

BATH FIXTURE CLEARANCE
SCALE: 1/2" = 1'-0"

COMPONENTS OF MEANS OF ESCAPE:

(A) NO DOOR IN THE PATH OF TRAVEL OF MEANS OF ESCAPE SHALL BE LESS THAN 2'-8" WIDE, EXCEPT THAT BATHROOM DOORS MAY BE 2'-4" WIDE UNLESS A LARGER DOOR OPENING IS REQUIRED TO SATISFY REQUIREMENTS OF F.B.C.

(B) EVERY CLOSET DOOR LATCH SHALL BE SUCH THAT CHILDREN CAN OPEN THE DOOR FROM INSIDE THE CLOSET.

(C) EVERY BATHROOM DOOR LOCK SHALL BE DESIGNED TO PERMIT THE OPENING OF THE LOCKED DOOR FROM THE OUTSIDE IN AN EMERGENCY.

(D) DOORS MAY BE SWINGING OR SLIDING AND ARE EXEMPT FROM THE REQUIREMENTS OF PARAGRAPH 3103.2(1) F.B.C.

(E) NO DOOR IN ANY MEANS OF ESCAPE SHALL BE LOCKED AGAINST EGRESS WHEN THE BUILDING IS OCCUPIED. ALL LOCKING DEVICES WHICH IMPEDE OR PROHIBIT EGRESS OR WHICH CANNOT BE EASILY DISENGAGED SHALL BE PROHIBITED.

NOTE:
ALL WINDOWS AND GLASS DOORS SHALL BE IMPACT RESISTANT AND SHALL BE MANUFACTURED IN ACCORDANCE WITH THE FOLLOWING PRODUCT APPROVALS

SECOND MEANS OF ESCAPE WINDOWS
EGRESS WINDOW OR DOOR OPERABLE FROM THE INSIDE WITHOUT THE USE OF TOOLS AND PROVIDING A CLEAR OPENING OF NOT LESS THAN 5.7 SQ. FT. IN WIDTH, 20 IN. IN HEIGHT AND 5.7 SQ. FT. IN AREA.

GENERAL NOTES

1. SHOWER & BATHTUB SHALL HAVE NON-ABSORBENT FLOOR & WALL FINISH UP TO 7'-0" HEIGHT, AS PER F.B.C. R307.2

1a. CERAMIC TILE WALL FINISH AND TUB SHOWER AREAS SHALL HAVE CEMENT FIBER OR GLASS MAT BACKING BOARD, AS PER F.B.C. R702.4.2

1b. GLAZING WITHIN 6'-0" OF FLOOR LEVEL IN WALLS SURROUNDING TUB OR SHOWER WITHIN 6'-0" HORIZONTALLY OF TUB OR SHOWER SHALL BE SAFETY GLAZING CAT. II PER R4410.2.6.1 & R308.4.5 F.B.C.

1c. SHOWER ENCLOSURE SHALL CONFORM TO THE SAFETY STANDARD FOR ARCH. GLAZING MATERIAL, CATEGORY II PER R4410.2.6.2 F.B.C.

2. VENT DRYER THRU WALL TO OUTSIDE.

3. 1/2" GYPSUM BOARD ON METAL HATS AT 16" O.C.

4. DESIGNATED EMERGENCY EGRESS DOOR SHALL BE LARGE MISSILE IMPACT RESISTANT, AS PER F.B.C. R310.4 & R4410.4

5. ALL INSULATION MATERIAL SHALL HAVE A FLAME RESISTANCE INDEX NOT TO EXCEED 450 WHEN TESTED AS PER ASTM E 84 OR UL 723 - FBC R302.10.1

6. LANDINGS OR FLOORS AT THE REQUIRED EGRESS DOOR SHALL NOT BE MORE THAN 1 1/2" LOWER THAN THE TOP OF THE THRESHOLD.

DOOR NOTES

1. ALL HARDWARE SHALL BE FURNISHED AND INSTALLED BY THE GENERAL CONTRACTOR.

2. INTERIOR DOOR, UNLESS OTHERWISE NOTED, SHALL BE GRADE.

3. PROVIDE WALL & FLOOR STOPS AS REQUIRED. PROVIDE SILENCERS TO ALL METAL FRAMES.

4. HOLLOW METAL DOOR TO BE 16 GAUGE.

5. PRODUCT APPROVAL FOR ALL WINDOWS, STORE FRONTS MUST BE SUBMITTED TO BUILDING DEPARTMENT FOR APPROVAL PRIOR TO INSPECTION OF SUCH PRODUCTS. ALSO SHALL BE DESIGNED TO MEET WIND PRESSURE AS PER ASCE 7-94.

6. UNLESS NOTED OTHERWISE, INTERIOR DOORS ARE WOOD OR MASONITE. EXTERIOR DOORS ARE METAL.

7. SLIDING DOOR WITH NOMINAL 3/2" CLEAR OPENING TO BE PROVIDED BY MANUFACTURER.

8. ALL STEEL FRAMES ARE GALVANIZED PRIMED AND PAINTED.

9. ALL WINDOWS AND EXTERIOR GLASS DOORS SHALL HAVE IMPACT RESISTANCE GLASS.

10. FIRE DOORS AND FRAMES SHALL BE UL - "B" LABEL RATED 1-1/2 HOURS.

11. ALL EXTERIOR DOORS TO HAVE WATER STRIP, 389 IN. VINYL DORBIN OR APPROVED EQUAL.

12. HINGES AT EXTERIOR METAL DOORS TO BE NON-REMOVABLE PIN WITH SECURITY STUDS TYPE.

13. REFER TO SPECIFICATIONS FOR HARDWARE SCHEDULE AND ADDITIONAL INFO.

14. ALL EXTERIOR DOORS TO BE DADE COUNTY PRODUCT APPROVED.

DOOR SCHEDULE				
No.	LOCATION	SIZE WIDTH HEIGHT THICK	TYPE	MATERIAL FINISH THRESHOLD JAMBS REMARKS
1	ENTRANCE & COVERED TERRACE	3'-0" 7'-0" 1 3/4"	SWING	METAL PAINTED METAL EMERGENCY MEANS OF ESCAPE, IMPACT RESISTANT
2	BEDROOM 1 & BATH 2	2'-10" 6'-8" 1 3/4"	SWING	WOOD PAINTED WOOD
3	BEDROOM 2 & BATH 1	2'-6" 6'-8" 1 3/4"	SWING	WOOD PAINTED WOOD
4	W.I.C. & LINEN	2'-6" 6'-8" 1 3/4"	BI-FOLD	WOOD PAINTED WOOD FULLY LOUVERED
5	A/C & WASHER DRYER CLOSET	2'-4" 6'-8" 1 3/4"	BI-FOLD	WOOD PAINTED

WINDOW LEGEND

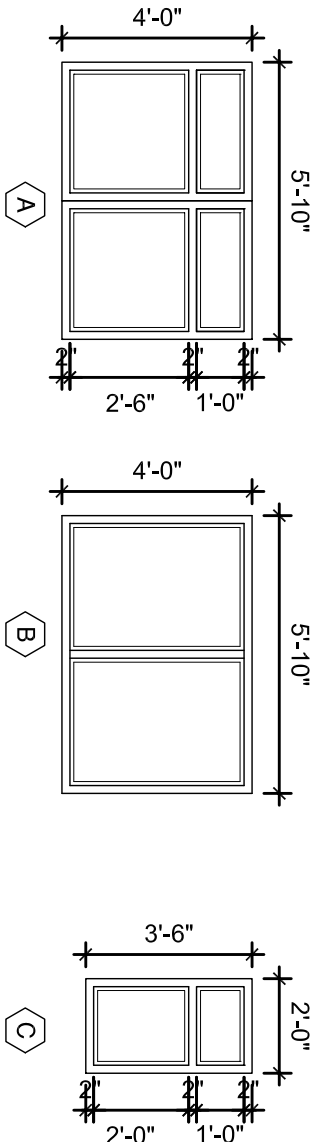

NOTE:
GLAZING LARGER THAN 950. SQ. FT. MUST BE CATEGORIED AS SAFETY GLASS. MANUFACTURER'S SAFETY GLASS INSPECTION TO BE KEPT ON SITE.

WINDOW SCHEDULE			
NO.	TYPE	MODULAR SIZES	
		W	H
A	HORIZONTAL ROLLER	7'-0"	4'-8"
B	HORIZONTAL ROLLER	7'-0"	4'-8"
C	CASEMENT	2'-4"	4'-2"

- WINDOW NOTES
1. ALL WINDOWS TO BE IMPACT RESISTANT & MEET ASCE 7-94 WIND LOADS, WFR TO BE DADE COUNTY APPROVED & COMPLIANT WITH ALL APPLICABLE CODES.

2. ALL WINDOWS TO BE ESP BROWN FINISH WITH LIGHT GRAY TINTED IMPACT RESISTANT GLASS.

3. ALL DIMENSIONS SHOW ARE WINDOW UNIT SIZES. CONTRACTOR TO VERIFY ALL MASONRY ROUGH OPENINGS DIMENSIONS WITH MANUFACTURER PRIOR TO FABRICATING WINDOWS. (TYPICAL)

4. FOR SAFETY GLAZING WINDOW A SAFETY GLAZING MUST MEET OR EXCEED ANSI Z97.1-1984 PER FBC 1617.4.6.3 LBS EDITION.

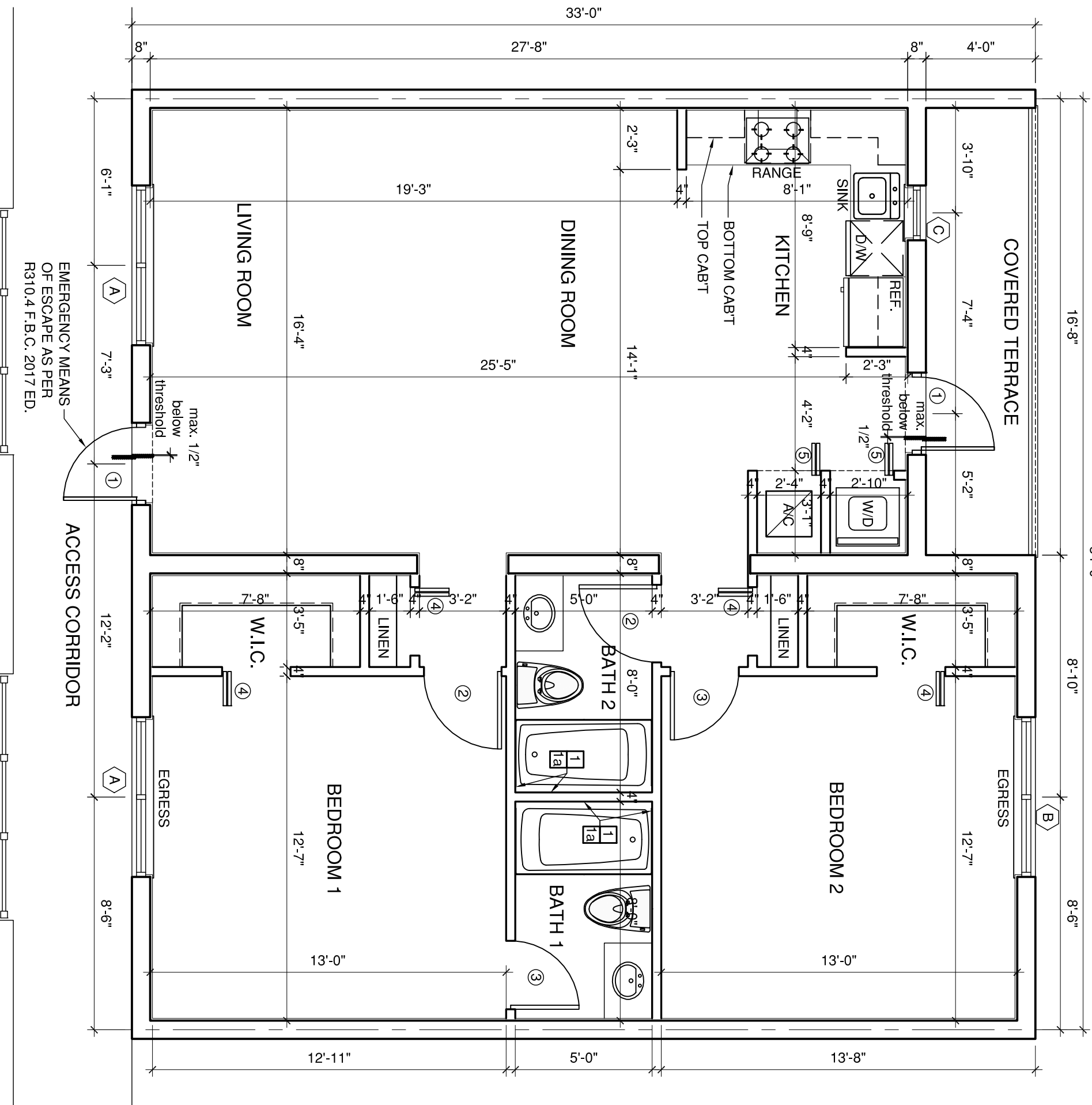

GROUND FLOOR PLAN - UNIT-A
SCALE: 1/4" = 1'-0"
2 BED - 2 BATHS
1,060 S.F.