

1 TREE INSTALLATION
SECTION NTS

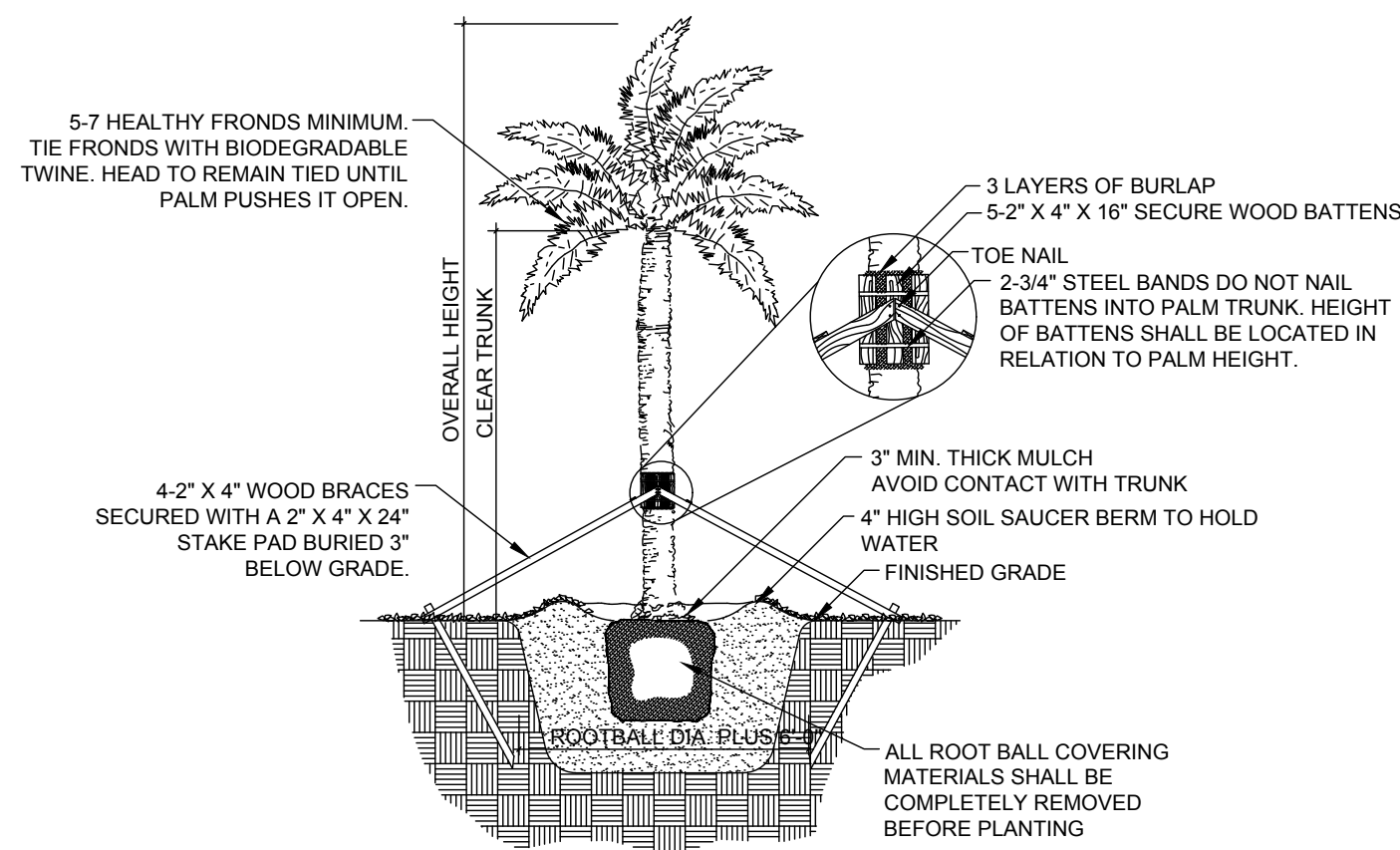

2 PALM INSTALLATION
SECTION NTS

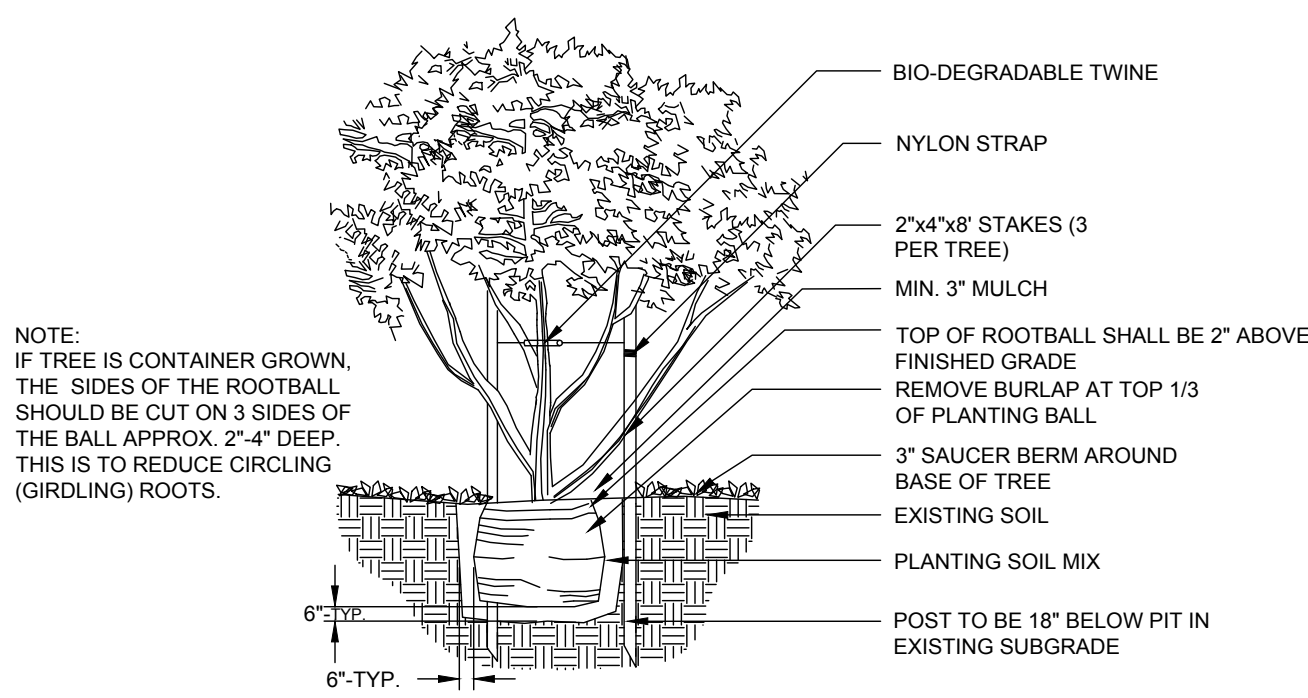

3 SMALL TREE
SECTION NTS

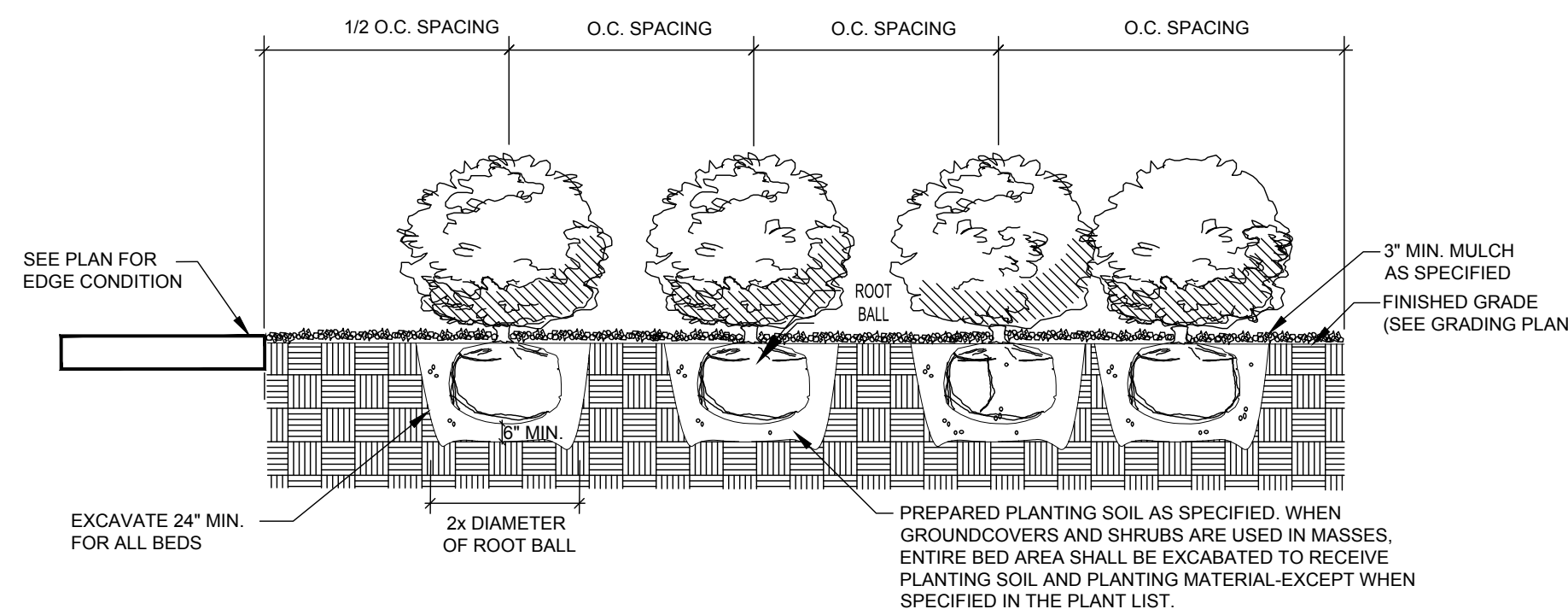

4 SHRUB PLANTING
SECTION NTS

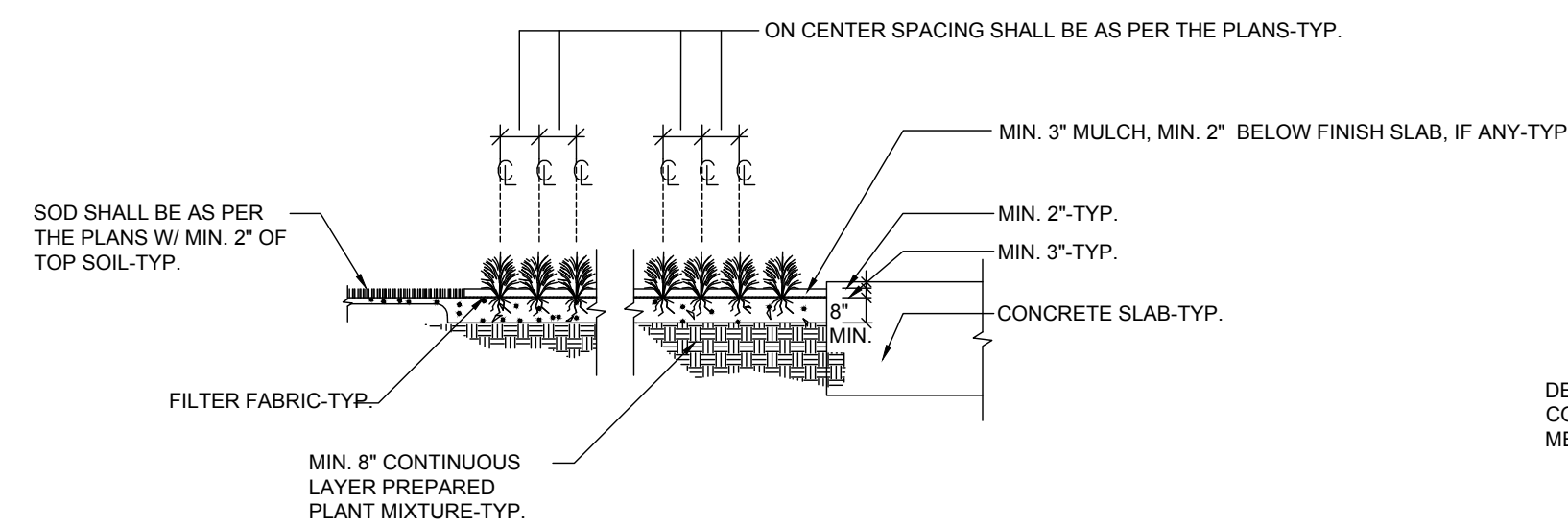

5 GROUNDCOVER PLANTING
SECTION NTS

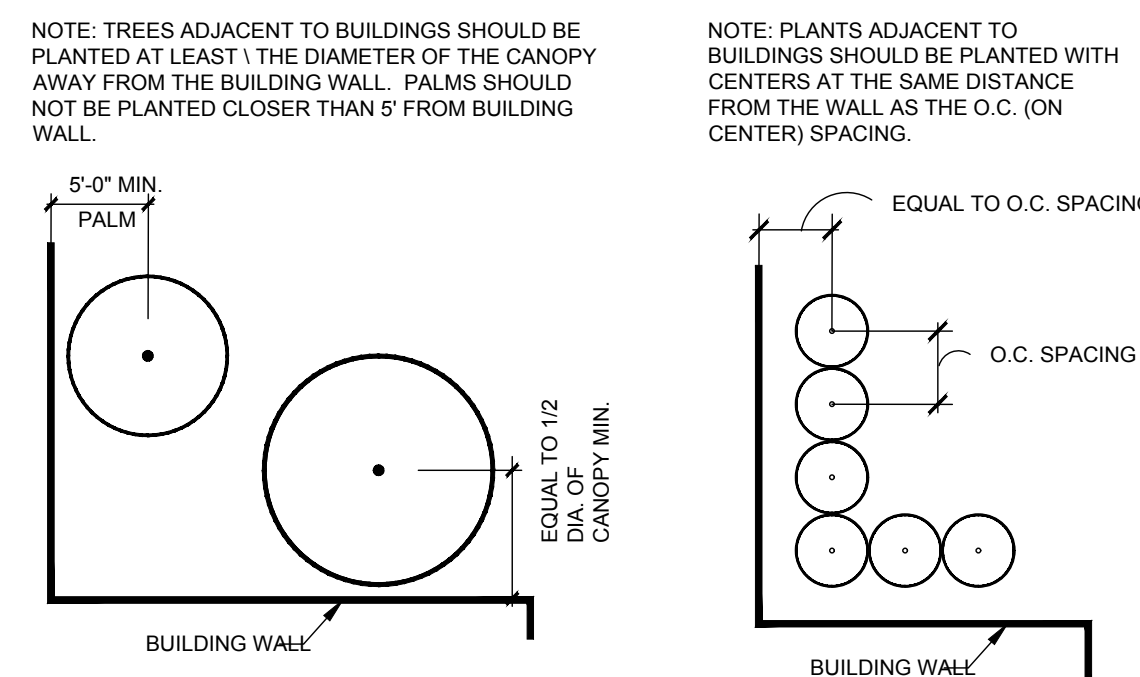

6 PLANTING ADJACENT TO BUILDING
SECTION NTS

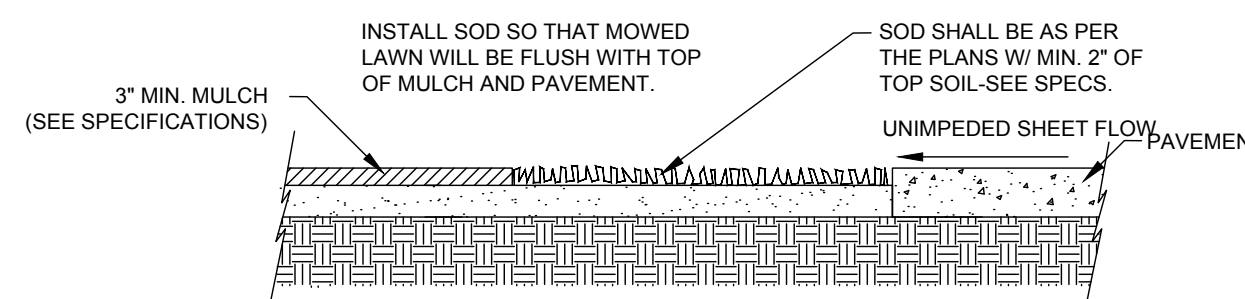

7 SOD INSTALLATION
SECTION NTS

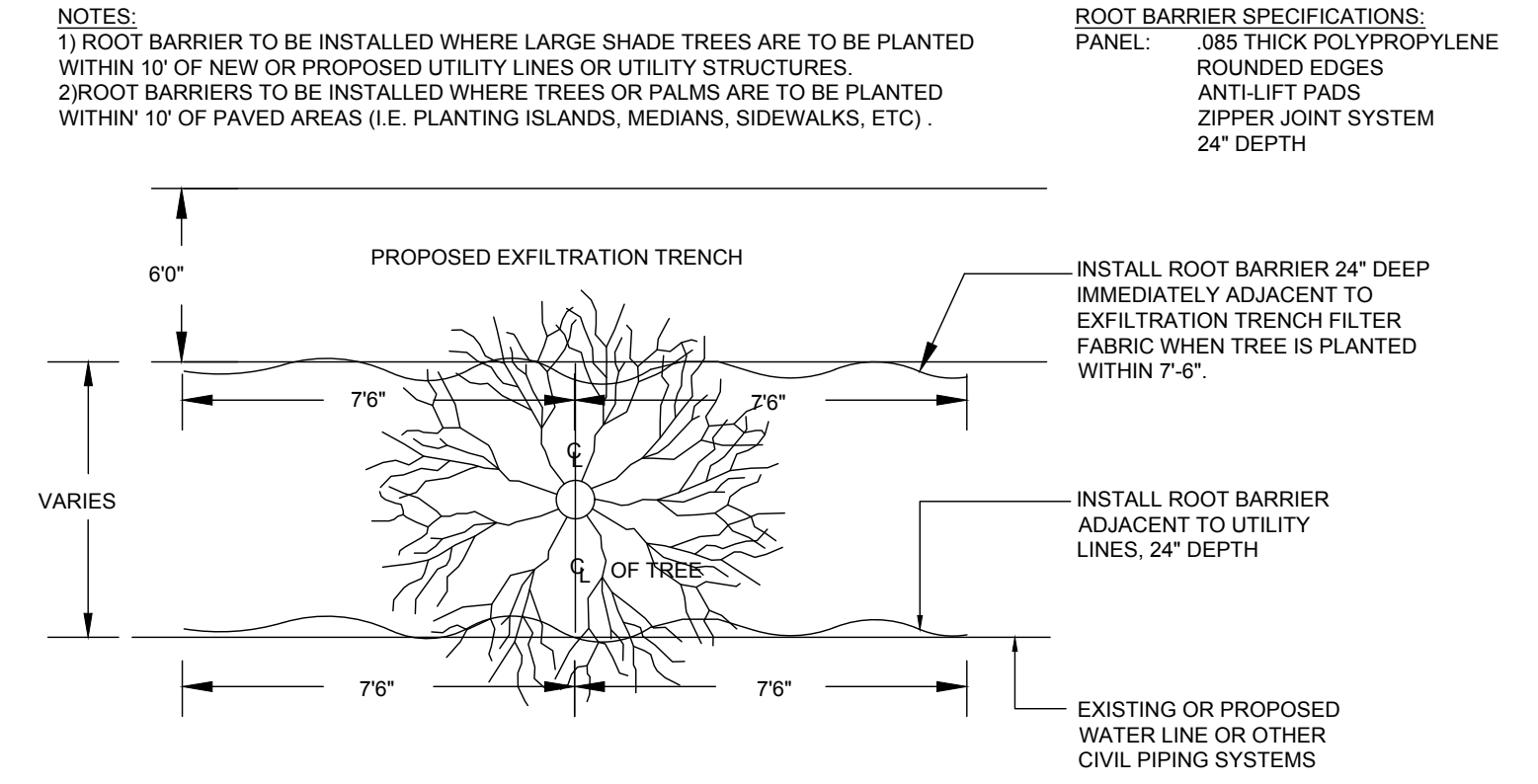

8 ROOT BARRIER
SECTION NTS

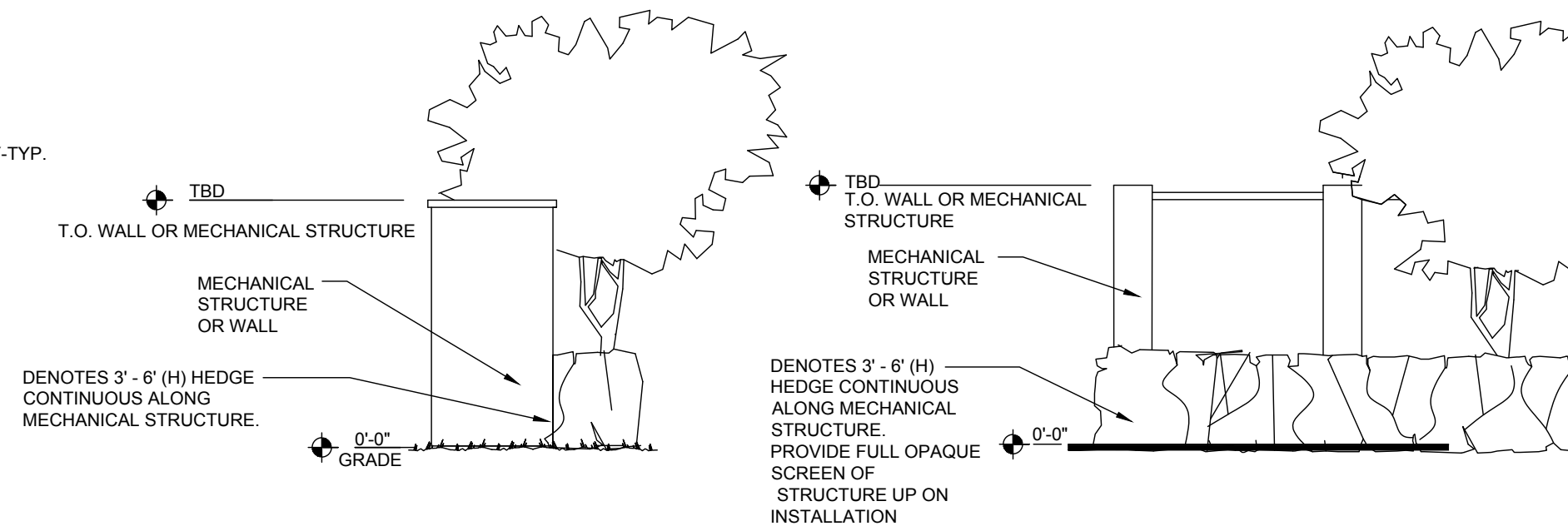

9 MECHANICAL EQUIPMENT SCREENING
ELEVATION NTS

NOTES:
1) ROOT BARRIER TO BE INSTALLED WHERE LARGE SHADE TREES ARE TO BE PLANTED WITHIN 10' OF NEW OR PROPOSED UTILITY LINES OR UTILITY STRUCTURES.
2) ROOT BARRIERS TO BE INSTALLED WHERE TREES OR PALMS ARE TO BE PLANTED WITHIN 10' OF PAVED AREAS (I.E. PLANTING ISLANDS, MEDIANS, SIDEWALKS, ETC.).

ROOT BARRIER SPECIFICATIONS:
PANEL: 085 THICK POLYPROPYLENE
ROUNDED EDGES
ANTI-LIFT PADS
ZIPPER JOINT SYSTEM
24\"/>

BOHLER
SITE CIVIL AND CONSULTING ENGINEERING
PROGRAM MANAGEMENT
LANDSCAPE ARCHITECTURE
SUSTAINABLE DESIGN
PERMITTING SERVICES
TRANSPORTATION SERVICES

REVISIONS

REV	DATE	COMMENT	DRAWN BY	CHECKED BY

811
Know what's below.
Call before you dig.
ALWAYS CALL 811
It's fast. It's free. It's the law.

SITE PLAN

THIS DRAWING IS INTENDED FOR MUNICIPAL AND/OR AGENCY REVIEW AND APPROVAL. IT IS NOT INTENDED AS A CONSTRUCTION DOCUMENT UNLESS INDICATED OTHERWISE.

PROJECT No.: FLB230010.00
DRAWN BY: RN
CHECKED BY: CL
DATE: 02/08/2023
CAD ID.: LAND

PROPOSED SITE PLAN
FOR
CRITERION
EXTERIOR GROUP LLC

PROPOSED DEVELOPMENT
NW 33RD STREET
POMPANO BEACH, FL 33069

BOHLER
1900 NW CORPORATE BOULEVARD
SUITE 101E
BOCA RATON, FLORIDA 33431
Phone: (561) 571-0280
Fax: (561) 571-0281
FLORIDA BUSINESS CERT. OF AUTH. No. 30780

THIS ITEM HAS BEEN DIGITALLY SIGNED AND SEALED BY BRETT M. WALDMAN, P.L.A. ON THE DATE ADJACENT TO THE SEAL. PRINTED COPIES OF THIS DOCUMENT ARE NOT CONSIDERED SIGNED AND SEALED AND THE SIGNATURE MUST BE VERIFIED ON ANY ELECTRONIC COPIES.

SHEET TITLE:
LANDSCAPE NOTES
SHEET NUMBER:
L-711
ORG. DATE - 02/08/2023