

Luminaire Schedule									
Symbol	Qty	Label	Arrangement	Luminaire Lumens	LLF	Luminaire Watts	Total Watts	Description	[MANUFAC]
	5	S1	Single	6265	0.900	40	200	BS100LED4HTLOWT40120-277V_S	BEGHELLI
	3	W6	Single	6768	0.900	38.14286	114.429	OPF-S-P03-740-T4M	SIGNIFY CANADA LTD
	2	SL9	Single	6768	0.900	38.14286	76.286	OPF-S-P03-740-T4M	SIGNIFY CANADA LTD
	1	W5	Single	4295	0.900	22.53333	22.533	OPF-S-P02-740-T3M	SIGNIFY CANADA LTD
	6	GA	Single	4421	0.900	30	180	BS100LEDPG4HTVLOWT40120-277V_S	BEGHELLI
Calculation Summary									
Label	CalcType	Units	Avg	Max	Min	Avg/Min	Max/Min	Point Spacing	Calc. Plane Height
Existing Sidewalk	Illuminance	Fc	2.56	4.3	0.1	25.60	43.00	3	0
First to Mid	Illuminance	Fc	29.09	37.4	21.7	1.34	1.72	2	14.256 to 19.303
Ground to Mid	Illuminance	Fc	23.35	28.1	21.0	1.11	1.24	2	0.357 to 7.394
Mid Landing_Top	Illuminance	Fc	24.21	26.6	21.5	1.13	1.24	2	6.993
Mid to First	Illuminance	Fc	26.15	29.9	23.1	1.13	1.29	2	7.394 to 14.256
Mid to Second	Illuminance	Fc	24.85	30.7	20.2	1.23	1.52	2	19.303 to 24.439
Parking	Illuminance	Fc	3.68	6.5	1.3	2.83	5.00	10	0
Property Line	Illuminance	Fc	0.45	2.3	0.0	N.A.	N.A.	N.A.	N.A.
Second Landing_Top	Illuminance	Fc	0.84	1.1	0.4	2.10	2.75	2	13.986
Second Mid Landing_Top	Illuminance	Fc	19.26	21.1	17.6	1.09	1.20	2	18.995
Third Landing_Top	Illuminance	Fc	29.63	31.7	27.4	1.08	1.16	2	23.99
Trash Staging and Guest Parking	Illuminance	Fc	1.83	2.7	1.0	1.83	2.70	5	0

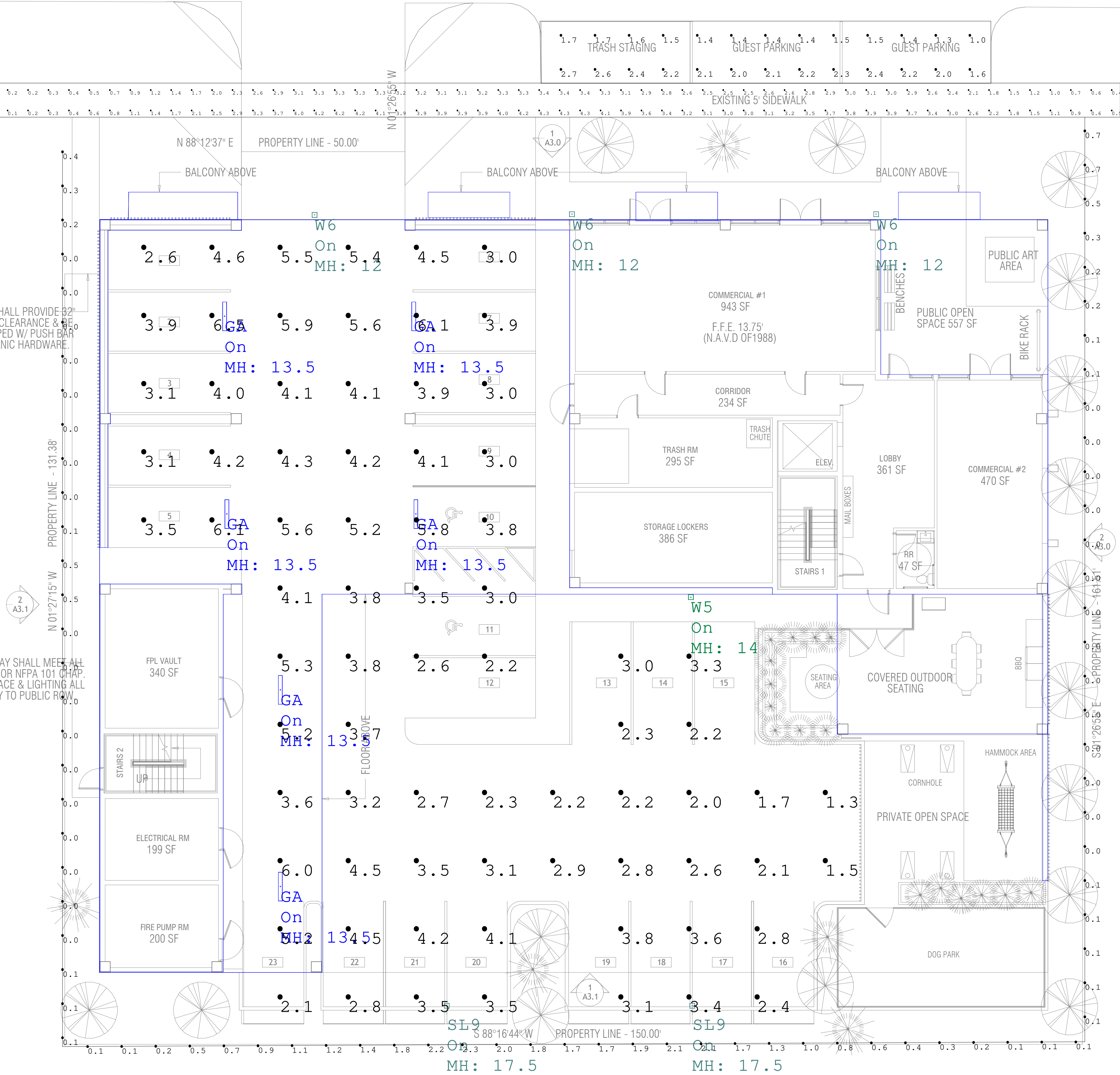

PHOTOMETRY  
Scale: 1 inch= 8 Ft.

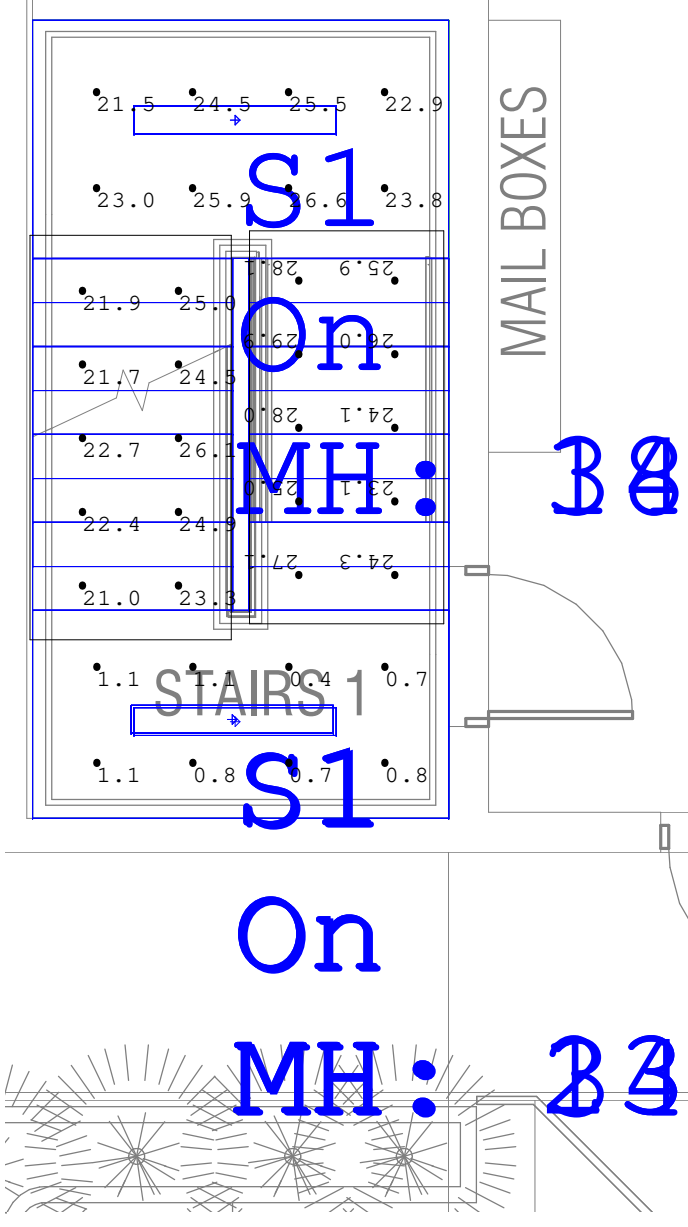

PHOTOMETRY  
Scale: 1 inch= 4 Ft.

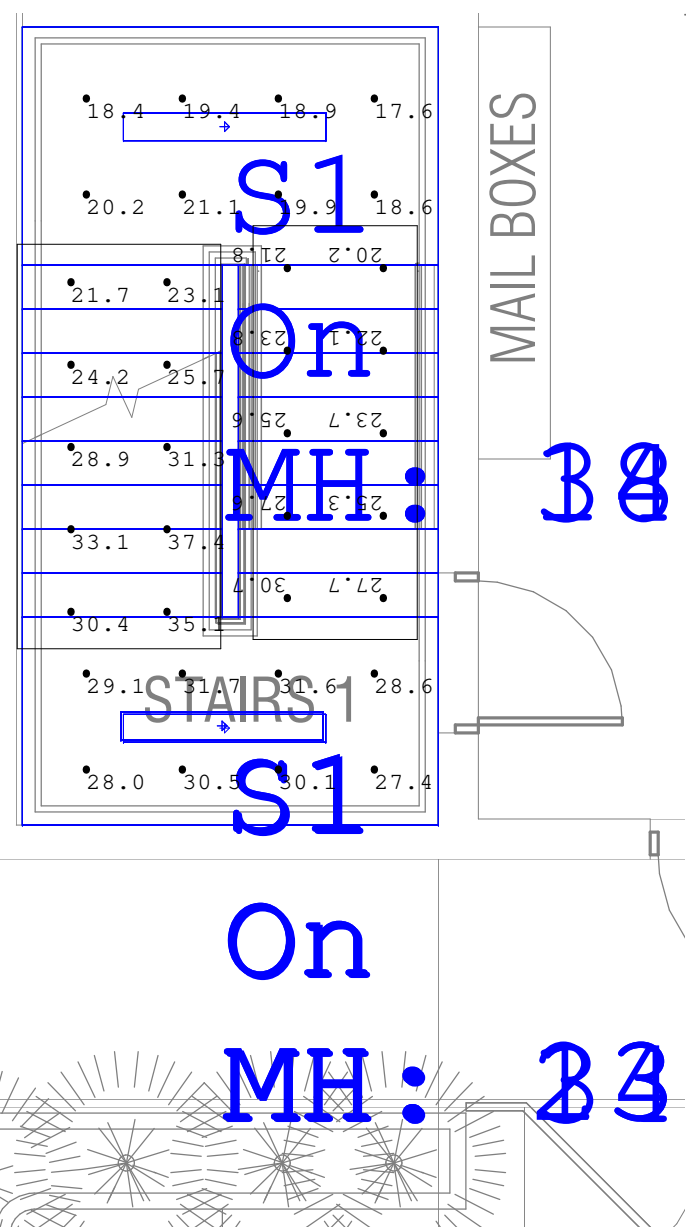

PHOTOMETRY  
Scale: 1 inch= 4 Ft.

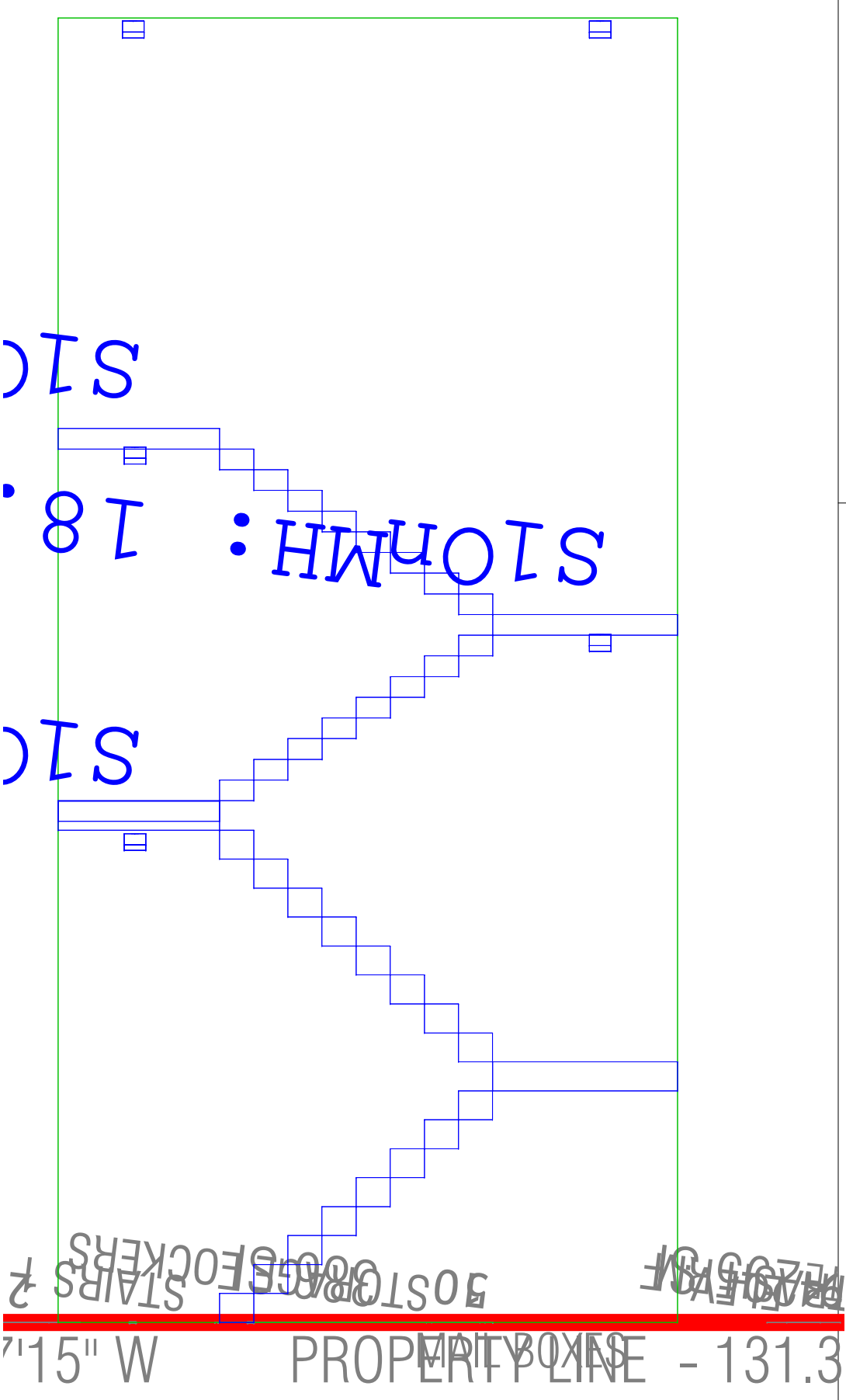

PHOTOMETRY  
Scale: 1 inch= 4 Ft.

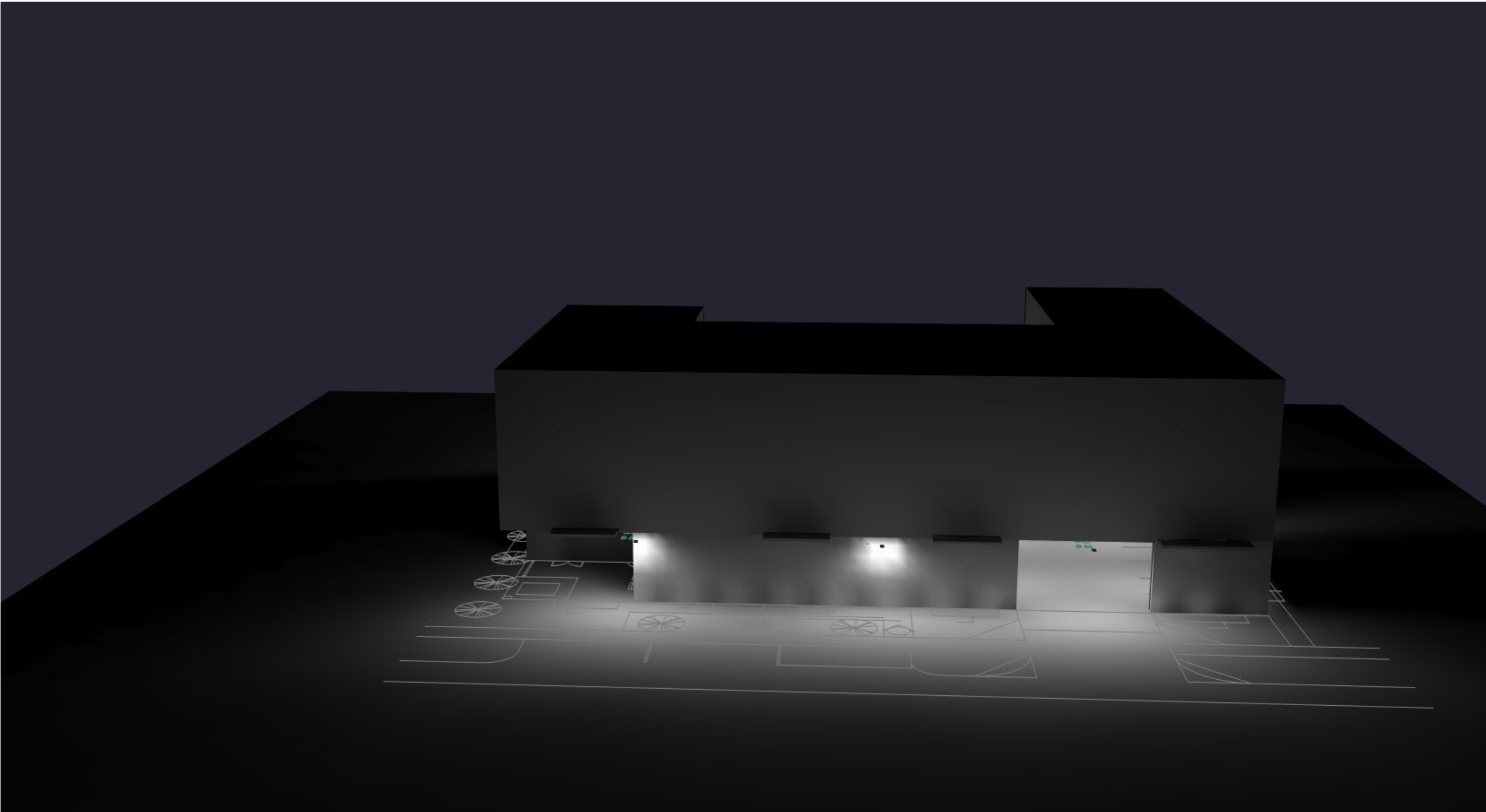
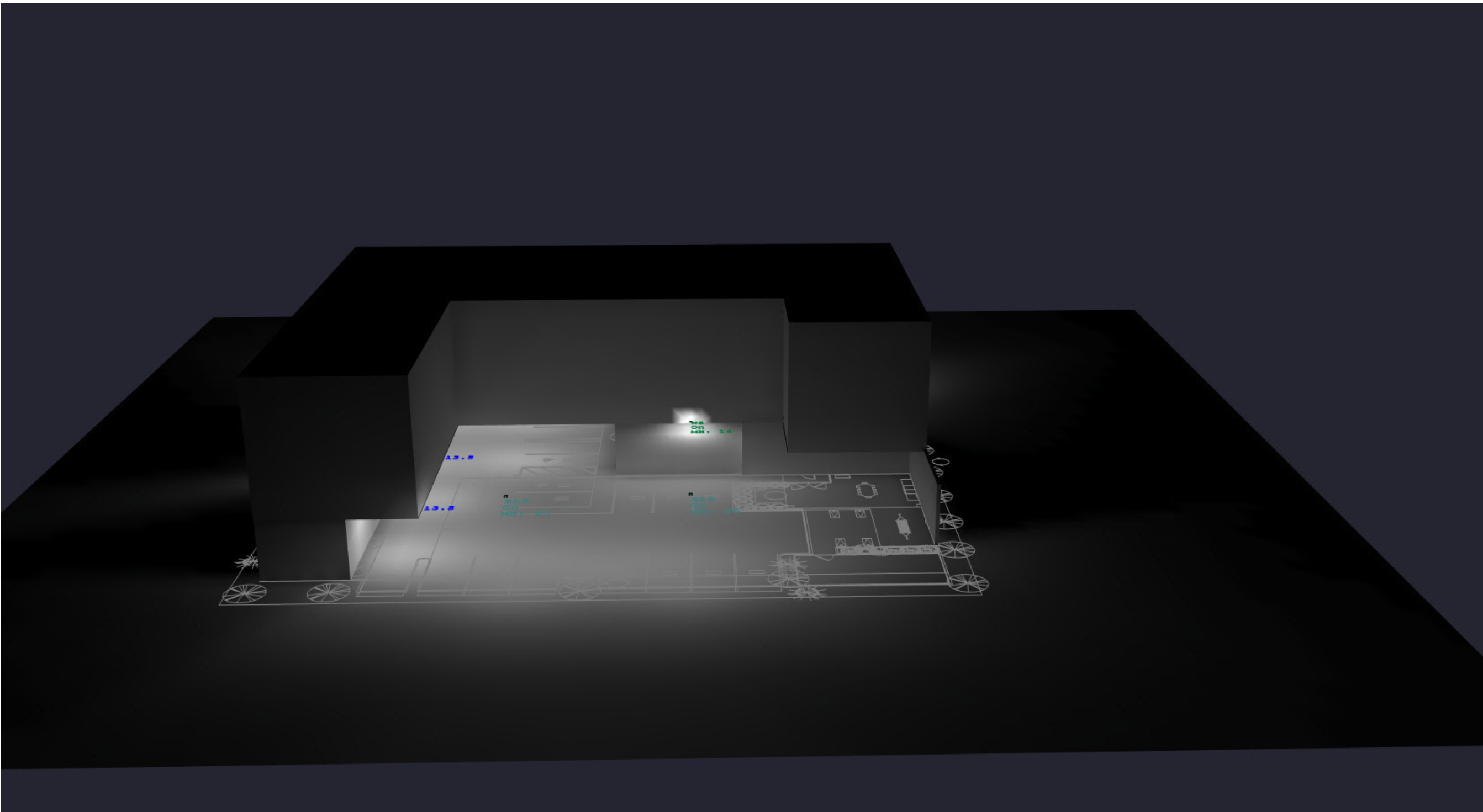

Disclaimer: SESCO Lighting provides this photometric report for purposes of comparison within the SESCO Lighting product line only. The information provided is based on standardized industry procedures. This laboratory performance will always differ from that observed in the field due to a great number of variables, both known and unknown (installation methods, power quality, lamping, recoverable and non-recoverable light loss factors, etc). In general, SESCO Lighting considers numerical studies to be predictive in that they cannot characterize the visual performance of any luminaire, single or grouped. As such, specification decisions must be thoroughly based upon experience, consultation with the manufacturer, and, above all, common sense.

Sales Rep: Cory Lawson  
Office: FT Lauderdale  
Contact: (850) 572-2827  
Processed By: J. Martin  
Filename: 12-09-2025 - 324 Haus - Initial Layout - Rev 1.AGI

324 Haus  
Pompano Beach  
Rev 1

Date: 12/9/2025  
PZ22- 12000032  
02/03/2026  
Page 1 of 1