DESCRIPTION

LEGAL DESCRIPTION:
CLUBHOUSE BOUNDARY

A PORTION OF LAND LYING IN SECTION 5, TOWNSHIP 49 SOUTH, RANGE 42 EAST
CITY OF POMPANO BEACH, BROWARD COUNTY, FLORIDA, BEING MORE PARTICULARLY
DESCRIBED AS FOLLOW

COMMENCING AT THE NORTHWEST CORNER OF PARCEL A "ALTECH PARCEL 9" ACCORDING TO THE PLAT THEREOF AS RECORDING IN PLAT BOOK 175 PAGE 59 PUBLIC RECORDS OF BROWARD COUNTY, FLORIDA; THENCE NORTH 85° 48' 07" WEST ALONG THE WESTERLY EXTENSION OF THE NORTH LINE OF SAID PARCEL A AND ALONG THE WESTERLY EXTENSION OF THE CLOUD CLUB NO. 71 TANGENT, 50' 20" 16" WEST; THENCE CONTINUE NORTH 85° 48' 07" WEST, ALONG SAID RIGHT OF WAY A DISTANCE OF 10.00 FEET; THENCE SOUTH 4° 11' 53" WEST, ALONG THE WESTERLY RIGHT OF WAY LINE OF SAID OAKS DRIVE A DISTANCE OF 39.00 FEET TO THE BEGINNING THENCE SOUTH 90° 00' 00" WEST, A DISTANCE OF 30.00 FEET; THENCE NORTH 15° 15' 00" WEST, A DISTANCE OF 196.21 FEET TO A POINT OF BEGINNING; THENCE CURVE FROM SAID POINT OF BEGINNING TO THE POINT OF BEGINNING, A CURVE HAVING A RADIUS OF 1,000.00 FEET, 52° 07' 16" W; THENCE ON A NON-TANGENT 400.00 FEET RADIIUS CURVE TO THE LEFT FOR AN ARC LENGTH OF 123.44 FEET HAVING A DELTA OF 17° 40' 51" HAVING A CHORD BEARING OF NORTH 29° 02' 19" EAST TO A POINT OF REVERSE CURVATURE; THENCE ALONG SAID 110.00 FEET RADIIUS CURVE TO THE RIGHT FOR AN ARC LENGTH OF 43.41 FEET HAVING A DELTA OF 17° 40' 51" HAVING A CHORD BEARING OF NORTH 30° 12' EAST TO A POINT ON CURVE FROM WHICH A RADIAL BEARING OF S47°11'28" THENCE NORTH 56° 40' 31" WEST, A DISTANCE OF 66.99 FEET TO THE BEGINNING OF A CURVE TANGENT TO SAID LINE, 165.29 FEET RADIIUS CURVE TO THE LEFT FOR AN ARC LENGTH OF 122.53 FEET, HAVING A DELTA 42° 28' 27" AND A CHORD BEARING OF NORTH 82° 09' 21" WEST; THENCE NORTH 70° 25' 26" WEST, A DISTANCE OF 95.56 FEET; THENCE NORTH 19° 19' 34" EAST, A DISTANCE OF 100.00 FEET TO THE POINT OF BEGINNING; THENCE ALONG THE WESTERLY EXTENSION OF AND PARALLEL TO THE SOUTH LINE OF PALM AIR COUNTRY CLUB NO. 71 AS RECORDED IN OFFICIAL RECORD BOOK 6464 PAGE 820 PUBLIC RECORDS OF BROWARD COUNTY, FLORIDA, A DISTANCE OF 262.33 FEET; THENCE SOUTH 36° 55' 03" EAST ALONG SAID SOUTHERLY PARALLEL LINE, A DISTANCE OF 151.63 FEET TO A POINT OF BEGINNING; THENCE CURVE FROM SAID POINT OF BEGINNING TO THE POINT OF BEGINNING, A CURVE HAVING A RADIUS OF 1,000.00 FEET, 52° 07' 16" W; THENCE SOUTHERLY AND WESTERLY PARALLEL LINE OF PALM AIR COUNTRY CLUB NO. 71 A TANGENT, 40.00 FEET RADIIUS CURVE TO THE RIGHT FOR AN ARC LENGTH OF 28.70 FEET AND HAVING A DELTA OF 41° 06' 56" AND A CHORD BEARING OF SOUTH 16° 21' 35" EAST; THENCE CONTINUE ALONG SAID PARALLEL WESTERLY LINE, SOUTH 4° 11' 53" WEST, A DISTANCE OF 151.63 FEET TO A POINT OF BEGINNING; THENCE NORTH 85° 48' 07" WEST, ALONG SAID PARALLEL A DISTANCE OF 250.00 FEET; THENCE SOUTH 4° 11' 53" WEST, ALONG THE WEST RIGHT OF WAY LINE OF OAKS CLUBHOUSE DRIVE A DISTANCE OF 212.74 FEET TO THE POINT OF BEGINNING.

SAID PARCEL BEING 201052.55 SQFT OR 4.616 ACRES MORE OR LESS.

DESCRIPTION

LEGAL DESCRIPTION:
PARKING BOUNDARY

A PORTION OF LAND LYING IN SECTION 5, TOWNSHIP 49 SOUTH, RANGE 42 EAST
CITY OF POMPANO BEACH, BROWARD COUNTY, FLORIDA, BEING MORE PARTICULARLY
DESCRIBED AS FOLLOW

COMMENCING AT THE NORTHWEST CORNER OF PARCEL A "ALTECH PARCEL II" ACCORDING TO THE PLAT THEREOF AS RECORDING IN PLAT BOOK 175 PAGE 59 PUBLIC RECORDS OF BROWARD COUNTY, FLORIDA; THENCE NORTH 85° 48' 07" WEST ALONG THE WESTERLY EXTENSION OF THE NORTH LINE OF SAID PARCEL A, A DISTANCE OF 10 FEET;
THENCE NORTH 41° 53' East, ALONG THE EAST LINE OF OAKS CLUBHOUSE DRIVE RIGHT OF WAY A DISTANCE OF 10.00 FEET TO THE POINT OF BEGINNING; THENCE CONTINUE ALONG SAID RIGHT OF WAY NORTH 41° 53' East, A DISTANCE OF 245.85';
THENCE NORTH 64° 55' 36" EAST, ALONG A LINE 10' SOUTH OF AND PARALLEL TO THE SOUTH LINE OF PALM AIRE COUNTRY CLUB NO 71, A DISTANCE OF 183.94 FEET; THENCE SOUTH 28° 09' 31" EAST, A DISTANCE OF 82.61 FEET; THENCE SOUTH 41° 11' 53" EAST, A DISTANCE OF 266.00 FEET, THENCE NORTH 48° 07' WEST ALONG A LINE 10 FEET NORTH OF AND PARALLEL TO THE SAID NORTH LINE OF ALTECH II AND THE WESTERLY PROLONGATION THEREOF, A DISTANCE OF 204.66 FEET TO THE POINT OF BEGINNING.

SAID PARCEL BEING 59964.79 SQFT OR 1.377 ACRES MORE OR LESS.

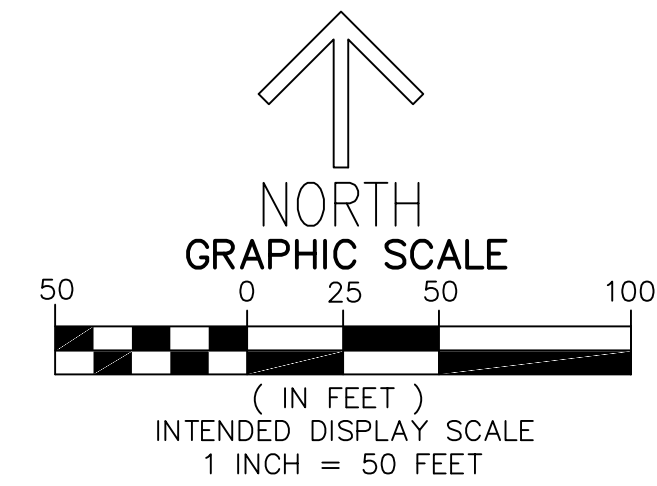

LEGEND

CONC. = CONCRETE
F.P.L. = FLORIDA POWER & LIGHT
FND. = FOUND
I.R./CAP = IRON ROD & CAP
L = ARC LENGTH
O.R.B. = OFFICIAL RECORD BOOK
P.B. = PLAT BOOK
P.O.B. = POINT OF BEGINNING
P.O.C. = POINT OF COMMENCEMENT
PGS. = PAGES
REF. = REFERENCE MONUMENT
PROP. = PROPOSED
R/W = RIGHT-OF-WAY
RGE. = RANGE
SEC = SECTION
SQ. FT. = SQUARE FEET
TWP. = TOWNSHIP
Δ = DELTA (CENTRAL ANGLE)
Δ = ELECTRICAL WIRES OVERHEAD
-OH- = FORCE MAIN
-W- = WATER MAIN
-IRR- = IRRIGATION LINE
-TEL- = PHONE OR FIBER OPTIC LINE
-STM- = STORM LINE
-SS- = SEWER LINE

SYMBOLS:

	= HORIZONTAL CONTROL POINT		= CATCH BASIN
	= BENCHMARK		= DRAINAGE PIPE END
	= TRASH CONTAINER		= ELECTRIC SWITCH
	= UNIDENTIFIED HANDHOLE		= ELECTRIC HANDHOLE
	= UNIDENTIFIED BOX		= ELECTRIC VAULT
	= NATURAL GAS MARKER		= ELECTRIC METER
	= SIGN		= ELECTRIC BOX
	= BOLLARD		= TRANSFORMER
	= TRAFFIC HANDHOLE		= GROUND LIGHT
	= CROSSWALK SIGNAL		= LIGHT POLE
	= MAST ARM / TRAFFIC LIGHT		= CONCRETE POWER POLE
	= SET/FOUND BOUNDARY POINT		= WOOD POWER POLE
	= FOUND CONCRETE MONUMENT		= GUY WIRE ANCHOR
	= FIBER OPTIC BOX		= PUMP
	= FIBER OPTIC VAULT		= FIRE HYDRANT
	= TELEPHONE SERVICE MANHOLE		= WATER GATE VALVE
	= CABLE TV HANDHOLE		= BACKFLOW PREVENTER
	= CABLE TV BOX		= IRRIGATION RISER/PEDASTAL
	= SEWER GATE VALVE		= IRRIGATION CONTROL VALVE
	= SANITARY MANHOLE		= WATER METER
	= DRAINAGE MANHOLE		= WELL
	= YARD DRAIN		= WATER VALVE
	= AREA OF APPARENT		= SECTION CORNER
	= PHYSICAL USE BY ADJOINING LANDS		

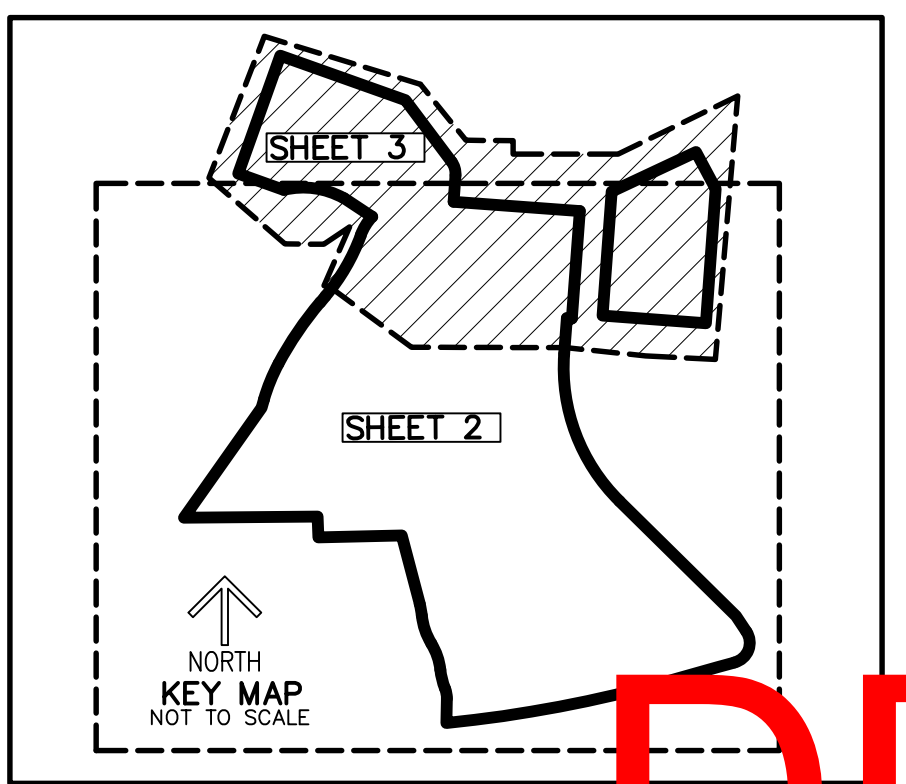

*IMPROVEMENTS ON PAGE 4

DRC
PAGE 4
JOB # 1032
T.NO.
3
OF 5 SHEET
PZ23-14000008
08/16/2023

[illegible]

CAULFIELD & WHEELER, INC.
CIVIL ENGINEERING — LAND PLANNING
LANDSCAPE ARCHITECTURE — SURVEYING
7900 GLADES ROAD — SUITE 100
BOCA RATON, FLORIDA 33434
PHONE (561) — 392-1991 / FAX (561) — 750-1991

BOUNDARY SURVEY
FOR OAKS @ PALM AIRE

DATE	3-15-2023
DRAWN BY	RSF
F.B./ PG.	ELEC
SCALE	SHOWN

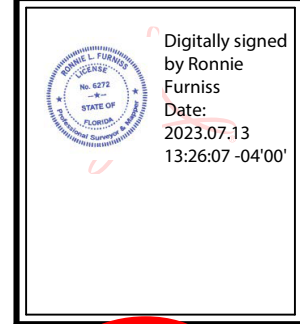

OB # 10326
T.NO. 3
OF 5 SHEETS