

McClellan Café/Wine Bar

Pompano Beach Historic
Preservation Committee

November 19, 2019

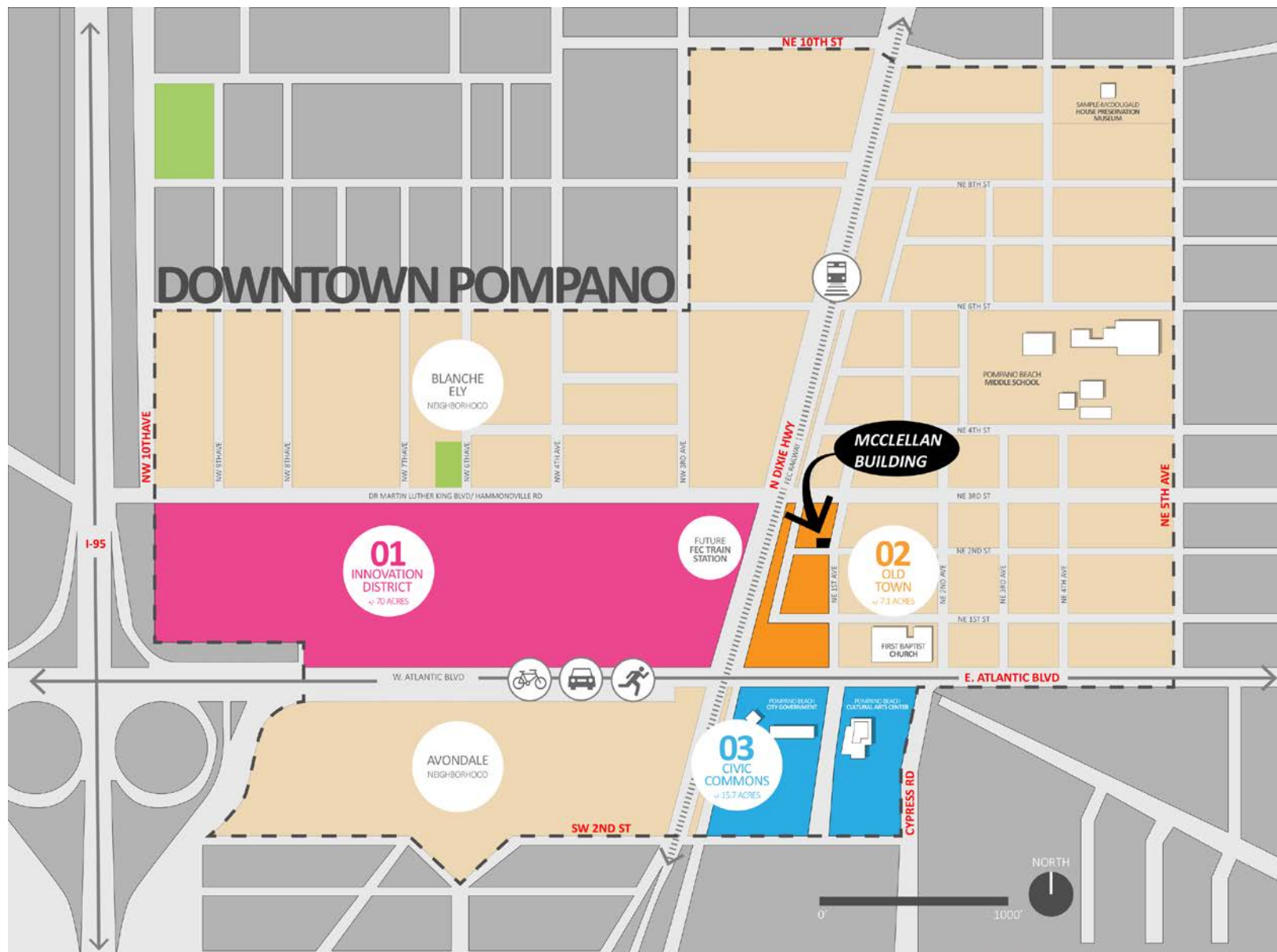



Downtown Pompano

- 01 Innovation District
- 02 Old Town
- 03 Civic Commons

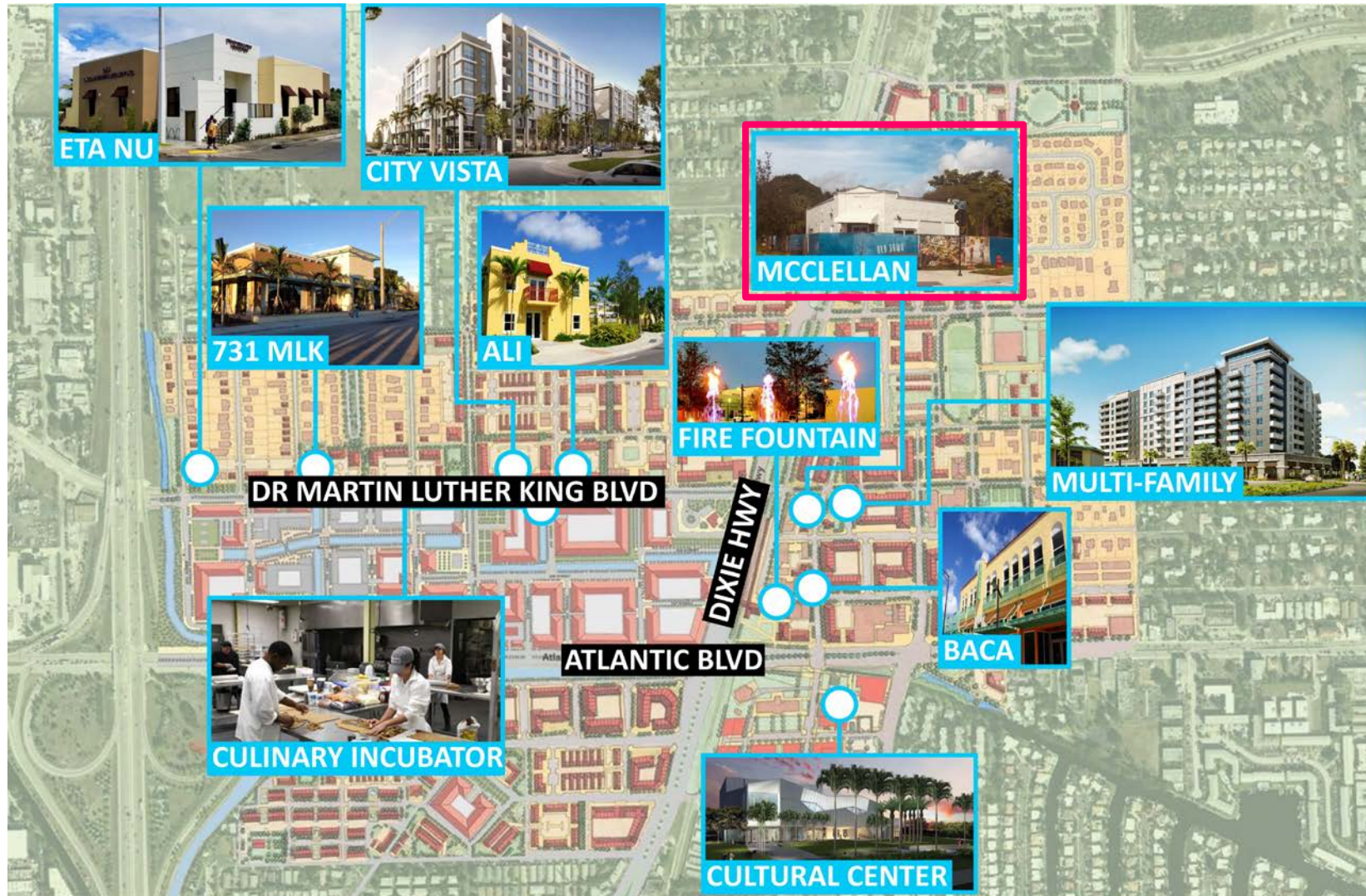

Downtown Pompano Projects



Pompano Cultural Tourism Trail



NORTH
0.25miles/5 minute walk

Pompano Cultural Tourism Trail



BLANCHE
ELY
HOUSE
POMPANO BEACH



Preserving Historic Buildings



Dr. McClellan Office

- Dr. George Sterling McClellan relocated to Pompano in 1921 and built his medical office & drugstore at the northeast corner of NE 2nd St. & NE 1st Ave.
- Dr. McClellan was Pompano's first physician and took care of everyone
- This building withstood the 1926 hurricane, reputedly sheltering 6 families during the storm
- This building was included in the 2013 Pompano Beach Historic Sites Survey



McClellan Café/Wine Bar Concept

- The 700 SF building would be a great spot for café/wine bar
- Outdoor seating would be included to draw people in
- Second life for building that provided so much service to the community
- Dada in Delray Beach is an example of restoration of historic structure into restaurant use





November 19, 2019

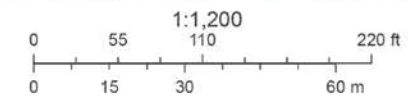

Aerial of Existing Sites

RELOCATE

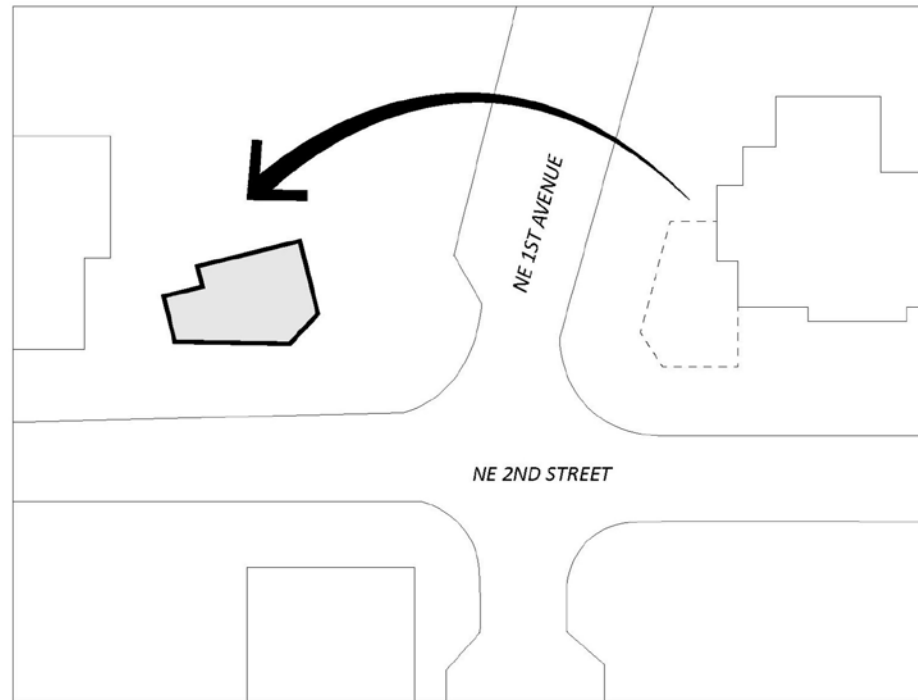

EXISTING



Relocation Diagram

[illegible]

Note: No decisions have been made by any entity, only preliminary discussion is beginning to get underway

Conceptual Site Design

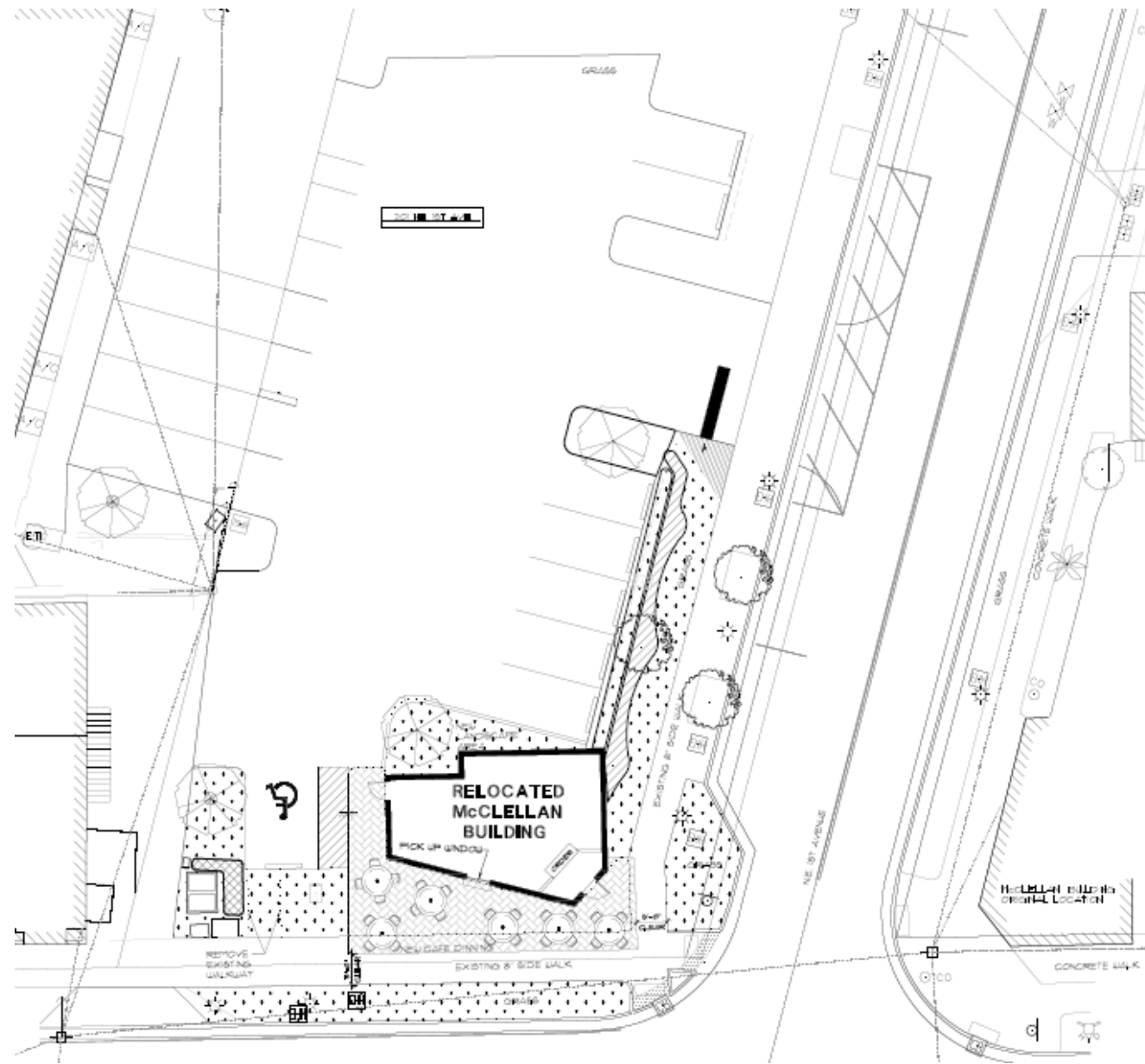

Note: No decisions have been made by any entity, only preliminary discussion is beginning to get underway



The McClellan Café/Wine Bar

- Opportunity for the CRA to lease and generate revenue for what is now a parking lot
- Estimated Timeframe for the McClellan Café/Wine Bar project is approximately 2 years
- The estimated costs to relocate and renovate the building are approximately \$400,000



Downtown Pompano Economic Impact

**Public
Investment**



DRIVES

**Private
Investment**



Cultural Heritage Tourism- Economic Impact

- Job Creation
- Restaurant Revenue
- Event Venue Revenue
- Tax Increment Financing (TIF)



McClellan Project Stakeholders

**CP OLD TOWN
SQUARE LLC &
T E P M, Inc.**

**The Historical
Society**

CRA

**Northwest CRA
Advisory
Committee**

**Historic
Preservation
Board**

**Old Pompano
Civic Association**

**Old Town
Improvement
District**

**McClellan
Family
Descendants**

**Residents &
Stakeholders**

Community Meeting Schedule

Pompano Beach Historical Society	Nov. 4, 2019
Old Pompano Civic Assoc.	Nov. 4, 2019
McClellan Descendants Interview	Nov. 13, 2019
Historic Preservation Board	Nov. 19, 2019
NWCRA Advisory Committee	Dec. 2, 2019
CRA Board	Dec. 17, 2019

THANK YOU!

A solid green horizontal bar at the bottom of the slide.