

NE 6th Street

16 ft. Parkway

South Property Line

Proposed Fence Line







NE 6th Street

16 ft. Parkway

South Property Line

Proposed Fence Line

Proposed Future Pool

3 feet



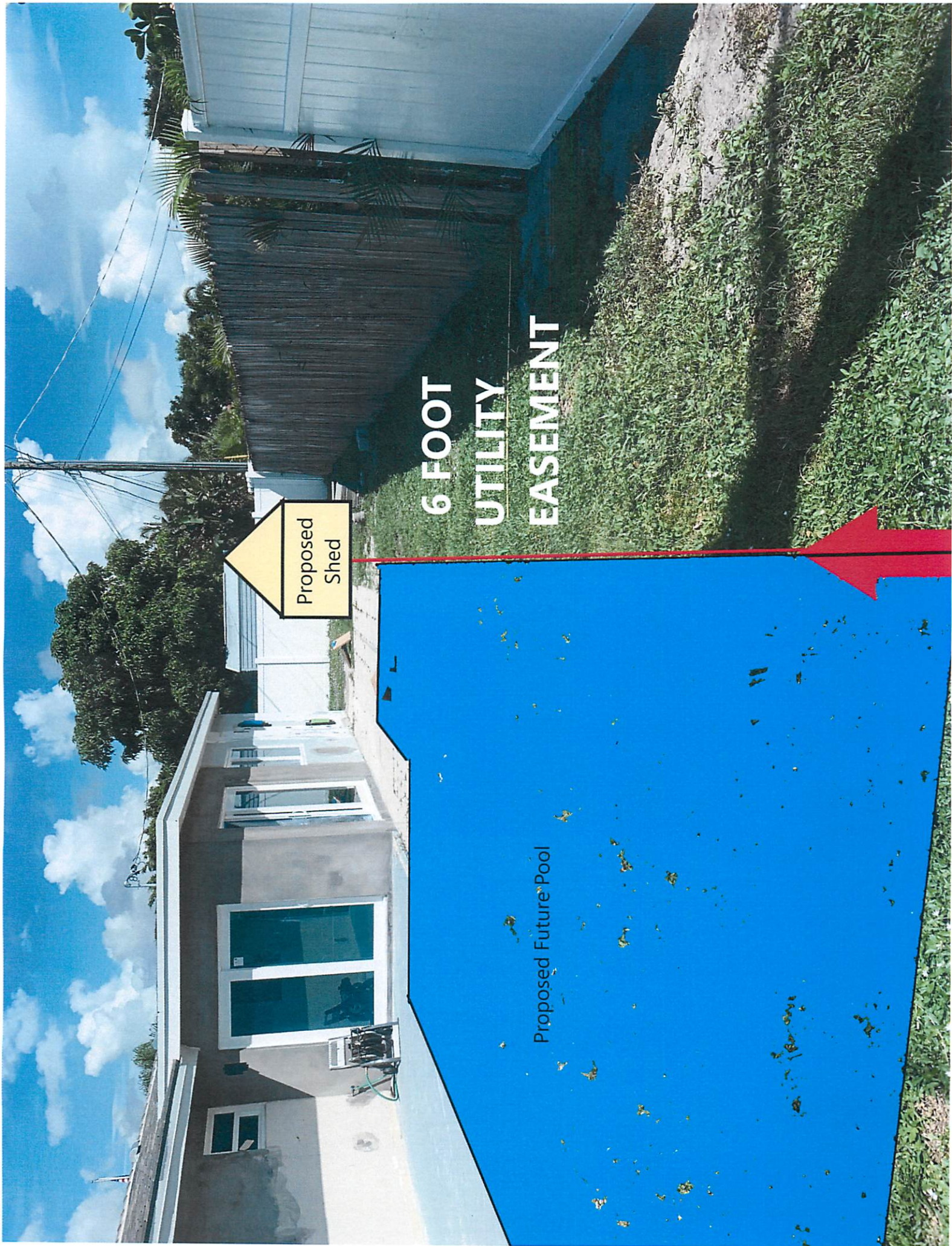

Proposed Future Pool

Proposed  
Shed

6 FOOT  
UTILITY  
EASEMENT



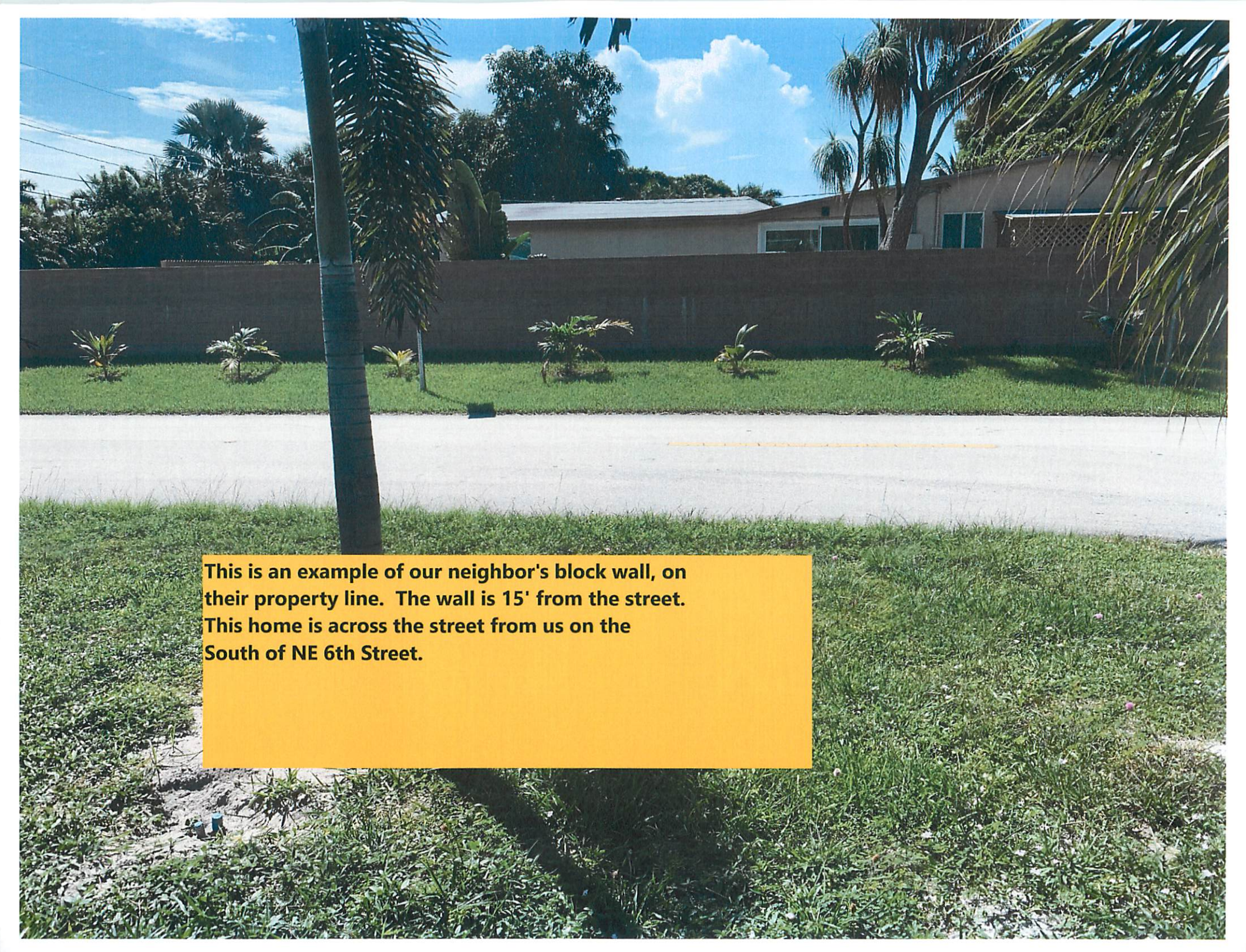

**This is an example of our neighbor's block wall, on their property line. The wall is 15' from the street. This home is across the street from us on the South of NE 6th Street.**



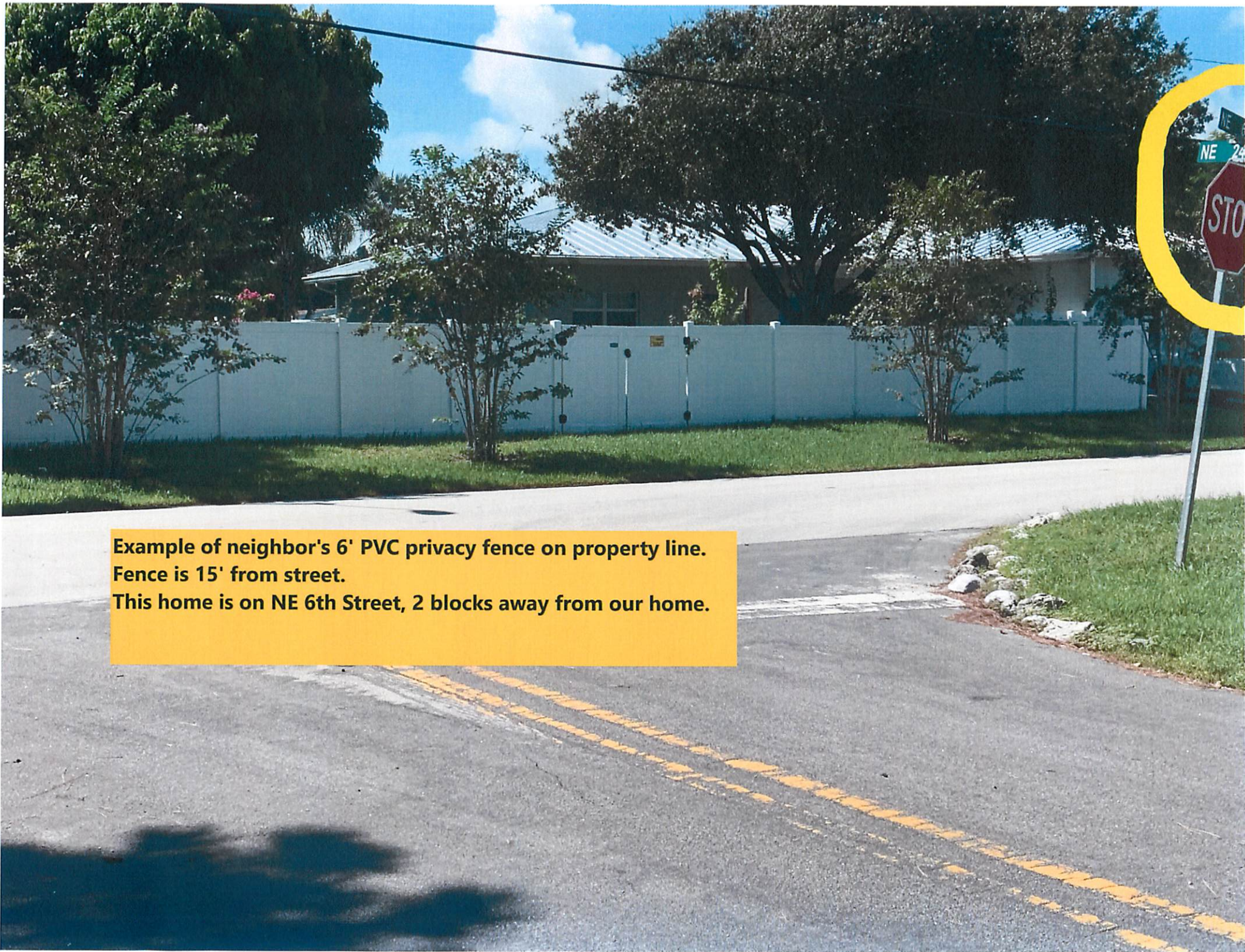

**Example of neighbor's 6' PVC privacy fence on property line.  
Fence is 15' from street.  
This home is on NE 6th Street, 2 blocks away from our home.**





**Example of neighbor's NEW 6' PVC  
Privacy Fence on property line.  
Recently constructed (Sept. 2020)  
Fence is 15' from street.  
600 NE 23 Terrace & NE 6th Street**



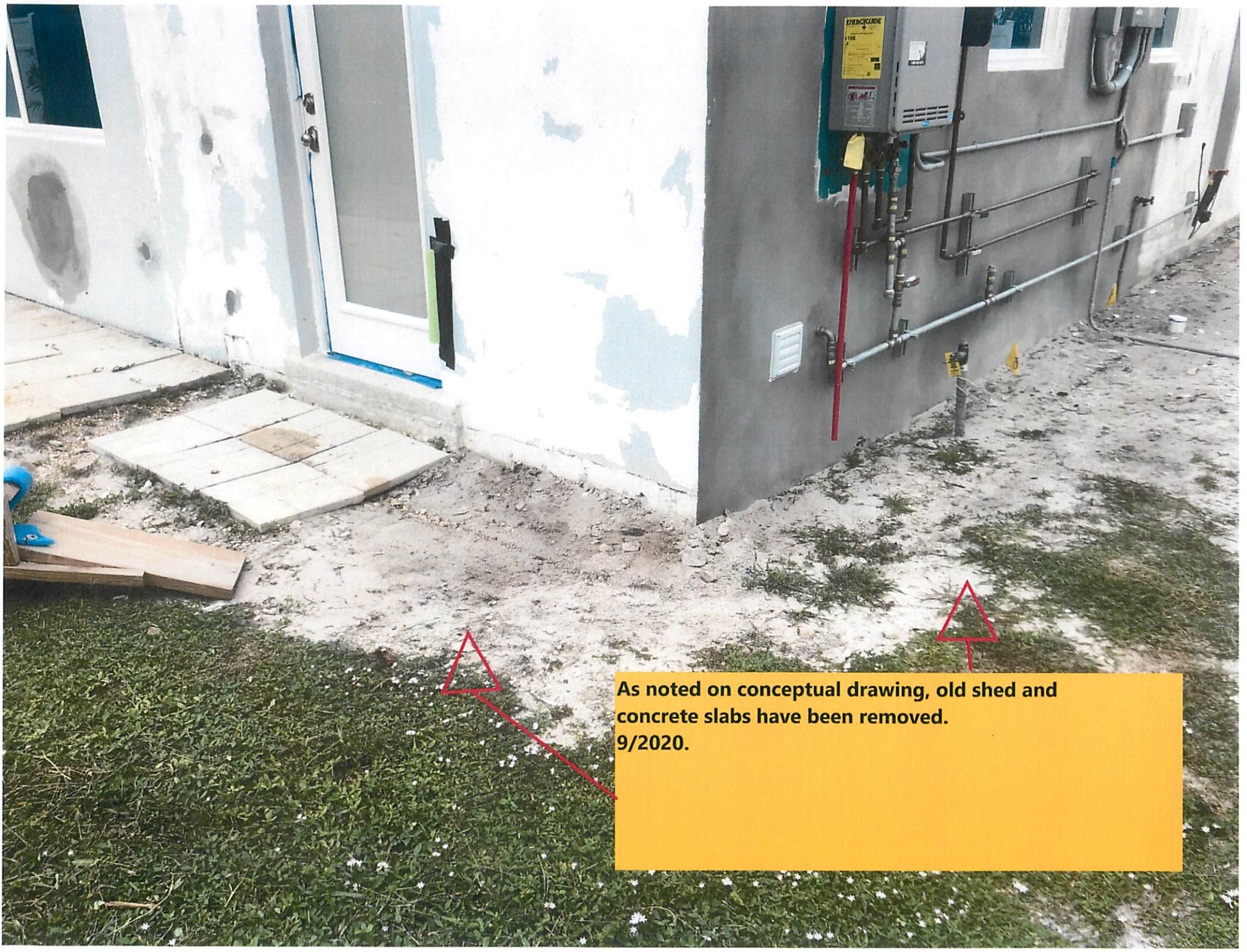

**As noted on conceptual drawing, old shed and concrete slabs have been removed. 9/2020.**



A photograph of a residential property. On the left, a light blue house with white trim and windows is visible. A concrete walkway runs along the side of the house. To the right of the walkway is a grassy yard. A yellow text box is overlaid on the image, containing the text "Pavers to be removed - they are not permanent,". The text is written in black, bold, sans-serif font. The background shows a clear blue sky with some clouds and a palm tree in the distance.

**Pavers to be removed - they are not permanent,**



As noted on conceptual drawing  
old shed and concrete pad  
have been removed  
9/2020.

