

1. REFER TO ARCHITECTURAL LIFE SAFETY PLAN FOR ALL EMERGENCY EGRESS ROUTES AND EMERGENCY EXITS FROM BUILDING
2. VISIBILITY AND UNOBSTRUCTED WORKING SPACE MUST BE MAINTAINED FROM FIRE APPARATUS ACCESS ROUTES TO FIRE PROTECTION AND LIFE SAFETY APPLIANCES/EQUIPMENT. THESE INCLUDE BUT NOT LIMITED TO: FIRE HYDRANTS, FIRE DEPARTMENT CONNECTIONS (FDC), POST INDICATING VALVES (PIV), FIRE SPRINKLER RISERS, FIRE ALARM CONTROL PANELS AND ELECTRICAL ROOM LOCATIONS.

3. CLEAR SPACE AROUND FIRE HYDRANTS, FIRE DEPARTMENT CONNECTIONS (FDC), AND ANY OTHER FIRE APPLIANCE REQUIRING CLEARANCE FOR ACCESS. A 36 INCH CLEAR SPACE SHALL BE MAINTAINED AROUND THE CIRCUMFERENCE OF FIRE HYDRANT/APPLIANCE.
4. VERTICAL CLEARANCE OF A MINIMUM 13'-6" SHALL BE PROVIDED FOR ALL FIRE APPARATUS ACCESS ROADS
5. FIRE APPARATUS ROADS SHALL BE DESIGNED AND MAINTAINED TO SUPPORT THE IMPOSED LOADS OF FIRE APPARATUS AND SHALL BE SURFACED SO AS TO PROVIDE ALL WEATHER DRIVING CAPABILITIES

- 
- A diagram of a circle with a vertical line segment passing through its center. The line segment is labeled 'N' at the top.

**GRAPHIC SCALE**

0 30 60



**SCALE: 1" = 30'**

**NOTE: PRINTED DRAWING SIZE  
MAY HAVE CHANGED FROM  
ORIGINAL. VERIFY SCALE USING  
BAR SCALE ABOVE.**

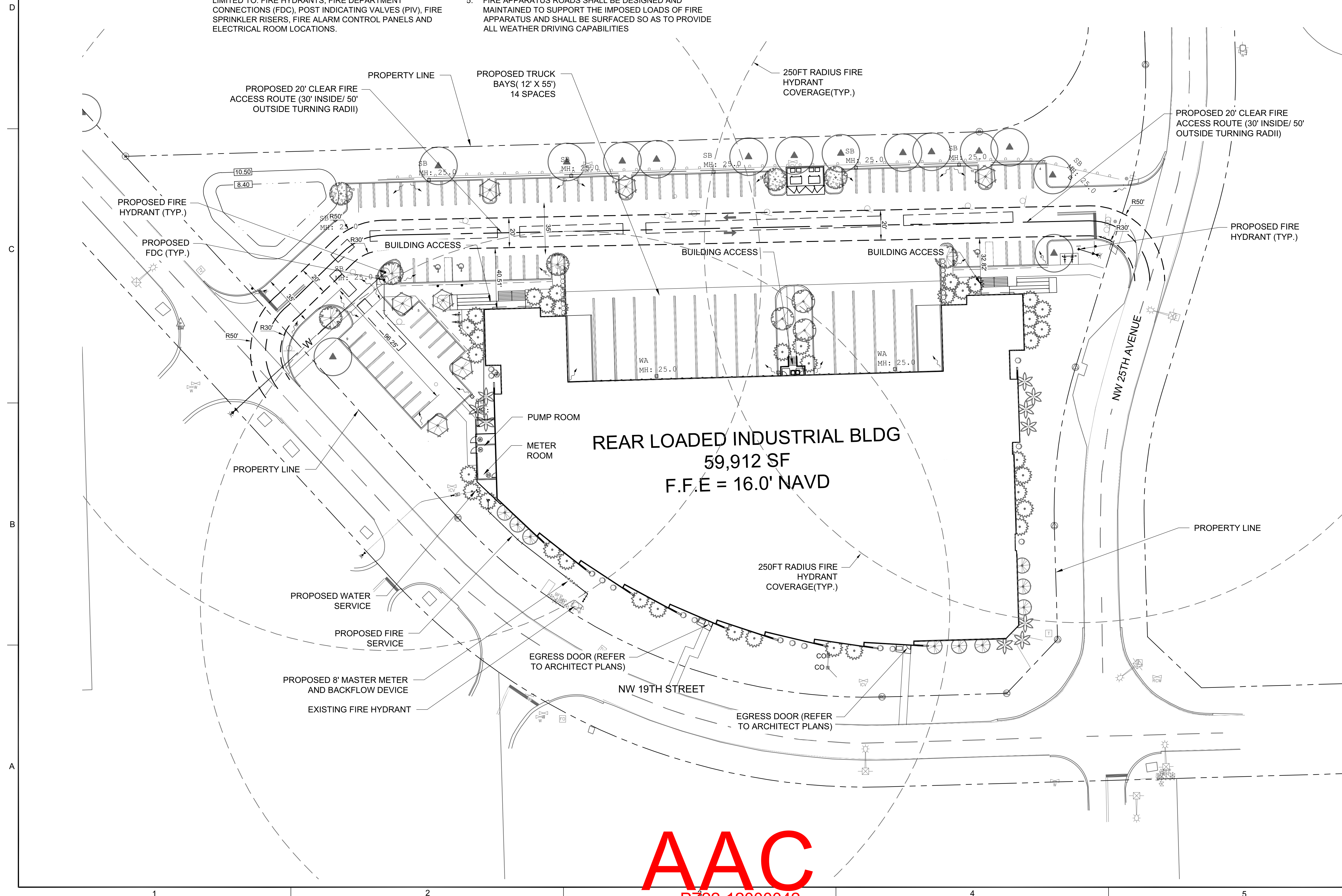

**KEITH**  
301 East Atlantic Blvd.  
Pompano Beach, FL 33060  
PH: (954) 788-3400

Florida Engineering Business License: CA7928  
Florida Surveyor and Mapper Business License: LB6860  
Florida Landscape Architecture Business License: LC2600045

[illegible]

**RESPONSIBILITY FOR THE USE OF THESE  
PLANS PRIOR TO OBTAINING PERMITS FROM  
ALL AGENCIES HAVING JURISDICTION OVER  
THE PROJECT WILL FALL SOLELY UPON THE  
USER.**

ISSUE DATE: 09/15/22

DESIGNED BY: JW

DRAWN BY: NW/SS/FA

CHECKED BY:	TD
-------------	----

<b>BID-CONTRACT:</b>	
----------------------	--

This item has been digitally signed and sealed by Thomas F. Donahue, P.E. on the date below using a Digital Signature.

THOMAS F. DONAHUE  
 LICENSE  
 No. 60529

Printed copies of this document are not considered signed and sealed and the signature must be verified on any electronic copies.

2023.02.01 17:49:57-05'00'

---

**THOMAS F. DONAHUE, P.E.**  
**FLORIDA REG. NO. 60529**  
**(FOR THE FIRM)**

CLIENT

**FIRST INDUSTRIAL  
REALITY TRUST**

PROJECT  
**FIRST POMPANO  
LOGISTICS CENTER I**

**2551 NW 19TH ST  
POMPANO BEACH, FL  
33069**

**SHEET TITLE**

## FIRE ACCESS PLAN

SHEET NUMBER **FA-101**

PROJECT NUMBER	12901.01
----------------	----------

STATUS: PRELIMINARY

# AAC

PZ22-12000042  
03/07/2023