

**CANOPY TREE PLANTING NOTES:**

- EACH TREE SHALL RECEIVE SIX "AGRIFORM" 21 GRAM TABLETS PER MANUFACTURER'S DIRECTIONS.
- ALL TREES SHALL HAVE A MINIMUM CLEARANCE OF 15' FROM LIGHT POLES, AND SHALL NOT BE INSTALLED WITHIN 10 FT. OF ANY ABOVE GROUND UTILITIES OR WITHIN 30 FT. OF THE FACE OF A STOP SIGN.
- ALL TREE TRIMMING SHALL BE IN ACCORDANCE WITH LOCAL CODES AND THE AMERICAN NATIONAL STANDARD INSTITUTE (ANSI)-A-300 PRUNING STANDARDS.

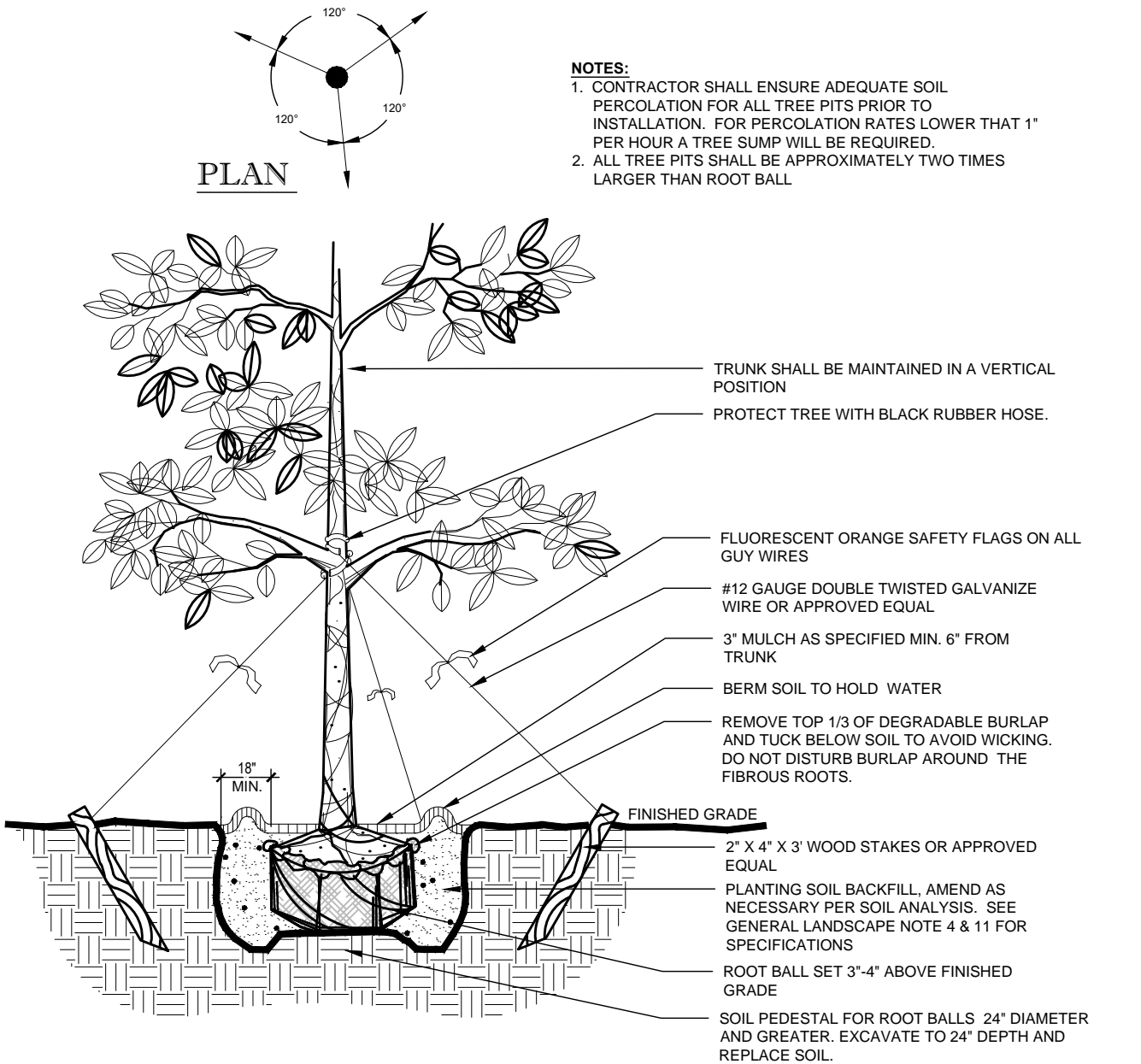

1 CANOPY TREE  
SCALE: NTS

- NOTES:**
- CONTRACTOR SHALL ENSURE FREE DRAINAGE/PERCOLATION OF ALL PLANTING PITS PRIOR TO INSTALLATION.
  - ALL TREE PITS SHALL BE APPROXIMATELY 1.5 TIMES LARGER THAN ROOT BALL.
  - FINAL TREE STAKING DETAILS AND PLACEMENT TO BE APPROVED BY THE LANDSCAPE ARCHITECT.
  - PRESSURE TREATED PINE TO BE USED FOR ALL WOOD STAKING AND BRACING MEMBERS.

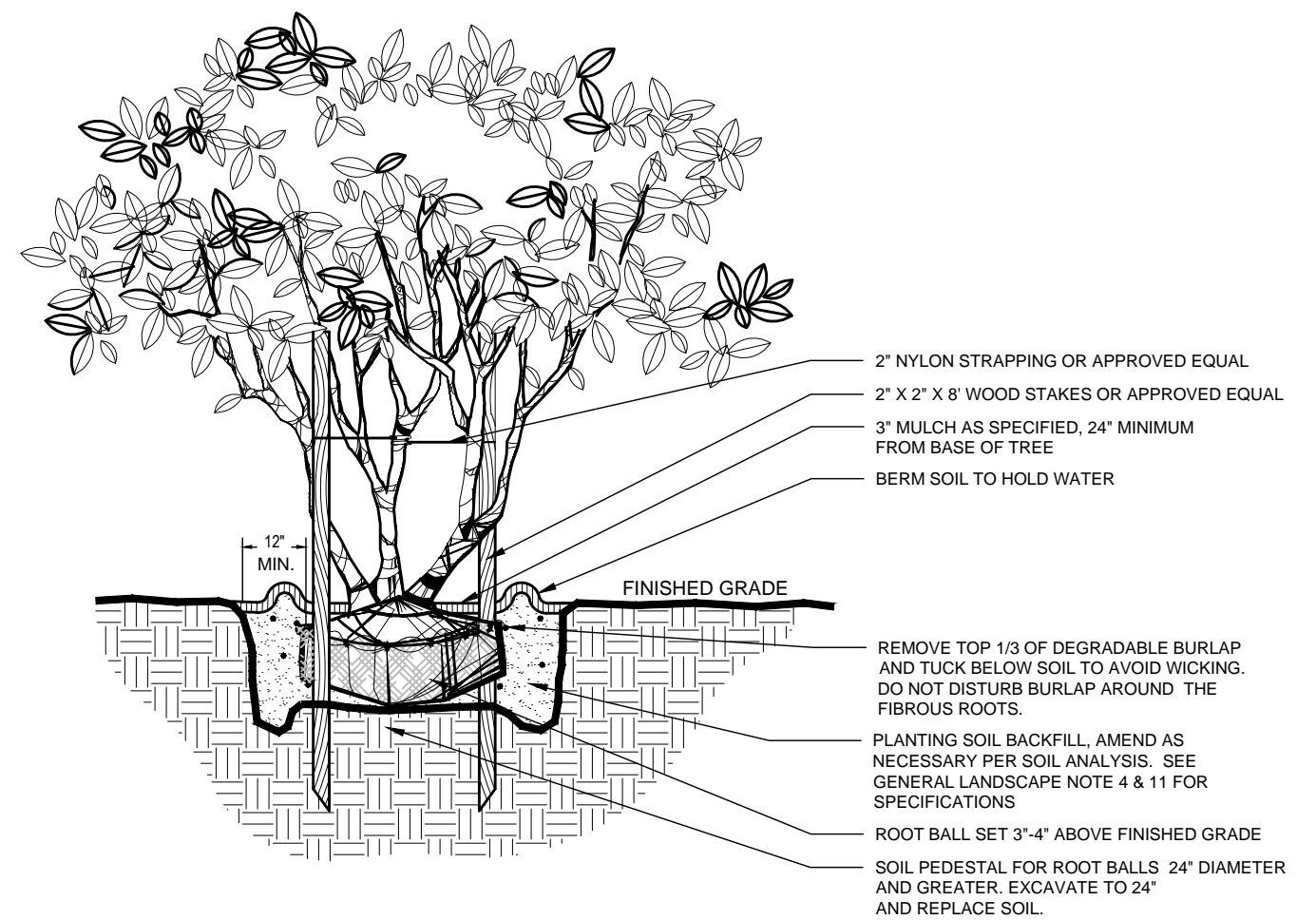

2 MULTI-STEM UNDERSTORY TREE  
SCALE: NTS

- NOTES:**
- ALL MULCH SHALL BE PEST AND INSECT FREE.
  - COMPLETELY FINE GRADE BED AS REQUIRED PRIOR TO PLACING MULCH.

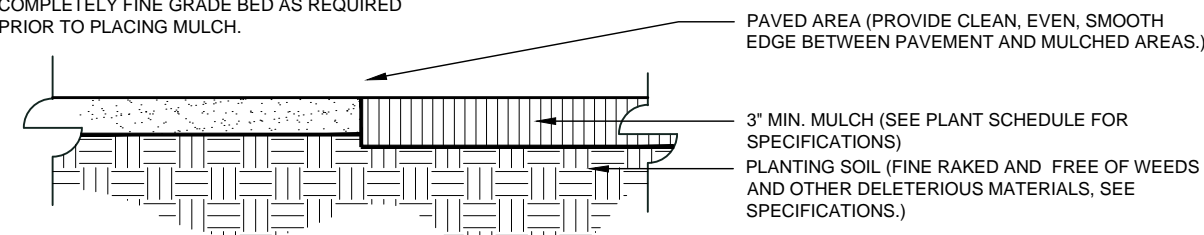

3 MULCH APPLICATION  
SCALE: NTS

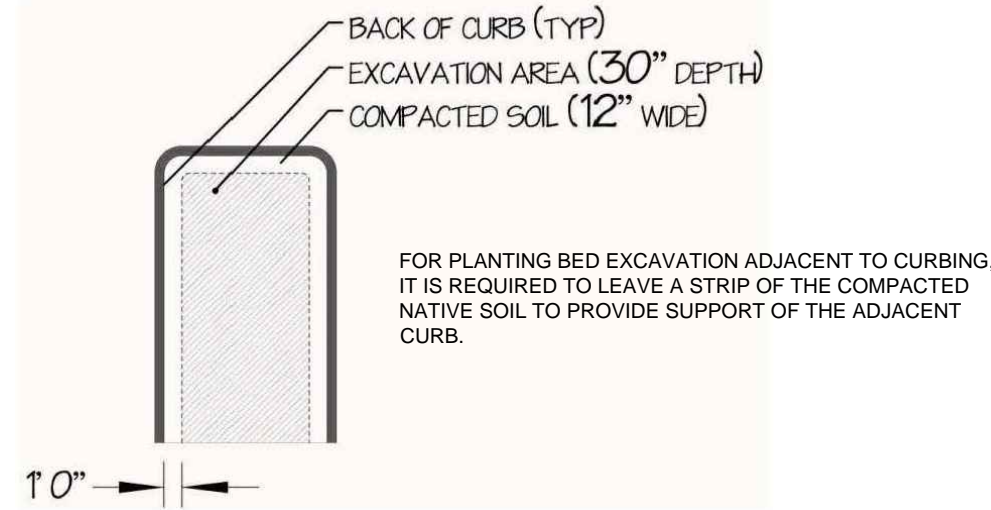

4 CURB AREA PLANTING DETAIL  
SCALE: NTS

- NOTES:**
- CONTRACTOR SHALL ENSURE FREE DRAINAGE/PERCOLATION OF ALL PLANTING PITS/BEDS PRIOR TO INSTALLATION.
  - ALL PLANTING PITS SHOULD HAVE VERTICAL SIDES AND BE APPROXIMATELY TWO TIMES LARGER THAN ROOT BALL.
  - PLANT MATERIAL SHALL BE INSTALLED 2' HIGH WITH SOIL MOUNDING UP TO THE TOP OF ROOT BALL.
  - WHERE GROUND COVERS ARE USED IN MASSES, THE ENTIRE BED SHALL BE EXCAVATED PRIOR TO RECEIVING PLANT MATERIAL AND PLANTING SOIL EXCEPT WHERE SPECIFIED.
  - ALL PLANT MATERIAL MASSES TO USE TRIANGULAR SPACING EXCEPT WHERE NOTED. REFER TO PLANT LIST FOR INDIVIDUAL PLANT SPACING 'X'.
  - PLANT MATERIAL INSTALLED ADJACENT TO STRAIGHT EDGES SHALL BE SPACED IN ROWS PARALLEL TO THE STRAIGHT EDGE. THOSE INSTALLED ADJACENT TO CURVED EDGES SHALL BE PLANTED IN ROWS PARALLEL TO THE CURVED EDGE.

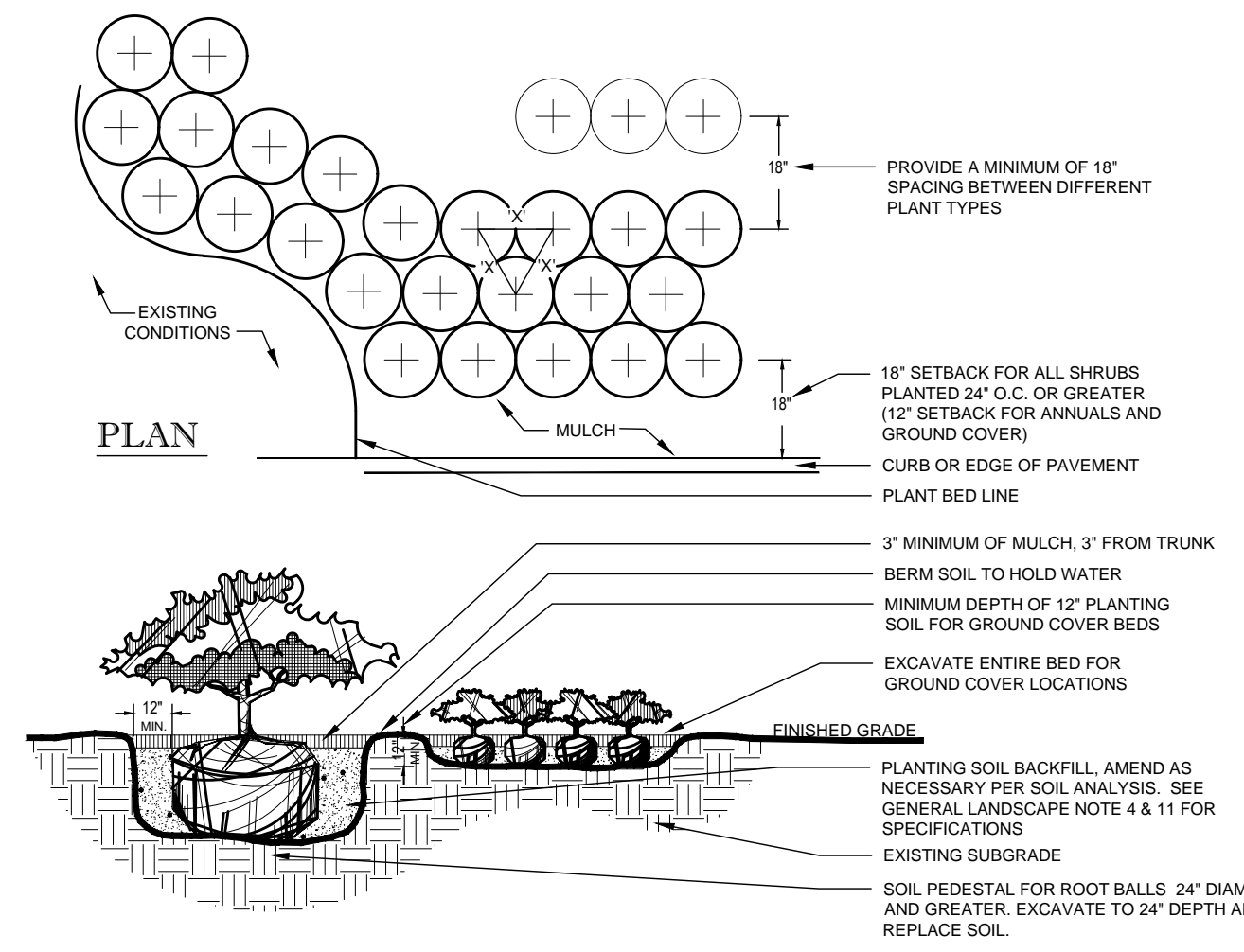

5 SHRUB AND GROUND COVER  
SCALE: NTS

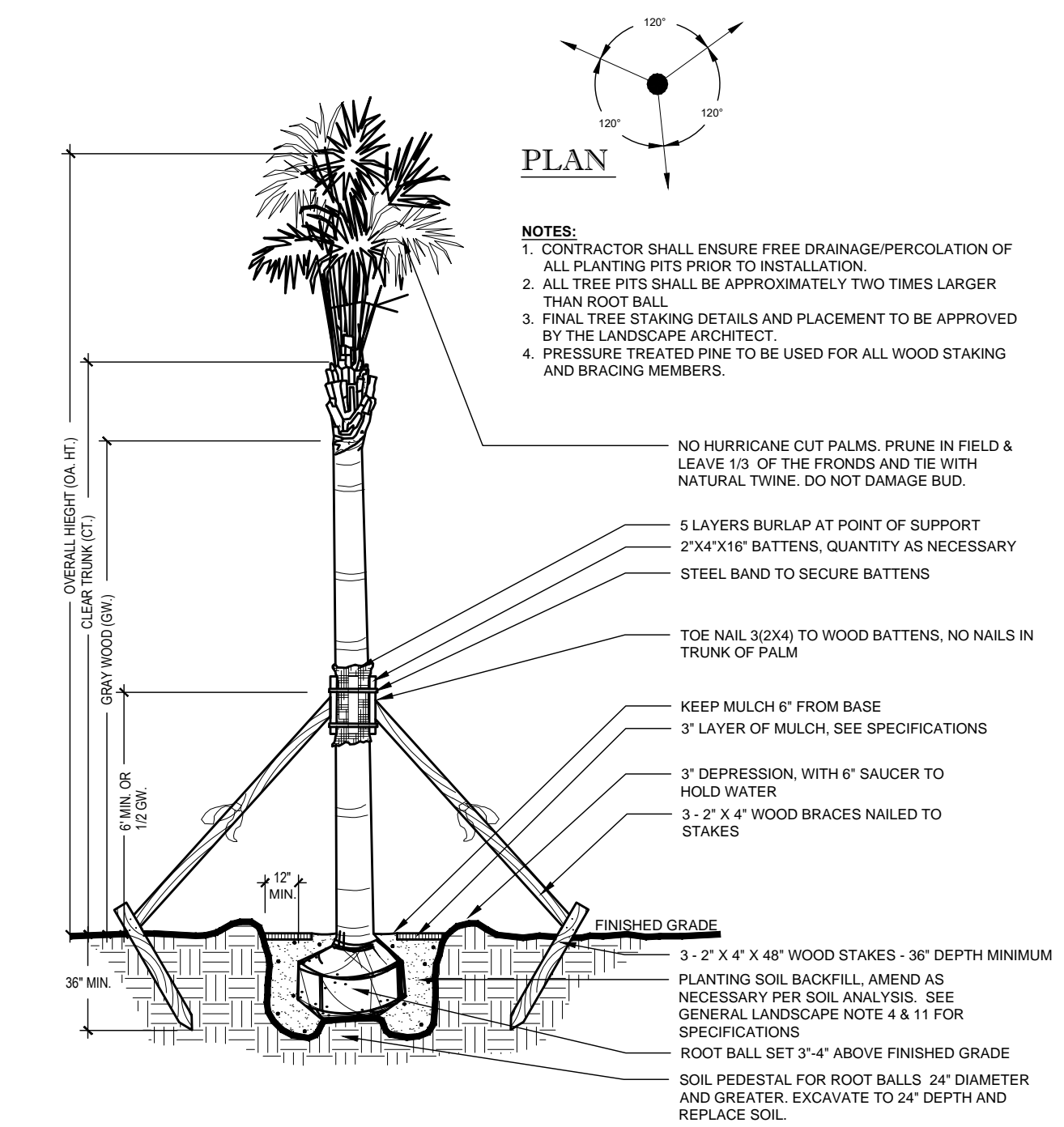

6 SABAL PALM TREE  
SCALE: NTS

**GENERAL PLANTING NOTES:**

- NUISANCE, EXOTIC PLANT SPECIES REMOVAL SHALL BE COMPLETED IN ACCORDANCE WITH SECTIONS OF THE MUNICIPAL REGULATIONS, GUIDELINES AND STANDARDS.
- ALL PLANT MATERIAL SHALL BE FLORIDA NO. 1 OR BETTER, AS SET FORTH BY THE LATEST EDITION OF FLORIDA GRADES AND STANDARDS.
- PLANT MATERIAL SHALL BE LOCAL FLORIDA NURSERY STOCK.
- THE LANDSCAPE CONTRACTOR SHALL NOTIFY THE OWNER OF ANY IMPROPER SOIL CONDITIONS (WETNESS, MUCK, DEBRIS, ETC.) PRIOR TO INSTALLATION. THE CONTRACTOR IS RESPONSIBLE FOR ALL SOIL AMENDMENTS AND/OR FERTILIZER RECOMMENDED BY THE REQUIRED SOIL ANALYSIS REPORT FOR HEALTHY, VIGOROUS PLANT GROWTH. SEE NOTE 11.
- ALL PLANT MATERIAL HOLES SHALL BE HAND DUG EXCEPT WHERE MACHINE DUG HOLES WILL NOT ADVERSELY AFFECT OR DAMAGE UTILITIES OR PROJECT IMPROVEMENTS.
- THE LANDSCAPE CONTRACTOR SHALL BE RESPONSIBLE FOR MAINTAINING ALL LANDSCAPE ELEMENTS UNTIL CONSTRUCTION IS COMPLETE AND ACCEPTED BY THE OWNER'S REP. THIS MAINTENANCE SHALL INCLUDE BUT NOT BE LIMITED TO MOWING, EDGING AND TRIMMING GRASS, KEEPING PLANTING BEDS FREE OF DEBRIS AND WEEDS, MANAGING ALL DISEASE OR INFESTATION, WATERING OF PLANT MATERIALS, AND MAINTAINING MULCH.
- ALL PLANT MATERIAL SHALL BE GUARANTEED FOR A PERIOD OF 1 YEAR FROM THE DATE OF COMPLETION OF CONSTRUCTION.
- PRIOR TO CONSTRUCTION, THE CONTRACTOR SHALL VERIFY AND STAKE ALL UTILITIES. A MINIMUM OF TEN FEET SEPARATION IS REQUIRED BETWEEN UTILITIES AND TREE PLANTINGS. IN ADDITION, ALL TREES SHALL BE LOCATED AT LEAST SIX FEET AWAY FROM THE FLOW LINE OF SWALES AND PROPOSED OR EXISTING STORM WARE INLETS.
- NEW PLANT MATERIAL TO BE INSTALLED WILL BE FIELD ADJUSTED TO ACCOMMODATE EXISTING PLANT MATERIAL SUCH AS OVERHEAD CANOPY TREES, UNDER-STORY TREES AND SHRUBS OR GROUND COVER. THIS WILL ENSURE EXISTING PLANT MATERIAL TO REMAIN IN ITS NATURAL STATE. THEREFORE, NO EXISTING PLANT MATERIAL WILL BE ALTERED BY REMOVING, CUTTING TRIMMING OR DESTROYING IN ORDER TO INSTALL NEW PLANT MATERIAL.
- ALL PLANT MATERIALS TO BE CONTAINER GROWN UNLESS OTHERWISE SPECIFIED. BAG GROWN PLANTS ARE NOT ACCEPTABLE.
- THE PLANTING SOIL USED IN THE PLANTING OPERATIONS SHALL BE A MIXTURE OF 50% COMPOSTED ORGANIC MATTER AND 50% CLEAN NATIVE TOPSOIL. THE EXISTING TOPSOIL SHALL BE TESTED AND CONSIST OF NATURAL, FRIABLE, FINE LOAM SOIL WITH A pH OF 5.5 TO 7.0, AND 0-5% ORGANIC MATTER. IT SHALL BE FREE OF WEED SEEDS, PATHOGENS, LITTER, SOD, CLAY, ROAD BASE, STONES, ROOTS AND STUMPS. SOIL DEPTH SPECIFIED ON THE PLANS IS MEASURED AFTER LIGHT COMPACTION. TOP SOIL THAT DOES NOT MEET THIS SPEC SHALL BE SUBSTITUTED WITH PROPER BORROW SOIL. SEE NOTE 4.
- BED PREPARATION: LOOSEN SOIL TO A MINIMUM DEPTH OF TWELVE INCHES AND REMOVE ALL DEBRIS. RE-GRADE THE BED TO ITS ORIGINAL GRADE. DIG PLANTING PITS AT 2 TIMES THE DIAMETER OF THE POT. FILL PLANT PIT WITH SPECIFIED PLANTING MIX AND COMPACT SO THAT THE TOP OF ROOT BALL WILL SETTLE 1/8 DEPTH OF THE ROOT BALL ABOVE FINISH GRADE. SET PLANT AND FILL REMAINDER OF HOLE WITH PLANTING MIX. FERTILIZE EACH PLANT WITH THE RECOMMENDED RATE BASED ON SOIL ANALYSIS AND RECOMMENDATIONS. WATER IN THOROUGHLY. RESET ANY PLANTS THAT SETTLE TOO DEEP. REMOVE SPILL SOIL AND RAKE THE BED TO ITS FINISH GRADE.
- MULCH ALL BED AREAS WITH A 3\"/>

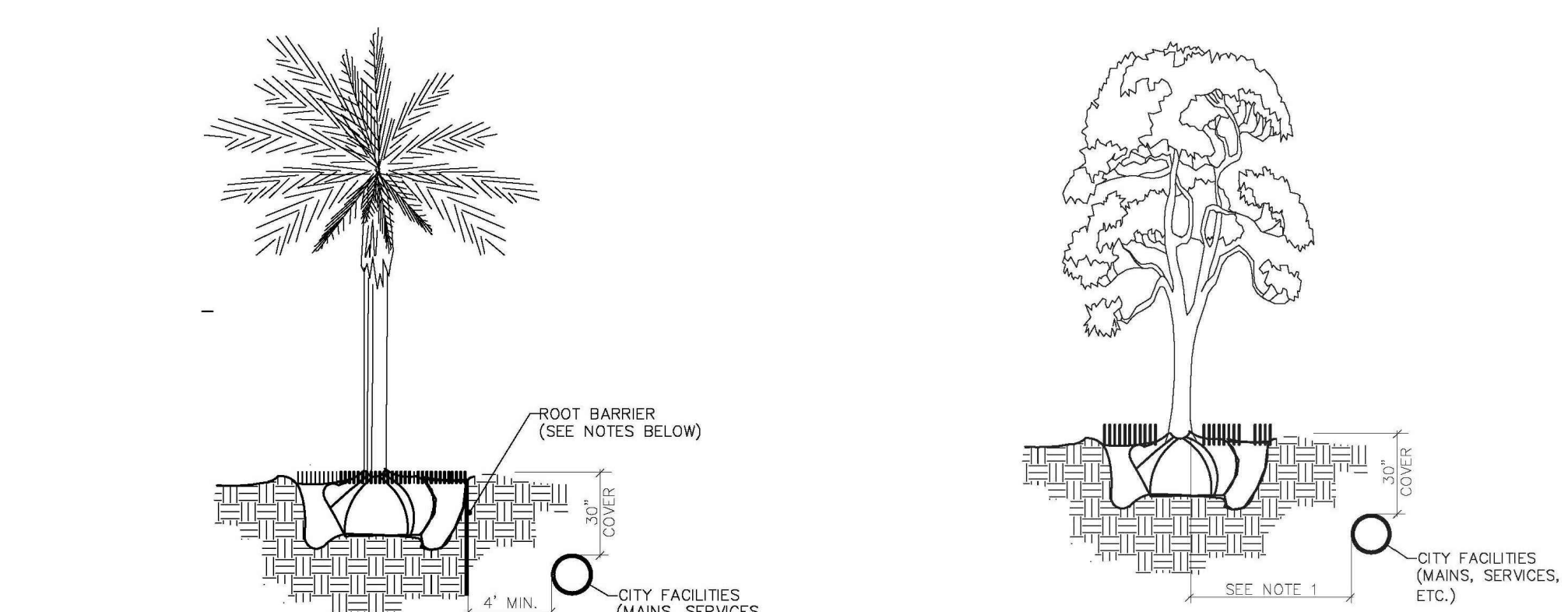

- NOTES:**
- ALL ROOT BARRIERS SHALL BE 4\"/>
- NOTES:**
- THIS DISTANCE SHALL BE 10\"/>

7 LANDSCAPE ROOT BARRIER DETAIL  
SCALE: NTS

**REGISTERED LANDSCAPE ARCHITECT**  
LA-0001660  
STATE OF FLORIDA

**SCOTT BARBER DESIGNS P.A.**  
LANDSCAPE ARCHITECTURE & PLANNING  
LC-26000593

1551 WYNDCLIFF DRIVE  
WELLINGTON, FL 33414  
(561) 309-7263

**DYNAMIC ENGINEERING**  
LAND DEVELOPMENT CONSULTING • PERMITTING  
TRAFFIC • SURVEY • PLANNING & ZONING

100 NE 5th Avenue, Suite B2  
Delray Beach, FL 33483  
T: 561-921-8570

Offices conveniently located at:  
Largo, FL • T: 727-974-0191  
Clermont, FL • T: 352-979-7229  
Hialeah, FL • T: 954-755-7200  
Tampa, FL • T: 727-974-0195  
Newport News, VA • T: 757-660-0758  
Arlene, VA • T: 757-654-9120  
Houston, TX • T: 281-399-4400  
A-16, TX • T: 371-246-2464  
Delray Beach, FL • T: 561-921-8570

Florida Certificate of Authorization No. 32355  
[www.dynamiccec.com](http://www.dynamiccec.com)

DRAWN BY:	SUB	CHECKED BY:	AP	
DESIGNED BY:	SUB	APPROVED BY:	SUB	

PROJECT: TGLENN ENVIRONMENTAL INC. - PROPOSED IMPROVEMENTS  
2401 NW 24TH AVENUE  
POMPANO BEACH, FLORIDA 33069

REV.	DATE	COMMENTS

THIS PLAN SET IS FOR PERMITTING PURPOSES ONLY AND MAY NOT BE USED FOR CONSTRUCTION

**DYNAMIC ENGINEERING**  
LAND DEVELOPMENT CONSULTING • PERMITTING  
GEOTECHNICAL • ENVIRONMENTAL  
TRAFFIC • SURVEY • PLANNING & ZONING

100 NE 5th Avenue, Suite B2  
Delray Beach, FL 33483  
T: 561-921-8570

Offices conveniently located at:  
Largo, FL • T: 727-974-0191  
Clermont, FL • T: 352-979-7229  
Hialeah, FL • T: 954-755-7200  
Tampa, FL • T: 727-974-0195  
Newport News, VA • T: 757-660-0758  
Arlene, VA • T: 757-654-9120  
Houston, TX • T: 281-399-4400  
A-16, TX • T: 371-246-2464  
Delray Beach, FL • T: 561-921-8570

Florida Certificate of Authorization No. 32355  
[www.dynamiccec.com](http://www.dynamiccec.com)

811

PROTECT YOURSELF  
ALL STATES REQUIRE NOTIFICATION OF  
EXCAVATIONS, REPAIRS, OR ANY PERSON  
PREPARING TO DISTURB THE EARTH'S  
SURFACE AND/OR IN ANY STATE  
Call before you dig  
FOR STATE SPECIFIC DIRECT PHONE NUMBERS VISIT:  
[WWW.CALL811.COM](http://WWW.CALL811.COM)

TITLE: LANDSCAPE DETAILS

SCALE: (AS NOTED)	DATE: 8/30/23
PROJECT No: 23.020.09	SHEET No: LP-2
REV. #:	0