

SECTION NO(S): 86130000
S.R. NO.(S): 849
COUNTY: Broward
PERMIT NO.: 2022-L-491-00005

**DISTRICT FOUR (4) AMENDMENT NUMBER TWENTY-THREE (23) TO
STATE OF FLORIDA DEPARTMENT OF TRANSPORTATION
INCLUSIVE LANDSCAPE MAINTENANCE MEMORANDUM OF AGREEMENT**

This is Amendment Number Twenty-Three (23) to the Agreement dated December 5, 2007, made and entered into this _____ day of _____ 20____ by and between the State of Florida Department of Transportation hereinafter called the “**DEPARTMENT**” and the **CITY OF POMPANO BEACH**, a municipal corporation of the State of Florida, hereinafter called the “**AGENCY**”.

WHEREAS, the parties entered into the Inclusive Landscape Maintenance Memorandum of Agreement dated December 5, 2007 for the purpose of maintaining the landscape improvements by the AGENCY on various State Road(s) including State Road 849 (NW 31st Avenue / Atlantic Blvd. Extension); and

WHEREAS, the DEPARTMENT and the AGENCY have agreed to add additional landscape improvements to be installed on State Road 849 (NW 31st Avenue) in accordance with the above referenced Agreement; and

NOW THEREFORE, for and in consideration of mutual benefits that flow each to the other, the parties covenant and agree as follows:

1. Pursuant to paragraph 1, page 1 of the Amendment Number Six (6) Landscape Inclusive Maintenance Memorandum of Agreement dated August 9, 2013, the DEPARTMENT will allow an adjacent property owner to construct additional landscape improvements or to modify an improvement located as indicated in **Exhibit “A”**, in accordance with the plans attached as **Exhibit “B”**.
2. The AGENCY shall agree to maintain the additional landscape improvements according to **Exhibit “F”** Maintenance Plan of the original agreement, Amendment #21, and as follows:

PART II. SPECIFIC PROJECT SITE MAINTENANCE REQUIREMENTS AND RECOMMENDATIONS

Project includes city required street trees, relocated palms, sod and irrigation.

Existing trees shall continue to be maintained to allow for visibility under the canopy and to keep the sidewalk and roadway clear of overhead obstructions. The proposed Oaks shall be likewise maintained as they mature, to allow for visibility into the site and to the price sign. Routine pruning and trimming may be required and regular intervals to maintain these conditions.

Except as modified by this Amendment, all terms and conditions of the original AGREEMENT shall remain in full force and effect.

LIST OF EXHIBITS

Exhibit A – Landscape Improvements Maintenance Boundaries

Exhibit B – Landscape Improvement Plan

In Witness whereof, the parties hereto have executed this Amendment effective the day and year first above written.

CITY OF POMPANO BEACH

By: _____
Chairperson/Mayor/Manager

Attest: _____(SEAL)
Clerk

Legal Review Date

STATE OF FLORIDA
DEPARTMENT OF TRANSPORTATION

By: _____
Transportation Development Director

Attest: _____
Executive Secretary

Legal Review Date

Office of the General Counsel

SECTION NO(S): 86130000
S.R. NO.(S): 849
COUNTY: Broward
PERMIT NO.: 2022-L-491-00005

EXHIBIT A

**LANDSCAPE IMPROVEMENTS
MAINTENANCE BOUNDARIES**

I. PERMIT PROJECT LANDSCAPE IMPROVEMENTS MAINTENANCE LIMITS:

State Road 849 (NW 31st Avenue) from M.P. 3.151 to M.P. 3.201

**II. ORIGINAL INCLUSIVE LANDSCAPE MAINTENANCE AGREEMENT LIMITS
FOR STATE ROAD 849 (NW 31st Avenue):**

State Road 849 (NW 31st Avenue) from M.P. 2.271 (Coconut Creek Road) to
M.P. 3.228 (Atlantic Blvd.)

III. LANDSCAPE IMPROVEMENTS MAINTENANCE BOUNDARY MAP:

Please See Attached

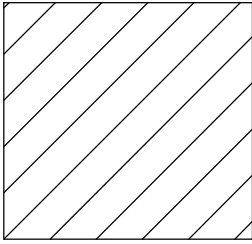
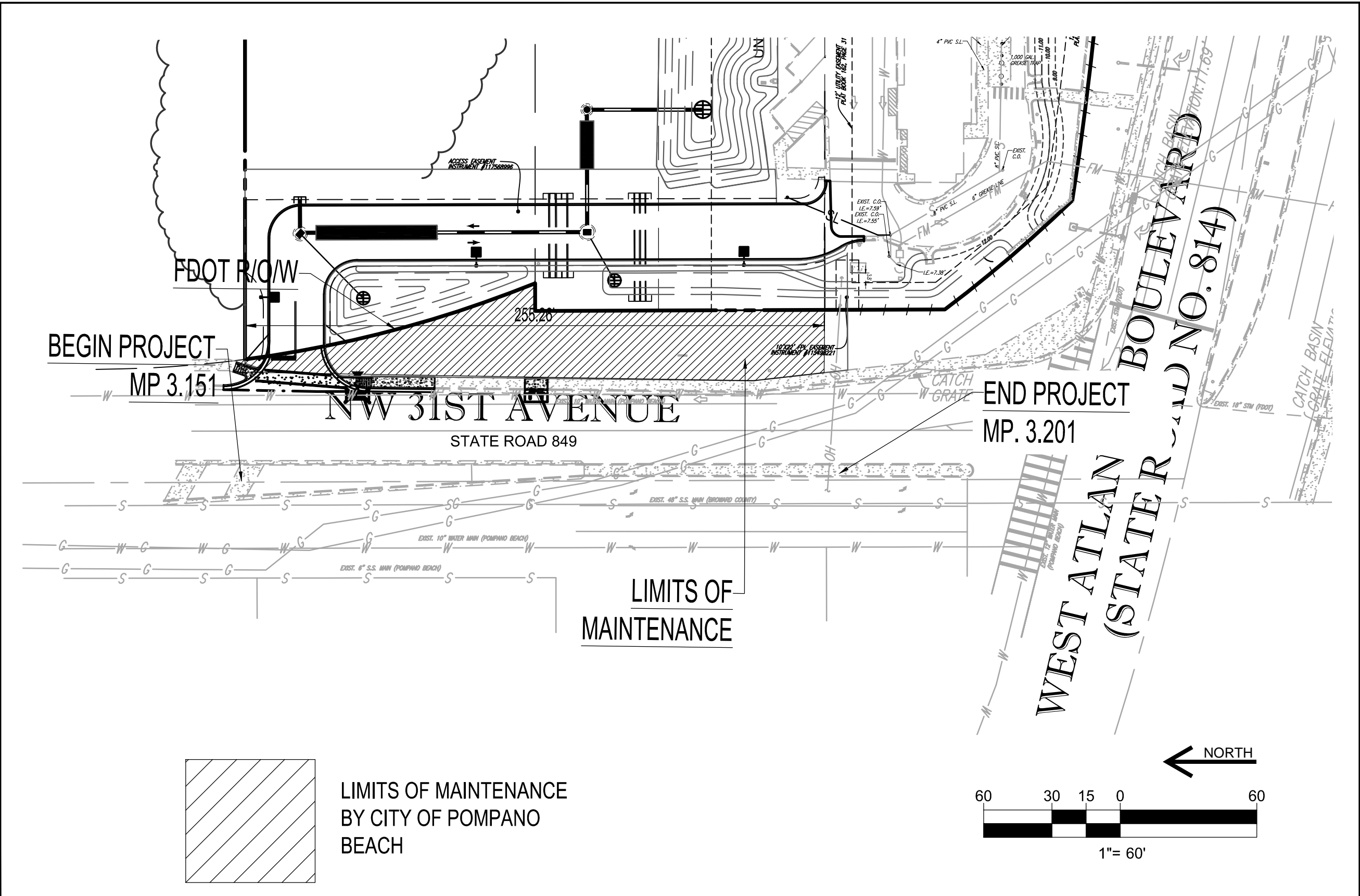

LIMITS OF MAINTENANCE
BY CITY OF POMPANO
BEACH

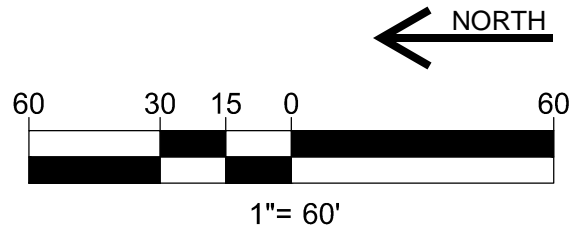

PROJECT: POPEYE'S CENTER CROSS ACCESS ROADWAY	
NW 31ST AVE, POMPANO BEACH, FL	
PROJECT NO: F190114	DATE: 05/17/2022
PREPARED BY: MDG	SCALE: 1" = 60'
FDOT LANDSCAPE PERMIT NO.:	2022-L-491-00005

**LANDSCAPE IMPROVEMENT
MAINTENANCE BOUNDARY
MAP**

6300 NW 31ST AVENUE, FT. LAUDERDALE, FL 33309 - TEL: (954)202-7000

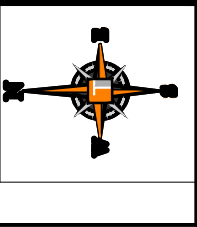

SECTION NO(S): 86130000
S.R. NO.(S): 849
COUNTY: Broward
PERMIT NO.: 2022-L-491-00005

EXHIBIT B

LANDSCAPE IMPROVEMENT PLANS

The AGENCY agrees to install the landscape improvements in accordance with the plans and specifications attached hereto and incorporated herein.

Please see attached plans prepared by: Michael Grosswirth, RLA
Thomas Engineering Group

Date: July 18, 2022

- FDOT GENERAL NOTES**
1. GOVERNING STANDARD PLANS: Florida Department of Transportation, FY 2022-23 Standard Plans for Road and Bridge Construction and applicable Interim Revisions (IRs). website: <https://www.fdot.gov/design/standards/plans>
 2. GOVERNING STANDARD SPECIFICATIONS: Florida Department of Transportation, July 2022 Standard Specifications for Road and Bridge Construction. website: <https://www.fdot.gov/programmanagement/implemented/specbooks>
 3. Contractor shall repair all damage done to FDOT property during demolition, relocation &/or installation activities at his sole expense.
 4. Any plant material substitution within or impacting the FDOT Right of Way whether requested by the Contractor, Owner, Landscape Architect or other will need to get approval from the FDOT District Landscape Architect.
 5. Ownership of all suitable excavated materials, as determined by the Department, shall remain in the Department until a final acceptance of the permitted project is fulfilled. Excavated materials shall be hauled by the Permittee, at their cost & expense from the site to the Broward Operations Center or stockpiled in those areas as directed by the Department, including asphalt millings.

- FDOT PLANTING NOTES**
1. For the portion of landscape plant material that will be installed within the FDOT Right of Way, landscape installation shall comply with current applicable FDOT Maintenance Specification 580. Online Reference: <https://www.fdot.gov/programmanagement/maintenance/2019-lan/maintenance-specifications-july-2020>
 2. For the portion of landscape plant material that will be installed within the FDOT Right of Way refer to the FDOT Standard Plans Index 580-001 Landscape Installation. Online Reference: <https://www.fdot.gov/design/standards/plans/2021/580-001/landscape-installation>
 3. Cypress Mulch is not permitted on FDOT right of way. Mulch permitted to be used are Hardwood Mulch (containing no Cypress products), Recycled Mulch or approved equal, certified by the Mulch and Soil Council (MSC). Submit proof of certification to the FDOT District Operations Permit Landscape Inspector upon inspection.
 4. Sodded areas will be in accordance with Standard Plans Index 570-010 and Standard Specifications Sections 162, 570, 981, 982, 983, 987 of the Department's latest edition of Governing Design Standards and Standard Specifications. All disturbed areas will be sodded within one (1) week of installation of said permitted work.

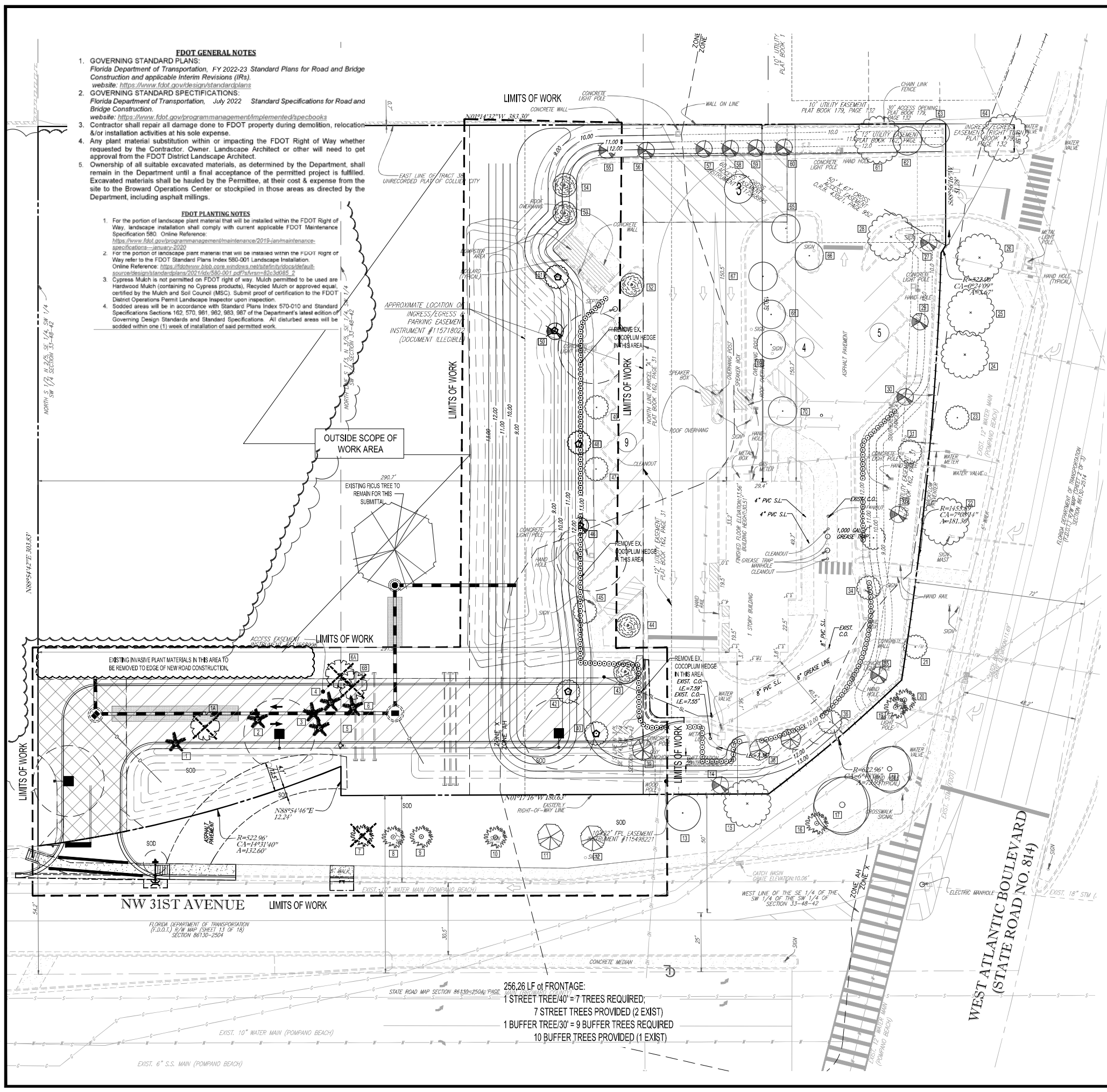

Michael D Grosswirth
 Digitally signed by Michael D Grosswirth
 DN: c=US, o=THOMAS ENGINEERING GROUP LLC, ou=A01410C000001720E31831F0000EAC, cn=Michael D Grosswirth
 Date: 2022.07.18 13:32:26 -04'00'

TREES TO BE REMOVED SHALL BE CUT DOWN TO THE STUMP 12-16" ABOVE GRADE. APPLY POTASSIUM NITRATE BASED PRODUCT (TBD) TO REMAINING STUMP TO INITIATE ROTTING OF THE STUMP FOR REMOVAL. SUBMIT PRODUCT SPECIFICATION TO LANDSCAPE ARCHITECT FOR REVIEW AND APPROVAL BY THE CITY OF POMPANO BEACH URBAN FORESTER.

ALL TREE WORK TO BE PERFORMED BY A BROWARD COUNTY REGISTERED TREE TRIMMER.

PLEASE SEE SHEET L-1.1 FOR TREE DISPOSITION CHART

UNLESS OTHERWISE SPECIFIED, ALL EXISTING HEDGES, SHRUBS AND GROUND COVERS OUTSIDE THE SCOPE OF WORK AREA SHALL REMAIN AND BE PROTECTED.

IT IS REQUIRED TO HAVE A PRE-CONSTRUCTION MEETING WITH THE URBAN FORESTRY STAFF PRIOR TO COMMENCEMENT OF ANY LANDSCAPE WORK OR SITE WORK AFFECTING EXISTING TREES. CONTACT WADE COLLUM AT 954-545-7766 or wade.collum@copbf.com

NOTE: SEVERAL TREES SCHEDULED TO REMAIN MAY REQUIRE STRUCTURAL BRACING, CABLING AND CROWN REDUCTION TO IMPROVE STABILITY AND INTEGRITY OF THE TREE. WORK SHALL BE PERFORMED, IF NECESSARY, BY AN BOARD CERTIFIED MASTER ARBORIST.

NOTE: TREES SCHEDULED TO REMAIN WHICH EXIST ADJACENT TO INTERIOR DRIVE AISLES, SHALL BE ROOT PRUNED AS NEEDED UNDER THE SUPERVISION OF AN ISA CERTIFIED ARBORIST AND IN ACCORDANCE WITH DETAIL ON SHEET L-1.1

FDOT PERMIT NUMBER: 2022-L-491-0005

THOMAS ENGINEERING GROUP
 CIVIL ENGINEERS - PROJECT MANAGERS - LAND PLANNING - LANDSCAPE ARCHITECTS
 4800 NW 31ST AVENUE SUITE 206 FORT LAUDERDALE, FL 33309
 P: 954-602-7000 F: 954-791-4100
 125 W. KENNEDY BLVD. SUITE 206 FORT LAUDERDALE, FL 33309
 P: 954-202-7933 F: 954-202-7933

REV.	DATE	COMMENT	BY

811 KNOW WHAT'S BELOW ALWAYS CALL 811 BEFORE YOU DIG
 www.callsunshine.com

PROJECT No.: F190114
 DRAWN BY: CAD
 CHECKED BY: ROT
 DATE: 02/14/2020
 CAD L.D.: F190114-TREE DISPOSITION PLAN

POPEYE'S CENTER CROSS-ACCESS ROADWAY
 FOR
NW 31ST AVE LLC

3051 W. ATLANTIC BLVD.
 CITY OF POMPANO BEACH
 FLORIDA

THOMAS ENGINEERING GROUP
 6300 NW 31ST AVENUE FORT LAUDERDALE, FL 33309
 PH: (954) 202-7000
 FX: (954) 202-7070
 www.ThomasEngineeringGroup.com

MICHAEL D. GROSSWIRTH
 REGISTERED LANDSCAPE ARCHITECT
 July 18, 2022
 FLORIDA LICENSE No. 198871
 FLORIDA BUSINESS REGISTRATION No. 27528

SHEET TITLE:
TREE DISPOSITION PLAN
 SHEET NUMBER:
L-1.0

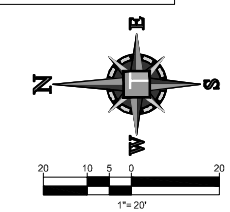

Printed on Monday, July 18, 2022, 1:19 PM by Michael Grosswirth

ANY EXISTING SOD IN RIGHT-OF-WAY OR ON ADJACENT PROPERTY DAMAGED DURING CONSTRUCTION, SHALL BE REPLACED WITH SAME SOD SPECIES BY CONTRACTOR.

PLANT SPACING SHALL SUPERCEDE PLANT QUANTITY TO FILL LANDSCAPE BED.

IT IS REQUIRED TO HAVE A PRE-CONSTRUCTION MEETING WITH THE URBAN FORESTRY STAFF PRIOR TO COMMENCEMENT OF ANY LANDSCAPE WORK OR SITE WORK AFFECTING EXISTING TREES. CONTACT WADE COLLUM AT 954-545-7766 or wade.collum@copbl.com

NOTE: ALL EXISTING SOIL, WITHIN LANDSCAPE AREAS ADJACENT TO VEHICULAR USE AREAS IS REQUIRED TO BE REMOVED, INSPECTED AND THEN REPLACED WITH A 60/40 MIX OF SAND TO TOPSOIL. (SEE L-2.2); ALL ROAD ROCK, CONCRETE, ASPHALT, & OTHER NON-NATURAL MATERIAL WITHIN LANDSCAPE AREAS IS REQUIRED TO BE REMOVED AND BE REPLACED WITH PLANTING SOIL PRIOR TO LANDSCAPE INSTALLATION

ALL HEDGED ABUTTING CITY RIGHTS OF WAY SHALL BE MAINTAINED AT A HEIGHT NO GREATER THAT 24".

REFER TO SHEET L-2.1 FOR PLANT MATERIALS, CODE REQUIREMENT CHART, COST ESTIMATE AND PLANTING DETAILS, AND SHEET L-2.2 FOR LANDSCAPE GENERAL NOTES.

PER CITY ORDINANCE SEC 50.02(A)(4) AND SEC 100.35(E), STREET TREES SHALL NOT BE PLACED ON TOP OF OR 5' TO EITHER SIDE OF ANY CITY OWNER UTILITY INFRASTRUCTURE. ALSO, PLEASE NOTE THAT NO TREES, SHRUBBERY OR OBSTRUCTION SHALL BE PLACED WITHIN A 3' RADIUS OF A CITY OWNED LATERAL CLEANOUT OR WATER AND/OR REUSE METER.

NOTE: ALL ABOVE GROUND MECHANICAL EQUIPMENT SUCH AS, BUT NOT LIMITED TO, EXTERIOR UTILITY BOXES, METERS, AND TRANSFORMERS NOT CURRENTLY KNOWN OR DEPICTED SHALL BE VISUALLY SCREENED A MINIMUM OF 6" ABOVE TOP OF EQUIPMENT. BACK FLOW PREVENTERS SHALL BE PAINTED TO MATCH THE PRINCIPAL STRUCTURE.

IRRIGATION SYSTEM TO PROVIDE 100% COVERAGE WITH 50% OVERLAP.

PLANT SCHEDULE			
TREES	QTY	COMMON NAME	BOTANICAL NAME
BS	16	Gumbo Limbo	Bursera simaruba
SM	5	West Indian Mahogany	Swietenia mahagoni
RELOCATED TREES	QTY	COMMON NAME	BOTANICAL NAME
QVR	4	Southern Live Oak	Quercus virginiana
TDR	2	Bald Cypress	Taxodium distichum
VMR	6	Adonidia Palm	Veitchia merillii
SHRUBS	QTY	COMMON NAME	BOTANICAL NAME
CH1	158	Red Tip Coccoloba	Chrysobalanus icaco 'Red Tip'
SOD	QTY	COMMON NAME	BOTANICAL NAME
PAS	10,052 sf	Bahia Grass	Paspalum notatum
SOD/SEED	QTY	COMMON NAME	BOTANICAL NAME
SOD	15,591 sf	Floritam St. Augustine Sod	Stenotaphrum secundatum 'Floritam'

Michael D Grosswirth
 Digitally signed by Michael D Grosswirth
 DN: c=US, o=THOMAS ENGINEERING GROUP LLC, ou=A01410C00000172 0E31831F0000EFAFC, cn=Michael D Grosswirth
 Date: 2022.07.18 13:33:12 -04'00'

FDOT PERMIT NUMBER: 2022-L-491-00005

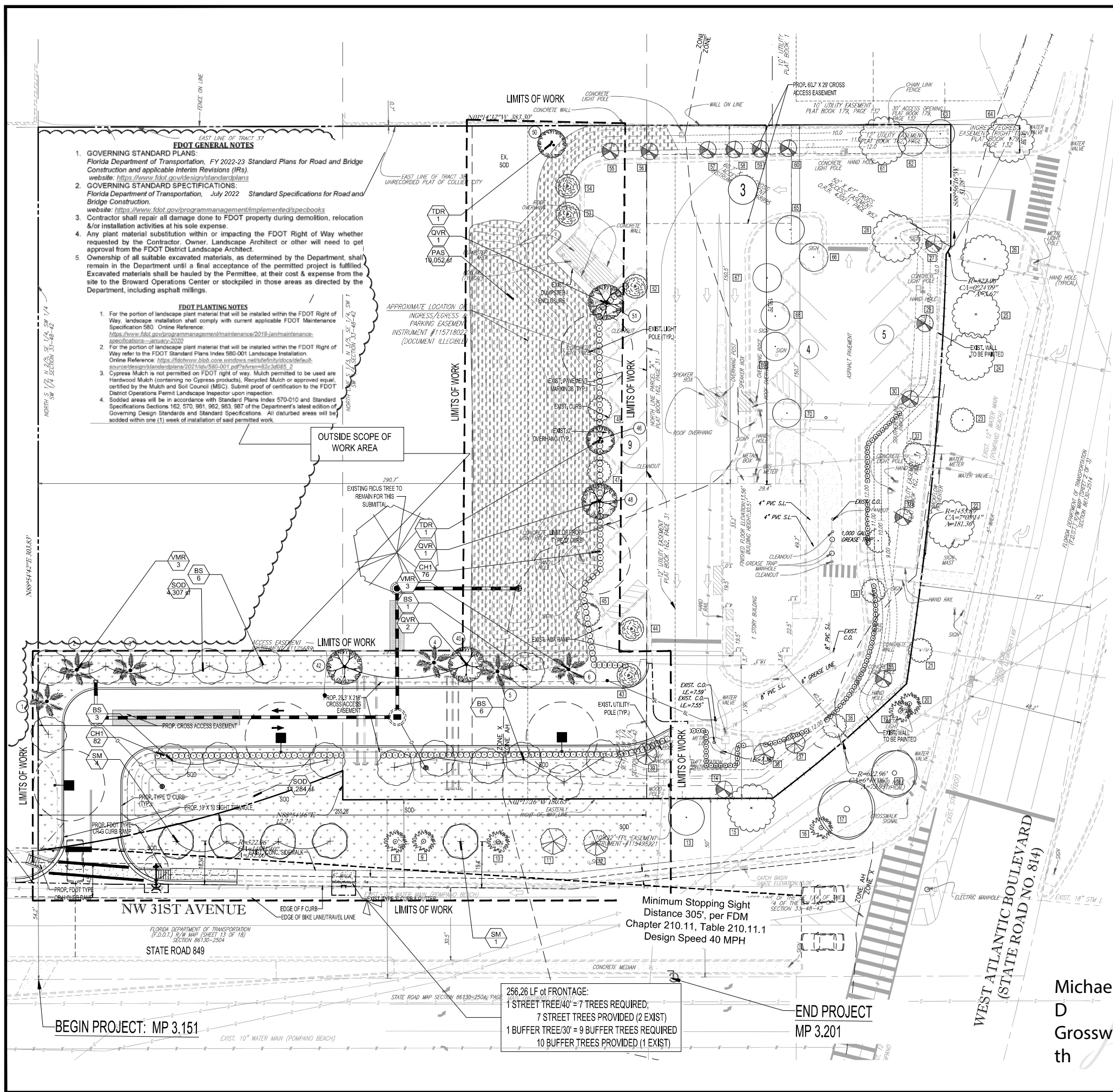
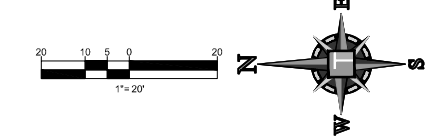

- GOVERNING STANDARD PLANS:**
 Florida Department of Transportation, FY 2022-23 Standard Plans for Road and Bridge Construction and applicable Interim Revisions (IRs).
 website: <https://www.fdot.gov/roads/standards/standardplans>
- GOVERNING STANDARD SPECIFICATIONS:**
 Florida Department of Transportation, July 2022 Standard Specifications for Road and Bridge Construction.
 website: <https://www.fdot.gov/programmanagement/implemented/specbooks>
- Contractor shall repair all damage done to FDOT property during demolition, relocation &/or installation activities at his sole expense.
 - Any plant material substitution within or impacting the FDOT Right of Way whether requested by the Contractor, Owner, Landscape Architect or other will need to get approval from the FDOT District Landscape Architect.
 - Ownership of all suitable excavated materials, as determined by the Department, shall remain in the Department until a final acceptance of the permitted project is fulfilled. Excavated materials shall be hauled by the Permittee, at their cost & expense from the site to the Broward Operations Center or stockpiled in those areas as directed by the Department, including asphalt millings.

- FDOT PLANTING NOTES**
- For the portion of landscape plant material that will be installed within the FDOT Right of Way, landscape installation shall comply with current applicable FDOT Maintenance Specification 580. Online Reference: <https://www.fdot.gov/programmanagement/maintenance/2019-ian/maintenance-specifications-580>
 - For the portion of landscape plant material that will be installed within the FDOT Right of Way refer to the FDOT Standard Plans Index 580-001 Landscape Installation. Online Reference: <https://dotfloridaweb.blob.core.windows.net/dotflorida/default-source/standardplans/2019-ian/580-001-landscape-installation-580-001.pdf>
 - Cypress Mulch is not permitted on FDOT right of way. Mulch permitted to be used are Hardwood Mulch (containing no Cypress products), Recycled Mulch or approved equal, certified by the Mulch and Soil Council (MSC). Submit proof of certification to the FDOT District Operations Permit Landscape Inspector upon inspection.
 - Sodded areas will be in accordance with Standard Plans Index 570-010 and Standard Specifications Sections 162, 570, 961, 962, 983, 987 of the Department's latest edition of Governing Design Standards and Standard Specifications. All disturbed areas will be sodded within one (1) week of installation of said permitted work.

256.26 LF of FRONTAGE:
 1 STREET TREE/40' = 7 TREES REQUIRED;
 7 STREET TREES PROVIDED (2 EXIST)
 1 BUFFER TREE/30' = 9 BUFFER TREES REQUIRED
 10 BUFFER TREES PROVIDED (1 EXIST)

Minimum Stopping Sight Distance 305', per FDM Chapter 210.11, Table 210.11.1 Design Speed 40 MPH

THOMAS ENGINEERING GROUP
 CIVIL ENGINEERS - PROJECT MANAGERS - LAND PLANNING - LANDSCAPE ARCHITECTS
 6300 NW 31ST AVENUE SUITE 206 FORT LAUDERDALE, FL 33309
 P: (954) 202-7000 F: (954) 202-7003
 125 W INDIANTOWN RD SUITE 206 FT. LAUDERDALE, FL 33309
 P: (954) 202-7000 F: (954) 202-7003

REVISIONS:			
REV.	DATE:	COMMENT:	BY:

811 KNOW WHAT'S BELOW ALWAYS CALL 811 BEFORE YOU DIG
 www.callsunshine.com

PROJECT No: F190114
 DRAWN BY: CAD
 CHECKED BY: ROT
 DATE: 02/14/2020
 CAD I.D.: F190114-LANDSCAPE ROAD-FDOT

POPEYE'S CENTER CROSS-ACCESS ROADWAY
 FOR
NW 31ST AVE LLC

3051 W. ATLANTIC BLVD.
 CITY OF POMPADINO BEACH
 FLORIDA

THOMAS ENGINEERING GROUP
 6300 NW 31ST AVENUE SUITE 206 FORT LAUDERDALE, FL 33309
 PH: (954) 202-7000 FX: (954) 202-7000
 www.ThomasEngineeringGroup.com

MICHAEL D. GROSSWIRTH
 REGISTERED LANDSCAPE ARCHITECT
 July 18, 2022
 FLORIDA LICENSE NO. 198971
 FLORIDA BUSINESS REGISTRATION NO. 27528

SHEET TITLE:
LANDSCAPE ROAD-FLAN PLAN
 SHEET NUMBER:
L-2.0

PLANT SCHEDULE

TREES	QTY	COMMON NAME	BOTANICAL NAME	SPECIFICATIONS	CAL/DBH	HEIGHT	SPREAD	NATIVE	XERIC	REMARKS	
BS	16	Gumbo Limbo	Bursera simaruba	B & B	3"Cal	16' Ht	5-6'	Yes	High	4' CT	
SM	5	West Indian Mahogany	Swietenia mahagoni	B & B	3"Cal	16' Ht	5-6'	Yes	High	5' CT	
RELOCATED TREES	QTY	COMMON NAME	BOTANICAL NAME	SPECIFICATIONS	CAL/DBH	HEIGHT	SPREAD	NATIVE	XERIC	REMARKS	
QVR	4	Southern Live Oak	Quercus virginiana	NA	Varies	varies	varies	Yes	Low		
TDR	2	Bald Cypress	Taxodium distichum	NA	As Noted on Sheet L-1.1	As Noted on Sheet L-1.1	As Noted on Sheet L-1.1	Yes	High		
VMR	6	Adonidia Palm	Veitchia merillii	NA	As Noted on Sheet L-1.1	As Noted on Sheet L-1.1	As Noted on Sheet L-1.1	No	Medium		
SHRUBS	QTY	COMMON NAME	BOTANICAL NAME	SPECIFICATIONS	SPACING	HEIGHT	SPREAD	NATIVE	XERIC	REMARKS	
CH1	158	Red Tip Cocoplum	Chrysobalanus icaco 'Red Tip'	NA	30"	36"	36"	Yes	High	Full to base	
SOD	QTY	COMMON NAME	BOTANICAL NAME	SPECIFICATIONS	SPACING	HEIGHT	SPREAD	NATIVE	XERIC	SPACING	REMARKS
PAS	10,052 sf	Bahia Grass	Paspalum notatum	n/a				Yes	High		
SOD/SEED	QTY	COMMON NAME	BOTANICAL NAME	SPECIFICATIONS	SPACING	HEIGHT	SPREAD	NATIVE	XERIC	SPACING	REMARKS
SOD	15,591 sf	Floritam St. Augustine Sod	Stenotaphrum secundatum 'Floritam'	sod				No	Medium		

ALL AREAS LABELED AS "SOD" TO BE STENOTAPHRUM SECUNDATUM, V. 'FLORITAM' SOLID SOD, UNLESS OTHERWISE SPECIFICALLY NOTED. ALL MULCH TO BE PER SPECIFICATION FOUND ON SHEET L-2.2 UNLESS OTHERWISE SPECIFICALLY NOTED. ALL QUANTITY TAKE-OFFS BY CONTRACTOR.

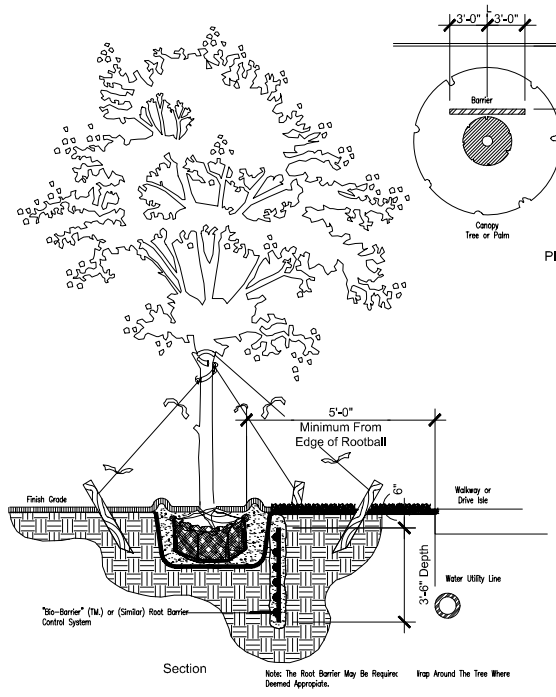

"Bio-Barrier" Is Manufactured By:
 Treemay, Inc., 70 Old Hickory Blvd., P.O. Box 511
 Old Hickory, TN 37138 - Phone: 1-800-25-ROOTS

Applicable Use of Root Barriers:
 If a Canopy Tree and/or Palm Is To Be Installed Within Less Than (10') Ten Feet Separation From A Water Main (or Service) and/or Sewer Main (or Service), The Landscape Contractor Shall Install a Root Barrier Parallel To The Utility As Required and as per This Detail. The Contractor Shall Maintain A (5') Five Feet Minimum Horizontal Distance From Outside Edge of Rootball To The Utility or any Paved or Concrete Surface.

The Landscape Contractor Shall Verify The Existing Locations of The Applicable Water Utilities. In The Field, Prior To Any Tree Installations Requiring A Root Barrier.

Suggested Installation Method:
 Dig A Vertical Trench Between The Root Source of The Tree and The Surface and/or Utility Line To Be Protected. The Trench Must Be At Least 5'-0" In Length (Centered On Tree) and Must Be at Least 4'-0" In Depth Parallel To The Applicable Surface, Service and/or Utility. Note: For New Tree Installations, Trench May Be Dug At The Same Time as The Hole For The Applicable Tree and/or Palm.

Using Impervious Gloves, Roll Out "Bio-Barrier" and Trim To Fit The Specific Application. Insert The Barrier Vertically Into The Trench, With The Top Edge of The Barrier (6") Six Inches Below The Soil Surface.

Tamp Backfill Firmly Into Trench With "Bio-Barrier" Contained, Eliminating Air Pockets or Soil Voids Accordingly. Dissolve The Coating and Activate The Product By Saturating The Backfill and "Bio-Barrier" With Water. After Completed, Smooth The Soil Surface To Finish Grade, Allowing Excess Material For Soil Settling.

TYPICAL ROOT BARRIER APPLICATION DETAIL

NTA

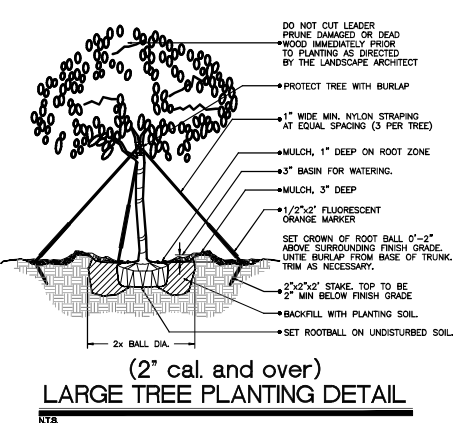

(2" cal. and over) LARGE TREE PLANTING DETAIL

NTA

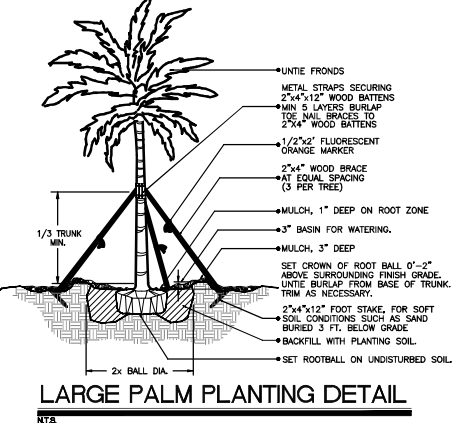

LARGE PALM PLANTING DETAIL

NTA

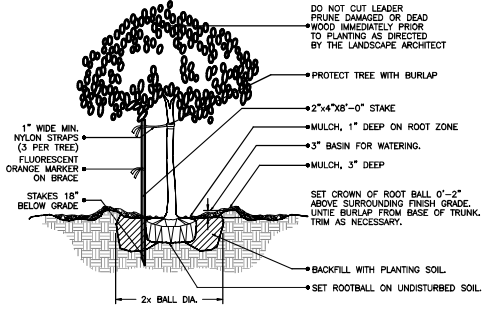

(2" cal. and under) SMALL TREE PLANTING DETAIL

NTA

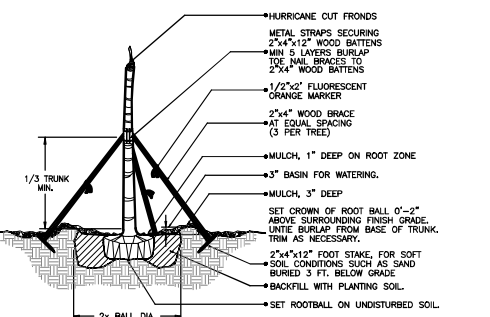

CIGARED SABAL PALM PLANTING DETAIL

NTA

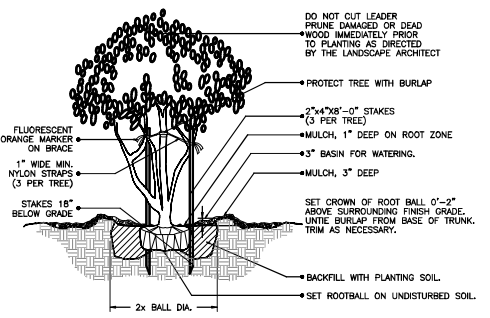

MULTI-TRUNK AND SMALL TREE (2" cal. and under) PLANTING DETAIL

NTA

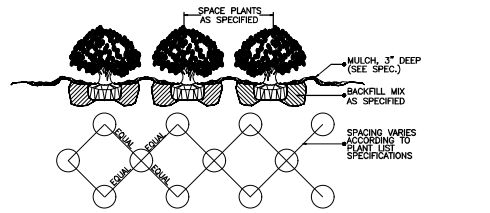

SHRUB / GROUNDCOVER SPACING / PLANTING DETAIL

NTA

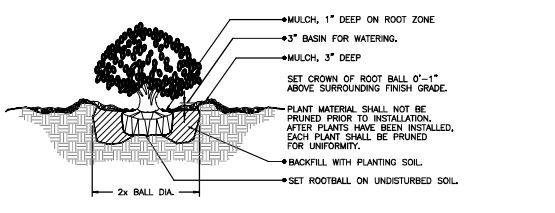

SHRUB PLANTING DETAIL

NTA

Digitally signed by Michael D Grosswirth
 DN: c=US, o=THOMAS ENGINEERING GROUP LLC, ou=A01410C000001720E31831F0000EFAC, cn=Michael D Grosswirth
 Date: 2022.07.18 13:33:28 -04'00'

Michael D Grosswirth

THOMAS ENGINEERING GROUP
 CIVIL ENGINEERS - PROJECT MANAGERS - LAND PLANNING - LANDSCAPE ARCHITECTS
 6300 NW 31ST AVENUE SUITE 200 FORT LAUDERDALE, FL 33309
 4850 W. KENNEDY BLVD. SUITE 200 FT. LAUDERDALE, FL 33309
 P: (954) 202-7000 F: (954) 202-0700
 WWW.THOMASENGINEERINGGROUP.COM

REV.	DATE	COMMENT	BY

811 KNOW WHAT'S BELOW ALWAYS CALL 811 BEFORE YOU DIG
 www.callsunshine.com

PROJECT No: F190114
 DRAWN BY: CAD
 CHECKED BY: ROT
 DATE: 02/14/2020
 CAD I.D.: F190114-LANDSCAPE ROAD/FDOT

POPEYE'S CENTER CROSS-ACCESS ROADWAY
 FOR
NW 31ST AVE LLC

3051 W. ATLANTIC BLVD.
 CITY OF POMPANO BEACH
 FLORIDA

THOMAS ENGINEERING GROUP
 6300 NW 31ST AVENUE FORT LAUDERDALE, FL 33309
 PH: (954) 202-7000
 FX: (954) 202-0700
 www.ThomasEngineeringGroup.com

MICHAEL D. GROSSWIRTH
 REGISTERED LANDSCAPE ARCHITECT
 July 18, 2022
 FLORIDA LICENSE No. 198871
 FLORIDA BUSINESS REGISTRATION No. 27528

SHEET TITLE:
LANDSCAPE ROAD-FDOT

SHEET NUMBER:
L-2.1

FDOT PERMIT NUMBER: 2022-L-491-00005

NOTE! THERE MAY BE EXISTING IRRIGATION IN THE AREA OF THE NEW RETENTION AREA CONSTRUCTION. ANY LINES OR EQUIPMENT THAT IS DAMAGED, DESTROYED OR OTHERWISE DISCONNECTED FROM THE EXISTING SYSTEM, SHALL BE REPAIRED AND/OR REPLACED SO THAT THE SYSTEM MAINTAINS FULL COVERAGE. CONTRACTOR SHALL VISIT THE SITE TO VERIFY ANY EXISTING IRRIGATION WHICH MAY BE AFFECTED.

IT IS REQUIRED TO HAVE A PRE-CONSTRUCTION MEETING WITH THE URBAN FORESTRY STAFF PRIOR TO COMMENCEMENT OF ANY LANDSCAPE WORK OR SITE WORK AFFECTING EXISTING TREES. CONTACT WADE COLLUM AT 954-545-7766 or wade.collum@copbfl.com

REFER TO SHEET L-3.1 FOR IRRIGATION SCHEDULES AND NOTES, AND SHEET L-3.2 FOR IRRIGATION DETAILS.

IRRIGATION SYSTEM TO PROVIDE 100% COVERAGE WITH 50% OVERLAP.

ELECTRICAL POWER FROM EXISTING POPEYE'S TRANSFORMER AND PANEL.

- FDOT GENERAL NOTES**
- GOVERNING STANDARD PLANS: Florida Department of Transportation, FY 2022-23 Standard Plans for Road and Bridge Construction and applicable Interim Revisions (IRs). website: <https://www.fdot.gov/design/standardplans>
 - GOVERNING STANDARD SPECIFICATIONS: Florida Department of Transportation, July 2022 Standard Specifications for Road and Bridge Construction. website: <https://www.fdot.gov/programmanagement/implemented/specbooks>
 - Contractor shall repair all damage done to FDOT property during demolition, relocation &/or installation activities at his sole expense.
 - Any plant material substitution within or impacting the FDOT Right of Way whether requested by the Contractor, Owner, Landscape Architect or other will need to get approval from the FDOT District Landscape Architect.
 - Ownership of all suitable excavated materials, as determined by the Department, shall remain in the Department until a final acceptance of the permitted project is fulfilled. Excavated materials shall be hauled by the Permittee, at their cost & expense from the site to the Broward Operations Center or stockpiled in those areas as directed by the Department, including asphalt millings.

- FDOT PLANTING NOTES**
- For the portion of landscape plant material that will be installed within the FDOT Right of Way, landscape installation shall comply with current applicable FDOT Maintenance Specification 980. Online Reference: <https://www.fdot.gov/programmanagement/maintenance/2019-land/maintenance-specifications-january-2020>
 - For the portion of landscape plant material that will be installed within the FDOT Right of Way refer to the FDOT Standard Plans Index 560.001 Landscape Installation. Online Reference: https://fdotwww.blob.core.windows.net/infiniti/docs/default-source/design/standardplans/2021/560-001.pdf?sfvrsn=62c3a0b5_2
 - Cypress Mulch is not permitted on FDOT right of way. Mulch permitted to be used are Hardwood Mulch (containing no Cypress products), Recycled Mulch or approved equal, certified by the Mulch and Soil Council (MSC). Submit proof of certification to the FDOT District Operations Permit Landscape Inspector upon inspection.
 - Sodded areas will be in accordance with Standard Plans Index 570.010 and Standard Specifications Sections 162, 570, 961, 962, 983, 987 of the Department's latest edition of Governing Design Standards and Standard Specifications. All disturbed areas will be sodded within one (1) week of installation of said permitted work.

EXISTING IRRIGATION IN THIS AREA MAY NEED ADJUSTMENTS TO INSURE NEW HEDGE IS PROPERLY WATERED.

CONNECT TO EXISTING POPEYE'S IRRIGATION SYSTEM. ADJUST EXISTING TIME CLOCK (CONTROLLER) ACCORDINGLY FOR NEW ZONE.

IRRIGATION SCHEDULE

SYMBOL	MANUFACTURER/MODEL/DESCRIPTION	QTY
Q T H TT TO F	Rain Bird 1806-PRS 15 Series MPR Turf Spray 6" pop-up with pressure regulator.	20
4 6 8 10 12 15 18	Rain Bird 1806-PRS ADJ Turf Spray 6" pop-up with pressure regulator.	1
1402 1408 1401 1404	Rain Bird 1804-1400 Flood Flood Bubbler 4" pop-up	33

SYMBOL	MANUFACTURER/MODEL/DESCRIPTION	QTY
25 ARC	Rain Bird 5006-MPR Turf Rotor, 6" pop-up, matched precipitation rotor, arc and radius as per symbol. 25 ft=red, 30 ft=green, 35ft=beige	9
35 ARC	Rain Bird 5006-MPR Turf Rotor, 6" pop-up, matched precipitation rotor, arc and radius as per symbol. 25 ft=red, 30 ft=green, 35ft=beige	7

SYMBOL	MANUFACTURER/MODEL/DESCRIPTION	QTY
⊕	Rain Bird PEB Electric Remote Control Valve	5
⊗	Buckner-Superior AV 3/4", 1", 1-1/4", 1-1/2", and 2" Red Brass Angle Shut Off Valves with Cross Handle.	2
Ⓡ	Rain Bird RSD-BEx Rain Sensor, with bracket, extension wire	1
—	Irrigation Lateral Line: PVC Class 160 SDR 26	1,404 l.f.
---	Irrigation Mainline: PVC Class 200 SDR 21	276.4 l.f.
—	Pipe Sleeve: PVC Schedule 80 Typical pipe sleeve for irrigation pipe. Pipe sleeve size shall allow for irrigation piping and their related couplings to easily slide through sleeving material. Extend sleeves 18 inches beyond edges of paving or construction.	27.8 l.f.

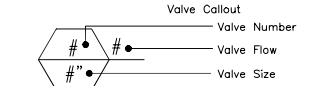

Digitally signed by Michael D Grosswirth
 DN: c=US, o=THOMAS ENGINEERING GROUP LLC, ou=A01410C000001 720E31831F0000EFA C, cn=Michael D Grosswirth
 Date: 2022.07.18 13:34:09 -04'00'

PLEASE SEE SHEET L-3.1 FOR COMPLETE SCHEDULE

- THE IRRIGATION SYSTEM SHALL USE THE LOWEST QUALITY WATER AVAILABLE WHICH SAFELY MEETS THE WATER NEEDS OF THE SYSTEM. STORM WATER, RECLAIM WATER, OR GREY WATER SHALL BE USED WHENEVER POSSIBLE.
- FDOT REQUIRED 24-HOUR EMERGENCY ACCESS TO WATER SOURCE.
- CONTRACTOR SHALL PROVIDE FDOT DISTRICT OPERATIONS MANAGER WITH A SET OF "AS-BUILT" IRRIGATION PLANS.

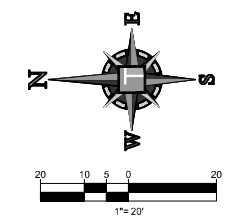

FDOT PERMIT NUMBER: 2022-L-491-00005

THOMAS ENGINEERING GROUP
 CIVIL ENGINEERS - PROJECT MANAGERS - LAND PLANNING - LANDSCAPE ARCHITECTS
 4850 W. KENNEDY BLVD. SUITE 206 FT. LAUDERDALE, FL 33309
 P: 954-626-7000 F: 954-575-4100
 8300 NW 31ST AVENUE SUITE 600 FT. LAUDERDALE, FL 33309
 P: 954-626-7000 F: 954-575-4100
 WE EMPLOY THE LATEST SOFTWARE AND HARDWARE TO PROVIDE THE BEST SERVICE AND VALUE TO OUR CLIENTS. WE ARE AN ISO 9001:2015 CERTIFIED COMPANY.

REVISIONS:

REV.	DATE	COMMENT	BY

811 KNOW WHAT'S BELOW ALWAYS CALL 811 BEFORE YOU DIG
 www.callsunshine.com

PROJECT No.:	F190114
DRAWN BY:	CAD
CHECKED BY:	ROT
DATE:	02/14/2020
CAD I.D.:	F190114RRIGATION ROAD -

POPEYE'S CENTER CROSS-ACCESS ROADWAY
 FOR
NW 31ST AVE LLC

3051 W. ATLANTIC BLVD. CITY OF POMPANO BEACH FLORIDA

THOMAS ENGINEERING GROUP
 8300 NW 31ST AVENUE FORT LAUDERDALE, FL 33309
 PH: (954) 202-7000 FX: (954) 202-7070
 www.ThomasEngineeringGroup.com

MICHAEL D. GROSSWIRTH
 REGISTERED LANDSCAPE ARCHITECT
 July 18, 2022
 FLORIDA LICENSE NO. 99871
 FLORIDA BUSINESS REGISTRATION NO. 27528

SHEET TITLE:
IRRIGATION ROAD - FDOT PLAN

SHEET NUMBER:
L-3.0

IRRIGATION SCHEDULE

SYMBOL	MANUFACTURER/MODEL/DESCRIPTION	QTY	PSI
	Rain Bird 1806-PRS 15 Series MPR Turf Spray 6" pop-up with pressure regulator.	20	30
	Rain Bird 1806-PRS ADJ Turf Spray 6" pop-up with pressure regulator.	1	30
	Rain Bird 1804-1400 Flood Flood Bubbler 4" pop-up	33	40

SYMBOL	MANUFACTURER/MODEL/DESCRIPTION	QTY	PSI	GPM	RADIUS
	Rain Bird 5006-MPR Turf Rotor, 6" pop-up, matched precipitation rotor, arc and radius as per symbol. 25 ft=red, 30 ft=green, 35ft=beige	9	35		24'
	Rain Bird 5006-MPR Turf Rotor, 6" pop-up, matched precipitation rotor, arc and radius as per symbol. 25 ft=red, 30 ft=green, 35ft=beige	7	35		34'

SYMBOL	MANUFACTURER/MODEL/DESCRIPTION	QTY
	Rain Bird PEB Electric Remote Control Valve	5
	Buckner-Superior AV 3/4", 1", 1-1/4", 1-1/2", and 2" Red Brass Angle Shut Off Valves with Cross Handle.	2
	Rain Bird RSD-BEx Rain Sensor, with bracket, extension wire	1
	Irrigation Lateral Line: PVC Class 160 SDR 26	1,404 Lf.
	Irrigation Mainline: PVC Class 200 SDR 21	276.4 Lf.
	Pipe Sleeve: PVC Schedule 80 Typical pipe sleeve for irrigation pipe. Pipe sleeve size shall allow for irrigation piping and their related couplings to easily slide through sleeving material. Extend sleeves 18 inches beyond edges of paving or construction.	27.8 Lf.

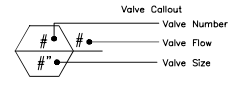

VALVE SCHEDULE

NUMBER	MODEL	SIZE	TYPE	GPM	HEADS	PIPE	WIRE	DESIGN PSI	FRICTION LOSS	PSI	PSI @ POC	PRECIP
1	Rain Bird PEB	1"	Turf Rotor	22.13	7	246.7	37.9	35	1.72	40.19	51.33	0.53 in/h
2	Rain Bird PEB	1-1/2"	Turf Rotor	30.06	9	199.6	27.1	35	1.23	39.83	51.80	0.56 in/h
3	Rain Bird PEB	1"	Bubbler	6.75	27	645.5	17.8	40	0.67	42.40	52.51	7.66 in/h
4	Rain Bird PEB	1"	Turf Spray	20.35	11	153.7	78.7	30	1.15	34.15	45.19	0.78 in/h
5	Rain Bird PEB	1"	Turf Spray	19.65	10	158.7	141.0	30	1.17	34.03	45.16	0.78 in/h
	Common Wire						202.7					

WATERING SCHEDULE

NUMBER	MODEL	TYPE	PRECIP	IN/WEEK	MIN/WEEK	GAL/WEEK	GAL/DAY
1	Rain Bird PEB	Turf Rotor	0.53 in/h	1	115	2,545	
2	Rain Bird PEB	Turf Rotor	0.56 in/h	1	108	3,246	
3	Rain Bird PEB	Bubbler	7.66 in/h	1	8	54	
4	Rain Bird PEB	Turf Spray	0.78 in/h	1	77	1,567	
5	Rain Bird PEB	Turf Spray	0.78 in/h	1	77	1,513	
	TOTALS:				385	8,926	

CRITICAL ANALYSIS

Generated: 2021-01-12 14:32

P.O.C. NUMBER: 01
Water Source Information:

FLOW AVAILABLE
Water Meter Size: EXISTING
Flow Available: 75.00 gpm

PRESSURE AVAILABLE
Static Pressure at POC: 55.00 psi
Elevation Change: 2.00 ft
Service Line Size: 3"
Length of Service Line: 20.00 ft
Pressure Available: 54.00 psi

DESIGN ANALYSIS
Maximum Station Flow: 30.06 gpm
Flow Available at POC: 75.00 gpm
Residual Flow Available: 44.94 gpm

Critical Station: 3
Design Pressure: 40.00 psi
Friction Loss: 0.63 psi
Fittings Loss: 0.04 psi
Elevation Loss: 0.00 psi
Loss through Valve: 1.74 psi
Pressure Req. at Critical Station: 42.40 psi
Loss for Fittings: 0.00 psi
Loss for Main Line: 0.01 psi
Loss for POC to Valve Elevation: 0.00 psi
Loss for Backflow: 10.00 psi
Loss for Water Meter: 0.10 psi
Critical Station Pressure at POC: 52.51 psi
Pressure Available: 54.00 psi
Residual Pressure Available: 1.49 psi

IRRIGATION NOTES

- ALL LOCAL MUNICIPAL AND STATE LAWS, RULES AND REGULATIONS GOVERNING OR RELATING TO ANY PORTION OF THIS WORK ARE HEREBY INCORPORATED INTO AND MADE A PART OF THESE SPECIFICATIONS AND THEIR PROVISIONS SHALL BE CARRIED OUT BY THE CONTRACTOR.
- THE CONTRACTOR SHALL VERIFY THE LOCATIONS OF ALL EXISTING UTILITIES, STRUCTURES AND SERVICES BEFORE COMMENCING WORK. THE LOCATIONS OF UTILITIES, STRUCTURES AND SERVICES SHOWN IN THESE PLANS ARE APPROXIMATE ONLY. ANY DISCREPANCIES BETWEEN THESE PLANS AND ACTUAL FIELD CONDITIONS SHALL BE REPORTED TO THE OWNER'S REPRESENTATIVE.
- THE CONTRACTOR SHALL OBTAIN THE PERTINENT ENGINEERING OR ARCHITECTURAL PLANS BEFORE BEGINNING WORK.
- THE CONTRACTOR SHALL OBTAIN ALL NECESSARY PERMITS REQUIRED TO PERFORM THE WORK INDICATED HEREIN BEFORE BEGINNING WORK.
- THIS DESIGN IS DIAGRAMMATIC. ALL EQUIPMENT SHOWN IN PAVED AREAS IS FOR DESIGN CLARITY ONLY AND IS TO BE INSTALLED WITHIN PLANTING AREAS.
- THE CONTRACTOR SHALL NOT WILLFULLY INSTALL ANY EQUIPMENT AS SHOWN ON THE PLANS WHEN IT IS OBVIOUS IN THE FIELD THAT UNKNOWN CONDITIONS EXIST THAT WERE NOT EVIDENT AT THE TIME THESE PLANS WERE PREPARED. ANY SUCH CONDITIONS SHALL BE BROUGHT TO THE ATTENTION OF THE OWNER'S REPRESENTATIVE PRIOR TO ANY WORK OR THE IRRIGATION CONTRACTOR SHALL ASSUME ALL RESPONSIBILITY FOR ANY FIELD CHANGES DEEMED NECESSARY BY THE OWNER.
- INSTALL ALL EQUIPMENT AS SHOWN IN THE DETAILS AND SPECIFICATIONS. CONTRACTOR SHALL BE RESPONSIBLE TO COMPLY WITH LOCAL CITY, COUNTY AND STATE REQUIREMENTS FOR BOTH EQUIPMENT AND INSTALLATION.
- ACTUAL LOCATION FOR THE INSTALLATION OF THE BACKFLOW PREVENTER AND THE AUTOMATIC CONTROLLER IS TO BE DETERMINED IN THE FIELD BY THE OWNER'S AUTHORIZED REPRESENTATIVE.
- CONTRACTOR IS TO PROVIDE AN ADDITIONAL PILOT WIRE FROM CONTROLLER ALONG ENTIRETY OF MAIN LINE TO THE LAST RCV ON EACH AND EVERY LEG OF MAIN LINE. LABEL SPARE WIRES AT BOTH ENDS.
- ALL PIPE UNDER PAVED AREAS TO BE INSTALLED IN SLEEVING TWICE THE DIAMETER OF THE PIPE CARRIED. SEE LEGEND FOR TYPE. ALL WIRE UNDER PAVED AREAS TO BE INSTALLED IN A SCH. 40 SLEEVE THE SIZE REQUIRED TO EASILY PULL WIRE THROUGH. ALL SLEEVES TO BE INSTALLED WITH A MINIMUM DEPTH AS SHOWN ON THE SLEEVING DETAILS. SLEEVES TO EXTEND AT LEAST 12" PAST THE EDGE OF THE PAVING.
- ALL QUICK COUPLER AND REMOTE CONTROL VALVES TO BE INSTALLED IN SHRUB OR GROUND COVER AREAS WHERE POSSIBLE. ALL QUICK COUPLER AND REMOTE CONTROL VALVES TO BE INSTALLED AS SHOWN ON THE INSTALLATION DETAILS. INSTALL ALL QUICK COUPLER AND REMOTE CONTROL VALVES WITHIN 18" OF HARDSCAPE.
- ALL HEADS ARE TO BE INSTALLED WITH THE NOZZLE, SCREEN AND ARCS SHOWN ON THE PLANS. ALL HEADS ARE TO BE ADJUSTED TO PREVENT OVERSPRAY ONTO BUILDINGS, WALLS, FENCES AND HARDSCAPE. THIS INCLUDES, BUT NOT LIMITED TO, ADJUSTMENT OF DIFFUSER PIN OR ADJUSTMENT SCREW, REPLACEMENT OF PRESSURE COMPENSATING SCREENS, REPLACEMENT OF NOZZLES WITH MORE APPROPRIATE RADIUS UNITS AND THE REPLACEMENT OF NOZZLES WITH ADJUSTABLE ARC UNITS.
- THE CONTRACTOR SHALL USE PROPER GROUNDING TECHNIQUES FOR GROUNDING THE CONTROLLER AND RELATED EQUIPMENT PER MANUFACTURERS SPECIFICATIONS, SWEENEY AND ASSOCIATES RECOMMENDS MEASURING FOR PROPER GROUND AT LEAST ONCE ANNUALLY, AND NECESSARY ADJUSTMENTS MADE TO COMPLY WITH MANUFACTURER SPECIFICATIONS.
- CONTRACTOR TO RECERTIFY EXISTING PUMP AND PVB IF APPLICABLE.
- SYSTEM IS TO USE LOWEST QUALITY WATER AVAILABLE AT TIME OF INSTALLATION.
- IRRIGATION SYSTEM SHALL MAINTAIN AND OPERATE A RAIN SENSOR DEVICE OR SWITCH WITH 100% COVERAGE AND 50% OVERLAP THAT WILL OVERRIDE THE IRRIGATION CYCLE OF THE SPRINKLER SYSTEM WHEN ADEQUATE RAINFALL OCCURS.
- CHECK VALVES MUST BE INSTALLED AT IRRIGATION HEADS AS NEEDED TO PREVENT LOW HEAD DRAINAGE AND PUDDLING.
- IRRIGATED AREAS SHALL NOT BE LESS THAN FOUR FEET WIDE, EXCEPT WHEN USING MICRO OR DRIP IRRIGATION.
- NOZZLE PRECIPITATION RATES FOR ALL HEADS WITHIN EACH VALVE CIRCUIT MUST BE MATCHED TO WITHIN 20% OF ONE ANOTHER.

NOTE A:
POINT OF CONNECTION SHALL BE FROM THE EXISTING WATER METER OFF OF CITY WATER. VERIFY THE ACTUAL LOCATION, SIZE AND WATER PRESSURE IN THE FIELD PRIOR TO STARTING WORK. IF ANY OF THE POC INFORMATION SHOWN ON THESE DRAWING IS FOUND TO BE DIFFERENT THAN THE ACTUAL POC INFORMATION GATHERED IN THE FIELD, IMMEDIATELY NOTIFY THE LANDSCAPE ARCHITECT AND IRRIGATION CONSULTANT. SHOULD THE CONTRACTOR FAIL TO VERIFY THE POC INFORMATION ANY CHANGES REQUIRED BY LOW PRESSURE OR VOLUME SHALL BE THE SOLE RESPONSIBILITY OF THE CONTRACTOR.

MINIMUM PRESSURE REQUIRED 45.16 PSI @ POC
DESIGN WATER PRESSURE 55 PSI
MAXIMUM SYSTEM DEMAND 30.06 GPM

NOTE B:
CONTROLLER IS EXISTING. CONTRACTOR TO VERIFY FINAL LOCATION AND ZONE CAPACITY OF CONTROLLER AND ELECTRICAL POC SHALL BE CONFIRMED WITH OWNER'S AUTHORIZED REPRESENTATIVE PRIOR TO STARTING WORK.

NOTE C:
MAINLINE AND RELATED EQUIPMENT SHOWN WITHIN PAVING FOR CLARITY ONLY. ACTUAL MAINLINE AND RELATED EQUIPMENT LOCATION TO BE WITHIN PLANTERS AND A MINIMUM OF 18" OFF ADJACENT HARDSCAPE AND OTHER OBSTACLES TYP.

NOTE D:
CONTRACTOR SHALL ADJUST ALL HEADS AS REQUIRED TO ACCOMMODATE ANY VERTICAL OBSTRUCTIONS THAT MAY OCCUR, INCLUDING BUT NOT LIMITED TO LIGHT POLES, FIRE HYDRANTS, ETC. VERIFY ALL HEAD LAYOUT WITH OWNER'S AUTHORIZED REPRESENTATIVE PRIOR TO STARTING WORK.

NOTE E:
BUBBLERS AND LATERAL LINES ARE SHOWN WITHIN PAVING FOR CLARITY ONLY. ACTUAL LOCATION TO BE WITHIN PLANTER. BUBBLERS SHALL BE ALIGNED WITH TREES AND AS DIRECTED BY OWNER'S AUTHORIZED REPRESENTATIVE. CONFIRM ALL LAYOUT IN FIELD WITH OWNER'S AUTHORIZED REPRESENTATIVE PRIOR TO STARTING WORK.

FDOT PERMIT NUMBER: 2022-L-491-0005

Printed on Monday, July 18, 2022, 1:20 PM by Michael Grosswirth

Digitally signed by Michael D Grosswirth
DN: c=US, o=THOMAS ENGINEERING GROUP LLC, ou=A01410C000001720E31831F0000EFAC, cn=Michael D Grosswirth
Date: 2022.07.18 13:34:34 -04'00'

THOMAS ENGINEERING GROUP
ENGINEERS - LAND PLANNING - LANDSCAPE ARCHITECTS
CIVIL ENGINEERS - PROJECT MANAGERS - LAND PLANNING - LANDSCAPE ARCHITECTS
4000 NW 31ST AVENUE SUITE 600 FORT LAUDERDALE, FL 33309
P: (954) 202-7000 F: (954) 202-7070
WWW.THOMASENGINEERINGGROUP.COM

REVISIONS:			
REV:	DATE:	COMMENT:	BY:

811 KNOW WHAT'S BELOW ALWAYS CALL 811 BEFORE YOU DIG
www.callsunshine.com

PROJECT No.:	F190114
DRAWN BY:	CAD
CHECKED BY:	ROT
DATE:	02/14/2020
CAD LID:	F1901144RRIGATION ROAD -

PROJECT:
POPEYE'S CENTER CROSS-ACCESS ROADWAY
FOR
NW 31ST AVE LLC
3051 W. ATLANTIC BLVD.
CITY OF POMPANO BEACH
FLORIDA

THOMAS ENGINEERING GROUP
8300 NW 31ST AVENUE FORT LAUDERDALE, FL 33309
PH: (954) 202-7000
FX: (954) 202-7070
www.ThomasEngineeringGroup.com

MICHAEL D. GROSSWIRTH
REGISTERED LANDSCAPE ARCHITECT
July 18, 2022
FLORIDA LICENSE No. 189871
FLORIDA BUSINESS REGISTRATION No. 27528

SHEET TITLE:
IRRIGATION ROAD - FDOT PLAN
SHEET NUMBER:
L-3.1

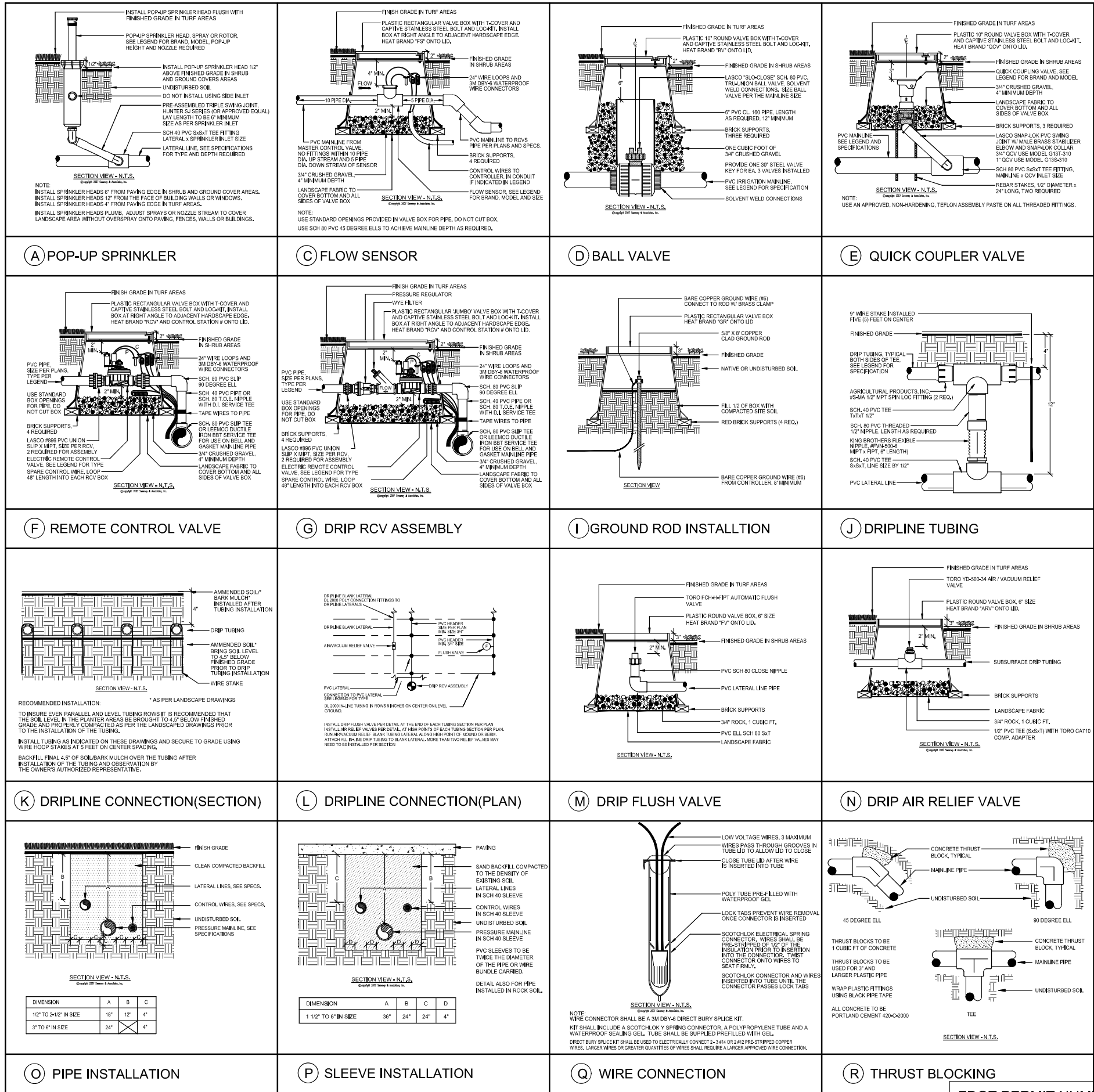

THOMAS ENGINEERING GROUP
 CIVIL ENGINEERS - PROJECT MANAGERS - LAND PLANNING - LANDSCAPE ARCHITECTS
 8300 NW 31ST AVENUE SUITE 600 FORT LAUDERDALE, FL 33309
 8300 NW 31ST AVENUE SUITE 600 FORT LAUDERDALE, FL 33309
 (954) 202-7000 FAX (954) 202-0700
 www.ThomasEngineeringGroup.com

REVISIONS:

REV	DATE	COMMENT	BY

811 KNOW WHAT'S BELOW ALWAYS CALL 811 BEFORE YOU DIG
 www.callsunshine.com

PROJECT No: F190114
 DRAWN BY: CAD
 CHECKED BY: RGT
 DATE: 02/14/2020
 CAD I.D.: F190114-IRRIGATION ROAD -

POPEYE'S CENTER CROSS-ACCESS ROADWAY
 FOR
NW 31ST AVE LLC

3051 W. ATLANTIC BLVD.
 CITY OF POMPANO BEACH
 FLORIDA

THOMAS ENGINEERING GROUP
 8300 NW 31ST AVENUE FORT LAUDERDALE, FL 33309
 PH: (954) 202-7000
 FAX: (954) 202-0700
 www.ThomasEngineeringGroup.com

MICHAEL D. GROSSWIRTH
 REGISTERED LANDSCAPE ARCHITECT
 July 18, 2022
 FLORIDA LICENSE No. 996871
 FLORIDA BUSINESS REGISTRATION No. 27528

Michael D Grosswirth
 Digitally signed by Michael D Grosswirth
 DN: c=US, o=THOMAS ENGINEERING GROUP LLC,
 ou=A01410C000001720E31831F0000E
 FAC, cn=Michael D Grosswirth
 Date: 2022.07.18 13:35:01 -04'00'

FDOT PERMIT NUMBER: 2022-L-491-0005