

INNOVATIVE SCULPTURE DESIGN



Project Proposal

Prepared for: Pompano Beach Powerline Rd. Entrance Sculpture
Prepared by: Innovative Sculpture Design LLC, Hunter Brown
February 16, 2024

Project Details

Title: Vivacious

Medium: Marine-grade stainless-steel

Finish: Automotive finish with a mirror-polished stainless-steel accent panel

Weight: Approx 7,000lbs

Scale: 20'H

Base: Circular concrete base with recessed center

- structural specs for base / foot to be determined by structural engineer
- artwork is welded to steel anchor plate and mounted to 3/4" anchor plate with anchor holes.
- plate is attached to concrete pad using hilti anchor system/ set by artist during install

Location: Powerline Rd. Pompano Beach, Florida

SCALE

5'D sphere

20'H

9' overall diameter

30"H

18'D base



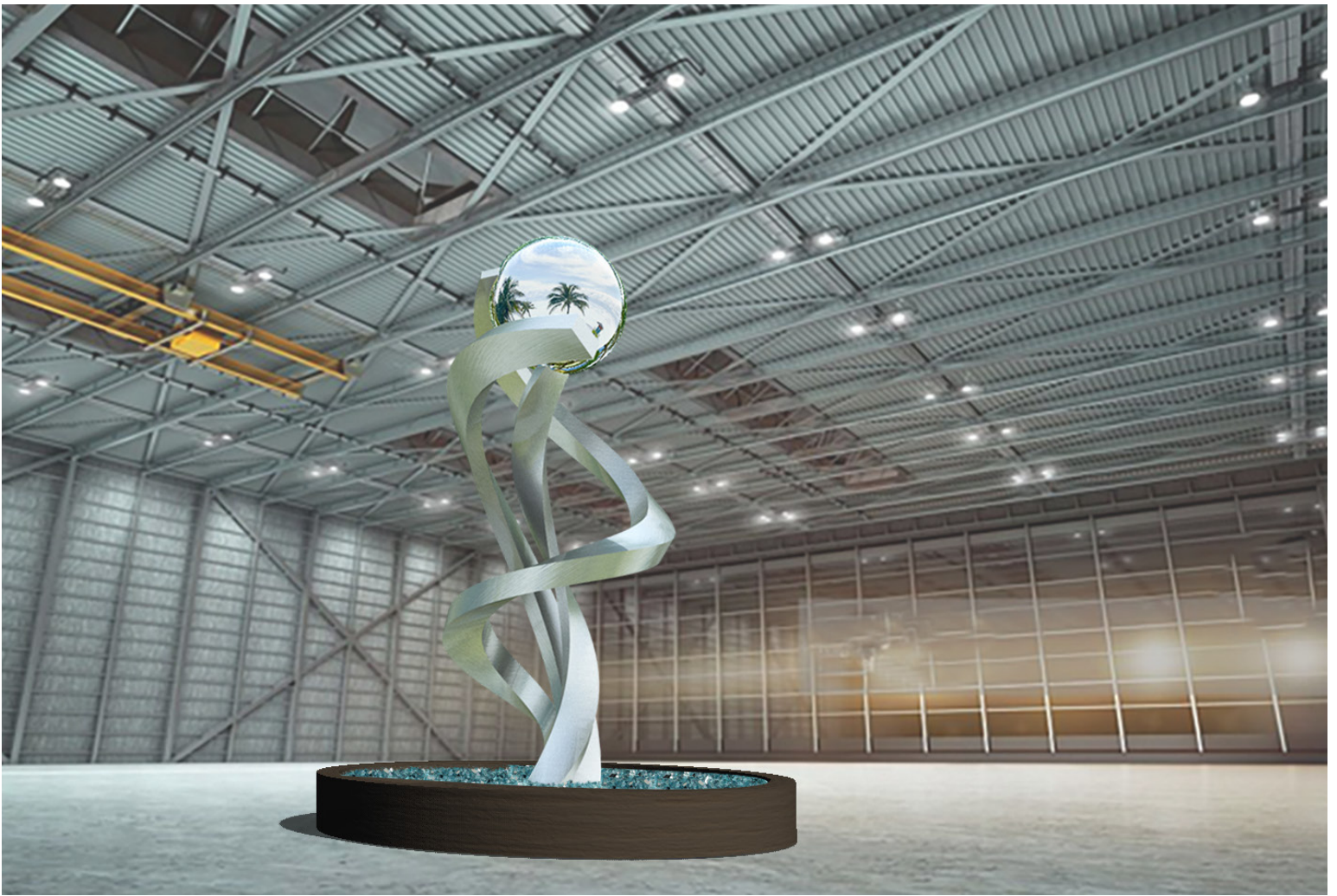

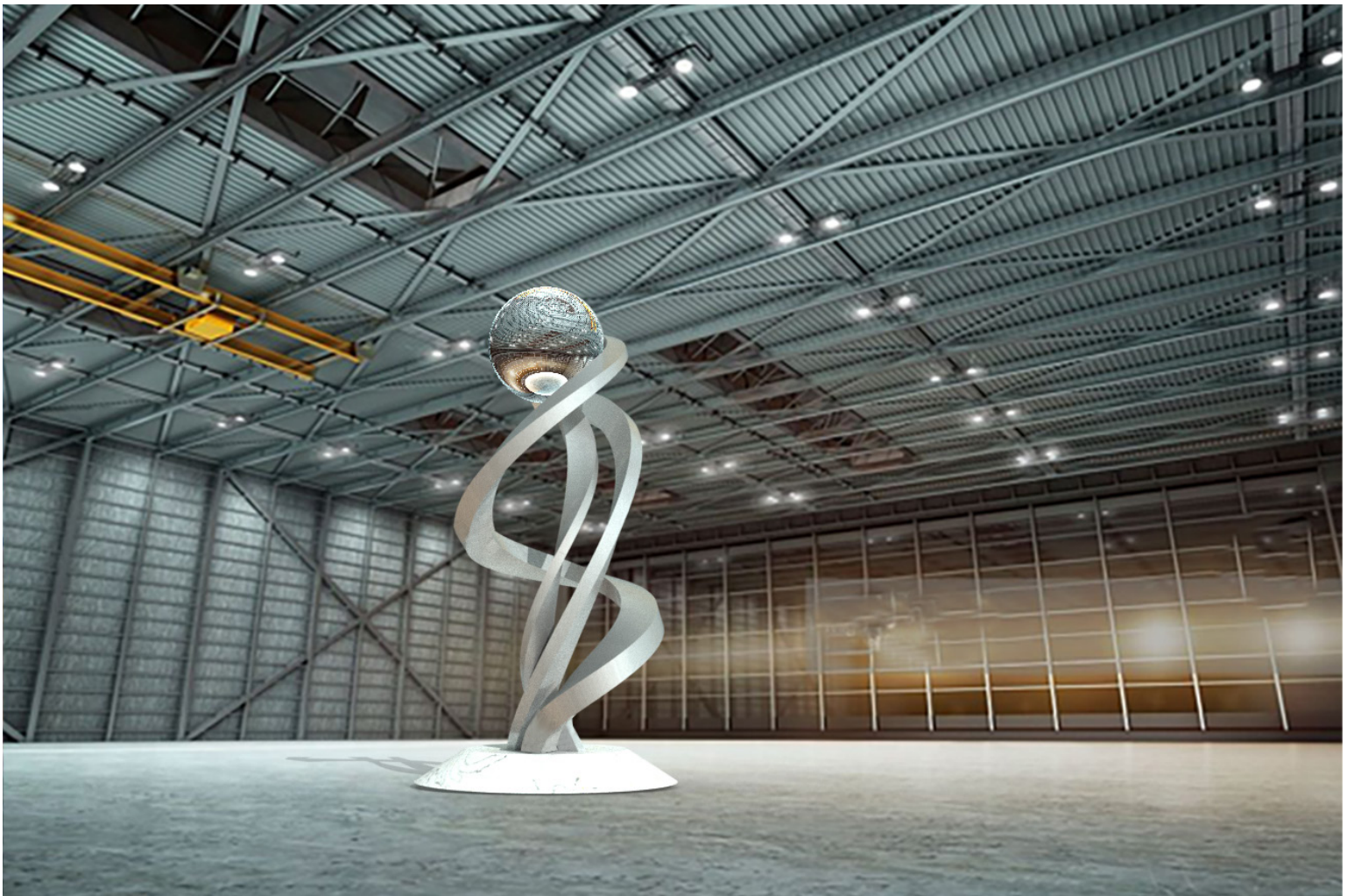
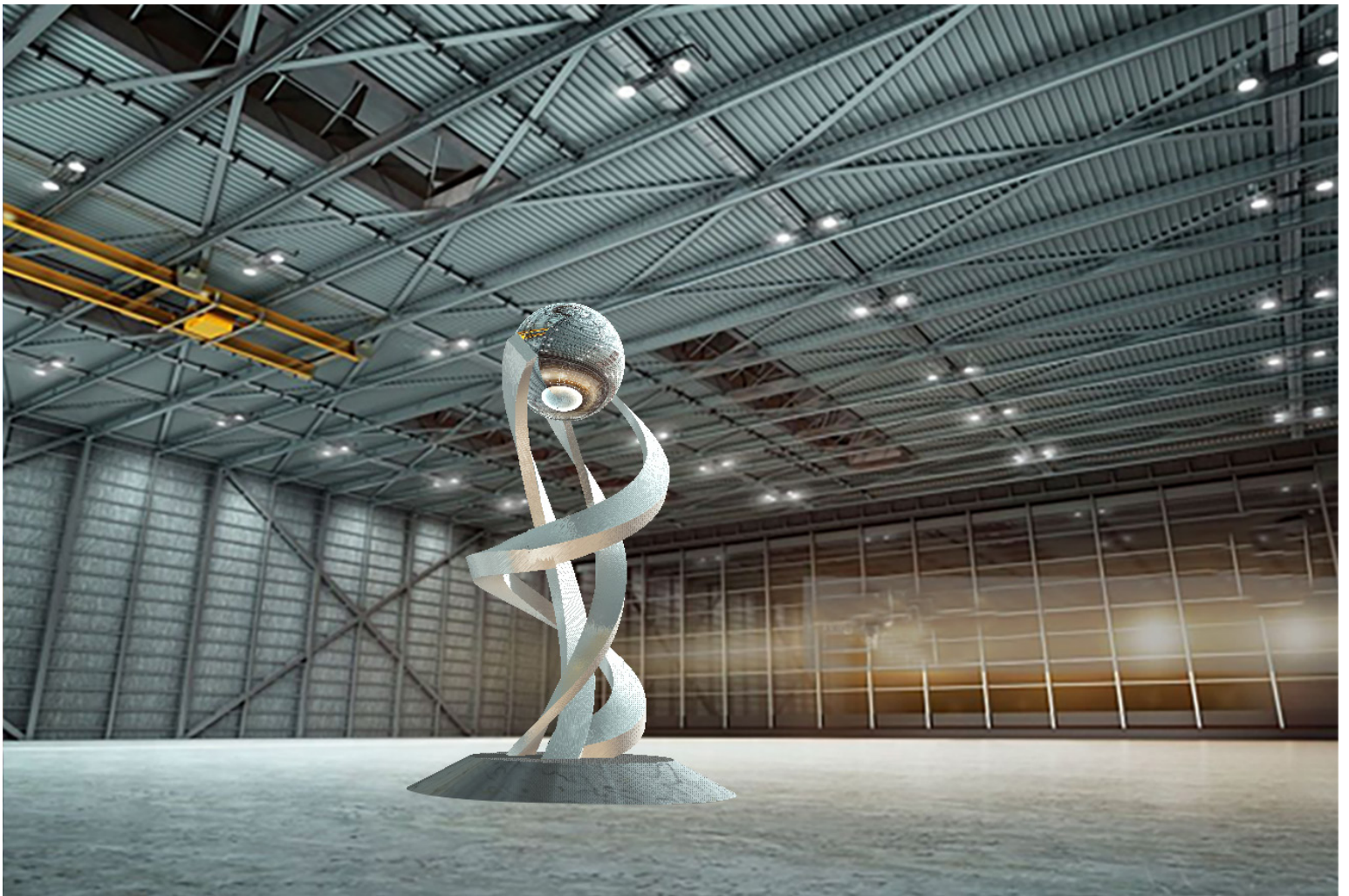

FINISH

Sample Finish:

Brush-pattern stainless/with mirror polished stainless



Other finishes and colors are optional*

BASE DESIGN

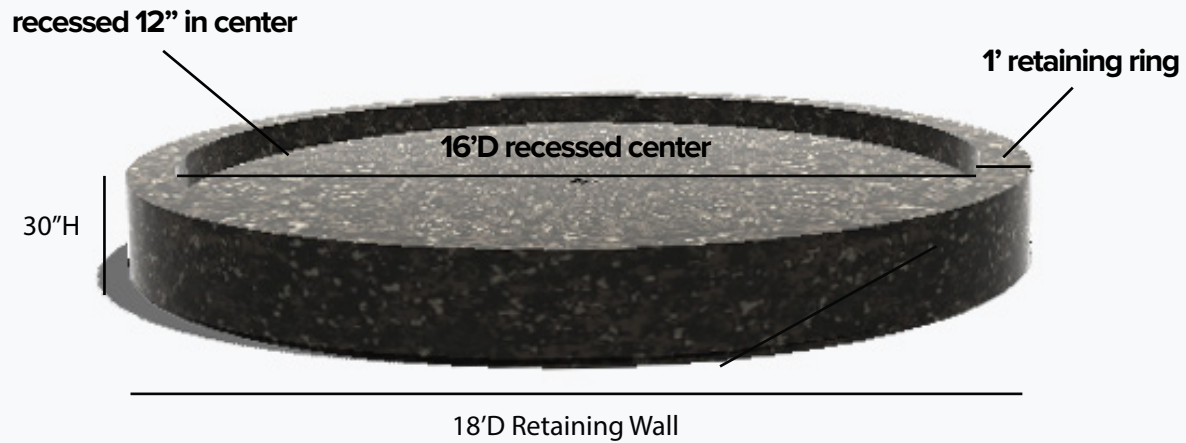

Base Finish: Rubbed concrete with stain sealer (other options available)

Base Specs: Per Structural Engineer Spec (finishes and proportions can be adjusted)

- This base construction helps with creating a barrier between the artwork and the viewer
- Artwork is welded to anchor plate/anchor plate attached in recessed area with hilti anchors
- Conduit for up lighting stubbed up inside inner extrusion ring
- Color Kinetics lighting installed inside retaining wall
- Landscape material to cover base plate attachment and to fill around light fixtures covering conduit inside retaining wall. (defer to design team for final look)

Other base options available*

Glass Sample

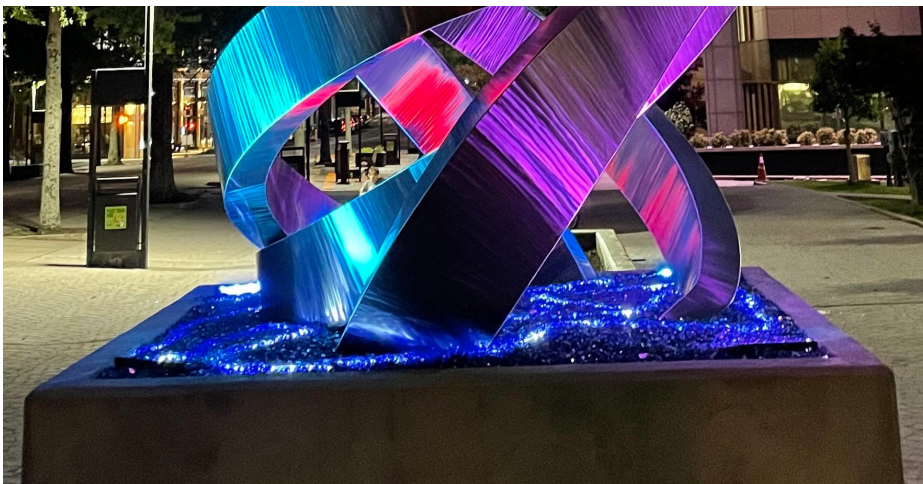



Shown with no elevated base.

Concrete Footing: 10'x10' concrete foot poured below grade with top of concrete just below grade.

-Artwork attached to concrete pad with Hilti Anchors by artist

-Attachment covered with landscape material

Base Specs: Per Structural Engineer Spec (finishes and proportions can be adjusted)

LIGHTING DESIGN

Color Kinetics lighting by Philips will be used to illuminate the piece. The Blast luminaires set the standard for flood lighting - delivering high quality light and uncompromising performance with exceptional reliability. The Blast Powercore lighting boosts the output to meet the most demanding white and color lighting applications. The fixtures have precise color, remote monitoring, and programming capabilities that open doors for innovative light show programming.

Lighting design will include 8 Color-Blast Gen5 fixtures. Lights to be mounted inside the retaining wall and wired in series. A box housing the controller will be placed in an accessible nearby location. The artist will program light shows to the controller prior to the installation.



Project Plan

We fabricate and complete all stages of the fabrication process at Innovative Sculpture Studio. The 8000sq. ft. studio has high structural beams and plenty of space to produce monumental works in house. Our fabrication assistants are trained in all stages of the process, from fabricating structural armatures to applying the final finish.

The base construction is to be contracted and completed prior to the completion of the fabrication process by Innovative Sculpture using structural specs provided by a certified structural engineer contracted by Innovative Sculpture. Base finish and proportions subject to final approval by design team.

Once the fabrication is complete we will prepare the artwork for safe transport. We will transport the assembled work as one piece using a oversize carrier. Installation will be completed in 1 day by the Innovative Sculpture team using a crane to pick and set the piece on the footing. A lane closure for the day will likely be necessary. Innovative. The base plate will be secured to the footing using threaded studs per engineering drawing specs. The studs will be set by Innovative Sculpture Design during install to allow for flexibility with the final orientation.

Maintenance

The piece is constructed in high chromium stainless steel (316 grade). The steel sheet is welded around a structural form constructed in tube and solid round stainless rods. This structure is designed to withstand high wind load and storms and will take into account hurricanes. The skin material/exterior material has high chromium content which is a chemical composition created for protecting the surfaces from oxidation even if the coating is compromised. The artwork will feature a blended brush pattern. The finished surfaces will be coated with Everbrite Protectaclear, a self-leveling resin coating made to protect the surfaces from grime and help maintain the surface luster. Maintenance includes washing the piece similar to washing a car. (If pressure washing the psi should be less than 3000psi with a non aggressive tip.) Water and mild soap can be used to wash the sculpture as needed. A new coating is recommended every 6-8 years. The coating is a wipe on application that is very easy to reapply. Innovative Sculpture offers a maintenance contract and prefers to apply Everbrite coating as needed.

Footing

Innovative Sculpture will offer design recommendations for the footing and attachment. The purchasing party will be responsible for all site-work outside of the artwork installation. Footing/base is to be complete prior to scheduled installation. The piece itself will be mounted on a 1" plate that will be anchored to the footing using Hilti anchor system. Anchors to be set by artist during the installation. This creates flexibility in the final orientation of the artwork.



Description

The Vivacious concept emerges as a testament to contemporary art, a symphony of abstract forms that dance with life.

The stainless-steel canvas bears the marks of creativity—a brush-pattern finish. The artist's strokes, deliberate and fluid, the etched pattern creates a dramatic everchanging visual, highlighting the relationship between light and reflection.

The sculpture defies stillness. Its forms twist, curve, and leap—an orchestra of motion frozen in time. Between these forms lies a dance—the interplay of positive and negative space. Emerging from the earth, like shoots reaching for sunlight. Each form carries a story—a memory, a dream, a fragment of existence. Their upward journey mirrors our aspirations. We, too, sprout toward the sky, seeking connection and transcendence.

High above, a polished sphere hovers—an enigma. Is it a celestial body, a symbol of community, or a reflection of our own yearnings? The forms embrace it, as if saying, "We share this space, this journey." The design exudes vitality. It laughs, twirls, and beckons. Perhaps it celebrates life, love, or the sheer joy of existence..

Budget

Description	Quantity	Unit Price	Cost
Materials			
11G 316 stainless sheet	12	\$ 833.50	\$ 10,002.00
1/2" stainless round bar	40	\$ 29.00	\$ 1,160.00
Sch. 40 2" tube	14	\$ 105.00	\$ 1,470.00
7'D 3/4" anchor plate	1		\$ 1,690.00
5'D Polished Sphere			\$ 6,000.00
Total:			\$ 20,322.00
Consumables/Production Cost			
Welding Consumables			\$ 1,000.00
Finish and Abrasives			\$ 1,500.00
Total:			\$ 2,500.00
Labor /Profit			
Production Labor			\$55,000.00
Labor Discount			-\$26,500.00
Total			\$ 28,500.00
Tranport / Install			
Transport			\$ 3,000.00
Crane Rental and Opperator			\$ 2,000.00
Reach Lift rental			\$ 2,000.00
Lodge			\$ 600.00
Install Fee			\$ 1,000.00
Total:			\$ 8,600.00
Grand Total:			\$ 59,922.00

Site-work budget

Base/ Lighting (not included in artist scope of work)

Budget with Recommended Base

	Cost
Color Kinetics Lighting	\$ 12,000.00
Lighting Hook Up Electric	\$ 5,000.00
Base Contractng	\$ 30,000.00
Engineer Fee for footing/attachment	\$ 1,500.00
Azuria Blue Fire Glass	\$ 2500.00

Total **\$ 51,000.00**

Budget with sub-grade concrete footing

Color Kinetics Lighting	\$12,000.00
Lighting Hook up Electric	\$ 5,000.00
Footing	\$ 8,000.00
Engineer Fee for footing/attachment	\$ 1,500.00

Total: **\$26,500.00**