

SITE PLAN LEGEND	
	EXISTING SITE
	EXISTING BUILDING
	HATCH REPRESENTS GENERAL LIMITS OF AREAS OUTSIDE THE SCOPE OF THIS RENOVATION PACKAGE

CLIENT:
 NICKLAUS CHILDREN'S HOSPITAL
 3100 S.W. 62ND AVE, MIAMI, FL 33155

CONTACT: ANDRES APONTE
 PROJECT MANAGER
 DESIGN & CONSTRUCTION
 M 786.228.7128
 O 786.624.3147
 E andres.aponte@nicklaushealth.org

PROJECT NAME:
 NICKLAUS CHILDREN'S HOSPITAL
 POMPANO BEACH OUTPATIENT CLINIC
 REMODEL PROJECT
 998 NORTH FEDERAL HIGHWAY
 POMPANO BEACH, FLORIDA, 33064

ARCHITECT:
 EG3A, LLC
 13250 SW 67TH AVENUE
 PINECREST, FL 33156

CONTACT:
 EDUARDO S. EGEA,
 CAAPPR, AIA,
 NCARB
 M 305.397.7044
 E eddie@eg3a.net

MEP/PIT SERVICE CONSULTANT:
 R.G. VANDERWEIL ENGINEERS, LLP
 8600 NW 36TH STREET
 SUITE 200
 MIAMI, FL 33166
 TEL: 305 501-5734

EG3A PROJECT NUMBER:
 13250-013-000
 NCH PO # 1000160483

DISCLAIMER:
 THE USE OF THIS DATA BY THE RECEIPT ACTS AS AN AGREEMENT OF THE FOLLOWING STATEMENTS DO NOT USE THIS DATA IF YOU DO NOT AGREE WITH ANY OF THE FOLLOWING STATEMENTS.

- ALL DRAWINGS ARE BASED UPON SITE INFORMATION SUPPLIED BY THIRD PARTIES AND AS SUCH THEIR ACCURACY CANNOT BE GUARANTEED.
- DO NOT SCALE THE DRAWING. USE FIGURED DIMENSIONS IN ALL CASES CHECK ALL DIMENSIONS ON SITE.

NOTES:
 A. ALL DIMENSIONS ARE IN FEET & INCHES UNLESS OTHERWISE MENTIONED.
 B. DIMENSIONS ARE NOT TO BE SCALED. ONLY WRITTEN DIMENSIONS SHALL BE FOLLOWED.
 C. ANY DISCREPANCIES MUST BE BROUGHT TO THE NOTICE OF EG3A ARCHITECTS BEFORE EXECUTION OF THE WORK AT SITE.

DATE	REVISION NUMBER	DESCRIPTION

STAMP:

EDUARDO SALVADOR EGEA-FERNANDEZ
 FLORIDA AR#93398

KEY PLAN:

ISSUE: **CONSTRUCTION DOCUMENT**

TITLE: **SITE PLAN**

SHEET NO: **A10.00**

DRAWN BY:	CHECKED BY:	Approved By:
		EDUARDO EGEA
DATE:	PAPER SIZE:	REV:
05-01-2025		

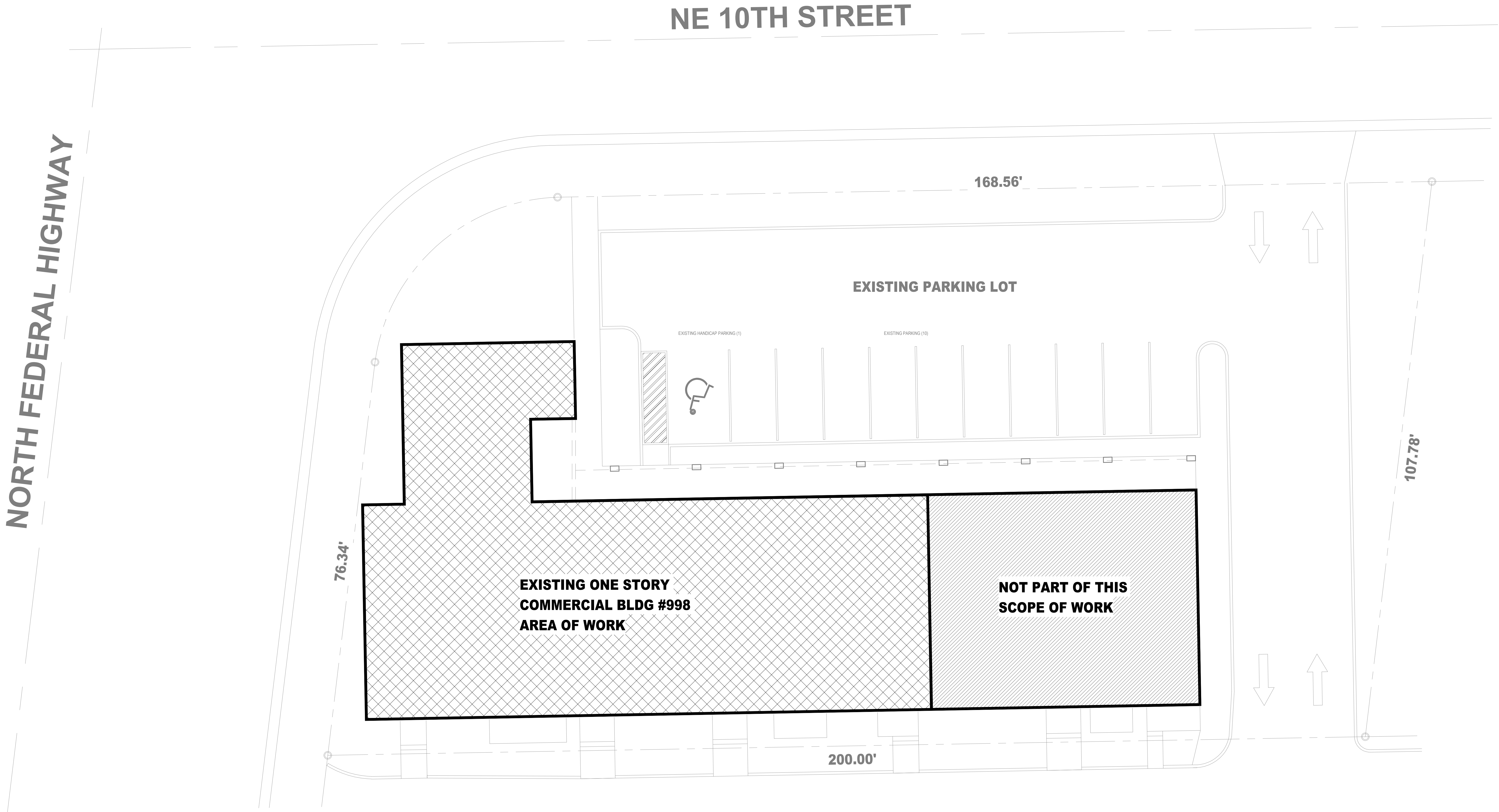

NORTH FEDERAL HIGHWAY

NE 10TH STREET

EXISTING PARKING LOT

EXISTING ONE STORY
 COMMERCIAL BLDG #998
 AREA OF WORK

NOT PART OF THIS
 SCOPE OF WORK