



View 02

06



View 01

03

| | |
|---|--------------------------|
| CURRENT USE: | VACANT |
| PROPOSED USE: | 3,500 SF CAR WASH |
| LAND USE DESIGNATION: | COMMERCIAL (C) |
| ZONING DESIGNATION: | B-3 - GENERAL COMMERCIAL |
| WATER/WASTEWATER SERVICE PROVIDER: | BROWARD COUNTY WWD |
| BUILDING AREA (FOOTPRINT): | 3,500 SF |
| TOTAL SITE AREA: | 52,371 SF (1.2023 AC) |
| BUILDING AREA (FOOTPRINT): | REQUIRED 3,500 SF |
| MAX. BLDG. HEIGHT: | REQUIRED 105' 2" |
| REQUIRED PARKING: Car Wash (3,500 @ 1 PER 500 SF) | REQUIRED 7 SPACES |
| ACCESSIBLE PARKING (1 PER 25 SPACES) | REQUIRED 1 SPACE |
| BICYCLE PARKING (4 PER 10 VEHICULAR SPACES) | REQUIRED 4 SPACES |
| PROPOSED SETBACKS: | REQUIRED NONE |
| FRONT (SOUTH) | 10' |
| REAR (NORTH) | 30' |
| SIDE (WEST) | NONE |
| SIDE (EAST) | NONE |
| PROPOSED LANDSCAPE BUFFERS: | REQUIRED 10' |
| FRONT (SOUTH) | 10' |
| REAR(NORTH) | 10' |
| SIDE (WEST) | 10' |
| SIDE (EAST) | 10' |

Site Data

02



View 04

05



View 03

04

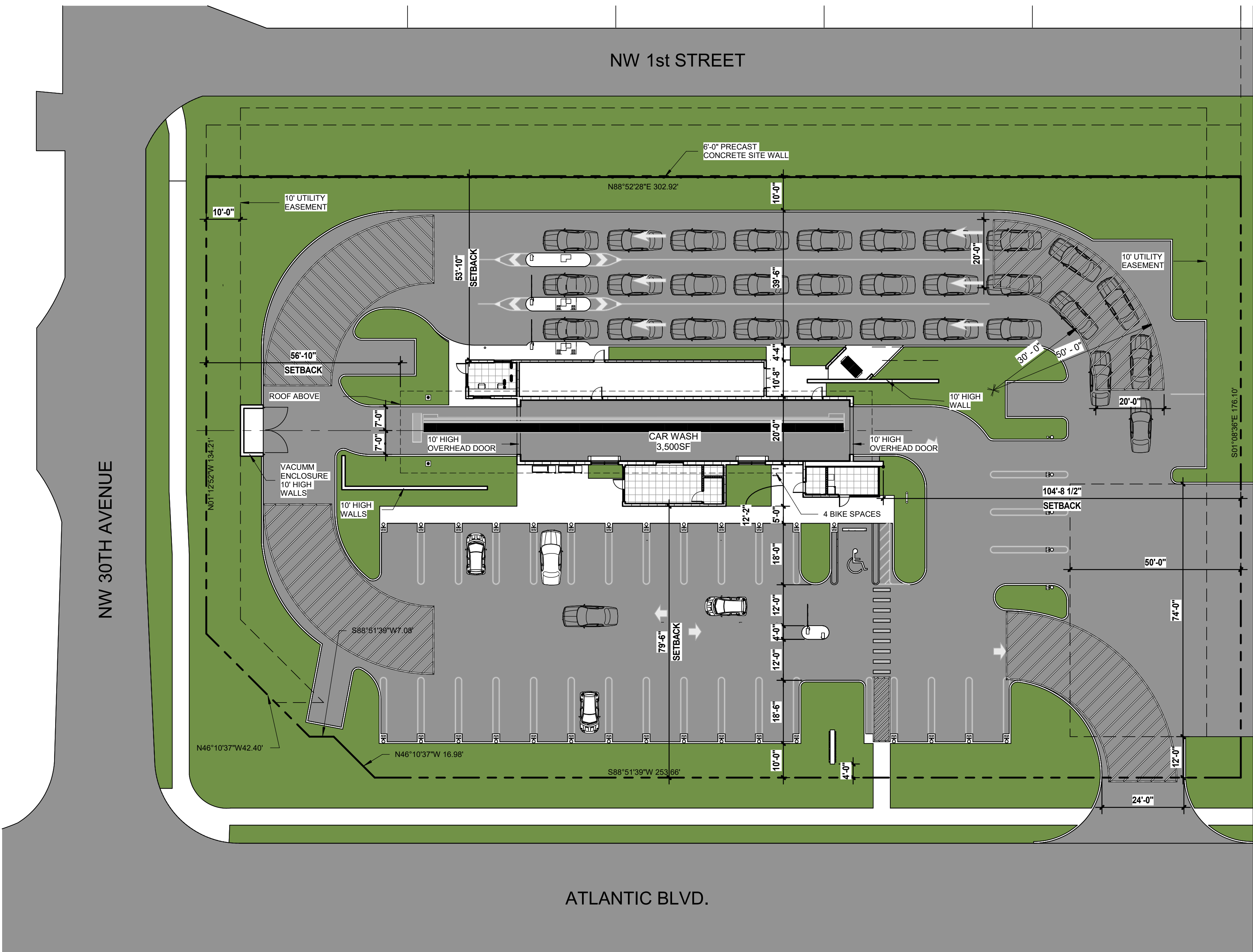

Site Plan

SCALE: 1" = 20'-0"

01

CONSULTANT

STATE OF FLORIDA

REGISTERED ARCHITECT

Gregory b. Molina

FL REG. #AR93354

DATE: 04-11-25

Copyright © 2025
All rights reserved. This document
design, or parts thereof, may not be
reproduced in any form without
written consent from GBM Architecture, PA.

GBM

ARCHITECTURE PA

ARCHITECTURE
MASTER PLANNING
AA26002332

330 HINMARSHREE ST,
SUITE 10B
FORT LAUDERDALE,
FLORIDA 33312

E: GREGM@GBMARCHITECTURE.COM
WEB: WWW.GBMARCHITECTURE.COM
T : 9 5 4 . 9 9 9 . 5 6 3 3

SPECIAL EXEMPTION
RISING TIDE

Atlantic Blvd. & NW 30th Ave.
Pompano Beach, FL 33069

DRAWING ISSUE DATES:

| |
|--|
| |
| |
| |
| |
| |
| |
| |
| |
| |
| |

Site Plan

SHEET

A-1.0

PROJECT 250225

DATE 04-11-25

PERMIT NO.