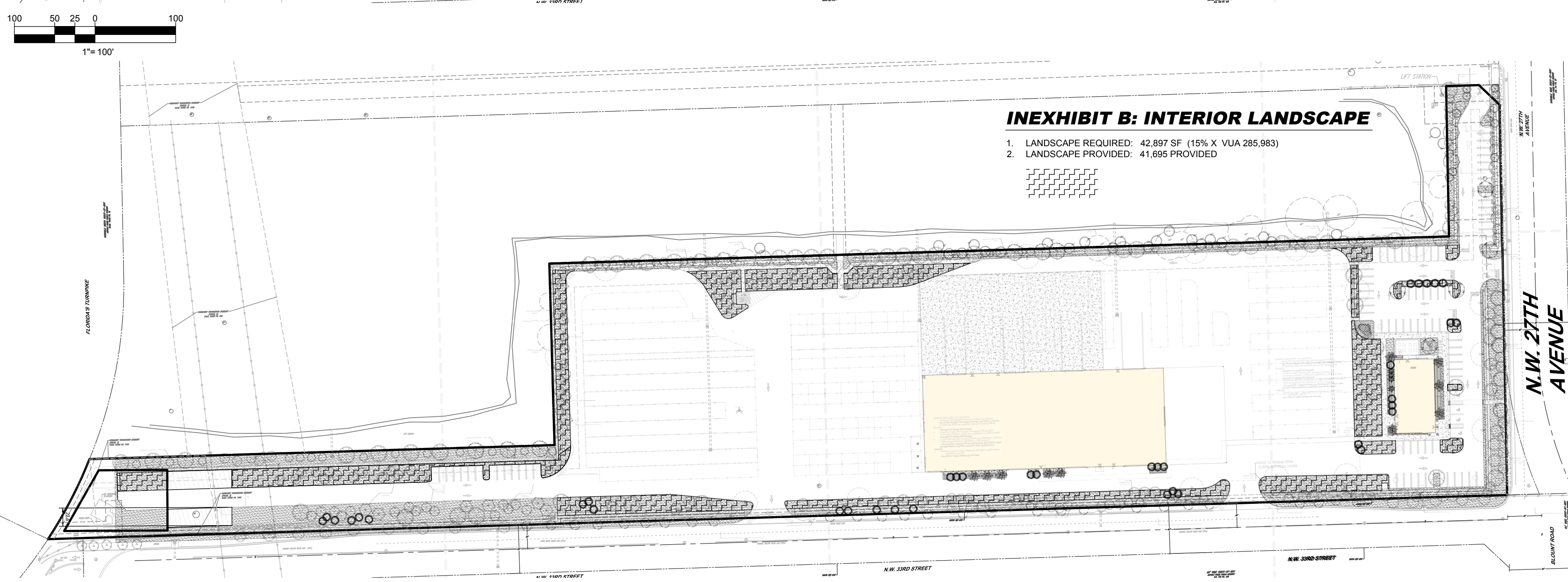

EXHIBIT A: PERVIOUS AREA

1. PERVIOUS AREA = 127,300 SF (28.2%)
2. LOT COVERAGE = 324,424 SF (71.8%)



INEXHIBIT B: INTERIOR LANDSCAPE

1. LANDSCAPE REQUIRED: 42,897 SF (15% X VUA 285,983)
2. LANDSCAPE PROVIDED: 41,695 PROVIDED

GENERAL LANDSCAPE NOTES:

1. ALL PLANTING BEDS TO BE MULCHED WITH 3" FLORIMULCH MELALEUCA (COCOA BROWN) MULCH. INSTALL A DOUBLE LAYER OF WEED FABRIC UNDER ALL MULCH INSTALLATIONS
2. THE CONTRACTOR SHALL VERIFY THE LOCATION OF ALL UTILITIES PRIOR TO CONSTRUCTION
3. DIGGING IN UTILITY EASEMENTS SHALL BE BY HAND ONLY
4. THIS PLAN IS TO BE UTILIZED FOR LANDSCAPE PURPOSES ONLY.
5. ALL DISTURBED UNPAVED AREAS, EXCLUDING PLANTING BEDS, ARE TO BE INSTALLED AS LAWN IN ACCORDANCE WITH LANDSCAPE SPECIFICATION #2.C., UNLESS OTHERWISE STATED ON THIS PLAN.
6. SHRUBS PLANTED ALONG HEAD-IN PARKING STALLS SHALL BE INSTALLED TO ALLOW A CLEARANCE OF TWO FEET FROM FACE OF CURB TO ALLOW FOR BUMPER OVERHANG.
7. IF IRRIGATION IS REQUIRED BY THE OWNER OR APPROVING MUNICIPALITY, THE CONTRACTOR SHALL PROVIDE AN IRRIGATION SYSTEM MEETING THE SPECIFICATIONS OF THE CHOSEN PRODUCT'S MANUFACTURER. THE IRRIGATION DESIGN SHALL ACCOMMODATE LAWN AND BED AREAS EACH UNDER SEPARATE ZONES TO MAXIMIZE WATER EFFICIENCY. THE CONTRACTOR SHALL BE RESPONSIBLE FOR SECURING ANY PERMITS REQUIRED FOR THE INSTALLATION OF AN IRRIGATION SYSTEM.
8. PLANT MATERIAL SUBSTITUTIONS MUST BE FORMALLY SUBMITTED TO BOHLER ENGINEERING AND THE MUNICIPAL ENGINEER AND LANDSCAPE CONSULTANTS FOR REVIEW AND APPROVAL PRIOR TO INSTALLATION. ANY PLANT MATERIAL THAT ARE TO BE INSTALLED WITHIN STORMWATER BMP FEATURES MUST BE NATIVE SPECIES.
9. WITHOUT EXCEPTION, WEED BARRIER FABRIC SHALL NOT BE INSTALLED WITHIN ANY BMP FACILITY. BMP FACILITIES INCLUDE RAINGARDENS, INFILTRATION TRENCHES, VEGETATIVE SWALES AND STORMWATER BASINS.
10. ANY TREE INSTALLED WITHIN 10 FT. OF NEW CONCRETE SIDEWALKS AND/OR NEARBY UNDERGROUND UTILITY OR PIPE SHOULD BE INSTALLED WITH BIOPARRIER ROOT BARRIER FABRIC AS SHOWN. SEE DETAIL 8. C-704.
11. THERE IS TO BE NO PLANTING OF TREES OR SHRUBS EITHER DIRECTLY OVER OR WITHIN 10 HORIZONTAL FEET OF THE SANITARY SEWER GRAVITY SEWERS AND FORCE MAIN.
12. PRE CONSTRUCTION MEETING WITH URBAN FORESTRY IS REQUIRED BEFORE ANY WORK IS PERFORMED ON SITE. WHERE THERE IS TREE PROTECTION AND/OR PLANT MATERIAL IS INSTALLED ON SITE.
13. ALL HEDGES ABUTTING CITY RIGHTS OF WAY SHALL BE MAINTAINED AT A HEIGHT NO GREATER THAN 24".
14. PRE-CONSTRUCTION MEETING WITH URBAN FORESTRY IS REQUIRED BEFORE ANY WORK IS PERFORMED ON SITE WHERE THERE IS TREE PROTECTION AND/OR PLANT MATERIAL IS INSTALLED ON SITE.
15. ALL ROAD ROCK, CONCRETE, ASPHALT AND OTHER NON NATURAL MATERIAL BE REMOVED FROM ALL PLANTING AREAS PRIOR TO LANDSCAPE INSTALLATION AND BE REPLACED WITH PLANTING SOIL PRIOR TO LANDSCAPE INSTALLATION.
16. ALL TREE WORK WILL REQUIRE PERMITTING BY A REGISTERED BROWARD COUNTY TREE TRIMMER.
17. OVERHEAD UTILITIES WILL BE BURIED FOR THIS PROJECT AS PER 155.5509
18. PER CITY ORDINANCE(S) §50.02(A) (4) AND §100.35(E), THAT LANDSCAPING MATERIALS OTHER THAN SOD ARE NOT ALLOWED WITHIN (5') FIVE FEET OF ANY PORTION OF CITY OWNED UTILITIES WITHIN THE PUBLIC STREET RIGHT-OF-WAY INCLUDING METERS, HYDRANTS, SERVICE LINES ETC. ALSO, PLEASE NOTE THAT NO TREES, SHRUBBERY OR OBSTRUCTION SHALL BE PLACED WITHIN A 3' RADIUS OF A CITY-OWNED SEWER LATERAL CLEANOUT OR WATER &/OR REUSE METER.

NATIVE SPECIES:

CONTRACTOR SHALL VERIFY PLANT QUANTITIES IN THE TABLE WITH THE PLAN. WHERE THERE IS A DISCREPANCY IN PLANT QUANTITIES, THE PLAN OVER RIDES THE PLANT LIST

* ALL PLANTS ARE NATIVE SPECIES - HIGH DROUGHT TOLERANCE
 ** CONTRACTOR TO VERIFY SQUARE FOOTAGE

LANDSCAPE & ROOT BARRIER NOTES:

TREES SHOWN ON THIS PLAN ARE FOR GRAPHIC REPRESENTATION ONLY. TREE SPACING IS BASED ON DESIGN REQUIREMENTS AND THE TREES SHOWN ON THESE PLANS ATTEMPT TO ACCOMPLISH THAT SPACING WHILE MAINTAINING THE REQUIRED SETBACKS FROM UTILITIES. TREES MAY BE FIELD ADJUSTED TO AVOID CONFLICTS WITH DRIVEWAYS AND UNDERGROUND UTILITIES. IN ANY CASE THE TREES SHALL BE LOCATED IN THE FIELD IN ACCORDANCE WITH THE PLANTING DETAILS SHOWN.

ADDITIONALLY, TREES ARE TO BE INSTALLED WITH TEN FOOT (10') SEPARATION FROM ANY WATER OR SEWER MAIN AND/OR SERVICE, HYDRANTS AND LIFT STATIONS. IF A TEN FOOT (10') SEPARATION CANNOT BE ACHIEVED, THE TREE CAN BE INSTALLED WITH A ROOT BARRIER SYSTEM. REFER TO THE "ROOT BARRIER" DETAIL FOR INSTALLATION REQUIREMENTS. HOWEVER, IN NO CASE SHALL A TREE ENCLOSED INTO A BCUW WITHOUT PRIOR BCUW APPROVAL AND ONLY SOD CAN BE INSTALLED WITHIN 7.5' OF A FIRE HYDRANT UNLESS OTHERWISE APPROVED BY THE FIRE MARSHAL AND BCUW

AS PER CITY ORDINANCE(S) §50.02(A) (4) AND §100.35(E), THAT LANDSCAPING MATERIALS OTHER THAN SOD ARE NOT ALLOWED WITHIN (5') FIVE FEET OF ANY PORTION OF CITY OWNED UTILITIES WITHIN THE PUBLIC STREET RIGHT-OF-WAY INCLUDING METERS, HYDRANTS, SERVICE LINES ETC. ALSO, PLEASE NOTE THAT NO TREES, SHRUBBERY OR OBSTRUCTION SHALL BE PLACED WITHIN A 3' RADIUS OF A CITY-OWNED SEWER LATERAL CLEANOUT OR WATER &/OR REUSE METER. SHOW THE LOCATION OF ALL EXISTING CITY OWNED AND MAINTAINED POTABLE WATER MAINS AND SERVICES, SANITARY SEWER MAINS OR LATERALS AND STORM DRAINAGE LINES ON THE PROPOSED LANDSCAPE PLANS. CONTACT TRACY WYNN GIS COORDINATOR ENGINEERING DIV. FOR UTILITY INFORMATION. 954-545-7007 TRACY.WYNN@COPBFL.COM ENGINEERING STANDARD STREET TREE DETAIL 316-1 AND 315-1.

SEE DETAIL 7, SHEET C-704 FOR ROOT BARRIER DETAILS.

NOTE: ROOT BARRIER SHALL BE PROVIDED FOR ALL LANDSCAPING PROPOSED WITHIN 10 FEET OR DRAINAGE PIPES, STRUCTURES AND CHAMBERS.

BOHLER
 SITE CIVIL AND CONSULTING ENGINEERING
 PROGRAM MANAGEMENT
 LANDSCAPE ARCHITECTURE
 SUSTAINABLE DESIGN
 PERMITTING SERVICES
 TRANSPORTATION SERVICES

REVISIONS

REV	DATE	COMMENT	DRAWN BY	CHECKED BY

811
 Know what's below.
 Call before you dig.
 ALWAYS CALL 811
 It's fast. It's free. It's the law.

SITE PLAN

THIS DRAWING IS INTENDED FOR MUNICIPAL AND/OR AGENCY REVIEW AND APPROVAL. IT IS NOT INTENDED AS A CONSTRUCTION DOCUMENT UNLESS INDICATED OTHERWISE.

PROJECT No.: FLB230010.00
 DRAWN BY: RN
 CHECKED BY: CL
 DATE: 02/08/2023
 CAD ID: SITE

PROPOSED SITE PLAN

FOR

CRITERION
 EXTERIOR GROUP LLC

PROPOSED DEVELOPMENT
 NW 33RD STREET
 POMPANO BEACH, FL 33069

BOHLER
 1900 NW CORPORATE BOULEVARD
 SUITE 101E
 BOCA RATON, FLORIDA 33431
 Phone: (561) 571-0280
 Fax: (561) 571-0281
 FLORIDA BUSINESS CERT. OF AUTH. No. 30780

THIS ITEM HAS BEEN DIGITALLY SIGNED AND SEALED BY BRETT M. WALDMAN, P.L.A. ON THE DATE ADJACENT TO THE SEAL. PRINTED COPIES OF THIS DOCUMENT ARE NOT CONSIDERED SIGNED AND SEALED AND THE SIGNATURE MUST BE VERIFIED ON ANY ELECTRONIC COPIES.

LANDSCAPE PLAN

SHEET NUMBER:
L-706
 ORG. DATE - 02/08/2023

SYMBOL	CODE	QTY	BOTANICAL NAME	COMMON NAME
TREES				
+	AR*	21	ACER RUBRUM	RED MAPLE
⊗	BS*	50	BURSERA SMARUBA	QUINCE LIMBO
⊗	CP*	17	COCCOLOBA DIVERSIFOLIA	PIGEON PLUM
⊗	CE*	3	CONOCARPUS ERECTUS VAR. SERICEUS	SILVER BUTTWOOD
⊗	CS*	49	CORDIA SEBESTENA	GEIGER TREE
⊗	EP*	22	EUGENIA FOETIDA	SPANISH STOPPER
⊗	IP*	8	ILEX VOMITORIA F. PENNOLA	WEERING YAUPON HOLLY
⊗	LI*	5	LYSLOMA LATSUQUIM	FALSE TAMARIND
⊗	LS	8	LYSLOMA SABCU	WILD TAMARIND
⊗	MP*	87	MYRANTHES FRAGRANS	SIMPSONS STOPPER
⊗	QV*	6	QUERCUS VIRGINIANA	SOUTHERN LIVE OAK
⊗	TD*	60	TAXODIUM DISTICHUM	BALD CYPRESS
EXISTING TREES & PALMS				
⊗	BS-E	13	BURSERA SMARUBA	QUINCE LIMBO
⊗	CE-E	5	CONOCARPUS ERECTUS VAR. SERICEUS	SILVER BUTTWOOD
⊗	LIE	29	LAGERSTROEMIA INDICA	CRAPPE MYRTLE
⊗	QV-E	5	QUERCUS VIRGINIANA	SOUTHERN LIVE OAK
⊗	SP-E	25	SABAL PALMETTO	CABBAGE PALMETTO
PALMS				
⊗	SP	38	SABAL PALMETTO	CABBAGE PALMETTO
⊗	VM	4	VEITCHIA MONTGOMERYANA	MONTGOMERY PALM
⊗	MVP	10	VEITCHIA MONTGOMERYANA	MONTGOMERY PALM MULTI-STEM
SHRUBS				
⊗	CAQ	3	CRINAM AUGUSTUM QUEEN EMMA	QUEEN EMMA CRINAM LILY
SHRUB AREAS				
⊗	CH	693	CHRYSOBALANUS ICACO	COCO PLUM
⊗	LN	613	ILEX VOMITORIA NANA	DWARF YAUPON HOLLY
⊗	LMB	405	LIRIOPE MUSCARI 'BIG BLUE'	BIG BLUE LILYTURF
⊗	MYF	3,599	MYRANTHES FRAGRANS	SIMPSONS STOPPER
⊗	BMF	41	PHLODENDRON BURLE-MARQUI	BURLE MARX PHLODENDRON
⊗	POD	189	PODOCARPUS MACROPHYLLUS 'DWARF PRINGLES'	DWARF PRINGLES YEW PODOCARPUS
⊗	TRD	568	TRIPSADIUM DACTYLODES NANA	DWARF FAKAHATHEE GRASS
⊗	ZAF	78	ZAMIA FLORIDANA	COONITE PALM
SOD				
⊗	SOD**	64,727 SF	STENOTAPHRUM SECUNDATUM PALMETTO	PALMETTO ST. AUGUSTINE GRASS

NOTE: FULL PLANT SCHEDULE ON SHEET L-712

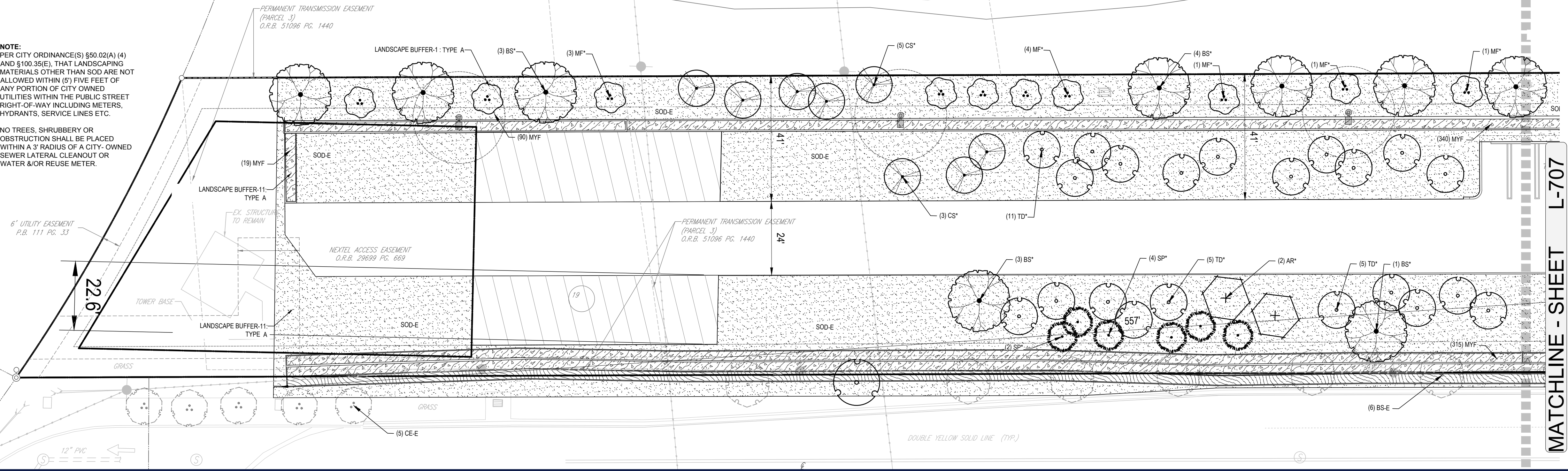
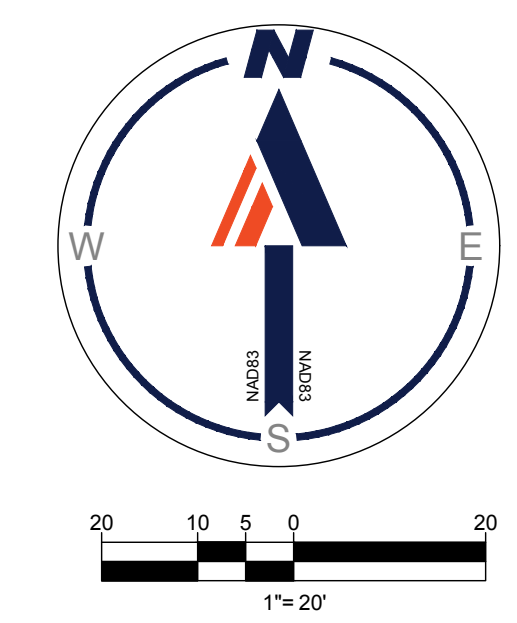

NOTE:
 PER CITY ORDINANCE(S) §50.02(A) (4) AND §100.35(E), THAT LANDSCAPING MATERIALS OTHER THAN SOD ARE NOT ALLOWED WITHIN (5') FIVE FEET OF ANY PORTION OF CITY OWNED UTILITIES WITHIN THE PUBLIC STREET RIGHT-OF-WAY INCLUDING METERS, HYDRANTS, SERVICE LINES ETC.

NO TREES, SHRUBBERY OR OBSTRUCTION SHALL BE PLACED WITHIN A 3' RADIUS OF A CITY-OWNED SEWER LATERAL CLEANOUT OR WATER &/OR REUSE METER.

FEB 08, 2024
 H:\2023\FLB230010\00\LAND\01-01-LAYOUT_L-706 LANDSCAPE