

STATE OF FLORIDA DEPARTMENT OF TRANSPORTATION
**PUBLIC TRANSPORTATION
GRANT AGREEMENT EXHIBITS**

Form 725-000-02
STRATEGIC
DEVELOPMENT
OGC 06/18

EXHIBIT A

Project Description and Responsibilities

A. Project Description (description of Agency's project to provide context, description of project components funded via this Agreement (if not the entire project)): Pompano beacg Airpark - Taxiway DELTA Rehabilitation

B. Project Location (limits, city, county, map, illustration/graphic of project area): Pompano Beach Airpark/Pompano Beach, FL/Broward

C. Project Scope (allowable costs: describe project components, improvement type/service type, approximate timeline, project schedule, project size): Taxiway Rehabilitation/Reconstruction: As required by 215.971, F.S., this scope of work includes but is not limited to consultant and design fees, survey and geotechnical costs, permitting, construction inspection and material testing costs, mobilization and demobilization, maintenance of traffic, erosion control, demolition, pavement enhancement or reconstruction (with concrete, asphalt, rejuvenators, or sealants), joint rehabilitation for PCC pavement, pavement markings (removal and new), airfield lighting system, signage improvements (includes conduits, lights, conductors, cans, lightning protection, and vault upgrades), drainage, stormwater structures, fencing and gates, and sodding, including all materials, equipment, labor, and incidentals required to rehabilitate/reconstruct the taxiway pavement. The Sponsor will comply with Aviation Program Assurances.

D. Deliverable(s): Taxiway DELTA Rehabilitation

The project scope identifies the ultimate project deliverables. Deliverables for requisition, payment and invoice purposes will be the incremental progress made toward completion of project scope elements. Supporting documentation will be quantifiable, measurable, and verifiable, to allow for a determination of the amount of incremental progress that has been made, and provide evidence that the payment requested is commensurate with the accomplished incremental progress and costs incurred by the Agency.

E. Unallowable Costs (including but not limited to):

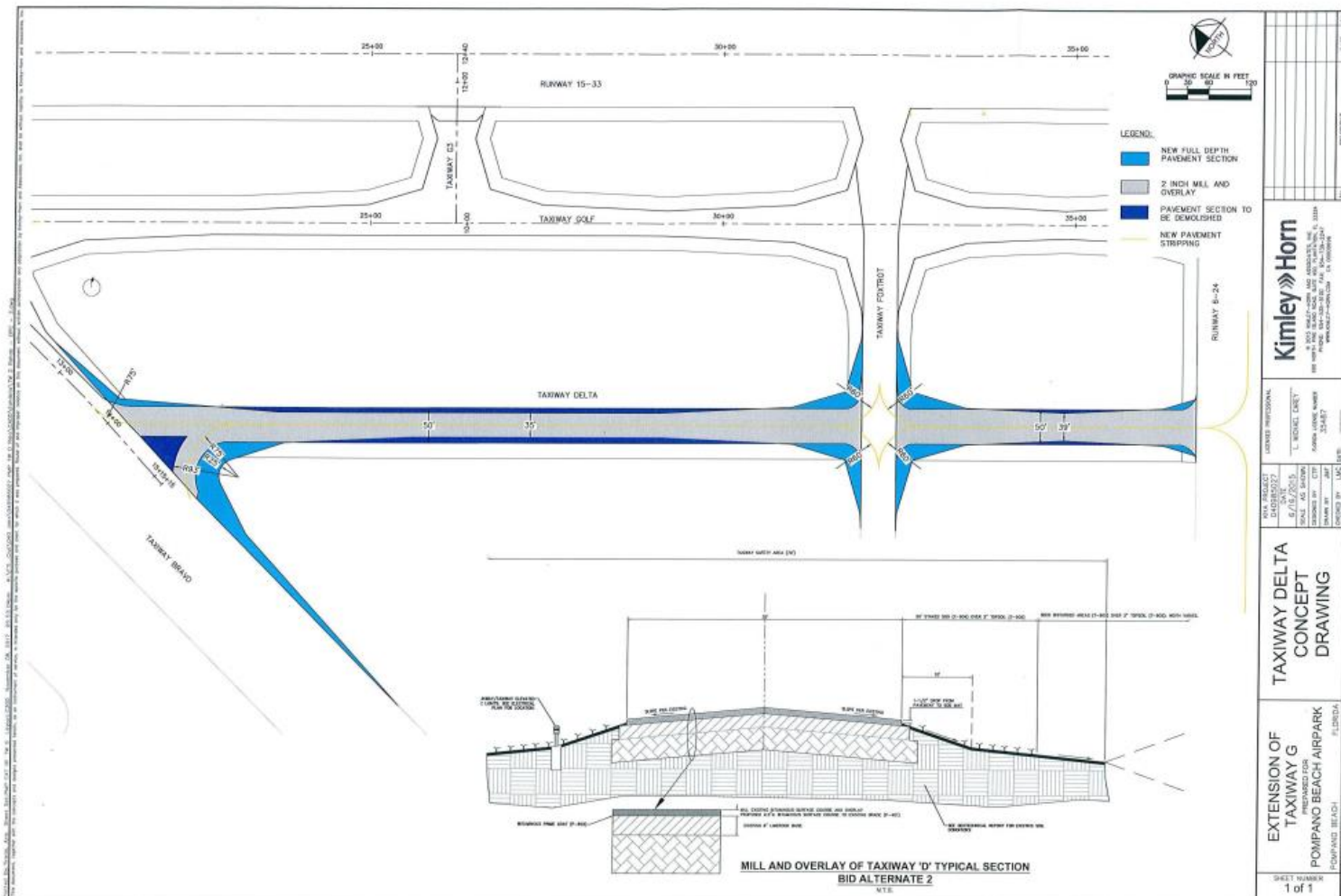

Kimley-Horn <small>INCORPORATED</small> <small>1000 N. W. 10TH AVE., SUITE 200, MIAMI, FL 33136</small> <small>TEL: 305.575.1100 FAX: 305.575.1101</small> <small>WWW.KIMLEY-HORN.COM</small>		DATE	1/10
TAXIWAY DELTA CONCEPT DRAWING		REVISIONS	
EXTENSION OF TAXIWAY G PREPARED FOR POMPANO BEACH AIRPORT POMPANO BEACH, FLORIDA		DATE	1/10
SHEET NUMBER 1 of 1		DATE	1/10