

STATE OF FLORIDA
DEPARTMENT OF TRANSPORTATION

CONTRACT PLANS

FINANCIAL PROJECT ID N/A
BROWARD COUNTY (86050)
STATE ROAD NO. A1A
STREETSCAPE IMPROVEMENTS

SIGNALIZATION PLANS

INDEX OF SIGNALIZATION PLANS

SHEET NO.	SHEET DESCRIPTION
T-1	KEY SHEET
T-2	TABULATION OF QUANTITIES
T-3	GENERAL NOTES
T-4 - T-7	SIGNALIZATION PLAN

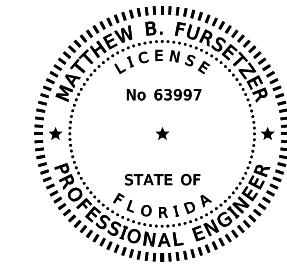
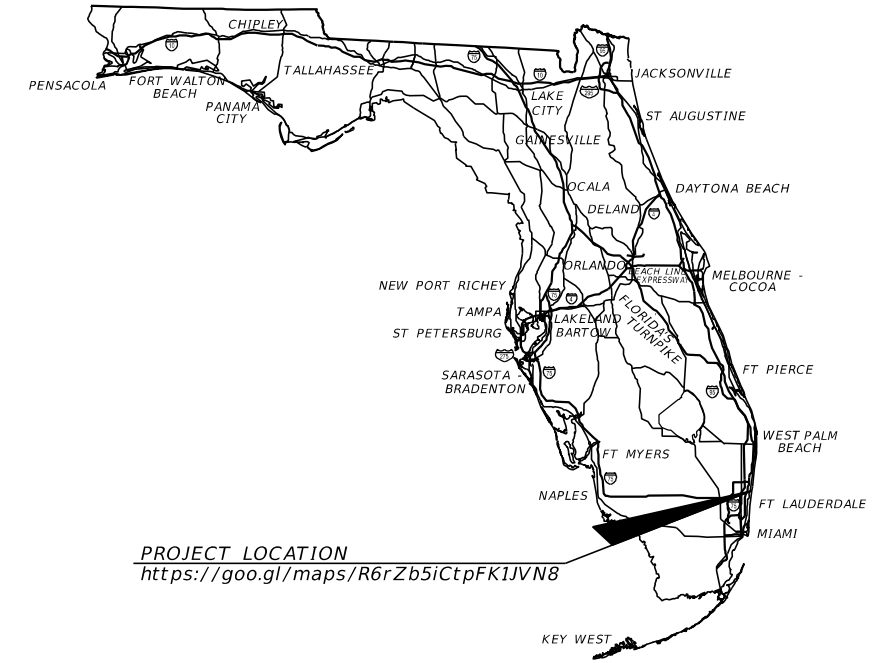

THIS DOCUMENT HAS BEEN DIGITALLY SIGNED AND SEALED BY:

ON THE DATE ADJACENT TO THE SEAL PRINTED COPIES OF THIS DOCUMENT ARE NOT CONSIDERED SIGNED AND SEALED. THE SIGNATURE MUST BE VERIFIED ON THE ELECTRONIC DOCUMENTS.

**SIGNALIZATION PLANS
ENGINEER OF RECORD:**

MATTHEW B. FURSETZER, P.E.
P.E. NO.: 63997
KIMLEY-HORN AND ASSOCIATES, INC.
1920 WEKIVA WAY, SUITE 200
WEST PALM BEACH, FLORIDA 33411
VENDOR NUMBER: F560885615-001
REGISTRY 696

CONSTRUCTION CONTRACT NO.	FISCAL YEAR	SHEET NO.
N/A	21	T-1

THE OFFICIAL RECORD OF THIS SHEET IS THE ELECTRONIC FILE DIGITALLY SIGNED AND SEALED UNDER RULE 61G15-23.004, F.A.C.

TABULATION OF QUANTITIES

PAY ITEM NO.	DESCRIPTION	UNIT	FM 441628-2-58-01	PB 19353	GRAND TOTAL
630 2 12	CONDUIT, FURNISH & INSTALL, DIRECTIONAL BORE	LF	463	375	838
632 7 2	SIGNAL CABLE - REPAIR/REPLACE/OTHER, FURNISH & INSTALL	LF	150	160	310
632 7 7	SIGNAL CABLE, REMOVE - OUTSIDE OF INTERSECTION	LF	125	145	270
635 2 11	PULL & SPLICE BOX, F&I, 13"X24" COVER SIZE	EA	15	12	27
646 1 11	ALUMINUM SIGNALS POLE, PEDESTAL	EA	6	6	12
646 1 60	ALUMINUM SIGNALS POLE, REMOVE	EA	3	1	4
653 1 11	PEDESTRIAN SIGNAL, FURNISH & INSTALL LED COUNTDOWN, 1 WAY	AS	9	8	17
653 1 60	PEDESTRIAN SIGNAL, REMOVE PED SIGNAL - POLE/PEDESTAL TO REMAIN	AS	4	5	9
665 1 11	PEDESTRIAN DETECTOR, FURNISH & INSTALL, STANDARD	EA	9	8	17
665 1 50	PEDESTRIAN DETECTOR, ADJUST/MODIFY ON EXISTING POLE	EA	1		1
665 1 60	PEDESTRIAN DETECTOR, REMOVE - POLE/PEDESTAL TO REMAIN	EA	4	5	9

REVISIONS				MATTHEW B. FURSETZER, P.E. P.E. LICENSE NUMBER 63997 KIMLEY-HORN AND ASSOCIATES, INC. 1920 WEKIVA WAY, SUITE 200 WEST PALM BEACH, FLORIDA 33411 REGISTRY 696	STATE OF FLORIDA DEPARTMENT OF TRANSPORTATION			TABULATION OF QUANTITIES	SHEET NO.
DATE	DESCRIPTION	DATE	DESCRIPTION		ROAD NO.	COUNTY	FINANCIAL PROJECT ID		T-2
					SR A1A	BROWARD	N/A		

THE OFFICIAL RECORD OF THIS SHEET IS THE ELECTRONIC FILE DIGITALLY SIGNED AND SEALED UNDER RULE 61G15-23.004, F.A.C.

SIGNALIZATION GENERAL NOTES:

1. AT LEAST 48 HOURS PRIOR TO BEGINNING CONSTRUCTION, THE CONTRACTOR SHALL PROVIDE WRITTEN NOTICE OF COMMENCEMENT, VIA EMAIL, TO TEINSPECTION@BROWARD.ORG. NOTICE SHALL INCLUDE THE DATE OF COMMENCEMENT, LOCATION AND TYPE OF WORK & INFORMATION REGARDING ANY MALFUNCTIONING SIGNAL EQUIPMENT. IT SHALL BE THE CONTRACTORS RESPONSIBILITY TO OBTAIN AND FILL OUT THE COUNTY'S "ACCEPTANCE OF TRAFFIC SIGNAL MAINTENANCE AND TIMING BY CONTRACTOR DURING CONSTRUCTION AND BURN-IN PERIOD" FORM LETTER, AVAILABLE AT BCTED, PRIOR TO COMMENCEMENT OF ANY WORK. MAINTENANCE OF THE SIGNAL OPERATION, INCLUDING TIMING ADJUSTMENTS, WILL BE THE RESPONSIBILITY OF THE CONTRACTOR UNTIL THE COUNTY ISSUES WRITTEN FINAL ACCEPTANCE OF THE INTERSECTION, AT WHICH TIME MAINTENANCE RESPONSIBILITIES ARE PROPERLY TRANSFERRED TO THE COUNTY.

2. APPROVAL OF SHOP DRAWINGS DOES NOT CONSTITUTE A WARRANTY THAT THE SIGNAL EQUIPMENT COMPLIES WITH THE STANDARDS OF THE MAINTAINING AGENCY. THE CONTRACTOR IS RESPONSIBLE FOR INSURING THAT THE PROPOSED SIGNAL EQUIPMENT MEETS THE REQUIREMENTS SPECIFIED IN THE CONTRACT, SPECIFICATIONS AND CONTRACT PLANS.

3. THE VIDEO DETECTION SYSTEM SHALL BE IN ACCORDANCE TO THE TECHNICAL SPECIFICATIONS INCLUDED IN THE 'Vehicle Detection Pay Item Notes' DOCUMENT POSTED ON THE BROWARD COUNTY TRAFFIC ENGINEERING WEBSITE AT: <http://www.broward.org/Traffic/Pages/Publications.aspx>. THE VIDEO DETECTION SYSTEM SHALL BE ON THE FLORIDA DEPARTMENT OF TRANSPORTATION (FDOT) APPROVED PRODUCTS LIST AND MEET ALL QUALIFYING SPECIFICATIONS AS DESCRIBED IN FDOT SECTION 660 "VEHICLE DETECTION SYSTEM" AS IT APPLIES TO VIDEO VEHICLE DETECTION SYSTEMS.

4. THE CONTRACTOR SHALL COORDINATE A FIELD MEETING WITH THE SIGNAL SUPERVISOR, PRIOR TO REMOVING ANY EXISTING EQUIPMENT, TO DETERMINE WHICH EQUIPMENT SHOULD BE DELIVERED TO BCTED. THE AGREED UPON EQUIPMENT SHALL BE DISASSEMBLED INTO THEIR COMPONENT PARTS, TAGGED AS TO LOCATION, PACKAGED AS NEEDED FOR PROTECTION FROM DAMAGE AND DELIVERED TO:

BROWARD COUNTY TRAFFIC ENGINEERING DIVISION
2300 WEST COMMERCIAL BLVD
FORT LAUDERDALE, FL 33309

ALL SIGNALIZATION EQUIPMENT THAT IS REMOVED AND NOT REQUESTED BY BCTED SHALL BE PROPERLY DISPOSED OF AT THE CONTRACTOR'S EXPENSE IN A MANNER AND LOCATION APPROVED BY THE SIGNAL SUPERVISOR.

THE SIGNAL SUPERVISOR IS TO BE CONTACTED AT 954-847-2600 AT LEAST 48 HOURS PRIOR TO DELIVERY. WRITTEN ACKNOWLEDGEMENT OF EQUIPMENT RECEIPT SHALL BE OBTAINED FROM THE SIGNAL SUPERVISOR IN THE FORM OF A SIGNED RECEIPT BEARING THE CONTRACTOR'S LETTERHEAD. THIS ITEMIZED RECEIPT SHALL STATE THAT ALL OF THE EQUIPMENT REMOVED FROM EACH LOCATION WAS RETURNED TO BCTED IN GOOD CONDITION. THE CONTRACTOR SHALL PRESENT THE RECEIPT TO BCTED AT THE TIME OF SIGNAL INSPECTION. ABSENCE OF SUCH RECEIPT SHALL BE RECORDED ON THE PUNCH LIST AS AN ITEM TO BE CORRECTED PRIOR TO FINAL APPROVAL OF THE INSTALLATION.

REVISIONS				MATTHEW B. FURSETZER, P.E. P.E. LICENSE NUMBER 63997 KIMLEY-HORN AND ASSOCIATES, INC. 1920 WEKIVA WAY, SUITE 200 WEST PALM BEACH, FLORIDA 33411 REGISTRY 696	STATE OF FLORIDA DEPARTMENT OF TRANSPORTATION			GENERAL NOTES	SHEET NO.
DATE	DESCRIPTION	DATE	DESCRIPTION		ROAD NO.	COUNTY	FINANCIAL PROJECT ID		
						SR A1A	BROWARD		N/A

EXIST. SIGNS TO BE REMOVED

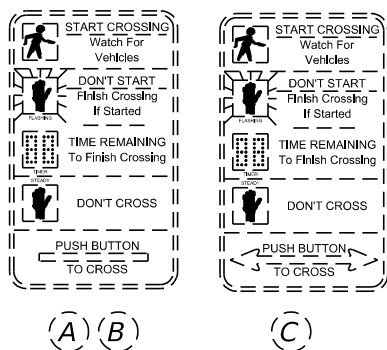

TO BE INSTALLED WITH PEDESTRIAN DETECTORS

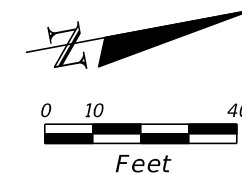
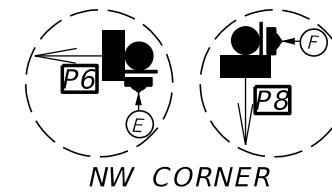
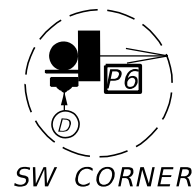
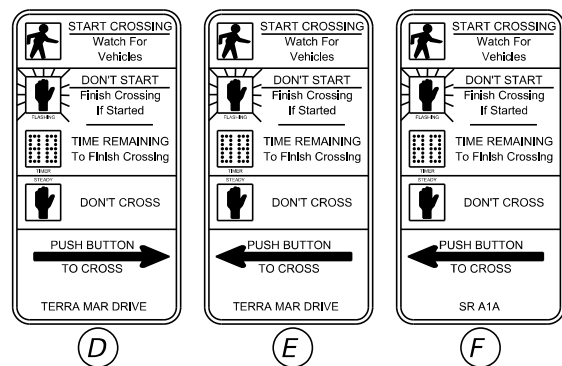

EXIST. PEDESTRIAN SIGNAL TO BE REMOVED

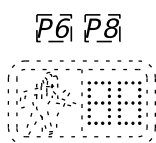

PROPOSED PEDESTRIAN SIGNAL

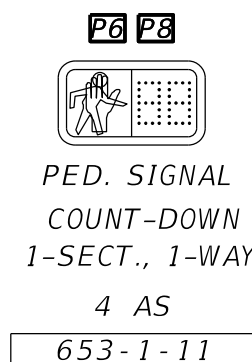

EXIST. MAST ARM TO REMAIN
EXIST. SIGN & PUSH BUTTON
TO BE REMOVED FROM MAST ARM
PROPOSED PUSH BUTTON & SIGN
TO BE INSTALLED ON MAST ARM
STA. 100+00, 29' LT

- 1 AS 653-1-11
- 1 AS 653-1-60
- 1 EA 665-1-11
- 1 EA 665-1-60

REMOVE EXIST PEDESTRIAN
DETECTOR & SIGNAL
646-1-60 1 EA

- ALUMINUM PEDESTAL
STA. 100+92, 29' LT
- 630-2-12 15 LF
 - 632-7-2 20 LF
 - 635-2-11 1 EA
 - 646-1-11 1 EA
 - 653-1-11 1 EA
 - 665-1-11 1 EA

- ALUMINUM PEDESTAL
STA. 100+92, 30' RT
- 630-2-12 16 LF
 - 632-7-2 25 LF
 - 635-2-11 1 EA
 - 646-1-11 1 EA
 - 653-1-11 1 EA
 - 665-1-11 1 EA

LEGEND

- PEDESTRIAN PUSH BUTTON AND SIGN
- PEDESTRIAN SIGNAL
- PEDESTRIAN MOVEMENT
- PROPOSED SIGN
- EXISTING SIGNAL CONTROLLER

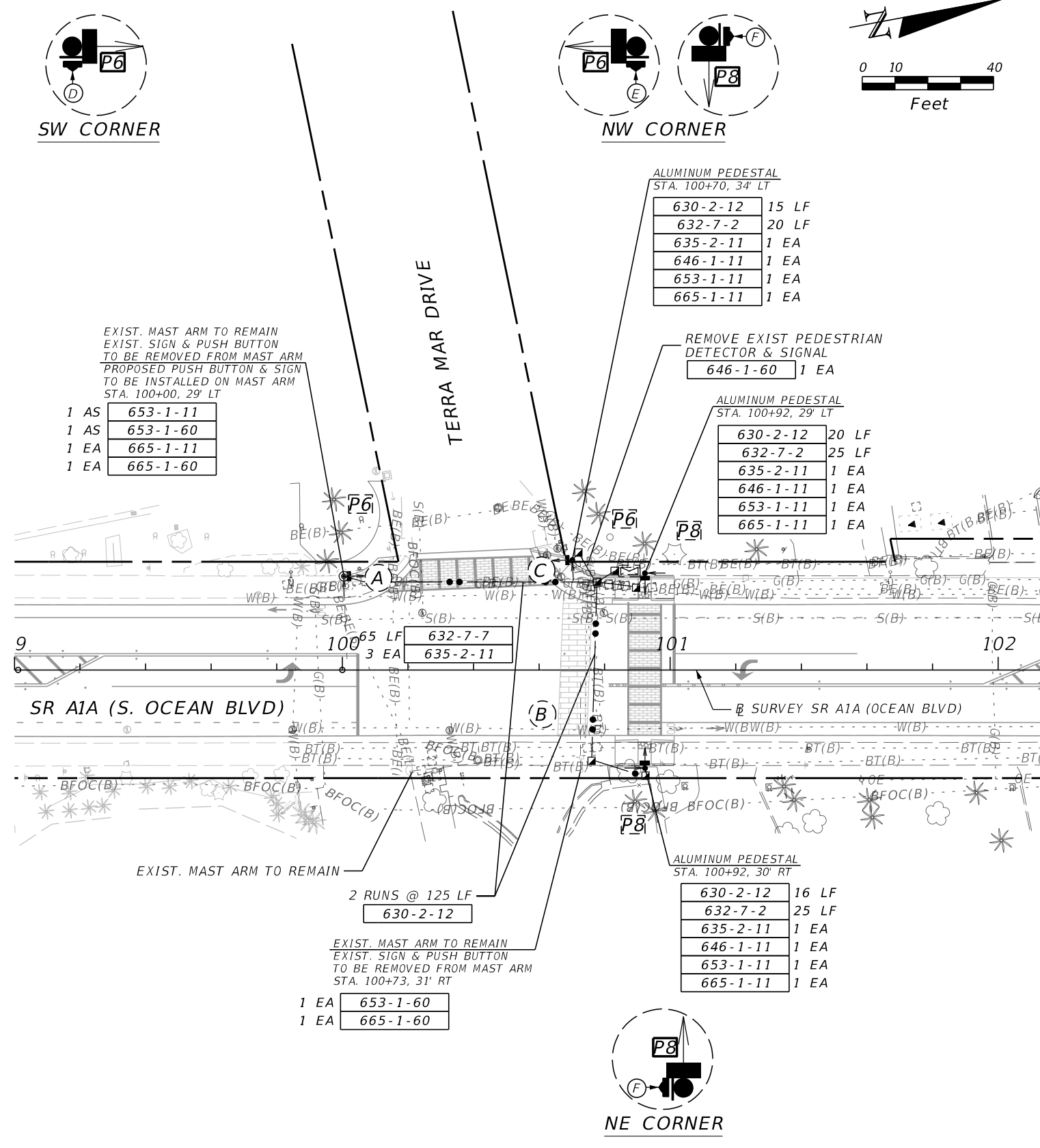

BCTED INTERSECTION ID 1325
TERRA MAR DR. & SR A1A

SIGNALIZATION PLAN

REVISIONS				MATTHEW B. FURSETZER, P.E. P.E. LICENSE NUMBER 63997 KIMLEY-HORN AND ASSOCIATES, INC. 1920 WEKIVA WAY, SUITE 200 WEST PALM BEACH, FLORIDA 33411 REGISTRY 696	STATE OF FLORIDA DEPARTMENT OF TRANSPORTATION			SHEET NO. T-4
DATE	DESCRIPTION	DATE	DESCRIPTION		ROAD NO.	COUNTY	FINANCIAL PROJECT ID	
					SR A1A	BROWARD	N/A	

THE OFFICIAL RECORD OF THIS SHEET IS THE ELECTRONIC FILE DIGITALLY SIGNED AND SEALED UNDER RULE 61G15-23.004, F.A.C.

EXIST. SIGNS TO BE REMOVED

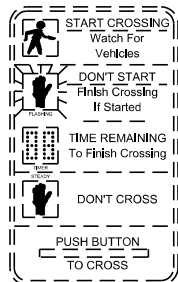

(A) (B) (C)

TO BE INSTALLED WITH PEDESTRIAN DETECTORS

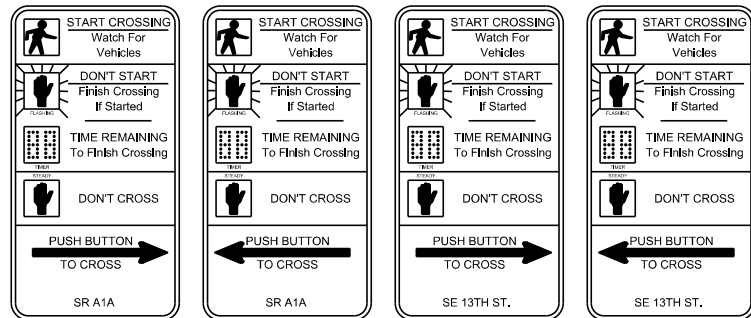

(D) (E) (F) (G)

EXIST. PEDESTRIAN SIGNAL TO BE REMOVED

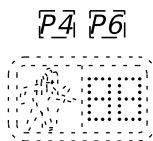

PROPOSED PEDESTRIAN SIGNAL

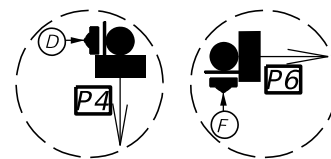
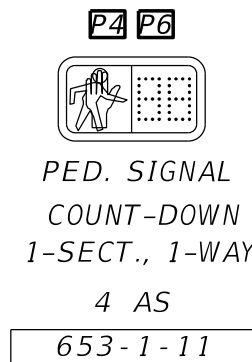

SW CORNER

EXIST. MAST ARM TO REMAIN
EXIST. SIGN & PUSH BUTTON TO BE REMOVED FROM MAST ARM
PROPOSED PUSH BUTTON & SIGN TO BE INSTALLED ON MAST ARM
STA. 120+22.67' LT

1 AS	653-1-11
1 AS	653-1-60
1 EA	665-1-11
1 EA	665-1-60

ALUMINUM PEDESTAL
STA. 120+06, 61' LT

15 LF	630-2-12
20 LF	632-7-2
1 EA	635-2-11
1 EA	646-1-11
1 AS	653-1-11
1 EA	665-1-11

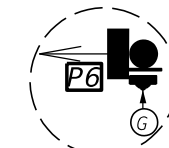

NW CORNER

EXIST. MAST ARM TO REMAIN
EXIST. SIGN & PUSH BUTTON TO BE REMOVED FROM MAST ARM
PROPOSED PUSH BUTTON & SIGN TO BE INSTALLED ON MAST ARM
STA. 120+90.59' LT

653-1-11	1 AS
653-1-60	1 AS
665-1-11	1 EA
665-1-60	1 EA

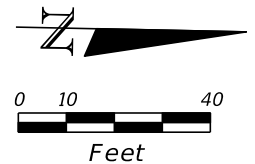
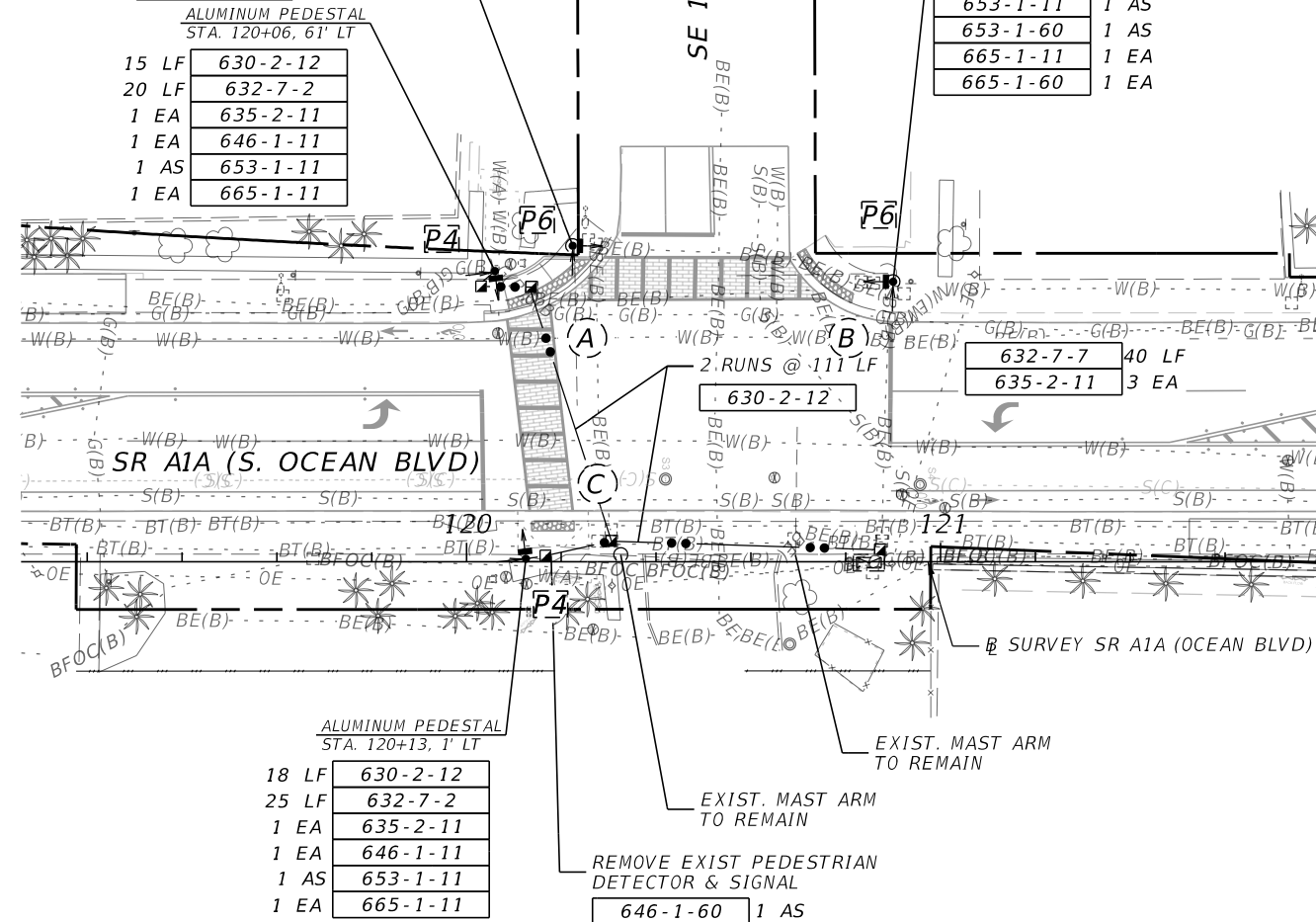

LEGEND

- PEDESTRIAN PUSH BUTTON AND SIGN
- PEDESTRIAN SIGNAL
- PEDESTRIAN MOVEMENT
- PROPOSED SIGN
- EXISTING SIGNAL CONTROLLER



SE CORNER

BCTED INTERSECTION ID 1327
SE 13TH ST. & SR A1A

REVISIONS				MATTHEW B. FURSETZER, P.E. P.E. LICENSE NUMBER 63997 KIMLEY-HORN AND ASSOCIATES, INC. 1920 WEKIVA WAY, SUITE 200 WEST PALM BEACH, FLORIDA 33411 REGISTRY 696	STATE OF FLORIDA DEPARTMENT OF TRANSPORTATION			SHEET NO. T-5
DATE	DESCRIPTION	DATE	DESCRIPTION		ROAD NO.	COUNTY	FINANCIAL PROJECT ID	
					SR A1A	BROWARD	N/A	

EXIST. SIGNS TO BE REMOVED

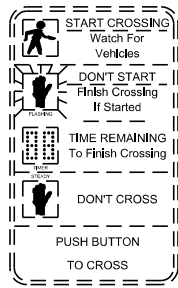

(A) (B)

TO BE INSTALLED WITH PEDESTRIAN DETECTORS

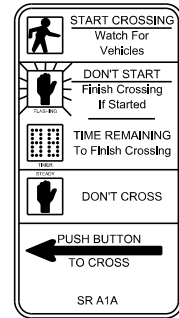

(D)

EXIST. PEDESTRIAN SIGNAL TO BE REMOVED

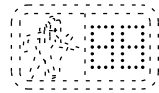

PROPOSED PEDESTRIAN SIGNAL

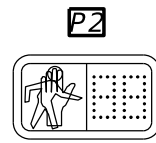

PED. SIGNAL
COUNT-DOWN
1-SECT., 1-WAY
1 AS
653-1-11

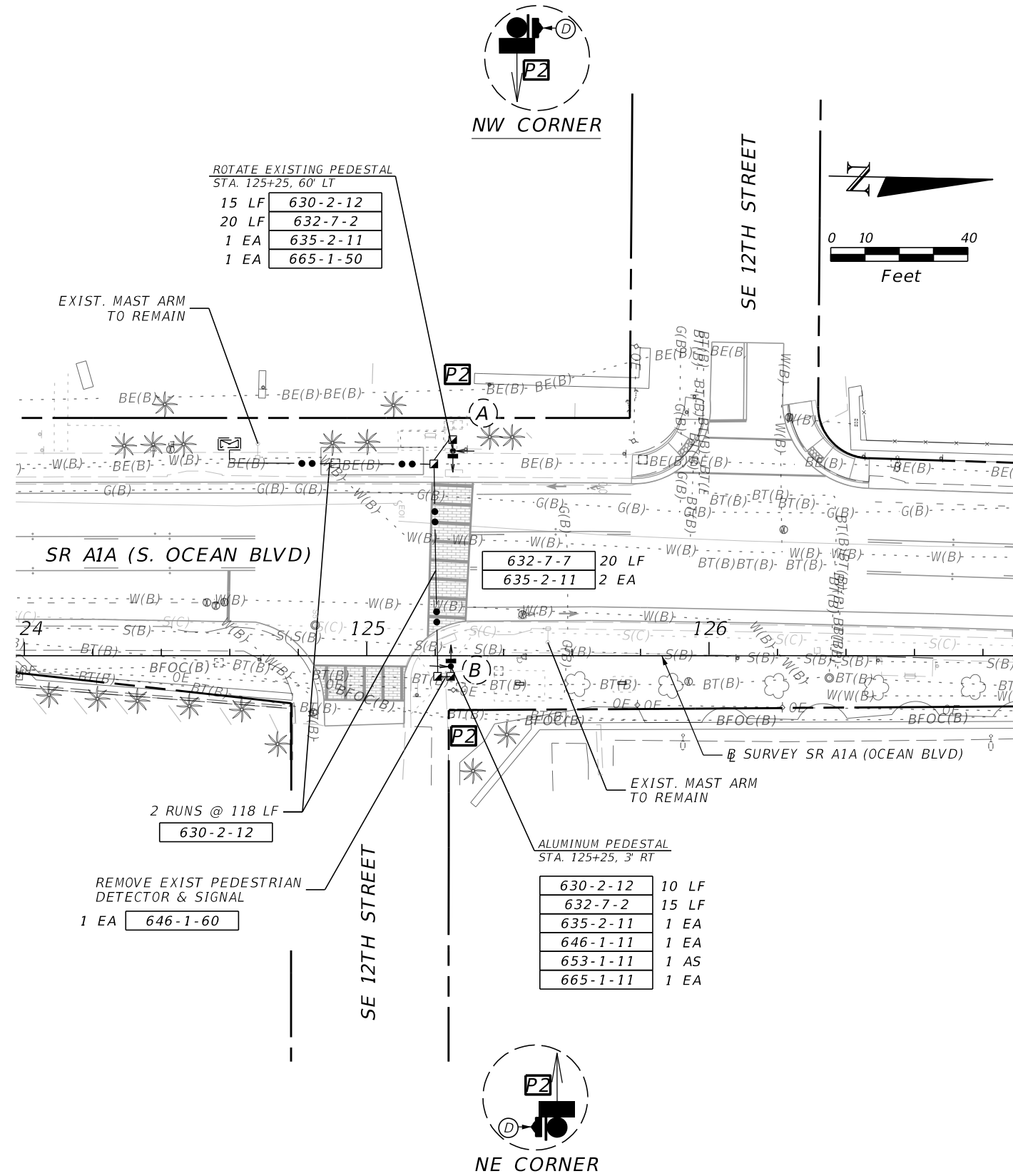

ROTATE EXISTING PEDESTAL
STA. 125+25, 60' LT
15 LF 630-2-12
20 LF 632-7-2
1 EA 635-2-11
1 EA 665-1-50

NW CORNER

SE 12TH STREET

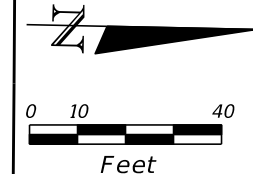

SR A1A (S. OCEAN BLVD)

2 RUNS @ 118 LF
630-2-12

REMOVE EXIST PEDESTRIAN
DETECTOR & SIGNAL
1 EA 646-1-60

632-7-7 20 LF
635-2-11 2 EA

ALUMINUM PEDESTAL
STA. 125+25, 3' RT
630-2-12 10 LF
632-7-2 15 LF
635-2-11 1 EA
646-1-11 1 EA
653-1-11 1 AS
665-1-11 1 EA



NE CORNER

LEGEND

- PEDESTRIAN PUSH BUTTON AND SIGN
- PEDESTRIAN SIGNAL
- PEDESTRIAN MOVEMENT
- PROPOSED SIGN
- EXISTING SIGNAL CONTROLLER

BCTED INTERSECTION ID 1372
SE 12TH ST. & SR A1A

REVISIONS				MATTHEW B. FURSETZER, P.E. P.E. LICENSE NUMBER 63997 KIMLEY-HORN AND ASSOCIATES, INC. 1920 WEKIVA WAY, SUITE 200 WEST PALM BEACH, FLORIDA 33411 REGISTRY 696	STATE OF FLORIDA DEPARTMENT OF TRANSPORTATION			SHEET NO. T-6
DATE	DESCRIPTION	DATE	DESCRIPTION		ROAD NO.	COUNTY	FINANCIAL PROJECT ID	
					SR A1A	BROWARD	N/A	

THE OFFICIAL RECORD OF THIS SHEET IS THE ELECTRONIC FILE DIGITALLY SIGNED AND SEALED UNDER RULE 61G15-23.004, F.A.C.

EXIST. SIGNS TO BE REMOVED

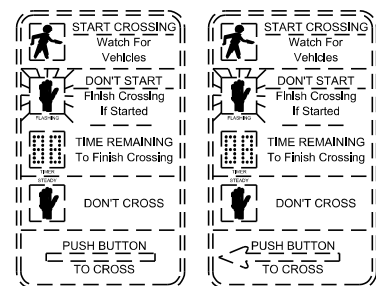

(A) (B) (C) (D) (E)

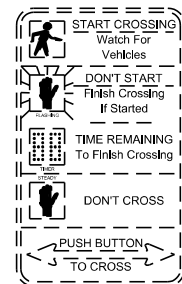

(F)

EXIST. PEDESTRIAN SIGNAL TO BE REMOVED

P2 P4 P6 P8

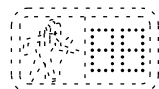

LEGEND

- PEDESTRIAN PUSH BUTTON AND SIGN
- PEDESTRIAN SIGNAL
- PEDESTRIAN MOVEMENT
- PROPOSED SIGN
- EXISTING SIGNAL CONTROLLER

TO BE INSTALLED WITH PEDESTRIAN DETECTORS

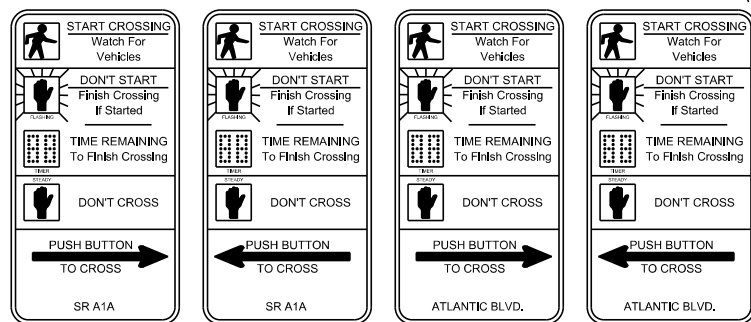

(G) (H) (K) (L)

PROPOSED PEDESTRIAN SIGNAL

P2 P4 P6 P8

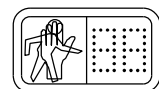

PED. SIGNAL COUNT-DOWN 1-SECT., 1-WAY

8 AS

653-1-11

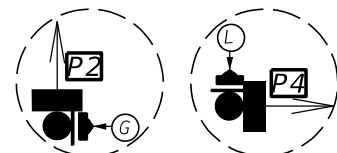

SE CORNER

SW CORNER

ALUMINUM PEDESTAL STA. 157+29, 43' LT

10 LF	630-2-12
15 LF	632-7-2
1 EA	635-2-11
1 EA	646-1-11
1 EA	646-1-60
1 AS	653-1-11
1 EA	665-1-11

ALUMINUM PEDESTAL STA. 157+12, 39' LT

20 LF	630-2-12
25 LF	632-7-2
1 EA	635-2-11
1 EA	646-1-11
1 AS	653-1-11
1 EA	665-1-11

ALUMINUM PEDESTAL STA. 157+08, 39' RT

25 LF	630-2-12
30 LF	632-7-2
1 EA	635-2-11
1 EA	646-1-11
1 AS	653-1-11
1 EA	665-1-11

REMOVE EXIST PEDESTRIAN DETECTOR & SIGNAL

1 AS	653-1-60
1 EA	665-1-60

ALUMINUM PEDESTAL STA. 157+56, 48' RT

15 LF	630-2-12
20 LF	632-7-2
1 EA	635-2-11
1 EA	646-1-11
1 AS	653-1-11
1 EA	665-1-11

NW CORNER

ALUMINUM PEDESTAL STA. 33+29, 59' LT

630-2-12	25 LF
632-7-2	30 LF
635-2-11	1 EA
646-1-11	1 EA
653-1-11	1 AS
665-1-11	1 EA

REMOVE EXIST. PED. SIGNALS

653-1-60	1 AS
665-1-60	1 EA

EXIST. MAST ARM TO REMAIN EXIST. SIGN & PUSH BUTTON TO BE REMOVED FROM MAST ARM PROPOSED PUSH BUTTON & SIGN TO BE INSTALLED ON MAST ARM STA. 33+34.38' LT

653-1-11	1 AS
653-1-60	1 AS
665-1-11	1 EA
665-1-60	1 EA

ALUMINUM PEDESTAL STA. 33+58, 40' RT

630-2-12	35 LF
632-7-2	40 LF
635-2-11	1 EA
646-1-11	1 EA
653-1-11	1 AS
665-1-11	1 EA

EXIST. MAST ARM TO REMAIN EXIST. SIGN & PUSH BUTTON TO BE REMOVED FROM MAST ARM STA. 33+37, 38' RT

653-1-60	1 AS
665-1-60	1 EA

EXIST. MAST ARM TO REMAIN EXIST. SIGN & PUSH BUTTON TO BE REMOVED FROM MAST ARM PROPOSED PUSH BUTTON & SIGN TO BE INSTALLED ON MAST ARM STA. 33+28.47' RT

653-1-11	1 AS
653-1-60	1 AS
665-1-11	1 EA
665-1-60	1 EA

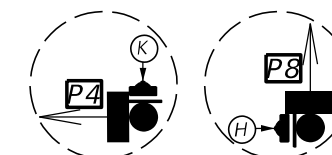

NE CORNER

BCTED INTERSECTION ID 1331 ATLANTIC BLVD. & SR A1A

REVISIONS			
DATE	DESCRIPTION	DATE	DESCRIPTION

MATTHEW B. FURSETZER, P.E.
P.E. LICENSE NUMBER 63997
KIMLEY-HORN AND ASSOCIATES, INC.
1920 WEKIVA WAY, SUITE 200
WEST PALM BEACH, FLORIDA 33411
REGISTRY 696

STATE OF FLORIDA DEPARTMENT OF TRANSPORTATION		
ROAD NO.	COUNTY	FINANCIAL PROJECT ID
SR A1A	BROWARD	N/A

SIGNALIZATION PLAN

SHEET NO.
T-7

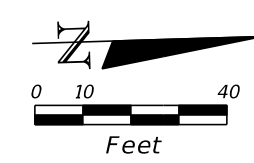

THE OFFICIAL RECORD OF THIS SHEET IS THE ELECTRONIC FILE DIGITALLY SIGNED AND SEALED UNDER RULE 61G15-23.004, F.A.C.