

LEGEND	
	ACCESSIBLE PARKING SYMBOL
	BACK FLOW PREVENTOR
	BENCH MARK
	BIKE SYMBOL
	BOLLARD
	CATCH BASIN
	CLEAN OUT
	CONCRETE LIGHT POLE
	CONCRETE UTILITY POLE
	DOUBLE DETECTOR CHECK VALVE
	ELECTRIC HANDHOLE
	ELECTRIC METER
	ELECTRIC OUTLET
	ELECTRIC PANEL
	FIRE HYDRANT
	GUY WIRE ANCHOR
	IRON PIPE
	IRON ROD
	IRON ROD & CAP
	IRRIGATION CONTROL VALVE
	IRRIGATION PUMP
	LIFT STATION
	MONITORING WELL
	NAIL
	NATURAL GAS METER
	PERMANENT REFERENCE MONUMENT
	CONCRETE POST
	PALM TREE
	SANITARY MANHOLE
	SANITARY VAULT
	SIGN POST
	SPRINKLER HEAD
	STORM SEWER MANHOLE
	TELEVISION PEDESTAL
	TRASH CAN
	TREE
	WATER METER
	WATER VALVE
	WOOD UTILITY POLE
	YARD DRAIN

MISC. LINETYPES

	CHAINLINK FENCE
	HANDRAIL
	METAL FENCE
	OVERHEAD WIRE
	WOOD FENCE

TREE TABLE:

TREE NUMBER	TREE TYPE	DBH
1219	OAK	4
1223	PALM	12
1307	STRANGLER FIG	52
1308	PALM	12
1309	PALM	12
1310	PALM	12
1313	PALM	4
1319	OAK	24
1320	PALM	5
1321	PALM (3)	5
1323	PALM	4
1336	ROYAL	8
1337	POINCIANA	8
1342	UNKNOWN	14
1343	PALM	14
1344	PALM	14
1345	STRANGLER FIG	82
1367	OAK	5
1368	OAK	5
1376	OAK	5
1405	GUMBO LIMBO	4
1644	PALM	4
1660	OAK	14
1825	PALM	18
1826	SCHEFFLERA	6
1827	SCHEFFLERA	6
1828	PALM	12
1829	PALM	14
1830	UNKNOWN	60
1831	SCHEFFLERA	6
1832	SCHEFFLERA	6
1833	SCHEFFLERA	12
1834	PALM	14
1835	PALM	14
1874	PALM	6
1875	PALM	6
1936	OAK	5
1937	OAK	5
1970	PALM	6
1992	PINE	15
1993	PINE	15
1995	PINE	20
1996	PINE	20
1997	PINE	20
1998	PINE	20
1999	PINE	14
2000	PINE	20
2001	OAK	10
2002	OAK	24
2003	MAHOGANY	12
2004	PINE	24
2075	PALM	13
2076	PALM	14
2077	PALM	15
2078	PALM	6
2163	OAK	6
2164	PINE	20
2166	PINE	24
2167	PINE	18
2168	PINE	20
2172	PINE	24
2173	PINE	24
2174	PINE	24
2179	OAK	18
2180	OAK	18
2181	OAK	8
2182	PINE	24
2222	UNKNOWN	6
2226	OAK	22
2227	UNKNOWN	6
2353	UNKNOWN	4
2361	UNKNOWN	5
2368	UNKNOWN	5
2392	UNKNOWN	5
2398	OAK	20
2418	OAK	24
2423	SCHEFFLERA	6
2424	SCHEFFLERA	6
2425	SCHEFFLERA	6
2426	SCHEFFLERA	6
2427	SCHEFFLERA	6
2429	SCHEFFLERA	6
2430	SCHEFFLERA	6
2431	PALM	16
2432	SCHEFFLERA	6
2433	PALM	16
2434	PALM	16
2435	PALM	16
2436	SCHEFFLERA	6
2437	GUMBO LIMBO	5
2479	PALM	8
2491	PALM	6
2498	PALM	10
2557	PALM	6
2585	BLACK OLIVE	2
2592	PALM	10
2593	PALM	5
2600	OAK	20
2647	SCHEFFLERA	6
2648	PALM	16
2649	SCHEFFLERA	6
2650	SCHEFFLERA	6
2651	PALM	16
2652	PALM	16
2653	PALM	16
2676	PALM	16
2678	UNKNOWN	10
2679	SCHEFFLERA	6
2680	SCHEFFLERA	6
2681	SCHEFFLERA	6
2682	SCHEFFLERA	6
2683	PALM	4
2705	PINE	6
2733	OAK	5
2734	OAK	5
2735	OAK	5
2747	UNKNOWN	10
2754	PALM	18
2755	PALM	18
2756	UNKNOWN	10
2759	UNKNOWN	6
2768	PALM	14
2769	PALM	14
2775	PALM	14
2776	UNKNOWN	6
2777	UNKNOWN	6
2778	UNKNOWN	6
2779	UNKNOWN	6
2780	PALM	10
2781	PALM	10
2782	PALM	10
2783	PALM	10
2784	PALM	10
2785	PALM	14
2801	PALM	12
2802	PALM	12
2803	PALM	14
2804	PALM	14
2813	UNKNOWN	8
2814	SCHEFFLERA	6
2815	SCHEFFLERA	6
2816	SCHEFFLERA	6
2817	UNKNOWN	4
2818	STRANGLER FIG	20
2819	PALM	16
2820	PALM	12
2840	UNKNOWN	10
2841	PALM	14
2877	SCHEFFLERA	6
2884	PINE	30
2889	PALM	10
2912	PALM	10
2919	PINE	19
2920	PINE	12
2921	PINE	8
2922	PINE	24
2923	PINE	18
2924	PINE	12
2925	PINE	15
2926	PINE	6
2927	PINE	20
2928	PINE	24
2929	UNKNOWN	5
2945	UNKNOWN	3
2946	UNKNOWN	3
2947	UNKNOWN	3
2948	UNKNOWN	6
2949	UNKNOWN	6
2950	PINE	36
2955	PINE	36
2956	PINE	36
2957	PINE	15
2958	PINE	24
2971	PALM	10
2972	PALM	10
2973	PALM	12
2974	PALM	10
2975	UNKNOWN	4
2986	STRANGLER FIG	30
2987	BLACK OLIVE	18
2994	PALM	10
2995	PALM	12
2996	PALM	12
2997	PALM	12
2998	PALM	12
2999	PALM	12
3005	PALM	10
3006	PALM	10
3007	PALM	10
3008	PALM	10
3009	PALM	10
3012	PALM	12
3015	SCHEFFLERA	5
3016	UNKNOWN	10
3017	PALM	12

ABBREVIATIONS	
B.C.R.	BROWARD COUNTY RECORDS
(C)	CALCULATED MEASUREMENT
CB	CATCH BASIN
CLF	CHAIN LINK FENCE
CONC.	CONCRETE
CBS	CONCRETE BLOCK STRUCTURE
(D)	MEASUREMENT PER DESCRIPTION
DBH	DIAMETER AT BREST HEIGHT
DWS	DETECTABLE WARNING SURFACE
E.	EAST
ELEV.	ELEVATION
F.F.	FINISH FLOOR
ID	IDENTIFICATION
INV.	INVERT
IRC	IRON ROD AND ID CAP
L	ARC LENGTH (CURVE DATA)
LB	FLORIDA LICENSE BUSINESS NUMBER
MAG	MAGNETIC
MF	METAL FENCE
N.	NORTH

NE.	NORTHEAST
NW.	NORTHWEST
OHW	OVERHEAD WIRES
O.R.B.	OFFICIAL RECORDS BOOK
(P)	MEASUREMENT PER PLAT
PG.	PAGE
P.B.	PLAT BOOK
P.O.B.	POINT OF BEGINNING
P.O.C.	POINT OF COMMENCEMENT
PRM	PERMANENT REFERENCE MONUMENT
PVC	POLYVINYL CHLORIDE PIPE
R	RADIUS (CURVE DATA)
R/W	RIGHT-OF-WAY
RCP	REINFORCED CONCRETE PIPE
S.	SOUTH
SE.	SOUTHEAST
SR	STATE ROAD
SW.	SOUTHWEST
TYP.	TYPICAL
W.	WEST
WF	WOOD FENCE
Δ	DELTA/CENTRAL ANGLE (CURVE DATA)

LEGAL DESCRIPTION:

PARCEL "A", MOTEL 6 - POMPANO BEACH, ACCORDING TO THE PLAT THEREOF, AS RECORDED IN PLAT BOOK 112, PAGE 27, OF THE PUBLIC RECORDS OF BROWARD COUNTY, FLORIDA.

TOGETHER WITH:

PARCEL 2:

THE SOUTH 180 FEET OF THE FOLLOWING PARCEL OF LAND: A PORTION OF THE NE 1/4 OF SECTION 32 AND A PORTION OF THE NW 1/4 OF SECTION 33, TOWNSHIP 48 SOUTH, RANGE 42 EAST, BEING MORE PARTICULARLY DESCRIBED AS FOLLOWS:

COMMENCE AT THE SOUTHWEST CORNER OF THE NW 1/4 OF THE NW 1/4 OF SECTION 33, TOWNSHIP 48 SOUTH, RANGE 42 EAST, AND RUN ON AN ASSUMED BEARING OF N89°51'07"E, ALONG THE SOUTH LINE OF THE SAID NW 1/4 OF SECTION 33 FOR 696.91 FEET TO A POINT OF INTERSECTION WITH THE WESTERLY RIGHT-OF-WAY LINE OF ATLANTIC BOULEVARD EXTENSION; THENCE RUN N15°51'17"E, ALONG THE SAID WESTERLY RIGHT-OF-WAY LINE OF ATLANTIC BOULEVARD EXTENSION FOR 536.04 FEET TO A POINT OF CURVATURE; THENCE CONTINUE ALONG THE SAID WESTERLY RIGHT-OF-WAY LINE OF ATLANTIC BOULEVARD EXTENSION ALONG A CURVE TO THE LEFT HAVING A RADIUS OF 1859.86 FEET AND A CENTRAL ANGLE OF 5°38'56" FOR AN ARC DISTANCE OF 183.36 FEET TO THE POINT OF BEGINNING; THENCE RUN WESTERLY ON A BEARING OF S88°35'42"W TO AN INTERSECTION WITH THE EAST RIGHT-OF-WAY LINE OF THE SUNSHINE STATE PARKWAY; THENCE SOUTHWESTERLY ALONG THE EAST RIGHT-OF-WAY LINE OF THE SUNSHINE STATE PARKWAY TO A POINT, BEING THE INTERSECTION OF A LINE 360 FEET SOUTH OF AND PARALLEL TO THE ABOVE DESCRIBED EAST-WEST LINE; THENCE RUN EASTERLY ON A BEARING OF N88°35'42"E TO A POINT OF INTERSECTION WITH THE WEST RIGHT-OF-WAY LINE OF ATLANTIC BOULEVARD EXTENSION; THENCE RUN NORTHERLY ALONG THE WEST RIGHT-OF-WAY LINE OF ATLANTIC BOULEVARD EXTENSION TO THE POINT OF BEGINNING;

SAID LANDS SITUATE, LYING AND BEING IN BROWARD COUNTY, FLORIDA.

TOGETHER WITH THE FOLLOWING DESCRIBED PARCEL OF LAND:

A PORTION OF THE NE 1/4 OF SECTION 32 AND A PORTION OF THE NW 1/4 OF SECTION 33, TOWNSHIP 48 SOUTH, RANGE 42 EAST, BEING MORE PARTICULARLY DESCRIBED AS FOLLOWS:

COMMENCE AT THE SOUTHWEST CORNER OF THE NW 1/4 OF THE NW 1/4 OF SECTION 33, TOWNSHIP 48 SOUTH, RANGE 42 EAST, AND RUN ON AN ASSUMED BEARING OF NORTH 89°51'07" EAST, ALONG THE SOUTH LINE OF THE SAID NW 1/4 OF SECTION 33 FOR 696.91 FEET TO A POINT OF INTERSECTION WITH THE WESTERLY RIGHT-OF-WAY LINE OF ATLANTIC BOULEVARD EXTENSION; THENCE RUN NORTH 15°51'17" EAST, ALONG THE SAID WESTERLY RIGHT-OF-WAY LINE OF ATLANTIC BOULEVARD EXTENSION FOR 536.04 FEET TO A POINT OF CURVATURE; THENCE CONTINUE ALONG THE SAID WESTERLY RIGHT-OF-WAY LINE OF ATLANTIC BOULEVARD EXTENSION ALONG A CURVE TO THE LEFT HAVING A RADIUS OF 1859.86 FEET AND A CENTRAL ANGLE OF 5°38'56" FOR AN ARC DISTANCE OF 183.36 FEET TO THE POINT OF BEGINNING; THENCE RUN WESTERLY ON A BEARING OF SOUTH 88°35'42" WEST TO AN INTERSECTION WITH THE EAST RIGHT-OF-WAY LINE OF THE SUNSHINE STATE PARKWAY; THENCE SOUTHWESTERLY ALONG THE EAST RIGHT-OF-WAY LINE OF THE SUNSHINE STATE PARKWAY TO A POINT, BEING THE INTERSECTION OF A LINE 180 FEET SOUTH OF AND PARALLEL TO THE ABOVE DESCRIBED EAST-WEST LINE; THENCE RUN EASTERLY ON A BEARING OF NORTH 88°35'42" EAST TO A POINT OF INTERSECTION WITH THE WEST RIGHT-OF-WAY LINE OF ATLANTIC BOULEVARD EXTENSION; THENCE RUN NORTHERLY ALONG THE WEST RIGHT-OF-WAY LINE OF ATLANTIC BOULEVARD EXTENSION TO THE POINT OF BEGINNING;

SAID LANDS SITUATE, LYING AND BEING IN BROWARD COUNTY, FLORIDA.

LESS AND EXCEPT FROM PARCEL 2 THE FOLLOWING TWO PARCELS OF LAND:

LESS OUT A:

ALL OF THE PLAT OF MOTEL 6 - POMPANO BEACH, ACCORDING TO THE PLAT THEREOF RECORDED IN PLAT BOOK 112, PAGE 27, INCLUDING BUT NOT LIMITED TO THAT CERTAIN 50 FOOT ADDITIONAL RIGHT OF WAY DEDICATED BY THE PLAT.

LESS OUT B:

ALL OF THAT CERTAIN PARCEL OF LAND CONVEYED BY MOTEL 6 OPERATING, L.P. TO MICHAEL L. THOMAS, TRUSTEE, BY THE SPECIAL WARRANTY DEED RECORDED IN OFFICIAL RECORDS BOOK 16308, PAGE 161, AND DESCRIBED AS FOLLOWS:

A PORTION OF THE NE 1/4 OF SECTION 32 AND A PORTION OF THE NW 1/4 OF SECTION 33, TOWNSHIP 48 SOUTH, RANGE 42 EAST, BROWARD COUNTY, FLORIDA, AND A PORTION OF PARCEL "A" OF "MOTEL 6 - POMPANO BEACH", AS RECORDED IN PLAT BOOK 112, PAGE 27, OF THE PUBLIC RECORDS OF BROWARD COUNTY, FLORIDA, BEING MORE PARTICULARLY DESCRIBED AS FOLLOWS:

COMMENCING AT THE SOUTHEAST CORNER OF SAID PARCEL "A", RUN ON AN ASSUMED BEARING S88°44'35"W, ALONG THE SOUTH LINE OF SAID PARCEL "A", ALSO BEING THE NORTH LINE OF PARCEL "A" OF "NEILL PLAT", AS RECORDED IN PLAT BOOK 89, PAGE 20, OF THE PUBLIC RECORDS OF BROWARD COUNTY, FLORIDA, 450.50 FEET TO A POINT OF BEGINNING; THENCE CONTINUE S88°44'35"W, ALONG THE LAST DESCRIBED LINE 452.95 FEET TO THE EASTERLY RIGHT-OF-WAY LINE OF SUNSHINE STATE PARKWAY; THENCE NORTHEASTERLY ALONG SAID RIGHT-OF-WAY LINE AND ALONG A CURVE TO THE LEFT WHOSE TANGENT BEARS N26°17'51.8"E AT THAT POINT, WITH A RADIUS OF 7789.44 FEET AND A CENTRAL ANGLE OF 2°56'55", AN ARC DISTANCE OF 400.86 FEET; THENCE N88°44'35"E 276.74 FEET TO THE NORTHWEST CORNER OF SAID "MOTEL 6 - POMPANO BEACH"; THENCE S01°15'25"E 360 FEET TO THE POINT OF BEGINNING.

LESS THAT PORTION OF PARCEL "A" OF "MOTEL 6 - POMPANO BEACH", AS RECORDED IN PLAT BOOK 112, PAGE 27, OF THE PUBLIC RECORDS OF BROWARD COUNTY, FLORIDA, DESCRIBED AS FOLLOWS:

COMMENCING AT THE SOUTHEAST CORNER OF SAID PARCEL "A", RUN ON AN ASSUMED BEARING OF S88°44'35"W 450.50 FEET TO THE POINT OF BEGINNING; THENCE CONTINUE S88°44'35"W 222 FEET; THENCE N01°15'25"E 150 FEET; THENCE N88°44'35"E 222 FEET; THENCE S01°15'25"E 150 FEET TO THE POINT OF BEGINNING.

SAID LANDS SITUATE, LYING AND BEING IN THE CITY OF POMPANO BEACH, BROWARD COUNTY, FLORIDA AND CONTAINING 228, 192 SQUARE FEET (5.19 ACRES), MORE OR LESS.

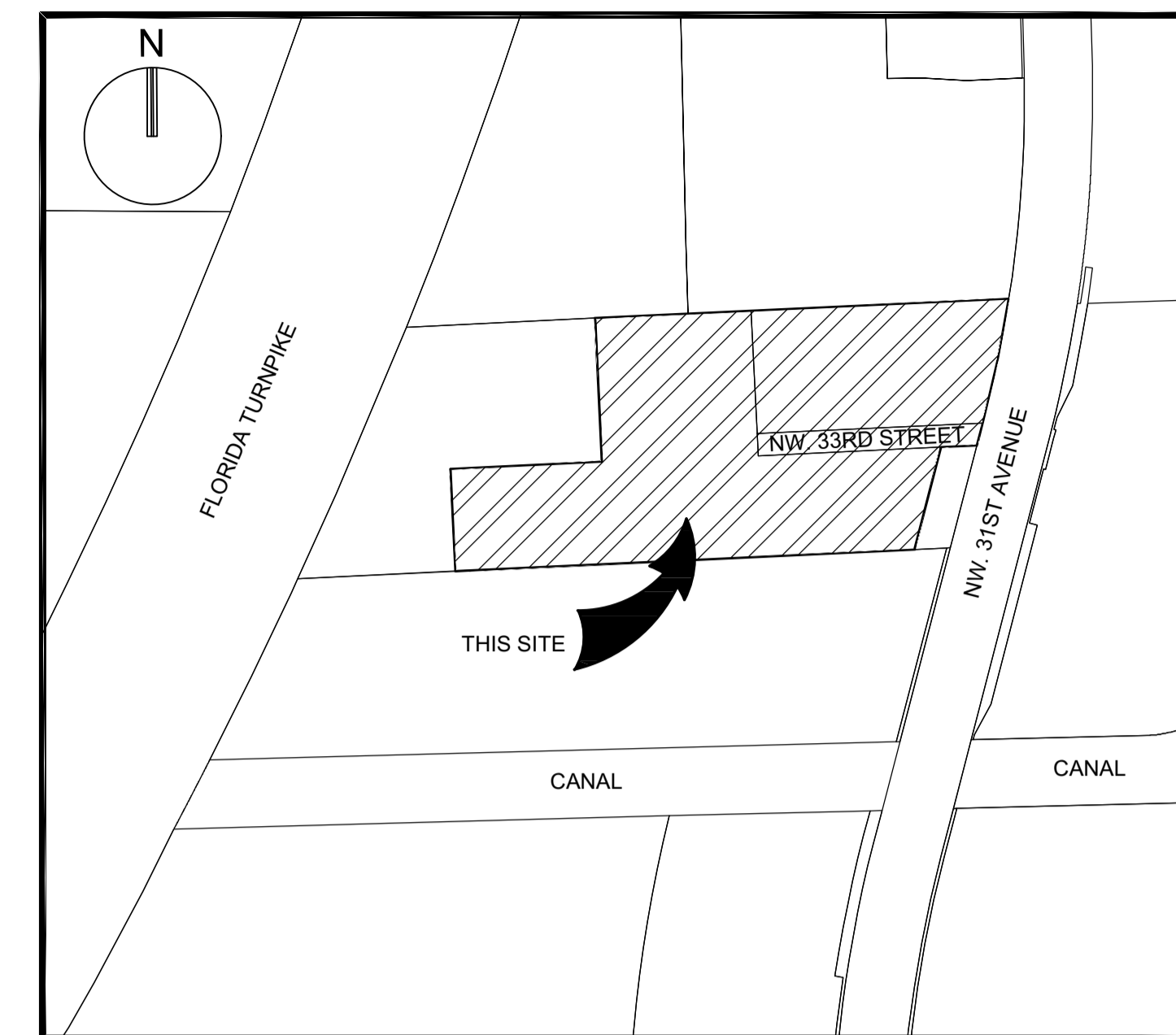

SURVEY NOTES:

- UNLESS OTHERWISE NOTED, RECORD VALUES AND FIELD MEASURED VALUES ARE IN SUBSTANTIAL AGREEMENT.
- THE LEGAL DESCRIPTION SHOWN HEREON WAS PREPARED BY THE SURVEYOR AND PARTIALLY DERIVED FROM THAT SPECIAL WARRANTY DEED RECORDED AS INSTRUMENT NO. 115904102 IN THE PUBLIC RECORDS OF BROWARD COUNTY, FLORIDA.
- NOT VALID WITHOUT THE ORIGINAL SIGNATURE AND SEAL OR AN ENCRYPTED DIGITAL SIGNATURE OF A FLORIDA PROFESSIONAL SURVEYOR AND MAPPER.
- IT IS A VIOLATION OF THE STANDARDS OF PRACTICE RULE 5J-17 OF THE FLORIDA ADMINISTRATIVE CODE TO ALTER THIS SURVEY WITHOUT THE EXPRESS PRIOR WRITTEN CONSENT OF THE SURVEYOR. ADDITIONS AND/OR DELETIONS MADE TO THE FACE OF THIS SURVEY WILL MAKE THIS SURVEY INVALID.
- OTHER THAN AS SHOWN, THERE IS NO EVIDENCE THAT UNDERGROUND ENCROACHMENTS EXIST. HOWEVER, A SUBSURFACE INVESTIGATION WAS NOT PERFORMED TO DETERMINE IF UNDERGROUND ENCROACHMENTS DO EXIST.
- THIS SURVEY DOES NOT IDENTIFY THE LIMITS OR EXTENTS OF POTENTIAL JURISDICTIONAL BOUNDARIES.
- THE OWNERSHIP OF FENCES, PERIMETER WALLS AND/OR HEDGES SHOWN HEREON ARE NOT KNOWN AND THUS ARE NOT LISTED AS ENCROACHMENTS. FENCES, HEDGES AND/OR PERIMETER WALLS ARE SHOWN IN THEIR RELATIVE POSITION TO THE BOUNDARY.
- FEATURES AND LINE WORK SHOWN HEREON ARE REFERENCED TO THE NORTH AMERICAN HORIZONTAL DATUM OF 1983 WITH THE 2011 ADJUSTMENT APPLIED (NAD 83/11), TRANSVERSE MERCATOR, FLORIDA EAST ZONE.
- ELEVATIONS SHOWN HEREON ARE BASED ON THE NORTH AMERICAN VERTICAL DATUM OF 1988 (NAVD88). SAID ELEVATIONS ARE BASED ON BROWARD COUNTY ENGINEERING DIVISION, "BM 0168", A BRASS DISC AT THE NORTH END OF A RETAINING WALL FOR CONTROL GATES ON THE EAST SIDE OF NORTHWEST 31 AVE., ELEVATION=10.18' (NAVD88) AND NATIONAL GEODETIC SURVEY (NGS) POINT DESIGNATION "Q 665", ELEVATION 11.63' (NAVD88), A STAINLESS STEEL ROD IN A NGS LOGO CAP, 4.4" NORTHEAST OF A BLOCK STUCCO WALL, 475' +/- WEST OF S.W. 27TH AVENUE & 75' +/- SOUTH OF CENTERLINE OF CANAL. THE ELEVATION OF "BM 0168" WAS CONVERTED FROM 11.75' (NGVD29) TO 10.18 FEET (NAVD88) USING A VERTCON FACTOR OF (-)1.575 FEET.
- THE HORIZONTAL FEATURES SHOWN HEREON ARE PLOTTED TO WITHIN 1/20 OF THE MAP SCALE. HORIZONTAL FEATURE LOCATION IS TO THE CENTER OF THE SYMBOL AND MAY BE ALTERED FOR CLARITY. DISTANCES AND ELEVATIONS SHOWN HEREON ARE U.S. SURVEY FEET UNLESS OTHERWISE NOTED. THE EXPECTED HORIZONTAL ACCURACY OF THE INFORMATION SHOWN HEREON IS ±0.10'.
- THE INTENDED DISPLAY SCALE FOR THIS SURVEY IS 1"= 20' OR SMALLER.
- ALL MAPPED FEATURES AND ELEVATIONS SHOWN HEREON WERE OBTAINED BY KEITH AND ASSOCIATES FOR THE PURPOSE OF THIS SURVEY.
- BEARINGS SHOWN HEREON ARE BASED ON AN ASSUMED BEARING ALONG THE EASTERLY EXTENSION OF THE MOST EASTERLY NORTH LINE OF PARCEL "A", MOTEL 6, PLAT BOOK 112, PAGE 27, PUBLIC RECORDS OF BROWARD COUNTY, BEING NORTH 87°18'06" EAST.

CERTIFICATION:

I HEREBY CERTIFY THAT THE ATTACHED BOUNDARY AND TOPOGRAPHIC SURVEY OF THE HEREON DESCRIBED PROPERTY IS DEPICTED TO THE BEST OF MY KNOWLEDGE AND BELIEF AND THE INFORMATION AS SURVEYED UNDER MY DIRECTION ON JULY 11, 2022 MEETS THE STANDARDS OF PRACTICE RULE 5J-17 OF THE FLORIDA ADMINISTRATIVE CODE, PURSUANT TO SECTION 472.027, FLORIDA STATUTES, SUBJECT TO THE QUALIFICATIONS NOTED HEREON.

KEITH & ASSOCIATES, INC.

DONALD A. SPICER
PROFESSIONAL SURVEYOR AND MAPPER
REGISTRATION No. 4677
STATE OF FLORIDA

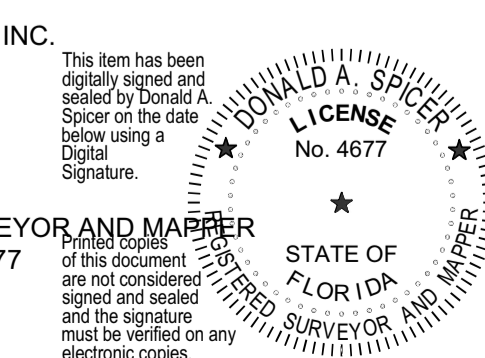

Digitally signed
by DONALD A
SPICER

