

TREE DISPOSITION SYMBOL LEGEND

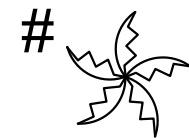

- EXISTING PALM TO REMAIN
SEE TREE PROTECTION FENCING DETAIL FOR FENCING TO BE ERECTED AND MAINTAINED DURING ENTIRE CONSTRUCTION PERIOD



- EXISTING PALM TO BE REMOVED
REMOVE ENTIRE ROOT SYSTEMS AND FILL/LIGHTLY COMPACT/GRADE WITH SUITABLE SOIL

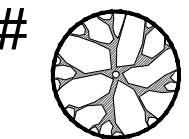

- EXISTING TREE TO REMAIN
SEE TREE PROTECTION FENCING DETAIL FOR FENCING TO BE ERECTED AND MAINTAINED DURING ENTIRE CONSTRUCTION PERIOD



- EXISTING TREE TO BE REMOVED
REMOVE ENTIRE ROOT SYSTEMS AND FILL/LIGHTLY COMPACT/GRADE WITH SUITABLE SOIL

NOTE: ALL TREE WORK IS TO BE PERFORMED BY A REGISTERED BROWARD COUNTY TREE TRIMMER. MITIGATION FOR TREES PROPOSED FOR REMOVAL SHALL BE IN ACCORDANCE WITH THE CITY OF POMPANO BEACH TREE MITIGATION REQUIREMENTS AS STATED IN THE CITY'S CODE OF ORDINANCES.

A PRE-CONSTRUCTION MEETING WITH URBAN FORESTRY IS REQUIRED BEFORE ANY WORK IS PERFORMED ONSITE WHERE THERE IS TREE PROTECTION AND/OR PLANT MATERIAL IS INSTALLED ON SITE.

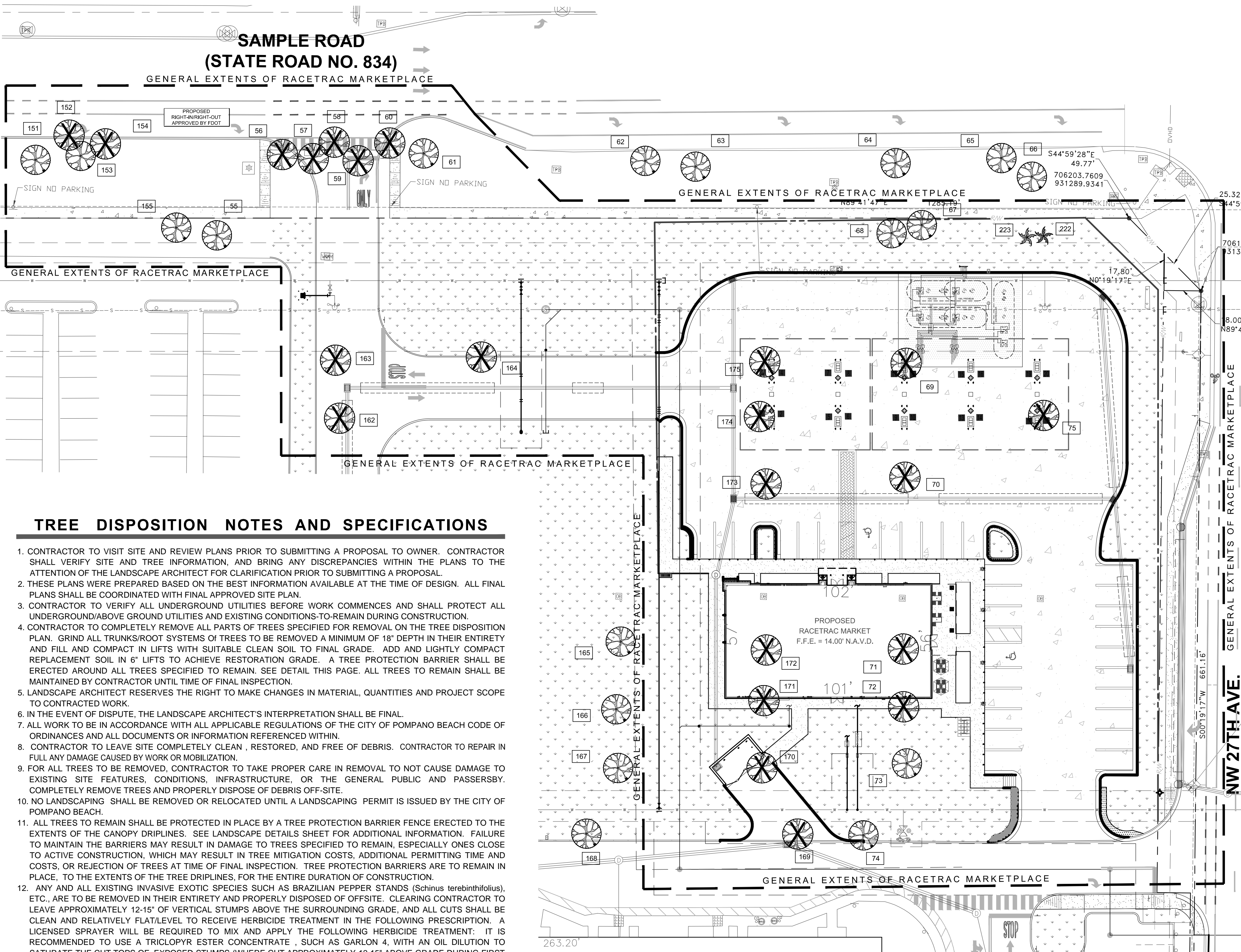

TREE DISPOSITION NOTES AND SPECIFICATIONS

- CONTRACTOR TO VISIT SITE AND REVIEW PLANS PRIOR TO SUBMITTING A PROPOSAL TO OWNER. CONTRACTOR SHALL VERIFY SITE AND TREE INFORMATION, AND BRING ANY DISCREPANCIES WITHIN THE PLANS TO THE ATTENTION OF THE LANDSCAPE ARCHITECT FOR CLARIFICATION PRIOR TO SUBMITTING A PROPOSAL.
- THESE PLANS WERE PREPARED BASED ON THE BEST INFORMATION AVAILABLE AT THE TIME OF DESIGN. ALL FINAL PLANS SHALL BE COORDINATED WITH FINAL APPROVED SITE PLAN.
- CONTRACTOR TO VERIFY ALL UNDERGROUND UTILITIES BEFORE WORK COMMENCES AND SHALL PROTECT ALL UNDERGROUND/ABOVE GROUND UTILITIES AND EXISTING CONDITIONS-TO-REMAIN DURING CONSTRUCTION.
- CONTRACTOR TO COMPLETELY REMOVE ALL PARTS OF TREES SPECIFIED FOR REMOVAL ON THE TREE DISPOSITION PLAN. GRIND ALL TRUNKS/ROOT SYSTEMS OF TREES TO BE REMOVED A MINIMUM OF 18" DEPTH IN THEIR ENTIRETY AND FILL AND COMPACT IN LIFTS WITH SUITABLE CLEAN SOIL TO FINAL GRADE. ADD AND LIGHTLY COMPACT REPLACEMENT SOIL IN 8" LIFTS TO ACHIEVE RESTORATION GRADE. A TREE PROTECTION BARRIER SHALL BE ERECTED AROUND ALL TREES SPECIFIED TO REMAIN. SEE DETAIL THIS PAGE. ALL TREES TO REMAIN SHALL BE MAINTAINED BY CONTRACTOR UNTIL TIME OF FINAL INSPECTION.
- LANDSCAPE ARCHITECT RESERVES THE RIGHT TO MAKE CHANGES IN MATERIAL, QUANTITIES AND PROJECT SCOPE TO CONTRACTED WORK.
- IN THE EVENT OF DISPUTE, THE LANDSCAPE ARCHITECT'S INTERPRETATION SHALL BE FINAL.
- ALL WORK TO BE IN ACCORDANCE WITH ALL APPLICABLE REGULATIONS OF THE CITY OF POMPANO BEACH CODE OF ORDINANCES AND ALL DOCUMENTS OR INFORMATION REFERENCED WITHIN.
- CONTRACTOR TO LEAVE SITE COMPLETELY CLEAN, RESTORED, AND FREE OF DEBRIS. CONTRACTOR TO REPAIR IN FULL ANY DAMAGE CAUSED BY WORK OR MOBILIZATION.
- FOR ALL TREES TO BE REMOVED, CONTRACTOR TO TAKE PROPER CARE IN REMOVAL TO NOT CAUSE DAMAGE TO EXISTING SITE FEATURES, CONDITIONS, INFRASTRUCTURE, OR THE GENERAL PUBLIC AND PASSERSBY. COMPLETELY REMOVE TREES AND PROPERLY DISPOSE OF DEBRIS OFF-SITE.
- NO LANDSCAPING SHALL BE REMOVED OR RELOCATED UNTIL A LANDSCAPING PERMIT IS ISSUED BY THE CITY OF POMPANO BEACH.
- ALL TREES TO REMAIN SHALL BE PROTECTED IN PLACE BY A TREE PROTECTION BARRIER FENCE ERECTED TO THE EXTENTS OF THE CANOPY DRIP LINES. SEE LANDSCAPE DETAILS SHEET FOR ADDITIONAL INFORMATION. FAILURE TO MAINTAIN THE BARRIERS MAY RESULT IN DAMAGE TO TREES SPECIFIED TO REMAIN, ESPECIALLY ONES CLOSE TO ACTIVE CONSTRUCTION, WHICH MAY RESULT IN TREE MITIGATION COSTS, ADDITIONAL PERMITTING TIME AND COSTS, OR REJECTION OF TREES AT TIME OF FINAL INSPECTION. TREE PROTECTION BARRIERS ARE TO REMAIN IN PLACE. TO THE EXTENTS OF THE TREE DRIP LINES, FOR THE ENTIRE DURATION OF CONSTRUCTION.
- ANY AND ALL EXISTING INVASIVE EXOTIC SPECIES SUCH AS BRAZILIAN PEPPER STANDS (*Schinus terebinthifolius*), ETC., ARE TO BE REMOVED IN THEIR ENTIRETY AND PROPERLY DISPOSED OF OFFSITE. CLEARING CONTRACTOR TO LEAVE APPROXIMATELY 12-15' OF VERTICAL STUMPS ABOVE THE SURROUNDING GRADE, AND ALL CUTS SHALL BE CLEAN AND RELATIVELY FLAT/LEVEL TO RECEIVE HERBICIDE TREATMENT IN THE FOLLOWING PRESCRIPTION. A LICENSED SPRAYER WILL BE REQUIRED TO MIX AND APPLY THE FOLLOWING HERBICIDE TREATMENT: IT IS RECOMMENDED TO USE A TRICLOPYR ESTER CONCENTRATE, SUCH AS GARLON 4, WITH AN OIL DILUTION TO SATURATE THE CUT TOPS OF EXPOSED STUMPS (WHERE CUT APPROXIMATELY 12-15' ABOVE GRADE DURING FIRST STAGE OF BRUSH REMOVAL), BUT LICENSED APPLICATOR SHALL DETERMINE THE FINAL, MOST EFFECTIVE AND SAFE FORMULA. APPLICATOR SHALL STRICTLY FOLLOW MANUFACTURER'S INSTRUCTIONS AND TO USE A COLOR DYE WITH THE SOLUTION TO DEMONSTRATE PROPER APPLICATION OF AFFECTED AREAS AND AVOIDANCE OF SURROUNDING VEGETATION TO REMAIN. WOODY INVASIVE EXOTIC VEGETATION OBSERVED INCLUDES BRAZILIAN PEPPER, CARROTWOOD, AND UMBRELLA TREE. THOUGH THERE MAY BE ADDITIONAL SPECIES. ANY ADDITIONAL INVASIVE VEGETATION SUCH AS BALSAM APPLE OR OTHER INVASIVE EXOTIC VINING PLANTS SHALL BE TREATED USING A FOLIAR HERBICIDE APPLICATION IF FOUND ONSITE AS PART OF THE SCOPE OF WORK.
- THE TREE REMOVAL WORK HEREIN WILL REQUIRE A PERMIT FROM THE CITY OF POMPANO BEACH PRIOR TO ANY TREE WORK. ALL TREE WORK IS TO BE PERFORMED BY A REGISTERED BROWARD COUNTY TREE TRIMMER. MITIGATION FOR TREES PROPOSED FOR REMOVAL SHALL BE IN ACCORDANCE WITH THE CITY OF POMPANO BEACH TREE MITIGATION REQUIREMENTS AS STATED IN THE CITY'S CODE OF ORDINANCES.
- A PRE-CONSTRUCTION MEETING WITH URBAN FORESTRY IS REQUIRED BEFORE ANY WORK IS PERFORMED ONSITE WHERE THERE IS TREE PROTECTION /TREE WORK AND/OR PLANT MATERIAL INSTALLED ON SITE.

TREE DISPOSITION PLAN

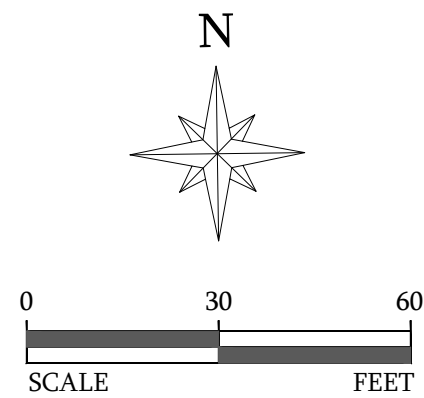

TREE DISPOSITION CHART

No.	BOTANICAL NAME	COMMON NAME	DBH	HT. x SPR.	CONDITION	DISPOSITION	VALUE
55	Bucida buceras	Black Olive	22" (SP)	44' x 60'	Fair	REMAIN	\$5,859.00
56	Bursera simaruba	Gumbo Limbo	21" (SP)	30' x 36'	Fair	REMOVE	\$7,641.00
57	Bursera simaruba	Gumbo Limbo	10"	24' x 18'	Fair	REMOVE	\$2,084.00
58	Bursera simaruba	Gumbo Limbo	16"	28' x 36'	Fair	REMOVE	\$4,626.00
59	Bursera simaruba	Gumbo Limbo	18" (SP)	26' x 30'	Fair	REMOVE	\$5,734.00
60	Bursera simaruba	Gumbo Limbo	12"	22' x 20'	Poor	REMOVE	\$1,634.00
61	Bursera simaruba	Gumbo Limbo	20" (SP)	30' x 36'	Good	REMAIN	\$9,878.00
62	Conocarpus erectus	Green Buttonwood	40" (SP)	24' x 30'	Poor	REMAIN	\$10,459.00
63	Conocarpus erectus	Green Buttonwood	26" (SP)	28' x 28'	Poor	REMAIN	\$4,459.00
64	Bursera simaruba	Gumbo Limbo	12"	28' x 30'	Poor	REMAIN	\$1,634.00
65	Bursera simaruba	Gumbo Limbo	12"	26' x 20'	Poor	REMAIN	\$1,634.00
66	Bursera simaruba	Gumbo Limbo	22" (SP)	32' x 30'	Poor	REMAIN	\$4,866.00
67	Bucida buceras	Black Olive	16"	24' x 22'	Poor	REMAIN	\$1,824.00
68	Bucida buceras	Black Olive	36" (SP)	50' x 60'	Fair	REMAIN	\$15,585.00
69	Quercus virginiana	Live Oak	12"	24' x 27'	Fair	REMOVE	\$4,441.00
70	Quercus virginiana	Live Oak	18" (SP)	30' x 36'	Fair	REMOVE	\$8,501.00
71	Quercus virginiana	Live Oak	10"	20' x 30'	Fair	REMOVE	\$3,448.00
72	Quercus virginiana	Live Oak	10"	30' x 40'	Fair	REMOVE	\$8,501.00
73	Quercus virginiana	Live Oak	13"	28' x 34'	Fair	REMAIN	\$5,005.00
74	Bucida buceras	Black Olive	30" (SP)	32' x 42'	Fair	REMOVE	\$10,842.00
75	Quercus virginiana	Live Oak	14"	32' x 40'	Fair	REMOVE	\$5,614.00
76	Acacia auriculiformis	Earleaf Acacia	26" (SP)	32' x 30'	Poor	REMOVE	EXEMPT
151	Bursera simaruba	Gumbo Limbo	14"	26' x 30'	Fair	REMAIN	\$3,648.00
152	Bursera simaruba	Gumbo Limbo	20" (SP)	20' x 24'	Poor	REMOVE	\$873.00
153	Bursera simaruba	Gumbo Limbo	11"	40' x 60'	Fair	REMAIN	\$6,973.00
154	Bursera simaruba	Gumbo Limbo	12"	28' x 24'	Poor	REMOVE	\$1,415.00
155	Bucida buceras	Black Olive	34" (SP)	52' x 86'	Fair	REMAIN	\$13,908.00
162	Quercus virginiana	Live Oak	18" (SP)	38' x 52'	Fair	REMOVE	\$8,501.00
163	Quercus virginiana	Live Oak	18" (SP)	38' x 50'	Fair	REMOVE	\$8,501.00
164	Quercus virginiana	Live Oak	16"	36' x 48'	Fair	REMOVE	\$6,967.00
165	Quercus virginiana	Live Oak	16"	32' x 40'	Fair	REMAIN	\$6,967.00
166	Quercus virginiana	Live Oak	9"	24' x 24'	Poor	REMAIN	\$1,510.00
167	Quercus virginiana	Live Oak	20" (SP)	36' x 50'	Poor	REMAIN	\$5,108.00
168	Bucida buceras	Black Olive	21" (SP)	36' x 60'	Fair	REMAIN	\$5,344.00
169	Bucida buceras	Black Olive	22" (SP)	38' x 58'	Poor	REMOVE	\$3,418.00
170	Quercus virginiana	Live Oak	14"	36' x 42'	Poor	REMOVE	\$2,807.00
171	Quercus virginiana	Live Oak	10"	28' x 32'	Poor	REMOVE	\$1,724.00
172	Quercus virginiana	Live Oak	24" (SP)	34' x 54'	Fair	REMOVE	\$14,187.00
173	Quercus virginiana	Live Oak	13"	30' x 30'	Fair	REMOVE	\$5,005.00
174	Quercus virginiana	Live Oak	18" (SP)	34' x 46'	Poor	REMOVE	\$4,959.00
175	Quercus virginiana	Live Oak	15"	36' x 50'	Fair	REMOVE	\$6,268.00
222	Sabal palmetto	Sabal Palm	9"	12' x 8'	Fair	REMAIN	\$340.00
223	Sabal palmetto	Sabal Palm	9"	20' x 8'	Fair	REMAIN	\$516.00

TOTAL VALUE OF EXISTING TREES = \$233,208.00
TOTAL VALUE OF SPECIMEN TREES REMOVED = \$73,157.00
TOTAL SPECIMEN INCHES REMOVED = 233"
TOTAL NON-SPECIMEN INCHES REMOVED = 164" (\$44,280.00 USING 2.5 MULTIPLIER)
TOTAL MITIGATION = \$117,437.00

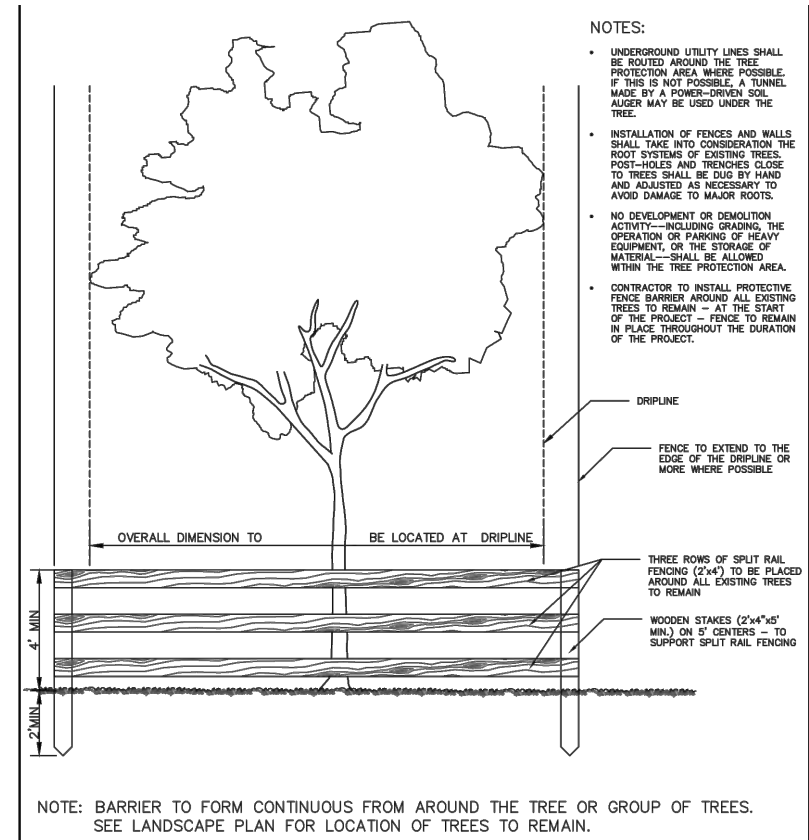

NOTE: BARRIER TO FORM CONTINUOUS FROM AROUND THE TREE OR GROUP OF TREES. SEE LANDSCAPE PLAN FOR LOCATION OF TREES TO REMAIN.

1 TREE PROTECTION BARRIER DETAIL SECTION N.T.S.

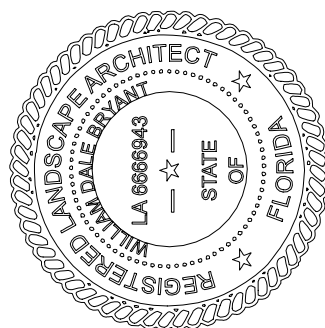

PROJECT #	25-111
DATE	05-28-2025
SCALE	AS SHOWN
DESIGNED BY	WDB
DRAWN BY	WDB
CHECKED BY	WDB

Racetrac.
RACETRAC PETROLEUM, INC.
SAMPLE ROAD & 27TH AVENUE
POMPANO BEACH, BROWARD COUNTY
FLORIDA 33069

TREE DISPOSITION PLAN

SHEET NUMBER
L-100