



**City of Pompano Beach
Procurement and Contracts Department
1010 N.E. 3rd Avenue
Pompano Beach, Florida, 33060**

July 3, 2025

ADDENDUM #1, RFP25-058

ITB25-058 Charlotte Burrie Plaza & Passive Park

To Whom It May Concern,

The following documents have been added to the Attachments tab:

02826 - Ornamental Metal Fence and Gate	C1 & C2 CIVIL PLANS
A1.10 STAGE & PLAZA PLAN AND DETAILS	A0.20 SITE FINISHES
A2.10 PLAY AREA PLAN AND INFORMATION	A0.30 SITE FURNITURE
E1.2 ELECTRICAL LIGHTING SITE PLAN	A0.40 SITE DETAILS
A0.10B PROPOSED SITE PLAN	A0.41 SITE DETAILS

Addendum #1 is posted on the City's eBid website: <http://pompanobeachfl.ionwave.net>. Acknowledge receipt of this Addendum using the Addendum Attribute on the Attributes tab in the eBid System.

The deadline for receiving written questions in the eBid System has passed

The deadline for accepting proposals in the eBid system is **July 10, 2025, at 2:00:00 p.m. (local).**

The remainder of the solicitation is unchanged at this time.

Sincerely,

Jeffrey English, Purchasing Agent.

cc: website

SECTION 02826 - ORNAMENTAL METAL FENCES AND GATES

PART 1 - GENERAL

1.1 RELATED DOCUMENTS

- A. Drawings and general provisions of the Contract, including General and Supplementary Conditions and Division 1 Specification Sections, apply to this Section.

1.2 SUMMARY

- A. Section Includes:
 - 1. Decorative aluminum fences.
 - 2. Swing gates.
 - 3. Sliding gates.
- B. Related Sections:
 - 1. Division 2 Section "Earthwork" for site excavation, fill, and backfill where decorative metal fences and gates are located.
 - 2. Division 3 Section "Cast-in-Place Concrete" for concrete bases for gate operators, drives, and controls, post concrete fill.

1.3 SUBMITTALS

- A. Product Data: For each type of product indicated.
- B. Shop Drawings: For gates. Include plans, elevations, sections, details, and attachments to other work.
 - 1. Product Data: Submit product data for fabric, posts, accessories, fittings, and hardware.
 - 2. Shop Drawings: Include plan layout, grid, spacing of components, accessories, fittings, hardware, anchorage's, and schedule of components.
 - 3. Signed and Sealed Engineering Drawings and Calculations - Contractor shall provide engineered, signed and sealed shop drawings by a Florida Registered Engineer to comply with ASCE 7-16 and Florida Building Code, Latest Edition. Size and spacing of posts, rails, gates and footings shall comply with engineering supplied by contractor's engineer, but not less than sizes and spacing specified in the construction documents.
 - 4. Wiring Diagrams: For power, signal, and control wiring.
 - 5. Submit drawings showing connections to adjacent construction, range of travel, and all electrical and mechanical connections to the operator. Drawings shall also show the size and location of the concrete mounting pad. Underground electrical runs shall be shown on shop drawings.
- C. Installation Instructions: Submit two copies of manufacturer's installation instructions for this specific project.
- D. Samples: For each fence material and for each color specified.
 - 1. Provide Samples 12 inches in length for linear materials.
- E. Welding certificates.

- F. Maintenance Data: For gate operators to include in maintenance manuals.

1.4 QUALITY ASSURANCE

- A. Installer Qualifications: Fabricator of products.
- B. Installer: A minimum of three years experience installing similar equipment.
- C. All fieldwork shall be performed in a neat and professional manner, completed to journeyman standards.
- D. Emergency Access Requirements: Comply with requirements of authorities having jurisdiction for automatic gate operators on gates that must provide emergency access.

1.5 CODES AND REGULATORY REQUIREMENTS

- A. Before submitting a proposal, the Contractor shall become familiar with the rules of the governing boards having jurisdiction and shall notify the Owners Representative before submitting a proposal, if in the Contractors opinion, any work or material specified is contrary to such rules. Otherwise, the Contractor is responsible for the approval of all work or material at no extra cost to the Owner, and in case the use of any material specified is not permitted, a substitute shall be approved by the Owners Representative and shall be provided at no extra cost.
- B. Work to conform to the latest editions of the following (when applicable):
 - 1. Florida Building Code, Latest Broward County Edition (F.B.C.)
 - 2. National Electric Code (N.E.C.)
 - 3. National Electrical Manufacturers Association (N.E.M.A.)
 - 4. All other applicable city, state and national codes
 - 5. Underwriters' Laboratories Inc. (U.L.), listings
 - 6. American Society for Testing and Materials (A.S.T.M.)
 - 7. Occupational Safety and Health Administration (O.S.H.A.)
 - 8. Wind Loads – ASCE 7-22 – 170 mph wind speed, Exposure C, Category II

1.6 PRODUCT DELIVERY AND STORAGE

- A. Store products upright in the original shipping containers, covered, ventilated and protected from all weather conditions.

1.7 WARRANTY

- A. Provide a two-year comprehensive warranty against all defects in materials or workmanship. Defective materials shall be replaced with comparable materials furnished by the manufacturer, at no cost to the owner. Freight, labor and other incidental costs must be covered under the factory warranty.

1.8 SAFETY REQUIREMENTS

- A. Do not locate any device (key switch, switch, key pad, card reader, etc.) In a position where it may be activated by a person reaching through the gate or while touching the gate in any manner.

PART 2 - PRODUCTS

2.1 ALUMINUM

- A. Aluminum, General: Provide alloys and tempers with not less than the strength and durability properties of alloy and temper designated in paragraphs below for each aluminum form required.
- B. Extrusions: ASTM B 221, Alloy 6063-T5.
- C. Tubing: ASTM B 429, Alloy 6063-T6.
- D. Plate and Sheet: ASTM B 209, Alloy 6061-T6.
- E. Die and Hand Forgings: ASTM B 247, Alloy 6061-T6.
- F. Castings: ASTM B 26/B 26M, Alloy A356.0-T6.

2.2 MISCELLANEOUS MATERIALS

- A. Welding Rods and Bare Electrodes: Select according to AWS specifications for metal alloy welding.
 - 1. For aluminum, provide type and alloy as recommended by producer of metal to be welded and as required for strength and compatibility in fabricated items.
- B. Concrete: Normal-weight, air-entrained, ready-mix concrete complying with requirements in Division 3 Section "Cast-in-Place Concrete" with a minimum 28-day compressive strength of 4000 psi, 3-inch slump, and 1-inch maximum aggregate size.
- C. Non-shrink Grout: Factory-packaged, non-staining, non-corrosive, non-gaseous grout complying with ASTM C 1107 and specifically recommended by manufacturer for exterior applications.

2.3 GROUNDING MATERIALS

- A. Grounding Conductors: Bare, solid wire for No. 6 AWG and smaller; stranded wire for No. 4 AWG and larger.
 - 1. Material above Finished Grade: Aluminum.
 - 2. Material on or below Finished Grade: Copper.
 - 3. Bonding Jumpers: Braided copper tape, 1 inch wide, woven of No. 30 AWG bare copper wire, terminated with copper ferrules.
- B. Grounding Connectors and Grounding Rods: Comply with UL 467.
 - 1. Connectors for Below-Grade Use: Exothermic-welded type.
 - 2. Grounding Rods: Copper-clad steel.
 - a. Size: 5/8 by 96 inches.

2.4 MATERIAL

- A. Aluminum material for fence framework (i.e., tubular pickets, rails and posts) shall conform to the requirements of ASTM B221. The aluminum extrusions for posts and rails shall be Alloy and Temper Designation 6005-T52. The aluminum extrusions for pickets shall be Alloy and Temper Designation 6063-T52.
- B. Material for fence pickets shall be 1" square x 0.062" thick extruded tubing. The cross-sectional shape of the rails shall conform to the manufacturer's ForeRunner™ design with outside cross-section dimensions of 1.75" square. The top wall and internal web of the rail shall be 0.070" thick; the sidewalls shall be 0.070" thick for superior vertical load strength. Picket holes in the ForeRunner rail shall be spaced 4.715" o.c., except for Invincible style 6' long, which shall be, spaced 4.98" o.c. Picket retaining rods shall be 0.125" diameter galvanized steel. Fence posts and gate posts shall meet the minimum size requirements of Table 1. High quality PVC grommets shall be supplied to seal all picket-to-rail intersections.
- C. All fasteners shall be stainless steel. Bracket to rail attachments shall be made using specially designed one-way tamperproof security bolts with inverted "t-nuts". Bracket to post connections shall be made using self-drilling hex-head screws.
- D. Aluminum castings shall be used for all rings, post caps, finials, and miscellaneous adornments.

2.5 FABRICATION

- A. Pickets, rails and posts shall be pre-cut to specified lengths. Rails shall be pre-punched to accept pickets.
- B. The rail inner slide shall be fully inserted into the rail outer channel to form the raceway for the internal retaining rod. Grommets shall be inserted into the pre-punched holes in the rails, and pickets shall be inserted through the grommets so that pre-drilled picket holes align with the internal raceway of the two-part ForeRunner rails. (Note: This can best be accomplished by using an alignment template). Retaining rods shall be inserted into each ForeRunner rail so that they pass through the pre-drilled holes in each picket, thus completing the panel assembly.
- C. Completed panels shall be capable of supporting a 300 lb. load (applied at midspan) without permanent deformation. Panels shall be biasable to a 25% change in grade.
- D. Swing Gates shall be fabricated using 1.75" sq. reinforced ForeRunner rail material, 2" sq. x .250" gate ends, and 1" sq. x .125" pickets. All rail and upright intersections shall be joined by welding. All picket and rail intersections shall be joined by welding.
- E. 6' wide or larger Aluminum Frames and Bracing: Fabricate members from square tubing.
 - 1. Frame Members: Extruded-aluminum tubes 2-1/2 by 2-1/2 inches with 0.154-inch wall thickness.
 - 2. Bracing Members: Extruded-aluminum tubes 2-1/2 by 2-1/2 inches with 0.154-inch wall thickness.
- F. Frame Corner Construction:
 - 1. Welded frame and 5/16-inch- diameter, adjustable truss rods for panels 4 feet wide or wider.
- G. Additional Rails: Provide as indicated, complying with requirements for fence rails.
- H. Infill: Comply with requirements for adjacent fence.
- I. Picket Size, Configuration, and Spacing: Comply with requirements for adjacent fence.

- J. Hardware: Latches permitting operation from both sides of gate, locking devices, hinges, hardware items and accessories, and stops fabricated from mill-finished, Grade 319 aluminum-alloy casting with stainless-steel fasteners. Fabricate latches with integral eye openings for padlocking; padlock accessible from both sides of gate.
 - 1. Contractor to Supply Padlocks - Schlage Primus series.
 - 2. Contractor shall provide Knox Box for fire department access.
- K. Finish exposed welds to comply with NOMMA Guideline 1, Finish #2 - completely sanded joint, some undercutting and pinholes okay.
- L. Aluminum Finish: Powder Coated.

2.6 ALUMINUM FINISHES

- A. Baked-Enamel or Powder-Coat Finish: AAMA 2603 except with a minimum dry film thickness of 2 mils. Comply with coating manufacturer's written instructions for cleaning, conversion coating, and applying and baking finish.
 - 1. Color and Gloss: Powder Coated, Color – To match with existing picket fence at Community Center, field verified.

Table 1 – Coating Performance Requirements		
Quality Characteristics	ASTM Test Method	Performance Requirements
Adhesion	D3359 – Method B	Adhesion (Retention of Coating) over 90% of test area (Tape and knife test).
Corrosion Resistance	B117, D714 & D1654	Corrosion Resistance over 3,500 hours (Scribed per D1654; failure mode is accumulation of 1/8" coating loss from scribe or medium #8 blisters).
Impact Resistance	D2794	Impact Resistance over 60 inch lb. (Forward impact using 0.625" ball).
Weathering Resistance	D822 D2244, D523 (60° Method)	Weathering Resistance over 1,000 hours (Failure mode is 60% loss of gloss or color variance of more than 3 delta-E color units).

PART 3 - EXECUTION

3.1 EXAMINATION

- A. Examine areas and conditions, with Installer present, for compliance with requirements for site clearing, earthwork, pavement work, construction layout, and other conditions affecting performance of the Work.
- B. Do not begin installation before final grading is completed unless otherwise permitted by Owner.
- C. Proceed with installation only after unsatisfactory conditions have been corrected.

3.2 PREPARATION

- A. Stake locations of fence lines, gates, and terminal posts. Do not exceed intervals of 500 feet or line of sight between stakes. Indicate locations of utilities, lawn sprinkler system, underground structures, benchmarks, and property monuments.
 - 1. Construction layout and field engineering are specified in Division 1 Section "Execution Requirements."

3.3 DECORATIVE FENCE INSTALLATION

- A. Install fences according to manufacturer's written instructions.
- B. Install fences by setting posts as indicated and fastening rails
- C. Post Excavation: Drill or hand-excavate holes for posts in firm, undisturbed soil. Excavate holes to a diameter and depth of not less than that show on engineered shop drawings.
- D. Post Setting: Set posts in concrete at 6'-0" o.c. spacing into firm, undisturbed soil.
 - 1. Verify that posts are set plumb, aligned, and at correct height and spacing, and hold in position during setting with concrete or mechanical devices.
 - 2. Concrete Fill: Place concrete around posts and vibrate or tamp for consolidation. Protect aboveground portion of posts from concrete splatter.
 - a. Exposed Concrete: Extend 2 inches above grade. Finish and slope top surface to drain water away from post.
 - b. Concealed Concrete: Top 2 inches below grade to allow covering with surface material. Slope top surface of concrete to drain water away from post.
- E. Posts Set in Concrete: Extend post to within 6 inches of specified excavation depth, but not closer than 3 inches to bottom of concrete.
- F. Space posts uniformly at 6 feet o.c.

3.4 GROUNDING AND BONDING

- A. Fence Grounding: Install at maximum intervals of 1500 feet except as follows:
 - 1. Fences within 100 Feet of Buildings, Structures, Walkways, and Roadways: Ground at maximum intervals of 750 feet.
 - 2. Gates and Other Fence Openings: Ground fence on each side of opening.
- B. Bond metal gates to gate posts.
 - 1. Bond across openings, with and without gates, except openings indicated as intentional fence discontinuities. Use No. 2 AWG wire and bury it at least 18 inches below finished grade.
 - 2. Protection at Crossings of Overhead Electrical Power Lines: Ground fence at location of crossing and at a maximum distance of 150 feet on each side of crossing.
- C. Grounding Method: At each grounding location, drive a grounding rod vertically until the top is 6 inches below finished grade. Connect rod to fence with No. 6 AWG conductor. Connect conductor to each fence component at the grounding location.
- D. Bonding Method for Gates: Connect bonding jumper between gate post and gate frame.

- E. Connections: Make connections so possibility of galvanic action or electrolysis is minimized. Select connectors, connection hardware, conductors, and connection methods so metals in direct contact will be galvanically compatible.
 - 1. Use electroplated or hot-tin-coated materials to ensure high conductivity and to make contact points closer in order of galvanic series.
 - 2. Make connections with clean, bare metal at points of contact.
 - 3. Make aluminum-to-steel connections with stainless-steel separators and mechanical clamps.
 - 4. Make aluminum-to-galvanized-steel connections with tin-plated copper jumpers and mechanical clamps.
 - 5. Coat and seal connections having dissimilar metals with inert material to prevent future penetration of moisture to contact surfaces.

3.5 ADJUSTING

- A. Gates: Adjust gates to operate smoothly, easily, and quietly, free of binding, warp, excessive deflection, distortion, nonalignment, misplacement, disruption, or malfunction, throughout entire operational range. Confirm that latches and locks engage accurately and securely without forcing or binding.
- B. Lubricate hardware, and other moving parts.

3.6 TRAINING AND DOCUMENTATION

- A. Procure all the necessary and usual inspections and certificates for all work to be installed. Deliver same to the owner/ end user before final acceptance.
- B. Provide three copies of "operations and maintenance", manual for the owner's use. Manuals will identify parts of the equipment for future procurement.
- C. Installer must provide extra parts to the owner, as specified.

END OF SECTION 02826

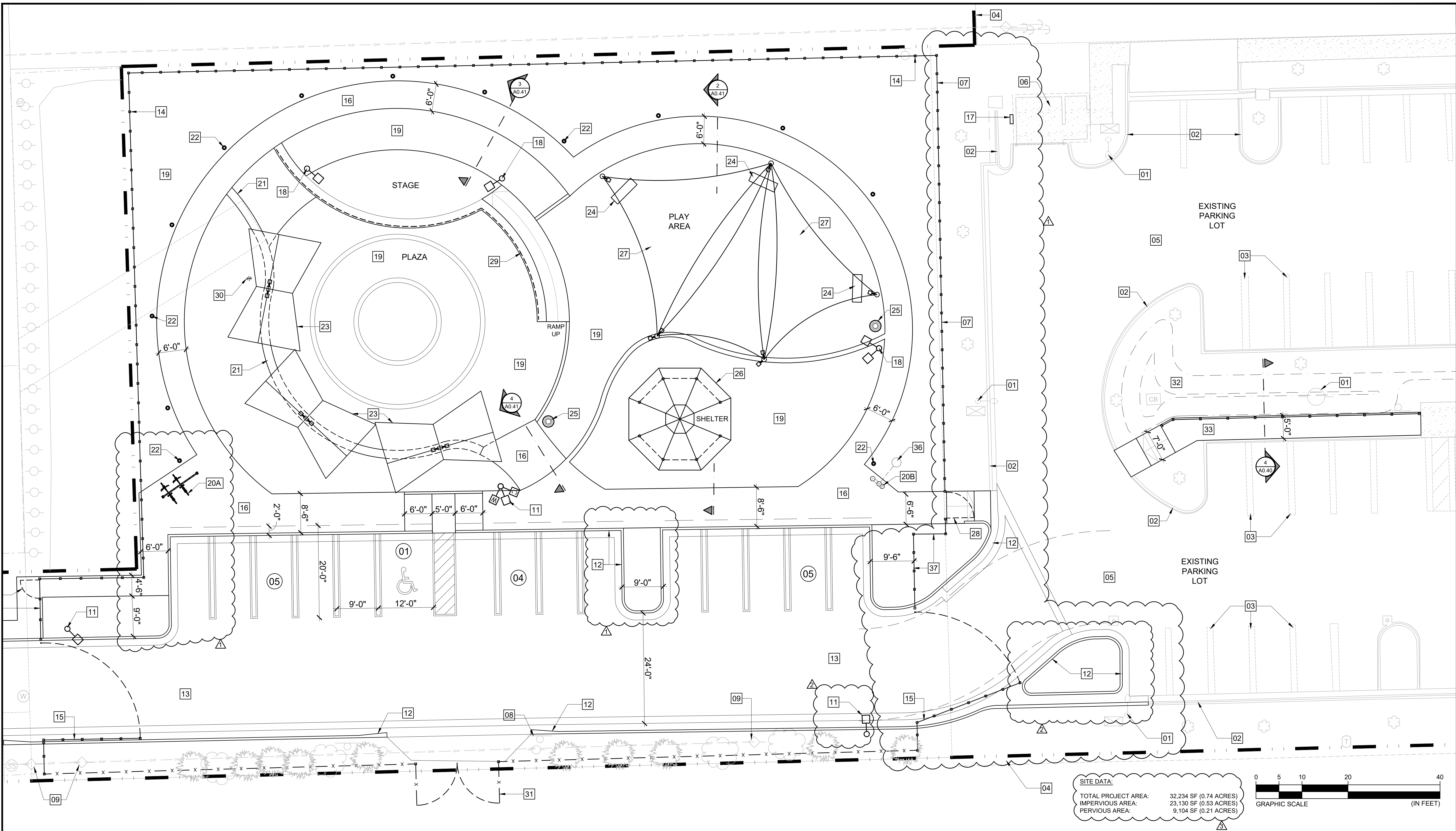

KEYNOTES FOR EXISTING FEATURES

- 01 EXISTING LIGHT POLE TO REMAIN. PROTECT DURING CONSTRUCTION.
- 02 EXISTING CURB TO REMAIN. PROTECT DURING CONSTRUCTION.
- 03 EXISTING PARKING LOT STRIPING TO REMAIN. PROTECT DURING CONSTRUCTION.
- 04 EXISTING PICKET FENCE ON ADJOINING PARCEL TO REMAIN. PROTECT DURING CONSTRUCTION.
- 05 EXISTING ASPHALT SURFACING IN PARKING LOT TO REMAIN. PROTECT DURING CONSTRUCTION.
- 06 EXISTING DUMPSTER AND RECYCLE BIN ENCLOSURE TO REMAIN. PROTECT DURING CONSTRUCTION.
- 07 EXISTING PICKET FENCE TO REMAIN. PROTECT DURING CONSTRUCTION.
- 08 EXISTING 'FIRE DEPARTMENT ACCESS' SIGN TO REMAIN.
- 09 EXISTING POWER POLE TO REMAIN. PROTECT DURING CONSTRUCTION.

KEYNOTES FOR PROPOSED FEATURES

- 10 NEW 25 FEET HIGH LIGHT POLE TO MATCH WITH CIVIC CENTER LIGHT POLE. SEE ELECTRICAL SHEETS FOR DETAIL.
- 11 NEW CONTINUOUS CONCRETE CURB
- 12 NEW ASPHALT SURFACING IN PARKING LOT. SEE CIVIL DRAWINGS FOR STRIPING DETAILS.
- 13 NEW 6-FEET HIGH ALUM. PICKET FENCE TO MATCH WITH FENCE USED AT CIVIC CENTER. SEE SHEET A0.40 FOR DETAIL.
- 14 NEW 6-FEET HIGH ALUM. PICKET FENCE GATE WITH POST. SEE SHEET A0.40 FOR DETAIL. 22' WIDE AT WEST, 24' WIDE AT EAST.
- 15 NEW PRECAST CONCRETE SEAT ON CONCRETE WALL. SEE DETAIL 1/A0.41 FOR INFORMATION.
- 16 NEW DECORATIVE LANDSCAPE LIGHT FIXTURE. SEE ELECTRICAL SHEETS FOR DETAIL.
- 17 NEW CONCRETE SIDEWALK. SEE DIMENSIONS ON PLAN FOR WIDTH INFORMATION.
- 18 NEW METAL CANOPY. SEE SHEET A4.10 FOR INFORMATION.
- 19 NEW PANEL. SEE ELECTRICAL SHEETS FOR DETAIL.
- 20 NEW 16 FEET HIGH PEDESTRIAN LIGHT POLE. SEE ELECTRICAL SHEETS FOR DETAIL.
- 21 NEW SURFACE FINISH. SEE SHEET A0.20 FOR FINISH INFORMATION.
- 22 NEW BIKE RACK. SEE A0.30 FOR INFORMATION.
- 23 NEW DRINKING WATER FOUNTAIN. SEE A0.30 FOR INFORMATION.
- 24 NEW PRECAST CONCRETE SEAT ON CONCRETE WALL. SEE DETAIL 1/A0.41 FOR INFORMATION.
- 25 NEW DECORATIVE LANDSCAPE LIGHT FIXTURE. SEE ELECTRICAL SHEETS FOR DETAIL.
- 26 NEW METAL CANOPY. SEE SHEET A4.10 FOR INFORMATION.
- 27 BENCHES - TYPICAL OF 3. SEE SHEET A0.30 FOR INFORMATION.
- 28 NEW TRASH / RECYCLING CAN - TYPICAL OF 2. SEE SHEET A0.30 FOR INFORMATION.
- 29 NEW SURFACE FINISH. SEE SHEET A0.20 FOR FINISH INFORMATION.
- 30 NEW SHELTER. SEE SHEET A3.10 FOR SYSTEM INFORMATION.
- 31 NEW SHADE STRUCTURE. SEE SHEET A2.10 FOR SYSTEM INFORMATION.
- 32 NEW 6-FT WIDE, 6-FEET HIGH 'CLEAR' ANNOZIDIZED ALUM. PICKET FENCE GATE WITH POST. SEE SHEET A0.40 FOR DETAIL.
- 33 NEW CONCRETE SEAT ON WALL WITH RAMP TO STAGE. SEE SHEET A1.10 FOR DETAIL.
- 34 NEW LOCKABLE HOSE BIBB. SEE CIVIL SHEETS.
- 35 NEW 18-FEET WIDE, 6-FEET HIGH CHAINLINK FENCE DOUBLE GATE WITH POST. SEE SHEET A0.41 FOR DETAIL. CHAINLINK FENCE ALONG SOUTH BOUNDARY OF PROPERTY.
- 36 SEE CIVIL SHEETS FOR MODIFIED AREA.
- 37 NEW CONCRETE SIDEWALK WITH CONCRETE STRUCTURAL WALL AT RETENTION AREA.
- 38 NEW PARK ENTRY SIGNAGE. SEE SHEET A0.11 FOR DETAIL.
- 39 DRYWELL CONNECTED TO WATER FOUNTAIN WITH 3" SCHEDULE 40 PVC DRAIN LINE. SEE SHEET A0.30 FOR DETAIL.
- 40 SECTION OF RELOCATED ALUMINUM PICKET FENCE

SITE PARKING INFORMATION

PER PARKING STANDARDS PROVIDED BY AMERICAN PLANNING ASSOCIATION, PARKS HAVING AN AREA OF 50 ACRES OR LESS TO HAVE 1 PARKING SPACE FOR EACH ONE-HALF ACRE OF DEVELOPED PARK AREA UP TO 15 ACRES, PLUS 1 PARKING SPACE FOR EACH 400 SQ. FEET OF FLOOR AREA IN THE REMAINING AREA OF EACH BUILDING IN THE PARK.

DEVELOPED AREA OF PARK = 0.75 ACRES = 2 PARKING SPACES REQUIRED

STAGE = 480 SQ. FEET = 2 PARKING SPACES REQUIRED

PARKING PROVIDED: 14 STANDARD SPACES (9' X 20')
01 ADA SPACE (12' X 20')

15 TOTAL SPACES

PER THE 2020 FLORIDA ACCESSIBILITY CODE TABLE 208.2, A MINIMUM OF (1) OF THE PROVIDED (15) PARKING SPACES SHALL BE ACCESSIBLE SPACES.

LEGEND

- LIGHT POLE WITH WI-FI & MULTISENSOR CCTV INFRASTRUCTURE
- LIGHT POLE WITH SINGLE HEAD
- PARKING STALL COUNT
- TRASH / RECYCLE CAN
- RELOCATED / NEW FENCE
- EXISTING FENCE TO REMAIN



PROPOSED SITE PLAN & KEYNOTES

SCALE: 1" = 10'-0"

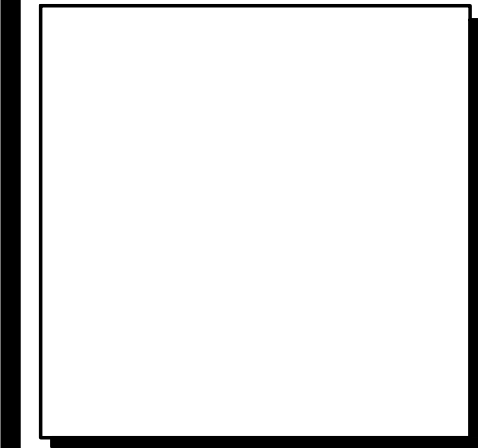

**WALTERS
ZACKRIA
ARCHITECTS**

5813 N. ANDREWS WAY
FORT LAUDERDALE, FL 33309
PHONE: (954) 522-4123
FAX: (954) 522-4128
www.wza-architects.com

Abbas H. Zackria, FL AR 91520

CORPORATE NAME: WALTERS ZACKRIA ASSOCIATES, PLLC REGISTERED IN THE STATE OF FLORIDA. WRITTEN DIMENSIONS TAKE PRECEDENCE OVER SCALED DIMENSIONS. THESE DRAWINGS ARE THE PROPERTY OF WALTERS ZACKRIA ASSOCIATES, PLLC, AND SHALL NOT BE REPRODUCED WITHOUT WRITTEN PERMISSION FROM A PRINCIPAL OF THE FIRM OR BE LIABLE FOR THE FULLEST LEGAL RECOURSE. CONTRACTOR SHALL VERIFY ALL EXISTING CONDITIONS AND DIMENSIONS AND NOTIFY THE ARCHITECT OF ANY DISCREPANCIES PRIOR TO EXECUTION OF WORK.

**CITY OF POMPANO BEACH
CHARLOTTE BURRIE COMM. CENTER
PLAZA AND PASSIVE PARK**

2669 N FEDERAL HWY.
POMPANO BEACH, FL 33064

DRAWN BY: JA
CHECKED BY: AZ
DATE: 08-21-2023

REVISIONS:

- 10-23-23 PERMIT CO-ORD
- 12-22-23 PERMIT CO-ORD
- 02-22-24 PERMIT CO-ORD
- 07-02-25 BID ADDENDUM

2203

A0.10B

SITE PLAN - PROPOSED

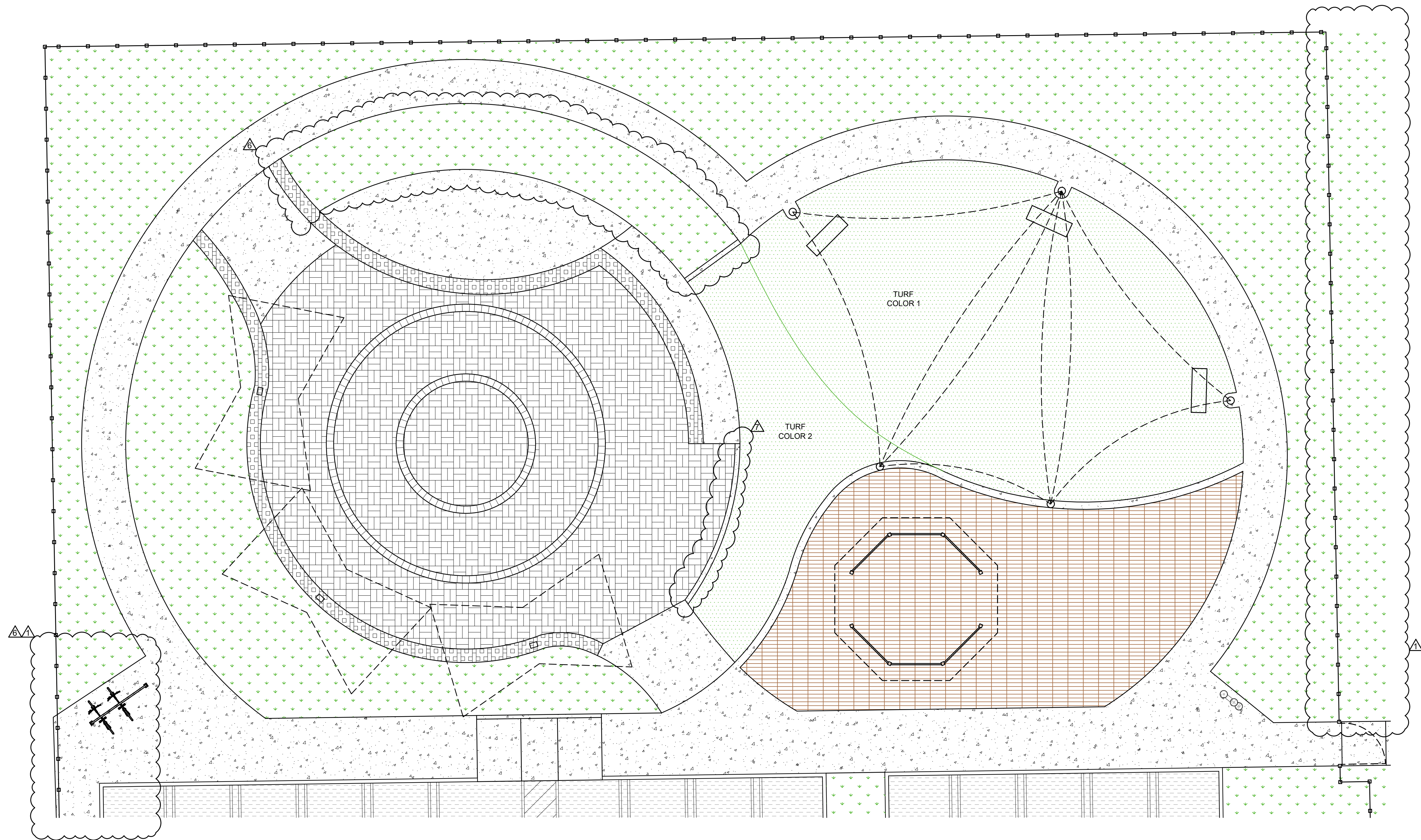

FINISHES / MATERIAL LEGEND:

- QUANTITIES TO BE DETERMINED BY CONTRACTOR.
- CONTRACTOR TO PROVIDE PHYSICAL SAMPLES OF MATERIALS SHOWN BELOW FOR OWNER APPROVAL OR GET A SUBSTITUTION APPROVED BY ARCHITECT AND OWNER PRIOR TO INSTALLATION.
- SEE SITE DETAILS SHEET FOR INSTALLATION INFORMATION.

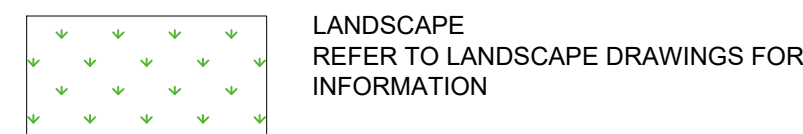

LANDSCAPE
REFER TO LANDSCAPE DRAWINGS FOR
INFORMATION

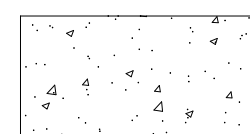

CONCRETE
BROOM FINISH
REFER TO CIVIL DRAWINGS FOR GRADES
AND CONCRETE MIX INFORMATION.
SEE A0.40 FOR SIDEWALK DETAIL.

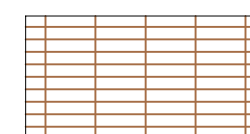

PAVERS: TYPE & COLOR TO MATCH WITH CIVIC CENTER
VEHICULAR DROP-OFF AREA
SEE INSTALLATION DETAIL ON A0.41
PRODUCT INFORMATION:

- 6" x 12" x 3" THK (FIELD) TRUFFLE BY "BELGARD",
MODULINE SERIES.
- 6" x 12" x 3" THK (BORDER) TRUFFLE BY "BELGARD",
MODULINE SERIES.
- SOLDIER COURSE PATTERN (ALTERNATING COLOR)
- PAVERS TO BE FLUSH WITH CONCRETE SIDEWALK

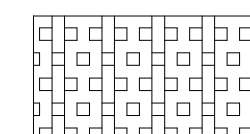

PRECAST CONCRETE
PRODUCT INFORMATION:
WAUSAU PRECAST CONCRETE 4" THK, 8 FEET LONG
SECTIONS, BEVELED EDGES.
FINISH TEXTURE - WEATHERSTONE W20 WHITE.



ARTIFICIAL TURF SURFACING
SEE INSTALLATION DETAIL ON A0.41
PRODUCT INFORMATION:
PLAYGROUND GRASS BY FOREVER LAWN.
SUBMIT SAMPLES TO OWNER FOR REVIEW OF COLORS.
COLOR 1 - ORANGE
COLOR 2 - YELLOW



ORANGE - YELLOW

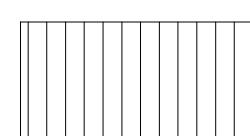

PAVERS
PRODUCT INFORMATION:
WAUSAU TILE ESTATE HRT-50
12" x 12" SQUARE TILE, 3" THK
APPLICATION ON PLAZA BORDER CIRCLES
AS SEEN ON PLAN ABOVE.



HRT-50

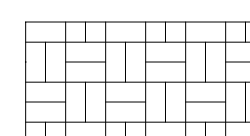

PAVERS
PRODUCT INFORMATION:
WAUSAU TILE ESTATE HRT-15, HRT-34, HRT-38
4" x 12" SQUARE TILE, 3" THK
RANDOM APPLICATION OF 3 COLORS IN BASKET
WEAVE PATTERN IN PLAZA AS SEEN ON PLAN ABOVE.



HRT-15

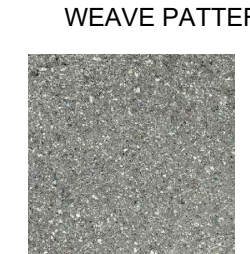

HRT-34



HRT-38



ASPHALT SURFACING
REFER TO CIVIL DRAWINGS FOR INFORMATION.



SITE PLAN - FINISHES

SCALE: 1/8" = 1'-0"

**WALTERS
ZACKRIA
ARCHITECTS**

5813 N. ANDREWS WAY
FORT LAUDERDALE, FL 33309
PHONE: (954) 522-4123
FAX: (954) 522-4128
www.wza-architects.com

Abbas H. Zackria, FL AR 91520

CORPORATE NAME: WALTERS ZACKRIA
ASSOCIATES, PLLC REGISTERED IN THE
STATE OF FLORIDA. WRITTEN
DIMENSIONS TAKE PRECEDENCE OVER
SCALED DIMENSIONS. THESE DRAWINGS
ARE THE PROPERTY OF WALTERS
ZACKRIA ASSOCIATES, PLLC, AND SHALL
NOT BE REPRODUCED WITHOUT WRITTEN
PERMISSION FROM A PRINCIPAL OF THE
FIRM OR BE LIABLE FOR THE FULLEST
LEGAL RECOUSE. CONTRACTOR SHALL
VERIFY ALL EXISTING CONDITIONS AND
DIMENSIONS AND NOTIFY THE
ARCHITECT OF ANY DISCREPANCIES
PRIOR TO EXECUTION OF WORK.

**CITY OF POMPANO BEACH
CHARLOTTE BURRIE COMM. CENTER
PLAZA AND PASSIVE PARK**

2669 N FEDERAL HWY,
POMPANO BEACH, FL 33064

DRAWN BY: JA
CHECKED BY: AZ
DATE: 08-21-2023

REVISIONS:
10-23-23 PERMIT CO-ORD
02-22-24 PERMIT CO-ORD
04-03-25 OWNER COMMENTS
07-02-25 BID ADDENDUM

2203

A0.20

SITE FINISHES



SKU: ALP479-38 Tags: 38 Gallon, Alpine, Back To School, Metal Slatted Trash, Outdoor Metal Trash Can, Outdoor Metal Trash Receptacle, Trash Can, Trash Receptacle

38 GALLON OUTDOOR METAL WASTE RECEPTACLE

FEATURES & BENEFITS

Design: Constructed with reinforced circular bands and rolled edges to ensure its longevity.

High-Capacity: The 38-gallon holding capability requires less emptying by maintenance workers.

Coating: A polyester powder that provides superior coverage, a polished finish, and deters vandals.

Optional: Partners well with our Rain Bonnet, which prevents rain and snow from flooding your receptacle.

Touch-Free: Without touching the receptacle physically, the risk of cross-contamination is eliminated.

- NOTE:
- COLOR OPTION TO BE SELECTED BY OWNER.
 - MANUFACTURERS:
 - ALPINE
 - TOPLINE RECREATION
 - APPROVED EQUAL

STEEL TRASH RECEPTACLE

NOT TO SCALE

Austin Bench

	cantilever backed	23°	72"	33"	Alum: 118 lb Wood: 150 lb
--	-------------------	-----	-----	-----	------------------------------------



BENCH AT BURRIE CIVIC CENTER

NOTE:
CONTRACTOR TO PROVIDE AND INSTALL BENCHES AS INDICATED ON SITE PLAN AS MANUFACTURED BY LANDSCAPE FORMS, INC. - CONTACT: LUIS SALAZAR (269) 337-1314. MODEL "AUSTIN" BACKED BENCH, CANTILEVER, ALUMINUM, WITH END ARMS (TYPICAL OF 3) CONTRACTOR TO MATCH NEW BENCH WITH EXISTING BENCH AT THE BURRIE CIVIC CENTER.

BENCH

NOT TO SCALE

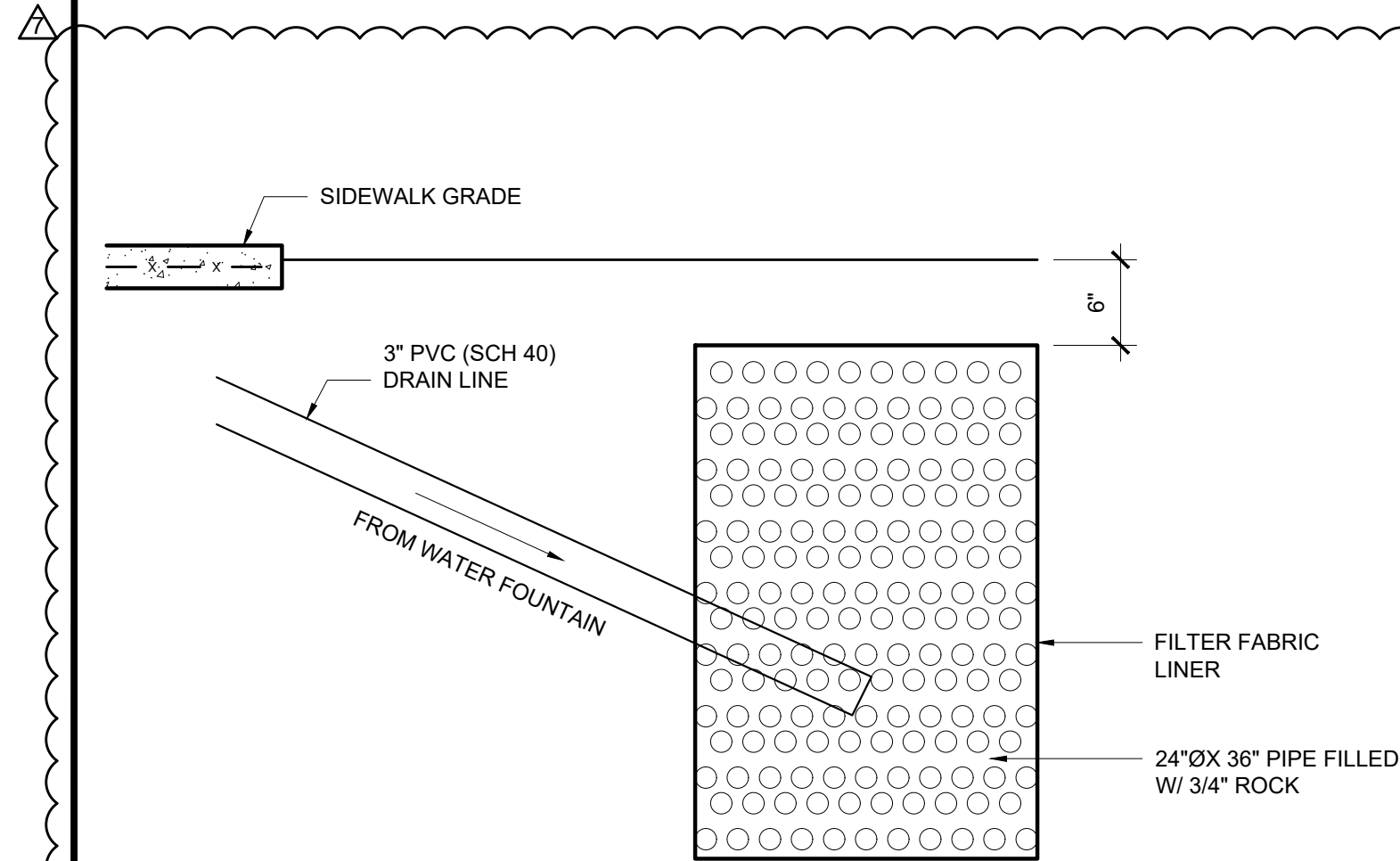

NOTE:
PIPE SHALL BE PREFORMED CORRUGATED METAL OR PERFORATED HDPE WRAPPED (INCLUDING TOP & BOTTOM) WITH FILTER FABRIC.

DRY WELL DETAIL

NOT TO SCALE



NOTE:
CONTRACTOR TO PROVIDE AND INSTALL FOUNTAIN BY MOST DEPENDABLE FOUNTAINS, MODEL - 440 SMFA WITH PET FOUNTAIN, OR APPROVED EQUAL. FINISH COLOR TO BE SELECTED BY OWNER.

DRINKING WATER FOUNTAIN WITH PET BOWL

NOT TO SCALE

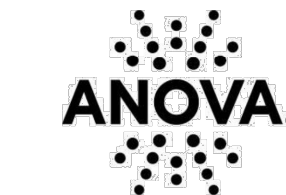

211 North Lindbergh Blvd.
St. Louis, MO 63141
800.231.1327 tel. | 314.754.0835 fax
specify@anovafurnishings.com
anovafurnishings.com

LBR7PSURF — Metro 5-Loop Bike Rack with 7-Bike Capacity, Powder Coated Finish and Surface Mount

Five-loop steel tubular bike rack with seven-bike capacity, powder coated finish and surface mount

Material

The bike rack is 63.63" wide and can accommodate seven bicycles. A bicycle can be parked within each of the upper and lower loops plus on the outside of each leg. The rack is made from 2.38" O.D. x 11-gauge wall steel tubing. Each leg features a 5" diameter mounting plate with predrilled holes for easy surface mounting. Mounting hardware is not included.

Finish

Fade-resistant, powder coated steel tubing features a state-of-the-art primer proven to prevent rusting. Treated components exceed the industry by 34% in testing by independent sources.

Color

See website or sales representative for color choices.

Assembly

Bike rack requires no assembly except for the surface mounting.

Maintenance

The product is virtually maintenance-free and requires only periodic cleaning with a sponge and a solution of mild detergent and water to remove surface dirt. Do not clean with solvent or petroleum base products.

Warranty

20-year limited structural warranty with 7-year finish warranty against fading from the date of purchase. See full details on multi-year warranties for components at www.anovafurnishings.com/warranty.aspx.

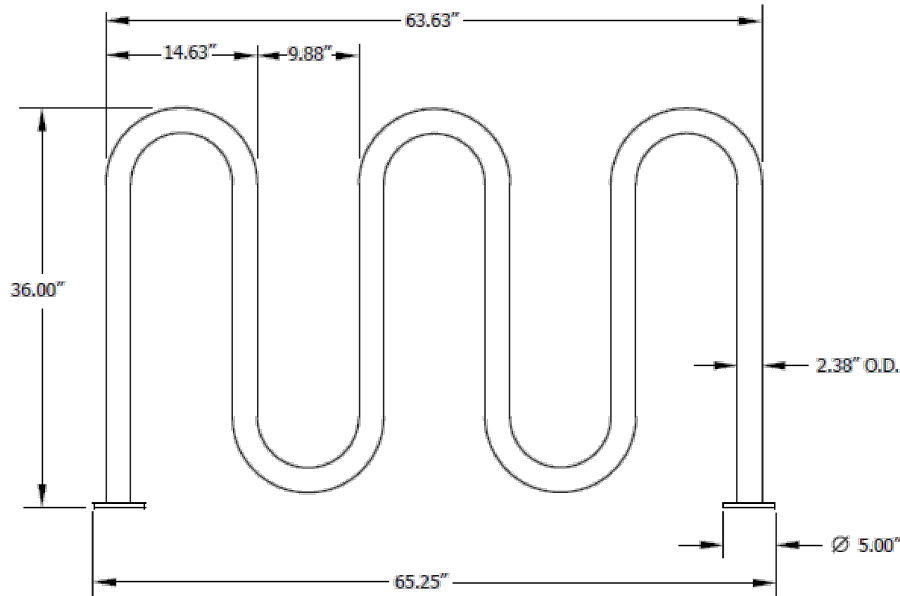
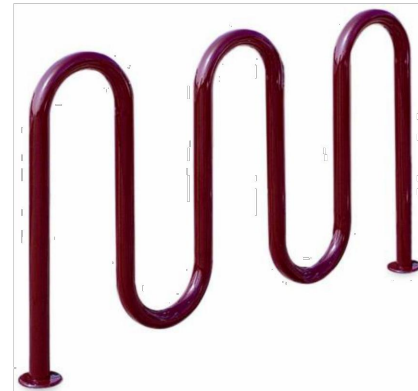

SHIPPING INFORMATION

Unit Weight	Unit Shipping Wt. UPS	Unit Shipping Wt. Truck (1+ Units)	Unit Ship Size w/Pallet	Max Units Per Pallet	Pallet Size/Wt. (78" X 36")	Total No. Pkgs.	Shipping Class
59 lbs.	N/A	69 lbs./unit	17.06 cu. ft.	8	100 lbs.	1	92.5

11/25/2015 Copyright 2015 ANOVA® Made in U.S.A.

FINISH COLOR TO BE SELECTED BY OWNER

BIKE RACK

NOT TO SCALE



WALTERS ZACKRIA ARCHITECTS

5813 N. ANDREWS WAY
FORT LAUDERDALE, FL 33309
PHONE: (954) 522-4123
FAX: (954) 522-4128
www.wza-architects.com

Abbas H. Zackria, FL AR 91520

CORPORATE NAME: WALTERS ZACKRIA ASSOCIATES, PLLC REGISTERED IN THE STATE OF FLORIDA. WRITTEN DIMENSIONS TAKE PRECEDENCE OVER SCALED DIMENSIONS. THESE DRAWINGS ARE THE PROPERTY OF WALTERS ZACKRIA ASSOCIATES, PLLC, AND SHALL NOT BE REPRODUCED WITHOUT WRITTEN PERMISSION FROM A PRINCIPAL OF THE FIRM OR BE LIABLE FOR THE FULLEST LEGAL RECOURSE. CONTRACTOR SHALL VERIFY ALL EXISTING CONDITIONS AND DIMENSIONS AND NOTIFY THE ARCHITECT OF ANY DISCREPANCIES PRIOR TO EXECUTION OF WORK.

CITY OF POMPANO BEACH CHARLOTTE BURRIE COMM. CENTER PLAZA AND PASSIVE PARK

2669 N FEDERAL HWY,
POMPANO BEACH, FL 33064

DRAWN BY: JA
CHECKED BY: AZ
DATE: 08-21-2023
REVISIONS:

- 12-22-23 PERMIT CO-ORD
- 02-22-24 PERMIT CO-ORD
- 07-02-25 BID ADDENDUM

2203

A0.30

SITE FURNITURE

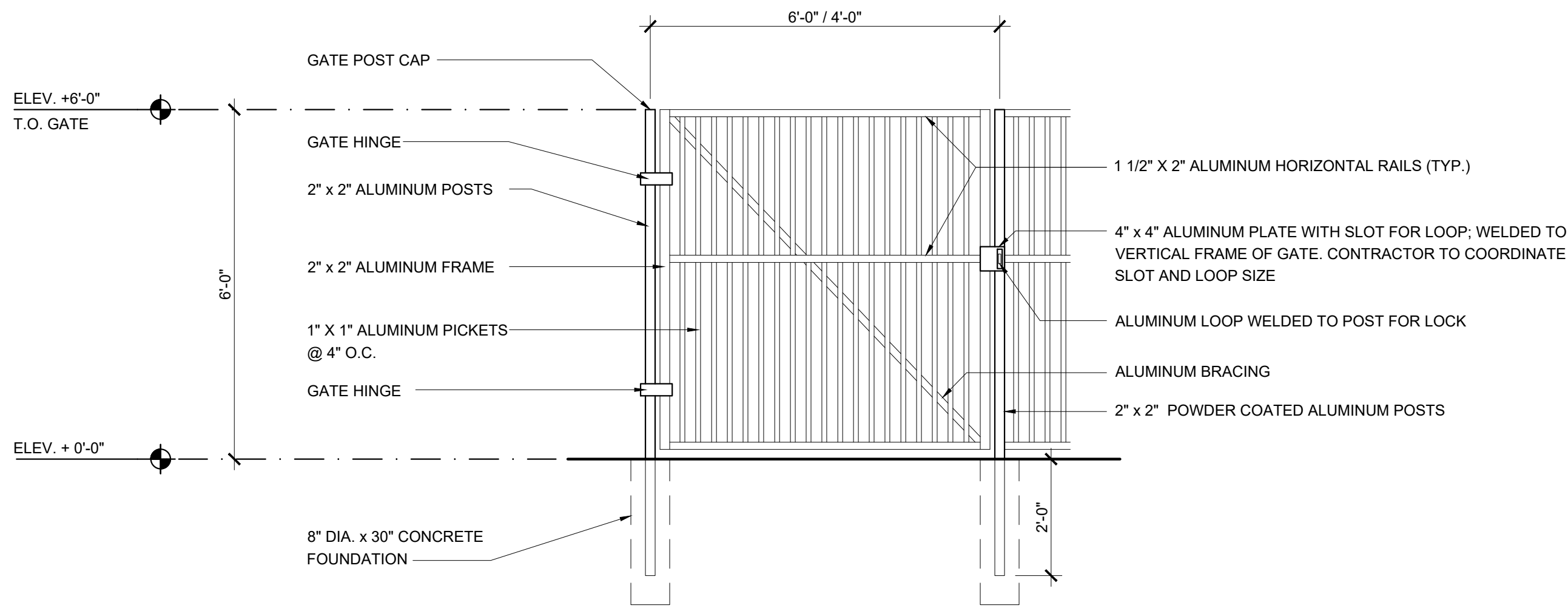

PEDESTRIAN GATE

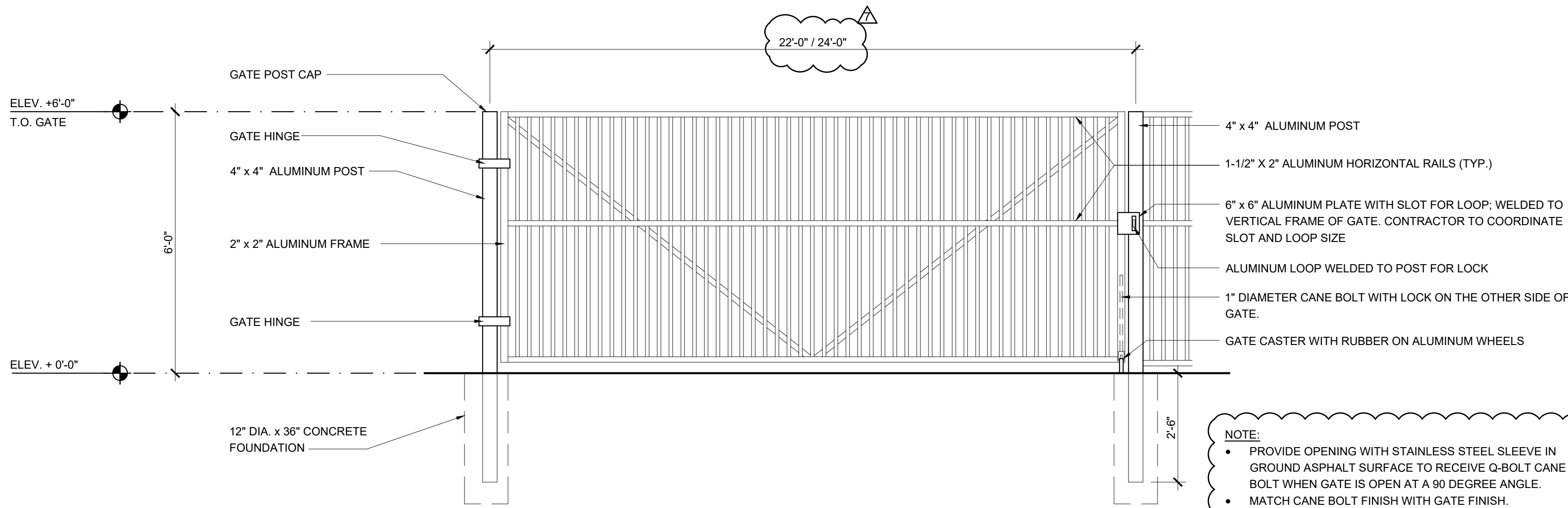

VEHICULAR GATE

NOTE:
SUBMIT SHOP DRAWINGS SIGNED AND SEALED BY A FLORIDA REGISTERED ENGINEER TO INCLUDE CALCULATIONS, FOOTERS, POSTS, FASTENERS, ANCHORS, ETC. FOR ARCHITECT AND OWNER REVIEW AND APPROVAL PRIOR TO FABRICATION AND INSTALLATION.

NOTE:
• PROVIDE OPENING WITH STAINLESS STEEL SLEEVE IN GROUND ASPHALT SURFACE TO RECEIVE Q-BOLT CANE BOLT WHEN GATE IS OPEN AT A 90 DEGREE ANGLE.
• MATCH CANE BOLT FINISH WITH GATE FINISH.
• KNOX BOX PADLOCK ON VEHICULAR GATE.
• ALUMINUM FENCE & GATE TO HAVE POWDER COATED FINISH. COLOR - ANO SILVER. OWNER TO CONFIRM.

1 TYPICAL ALUMINUM PICKET GATE DETAIL

SCALE: 1/2" = 1'-0"

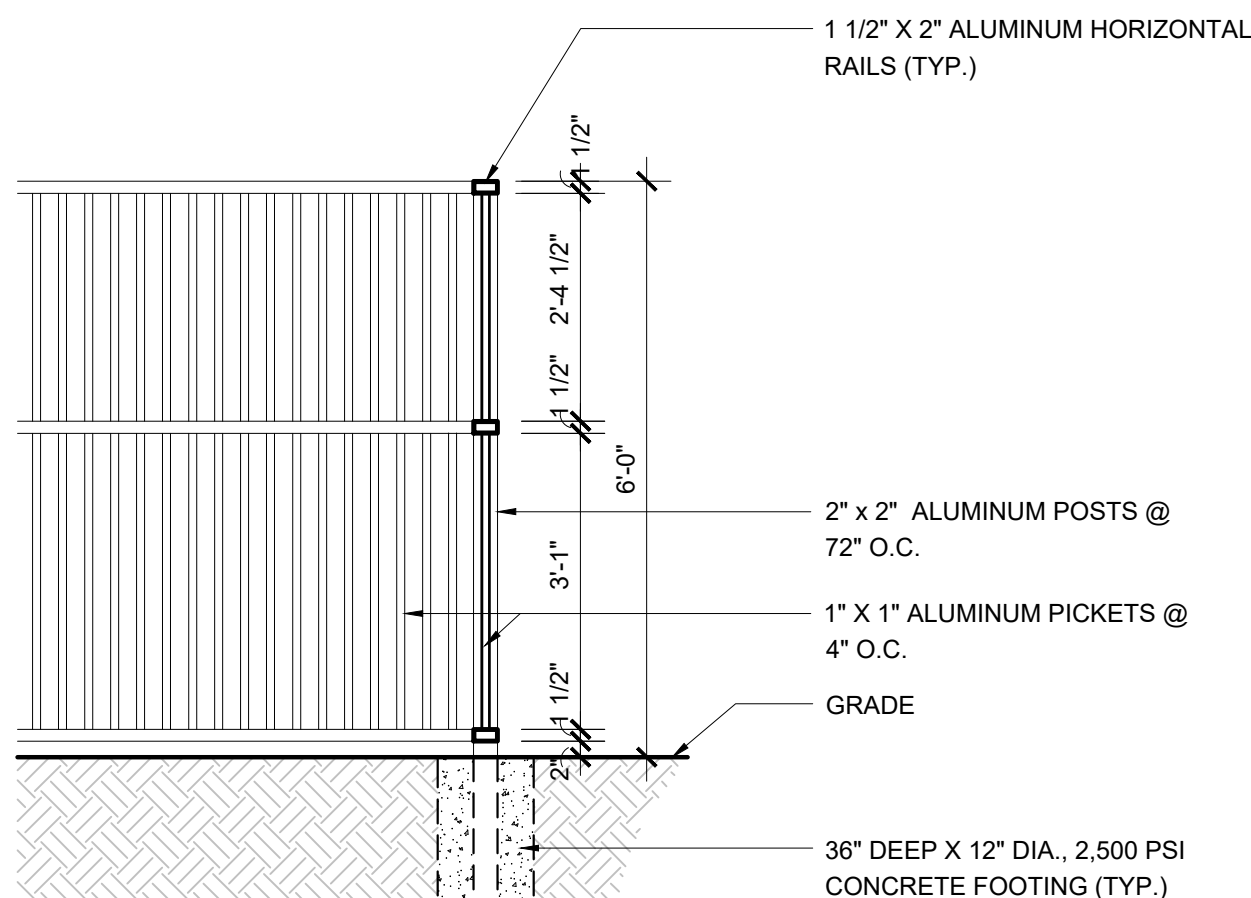

NOTE:
SUBMIT SHOP DRAWINGS SIGNED AND SEALED BY A FLORIDA REGISTERED ENGINEER TO INCLUDE CALCULATIONS, FOOTERS, POSTS, FASTENERS, ANCHORS, ETC. FOR ARCHITECT AND OWNER REVIEW AND APPROVAL PRIOR TO FABRICATION AND INSTALLATION. CONTRACTOR TO MATCH NEW FENCE WITH EXISTING PICKET FENCE AT CIVIC CENTER.

POSTS:
2" x 2" POWDER COATED ALUMINUM POSTS @ 72" O.C. SET ALL POSTS IN 36" DEEP x 12" DIAMETER 2,500 PSI CONCRETE FOOTING. PROVIDE SLEEVE, SET IN NON-METALLIC GROUT, 30 INCHES.

PICKETS: 1" x 1" POWDER COATED ALUMINUM.

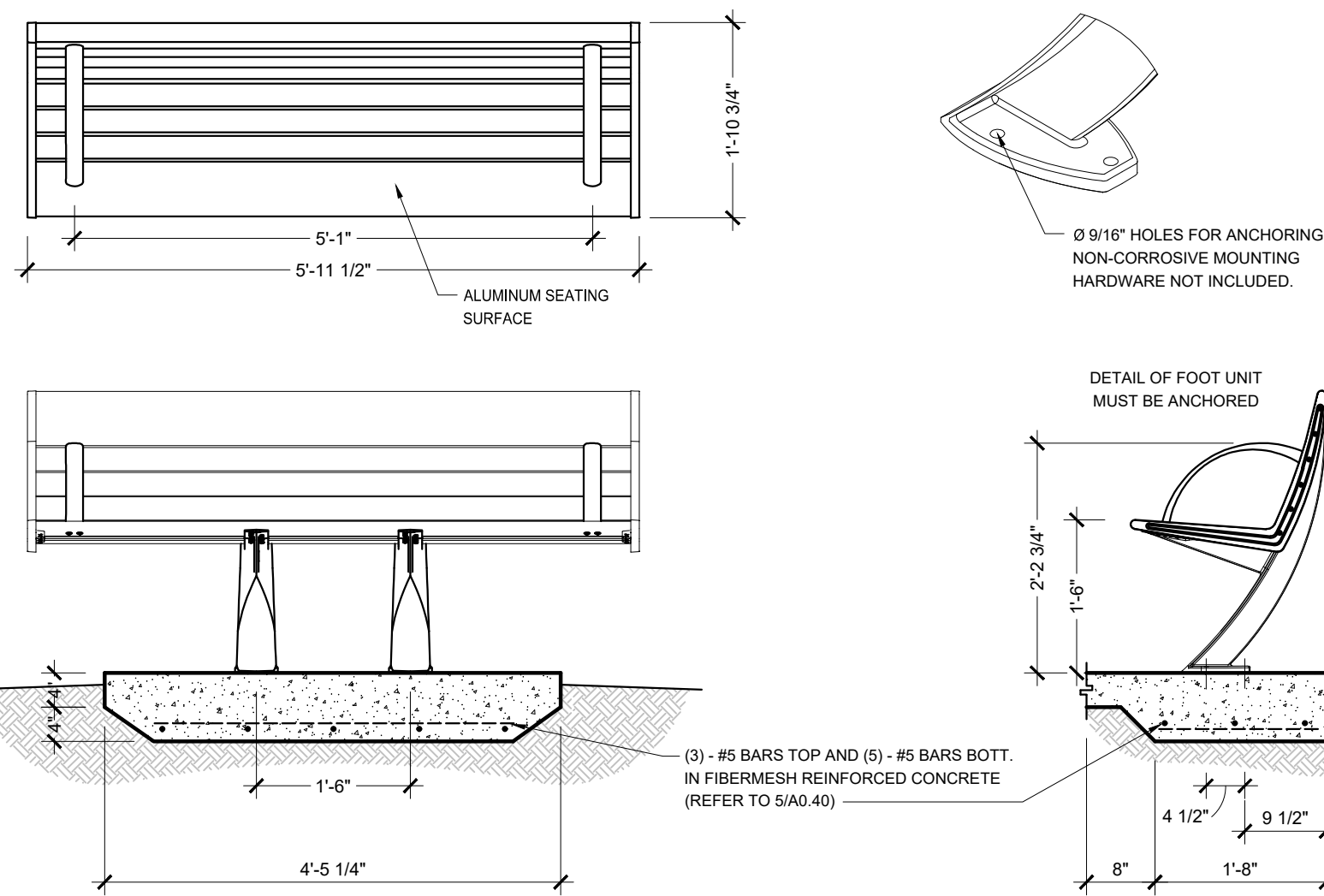

NOTE:
CONTRACTOR TO PROVIDE AND INSTALL BENCHES AS INDICATED ON SITE PLAN AS MANUFACTURED BY LANDSCAPE FORMS, INC. - CONTACT: LUIS SALAZAR (268) 337-1314. MODEL "AUSTIN" BACKED BENCH, CANTILEVER, ALUMINUM, WITH END ARMS (TYPICAL OF 3)
CONTRACTOR TO MATCH NEW BENCH WITH EXISTING BENCH AT THE CIVIC CENTER

3 BENCH DETAIL

SCALE: NOT TO SCALE

2 TYPICAL ALUMINUM PICKET FENCE DETAIL

SCALE: 1/2" = 1'-0"

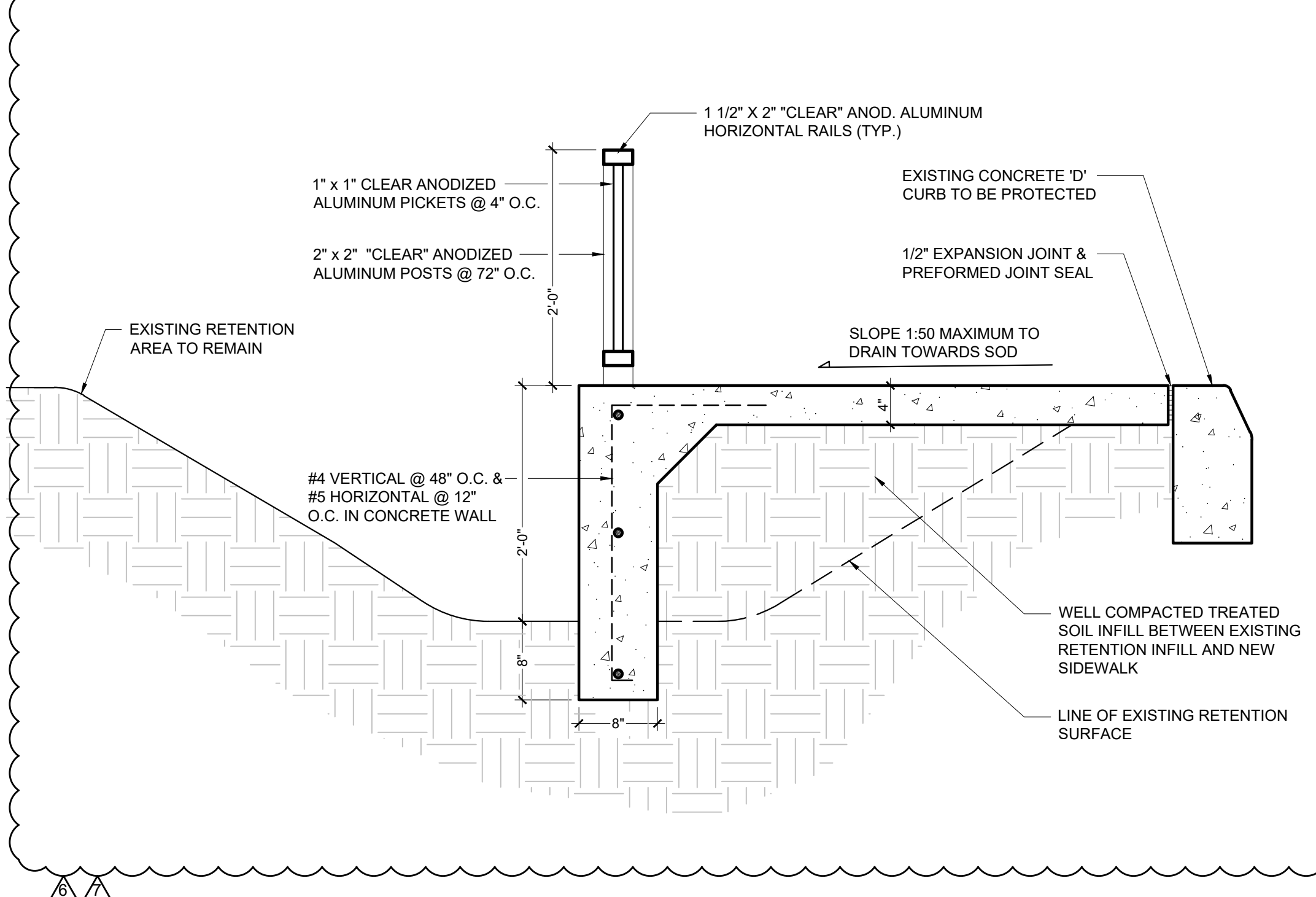

4 SIDEWALK DETAIL AT RETENTION AREA

SCALE: N/A

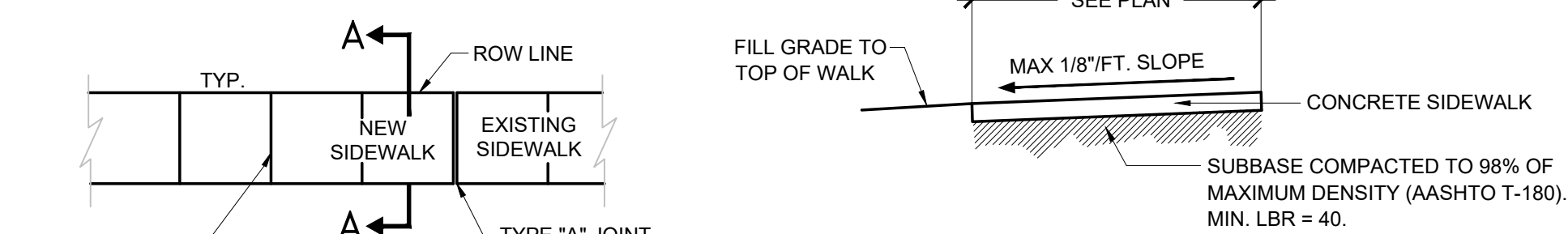

PLAN

SECTION A-A

TYPE "A"

P.C. AND P.T. CURVES. JUNCTION OF EXISTING AND NEW SIDEWALKS.

TYPE "B"

6'-0" CENTER TO CENTER ON SIDEWALKS.

TYPE "C"

WHERE SIDEWALK ABUTS CONCRETE CURBS, DRIVEWAYS AND SIMILAR STRUCTURES

SIDEWALK JOINT TYPES

CONCRETE SIDEWALK DETAIL NOTES

1. PROVIDE 1/8" CONTRACTION JOINTS AT 6' O.C. WITH A MINIMUM DEPTH 1-1/2", EDGED WITH A 1/4" RADIUS OR PROVIDE SAWED JOINTS 3/16" WIDE AND NOT LESS THAN 1-1/2" DEEP WITHIN THE FOLLOWING TIME PERIODS: JOINTS AT NOT MORE THAN 30' INTERVALS - WITHIN 12 HOURS AFTER FINISHING. REMAINING JOINTS WITHIN 96 HOURS AFTER FINISHING.
2. PROVIDE A 1/2" EXPANSION JOINTS WITH NON-RISING PREFORMED JOINT FILLER WHERE SIDEWALK ABUTS CONCRETE CURBS, DRIVEWAYS AND OTHER FIXED / EXISTING OBJECTS.
3. PROVIDE 4" THICK MINIMUM CONCRETE FOR ALL PEDESTRIAN SIDEWALKS.
4. PROVIDE 6X6 #8 WIRE MESH W/ 2" MINIMUM COVER.
5. CONCRETE TO BE 3,000 PSI IN 28 DAYS.
6. CURE ALL CONCRETE WITH CLEAN SAND, PLASTIC MEMBRANE OR OTHER APPROVED METHOD.
7. SIDEWALK FOUNDATION SHALL BE COMPACTED TO A FIRM, EVEN SURFACE, TRUE TO GRADE AND CROSS SECTION, AND SHALL BE MOIST AT THE TIME CONCRETE IS PLACED.
8. ALL CONSTRUCTION SHALL CONFORM TO LOCAL CONSTRUCTION CODES AND STANDARDS
9. GRADE ADJACENT LANDSCAPE AREAS TO MAX 1:4 (UNLESS OTHERWISE NOTED) SLOPE AWAY FROM NEW SIDEWALK / SLAB TO EXISTING GRADE. RE-SOD LANDSCAPE AREAS AFTER RE-GRADING.

5 TYPICAL CONCRETE SIDEWALK DETAIL

SCALE: NOT TO SCALE

WALTERS ZACKRIA ARCHITECTS

5813 N. ANDREWS WAY
FORT LAUDERDALE, FL 33309
PHONE: (954) 522-4123
FAX: (954) 522-4128
www.wza-architects.com

Abbas H. Zackria, FL AR 91520

CORPORATE NAME: WALTERS ZACKRIA ASSOCIATES, PLLC REGISTERED IN THE STATE OF FLORIDA. WRITTEN DIMENSIONS TAKE PRECEDENCE OVER SCALED DIMENSIONS. THESE DRAWINGS ARE THE PROPERTY OF WALTERS ZACKRIA ASSOCIATES, PLLC, AND SHALL NOT BE REPRODUCED WITHOUT WRITTEN PERMISSION FROM A PRINCIPAL OF THE FIRM OR BE LIABLE FOR THE FULLEST LEGAL RECOURSE. CONTRACTOR SHALL VERIFY ALL EXISTING CONDITIONS AND DIMENSIONS AND NOTIFY THE ARCHITECT OF ANY DISCREPANCIES PRIOR TO EXECUTION OF WORK.

CITY OF POMPANO BEACH
CHARLOTTE BURRIE COMM. CENTER
PLAZA AND PASSIVE PARK

2669 N FEDERAL HWY.
POMPANO BEACH, FL 33064

DRAWN BY: JA
CHECKED BY: AZ
DATE: 08-21-2023

REVISIONS:
10-23-23 PERMIT CO-ORD
04-03-25 OWNER COMMENTS
07-02-25 BID ADDENDUM

2203

A0.40

SITE DETAILS

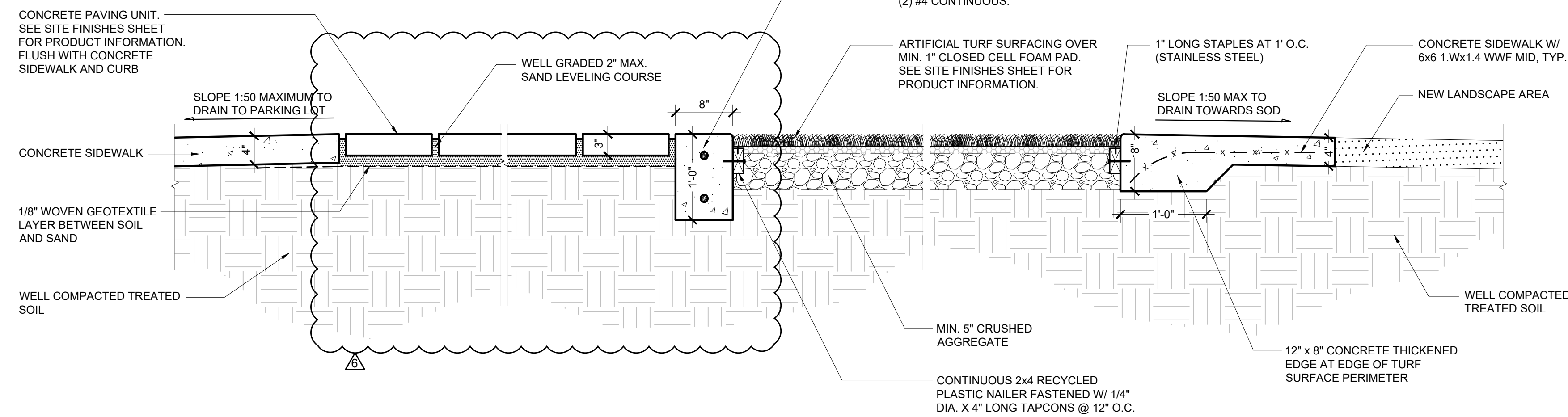

2 TURF - CURB - PAVER INSTALLATION DETAIL

SCALE: 1" = 1'-0"

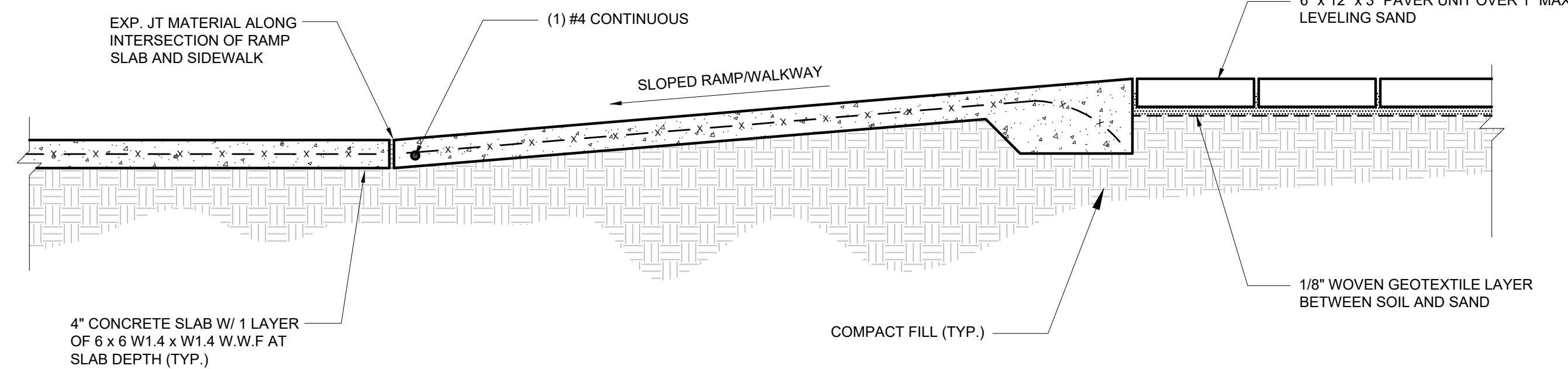

1 SIDEWALK - RAMP - PAVER DETAIL

SCALE: 1" = 1'-0"

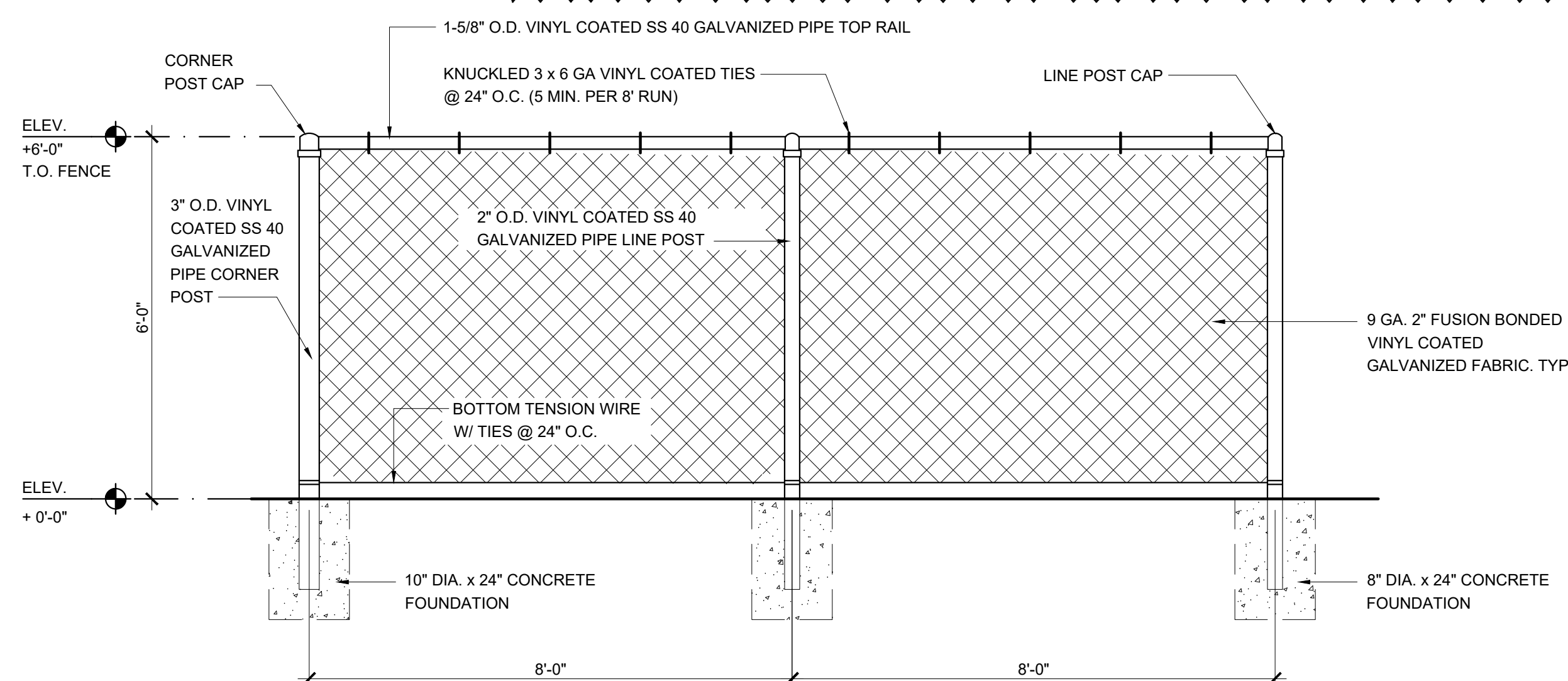

CHAIN LINK FENCE & GATE NOTES

1. CONTRACTOR TO PROVIDE GALVANIZED SILVER ZINC COATING ON ALL CHAIN LINK FENCE ELEMENTS, INCLUDING POSTS, RAILS, AND FABRIC
2. MAXIMUM POST SPACING SHALL BE 8'-0" O.C.
3. ALL DIMENSIONS TO CENTERLINE OF POSTS.
4. COMPLY WITH TABLE 2224 CHAIN LINK FENCE MINIMUM REQUIREMENTS OF THE FLORIDA BUILDING CODE EIGHTH EDITION (2023)
5. KNOX PAD LOCK W/ CHAIN TO BE USED FOR GATE LOCKING MECHANISM.
6. SUBMIT SHOP DRAWINGS SIGNED AND SEALED BY A FLORIDA REGISTERED ENGINEER TO INCLUDE CALCULATIONS, FOOTER POSTS, FASTENERS, ANCHORS, ETC. FOR ARCHITECT AND OWNER REVIEW AND APPROVAL PRIOR TO FABRICATION AND INSTALLATION.

DRAWN BY:	JA
CHECKED BY:	AZ
DATE:	08-21-2023
REVISIONS:	

04-03-25 OWNER COMMENTS
 07-02-25 BID ADDENDUM

2203

A0.41

SITE DETAILS

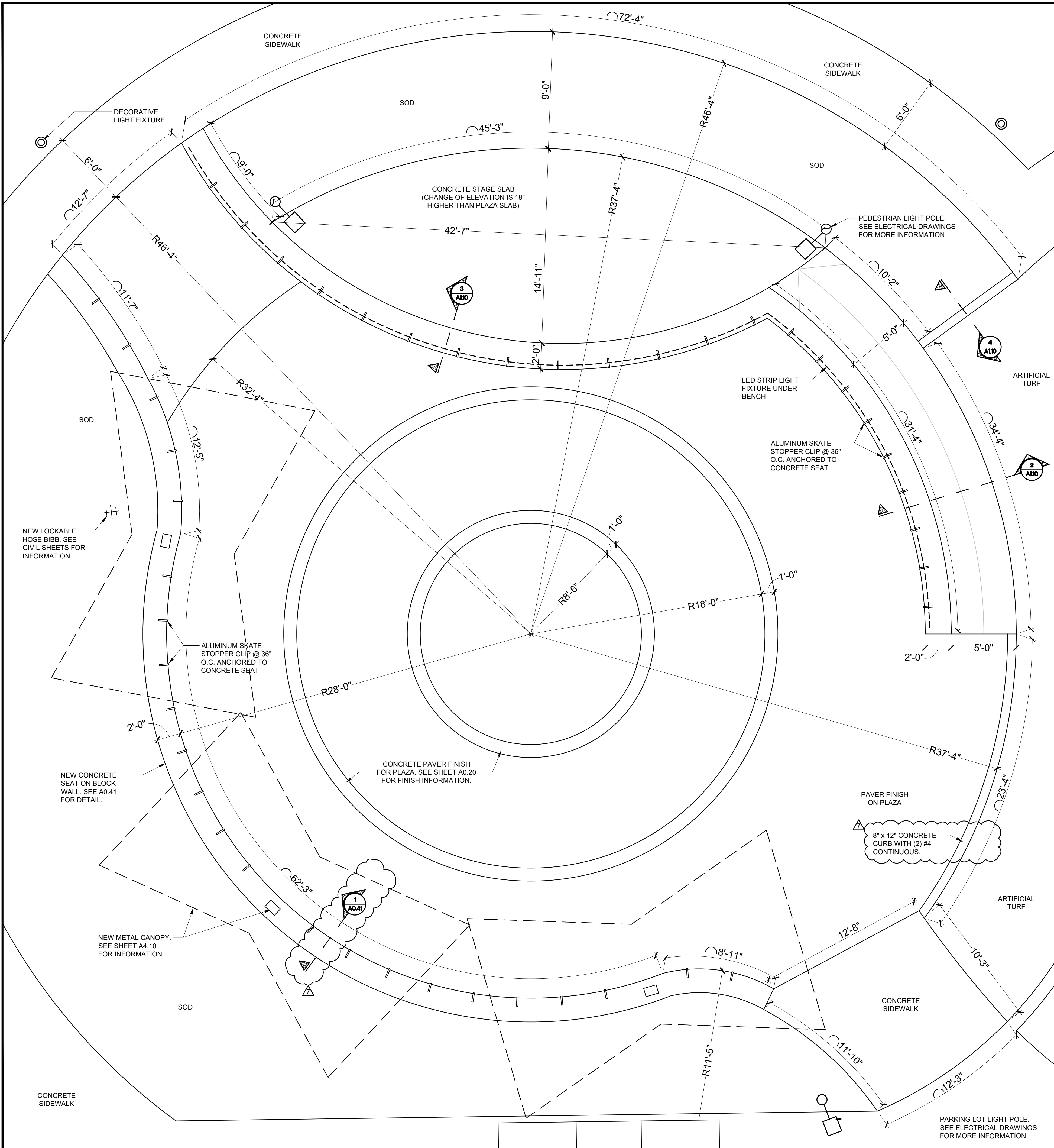

1 STAGE AND PLAZA LAYOUT PLAN
SCALE: 1/4" = 1'-0"

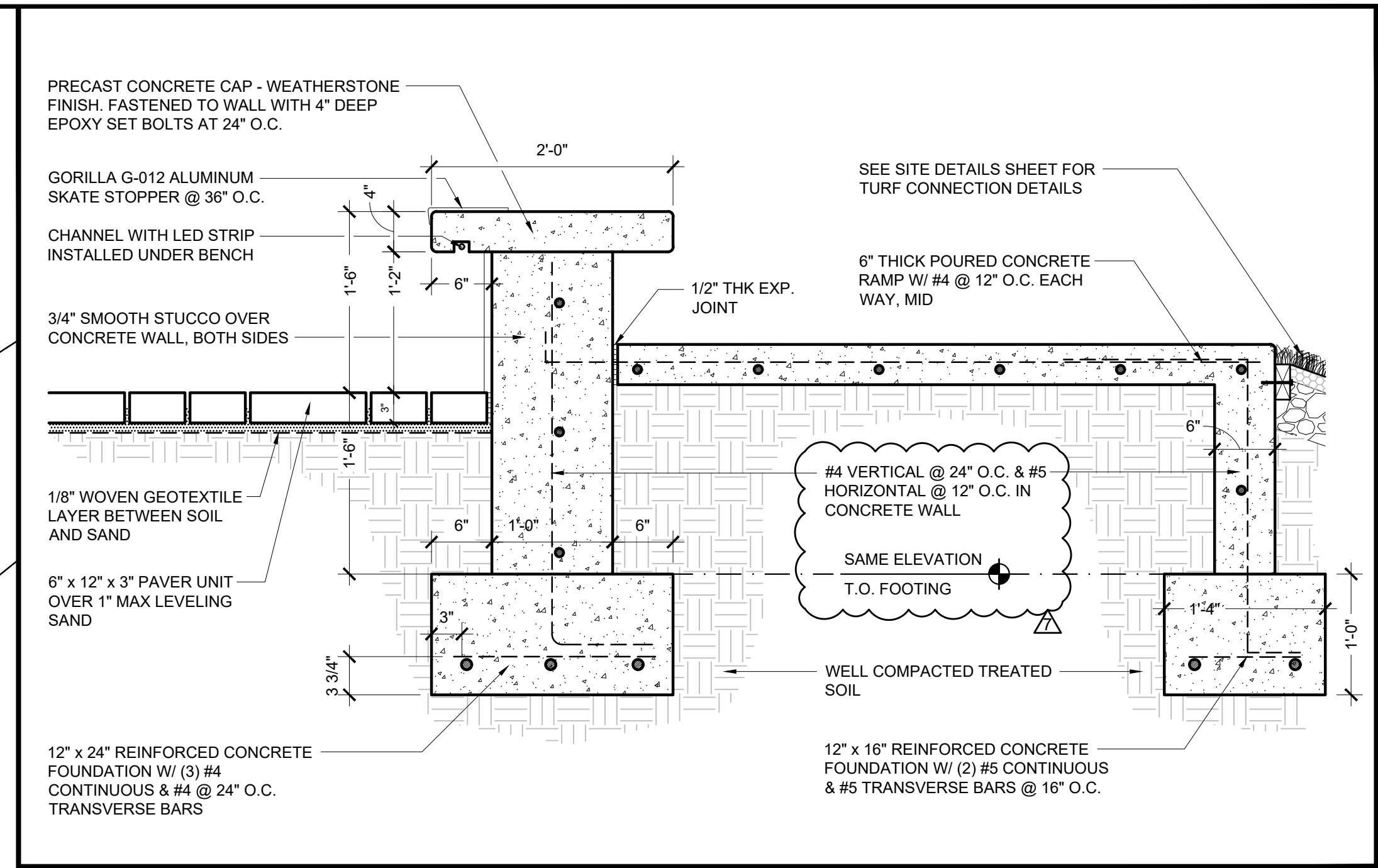

2 BENCH AND RAMP DETAIL
SCALE: 1" = 1'-0"

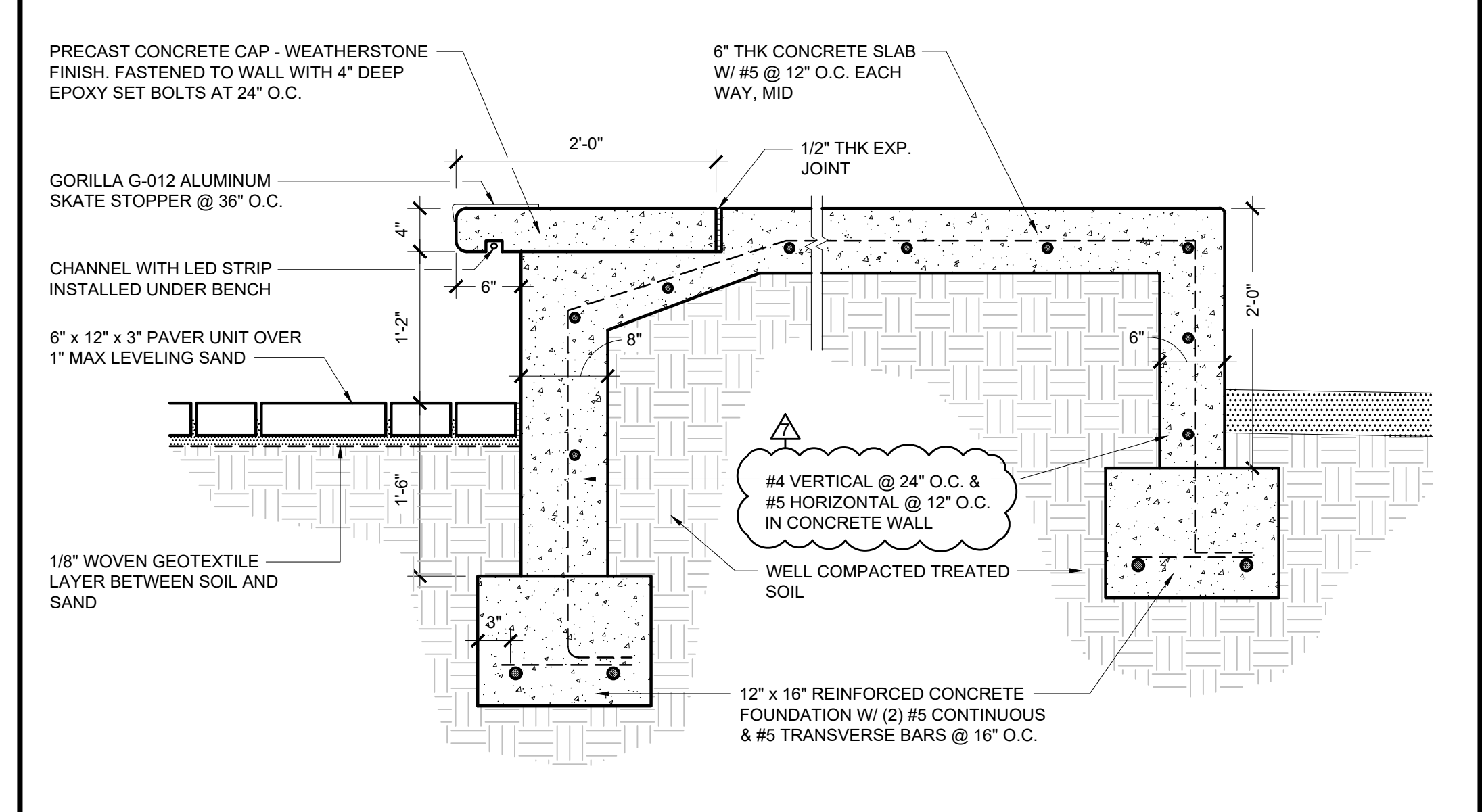

3 STAGE EDGE DETAIL
SCALE: 1" = 1'-0"

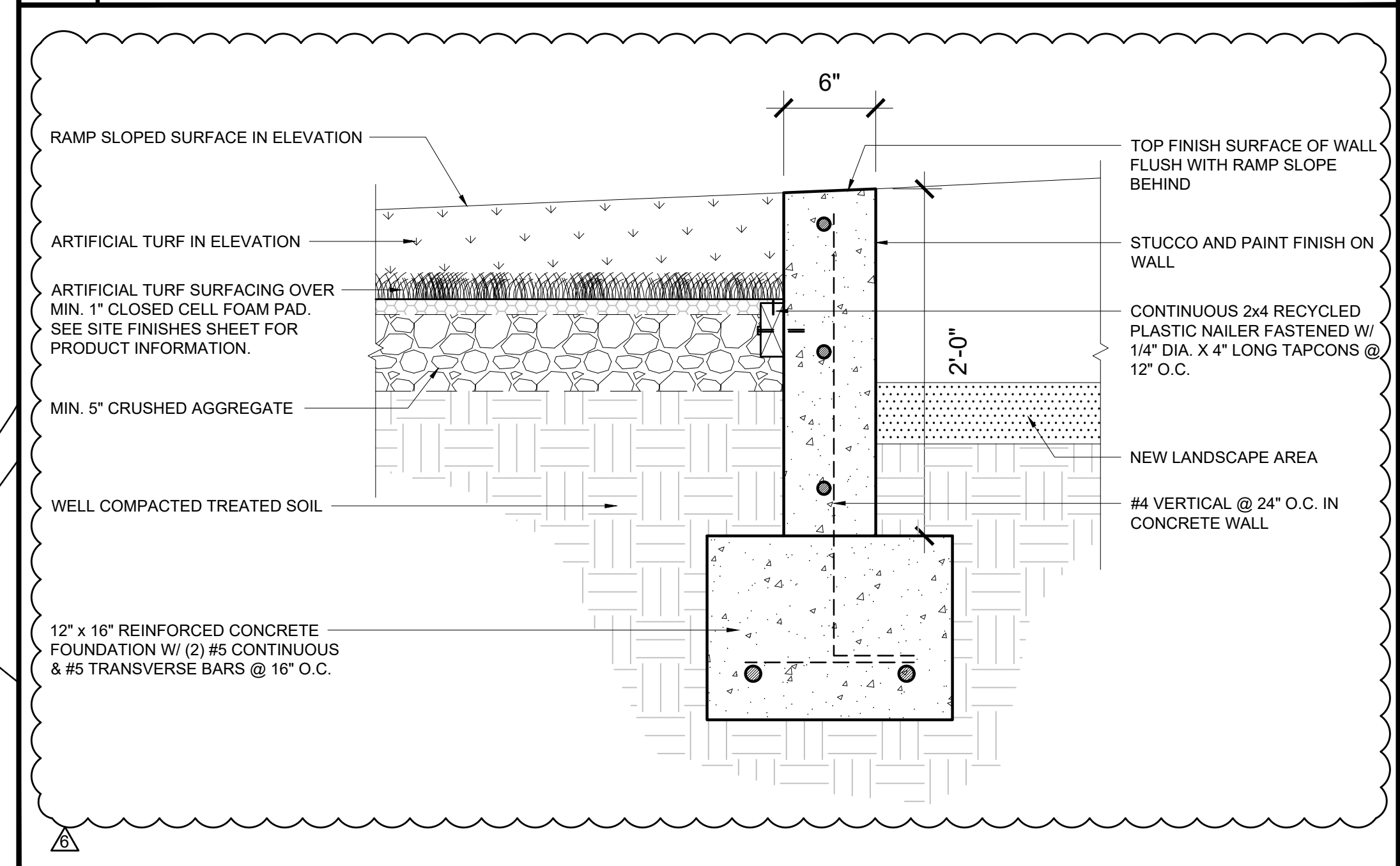

4 TURF - WALL - LANDSCAPE DETAIL
SCALE: 1-1/2" = 1'-0"

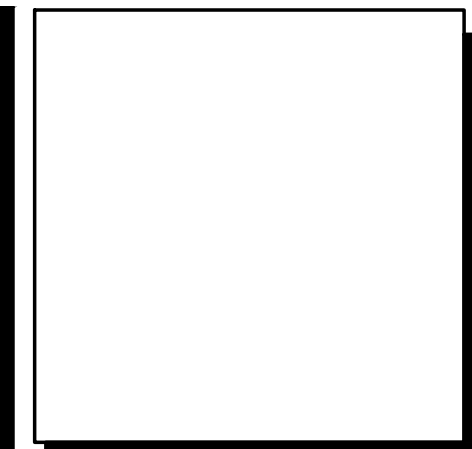

**WALTERS
ZACKRIA
ARCHITECTS**

5813 N. ANDREWS WAY
FORT LAUDERDALE, FL 33309
PHONE: (954) 522-4123
FAX: (954) 522-4128
www.wza-architects.com

Abbas H. Zackria, FL AR 91520

CORPORATE NAME: WALTERS ZACKRIA ASSOCIATES, PLLC REGISTERED IN THE STATE OF FLORIDA. WRITTEN DIMENSIONS TAKE PRECEDENCE OVER SCALED DIMENSIONS. THESE DRAWINGS ARE THE PROPERTY OF WALTERS ZACKRIA ASSOCIATES, PLLC, AND SHALL NOT BE REPRODUCED WITHOUT WRITTEN PERMISSION FROM A PRINCIPAL OF THE FIRM OR BE LIABLE FOR THE FULLEST LEGAL RECOURSE. CONTRACTOR SHALL VERIFY ALL EXISTING CONDITIONS AND DIMENSIONS AND NOTIFY THE ARCHITECT OF ANY DISCREPANCIES PRIOR TO EXECUTION OF WORK.

**CITY OF POMPANO BEACH
CHARLOTTE BURRIE COMM. CENTER
PLAZA AND PASSIVE PARK**

2669 N FEDERAL HWY.
POMPANO BEACH, FL 33064

DRAWN BY: JA
CHECKED BY: AZ
DATE: 08-21-2023

REVISIONS:

04-03-25 OWNER COMMENTS
07-02-25 BID ADDENDUM

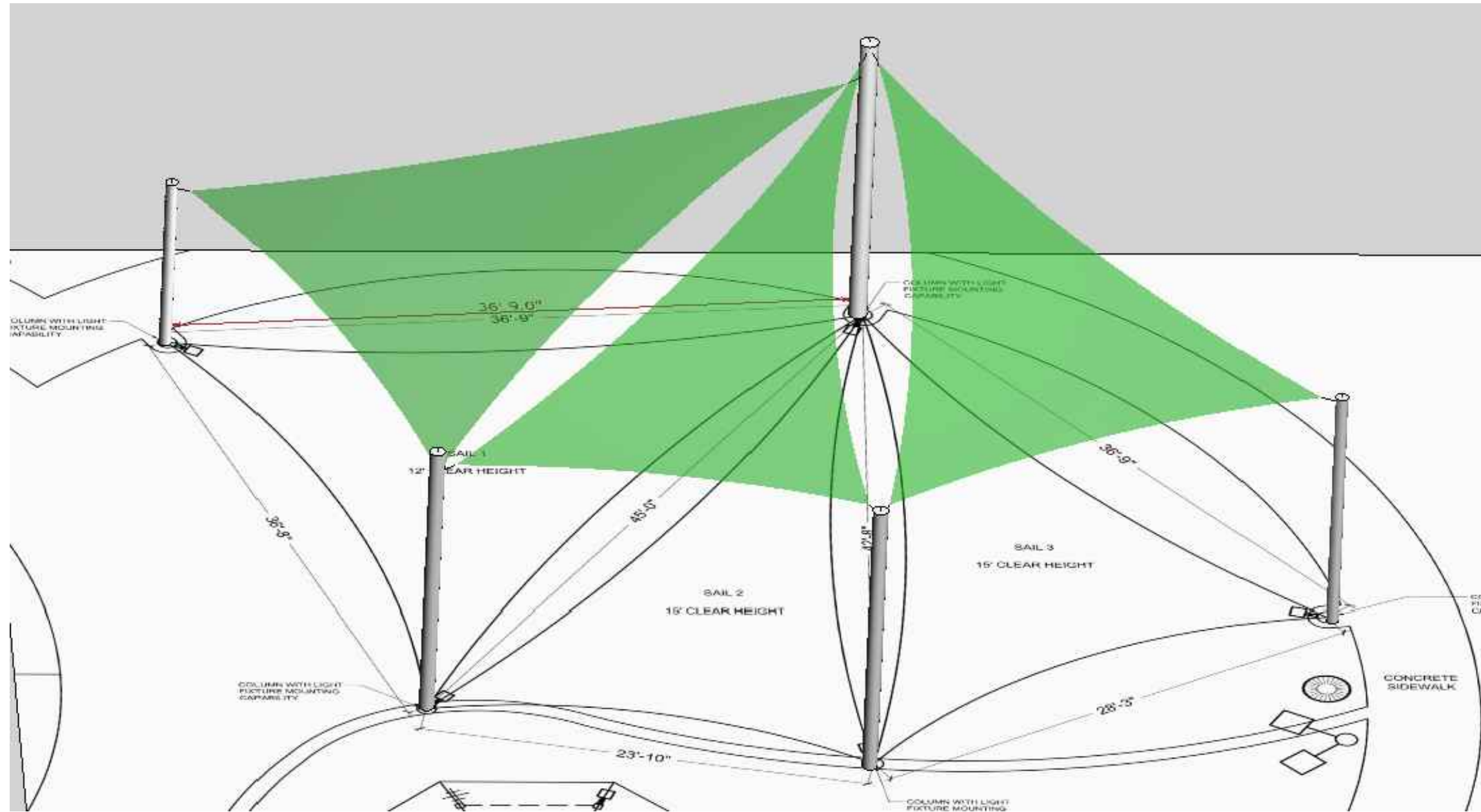

PLAY AREA SHADE STRUCTURE SCHEMATIC RENDER

PLAY AREA SHADE STRUCTURE FABRIC SAIL INFORMATION						
MARK	HEIGHT	SAIL ATTACHMENT POINTS			LIGHT FIXTURE MOUNTING HEIGHT	
		SAIL 1	SAIL 2	SAIL 3		
1	10' - 0"	9' - 8"			FIXTURE 1 : 9'-0" AFF	
2	15' - 0"	14' - 0"	13' - 6"	13' - 6"	FIXTURE 2 : 9'-0" AFF	
3	14' - 0"	13' - 0"	12' - 0"		FIXTURE 3 : 9'-0" AFF & FIXTURE 4 : 9'-0" AFF	
4	13' - 0"			12' - 6"	FIXTURE 5 : 9'-0" AFF	
5	12' - 0"		11' - 6"	11' - 0"	FIXTURE 6 : 9'-0" AFF & FIXTURE 7 : 9'-0" AFF	

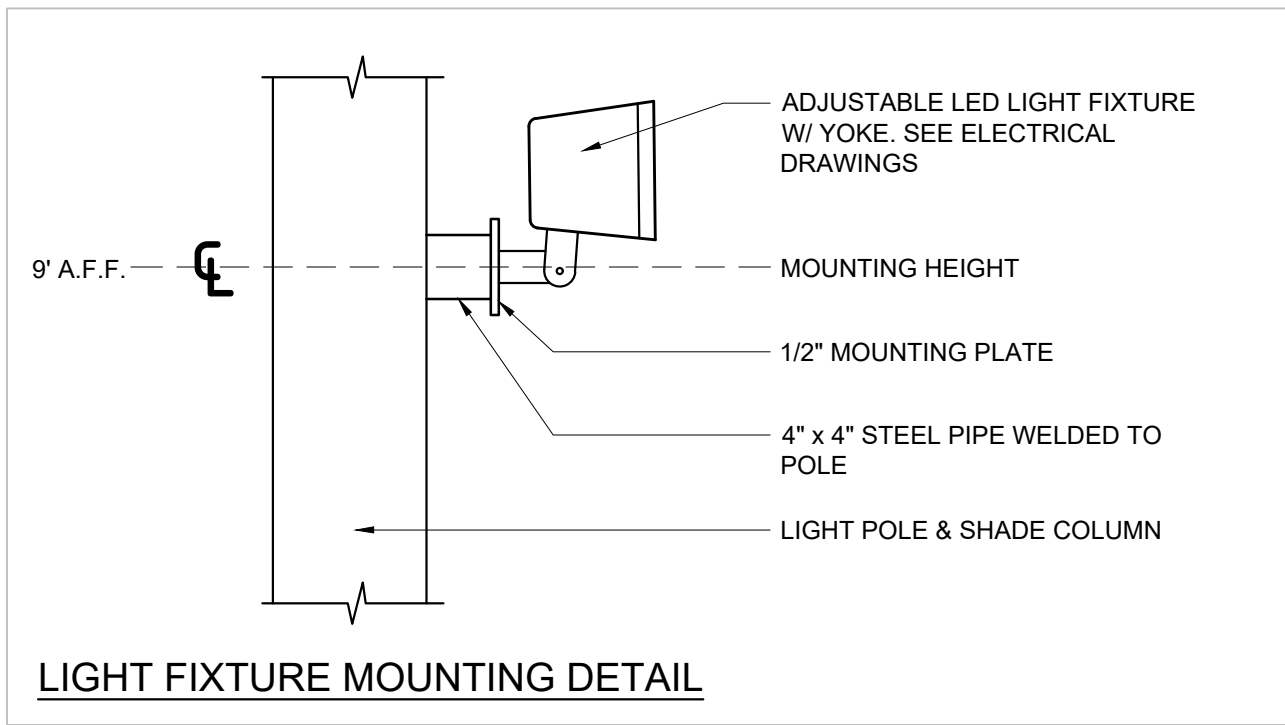

LIGHT FIXTURE MOUNTING DETAIL

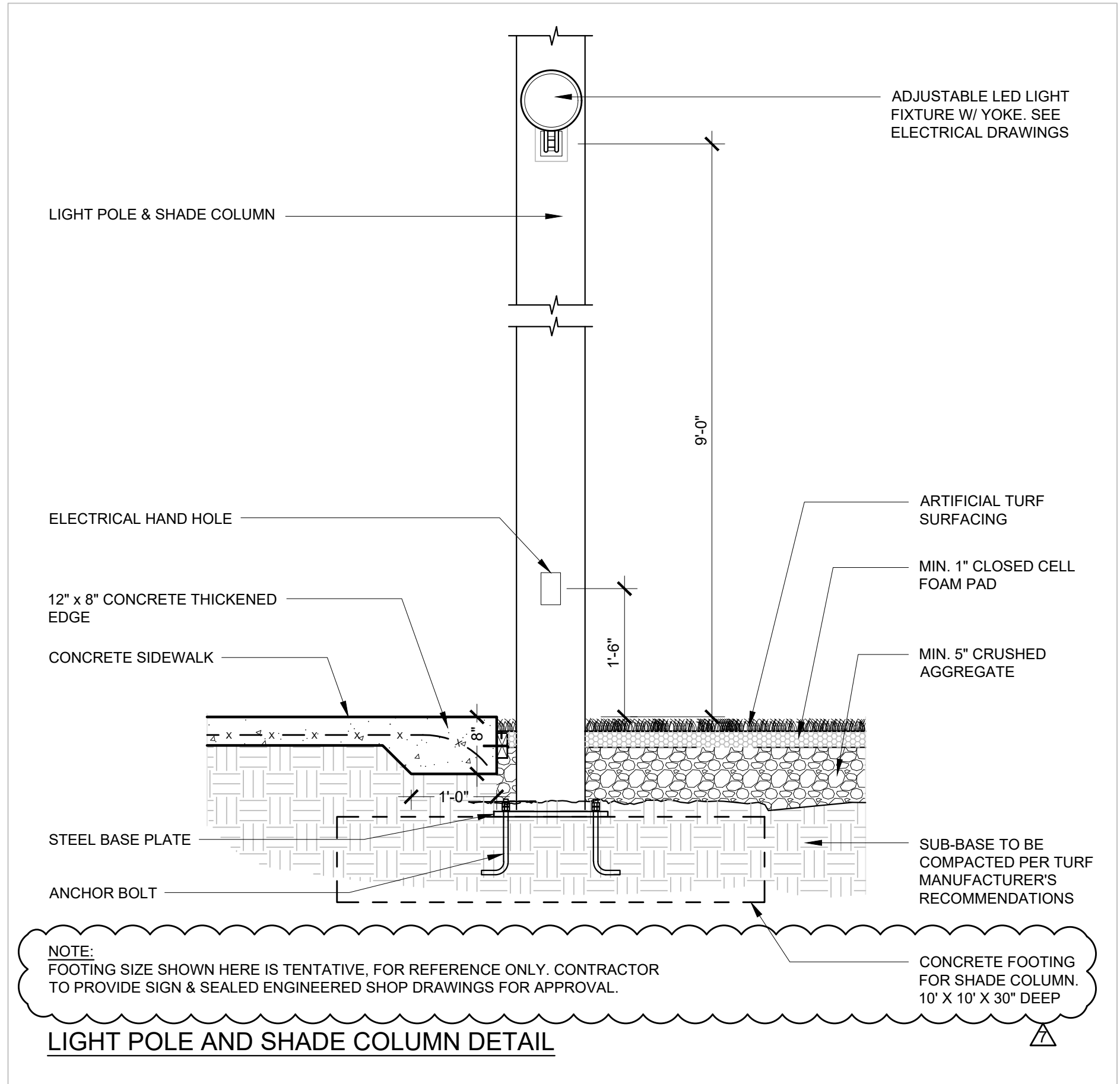

NOTE:

BASIS OF DESIGN FOR THE SHADE STRUCTURE SHALL BE CUSTOM SHADE SAILS BY SUPERIOR RECREATIONAL PRODUCTS, CARROLTON, GEORGIA.

CONTRACTOR SHALL PROVIDE SIGNED AND SEALED ENGINEERED DRAWINGS AND CALCULATIONS FOR SHADE STRUCTURE, INCLUDING FOUNDATIONS.

COLOR OF SHADE STRUCTURE COLUMNS AND FABRIC TO BE SELECTED BY OWNER.

PROVIDE CUT-OUTS AT ALL COLUMNS FOR NEW LIGHT FIXTURES. CO-ORDINATE WORK TO CONCEAL CONDUITS WITHIN HOLLOW STRUCTURAL STEEL COLUMNS. HEIGHT OF JUNCTION BOX FOR LIGHT FIXTURES SHALL BE AT 9'-0" ABOVE FINISH SURFACE.

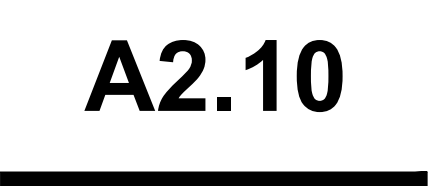
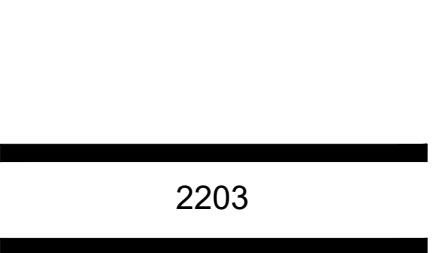
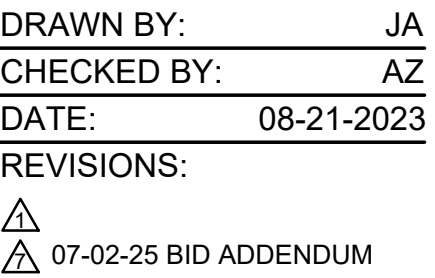
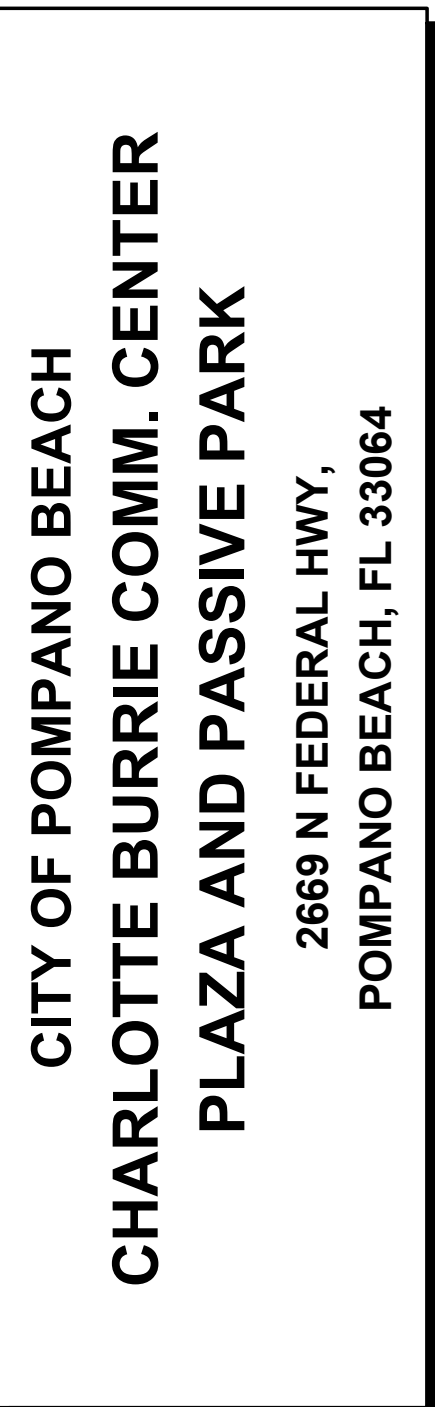
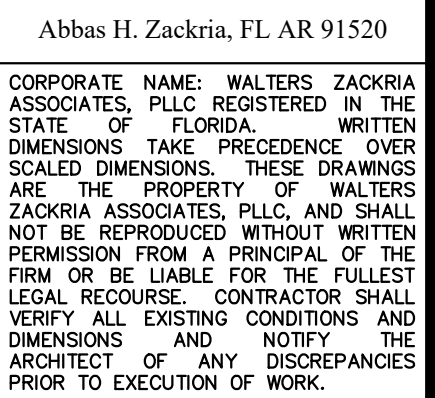
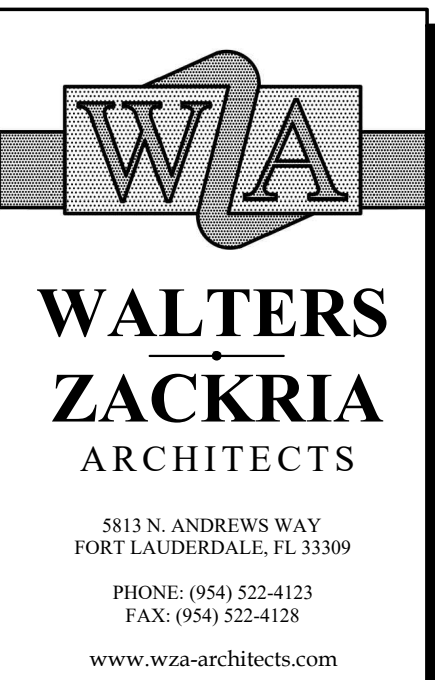
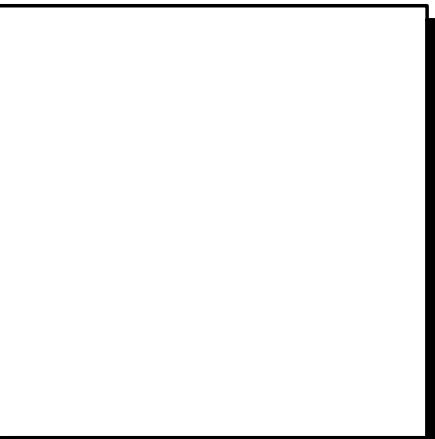
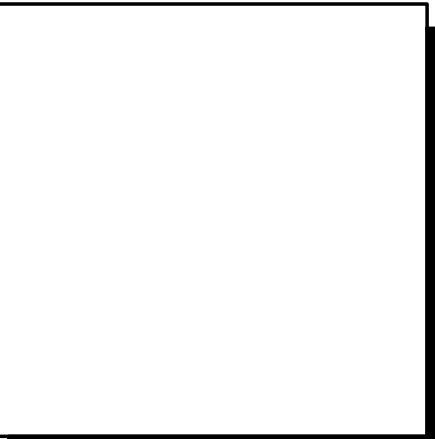
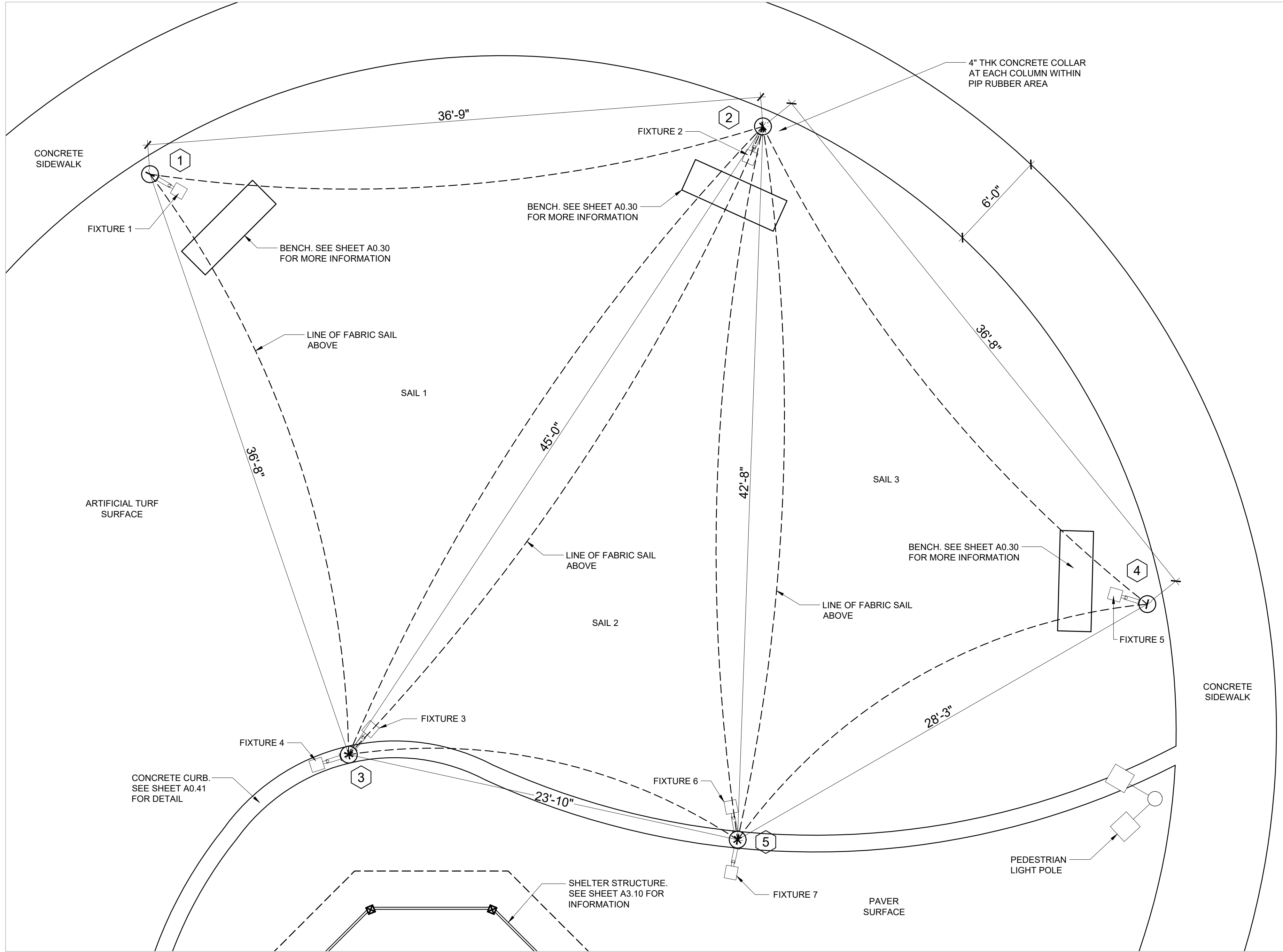
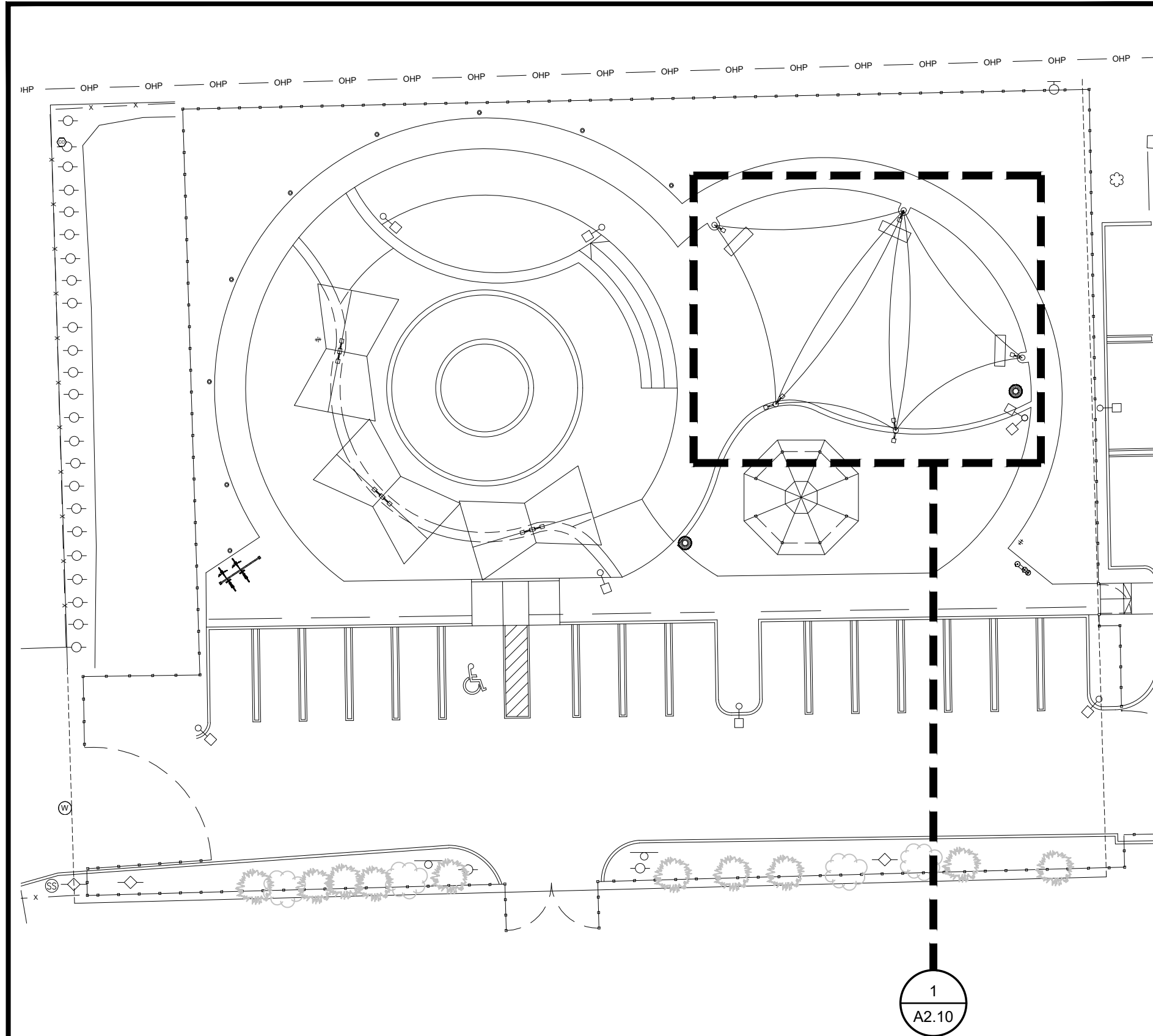

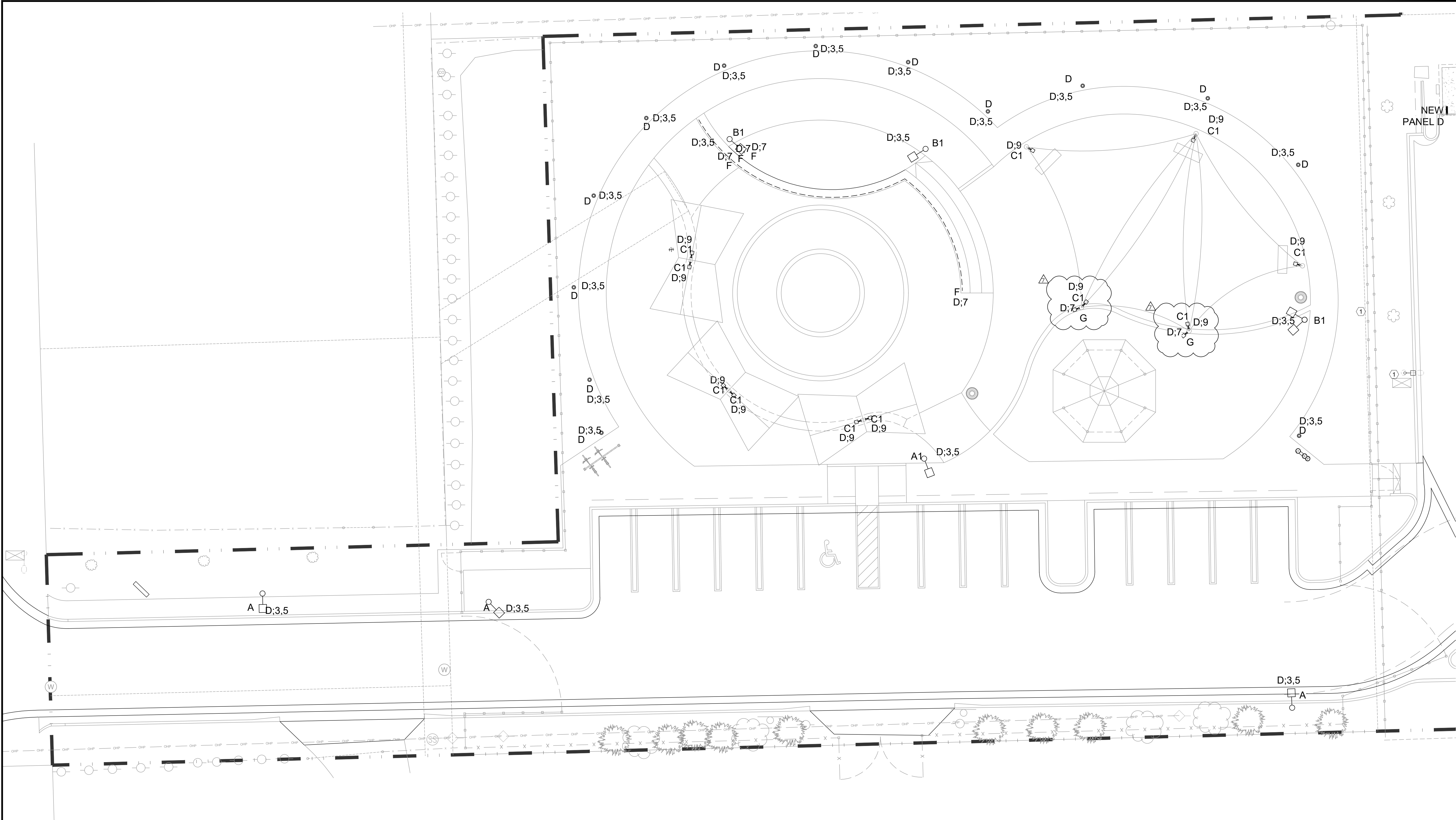

KEY NOTES:	
①	EXISTING LIGHT POLE TO REMAIN.

GENERAL NOTES:	
1.	CONTRACTOR SHALL PROVIDE SIGNED AND SEALED SHOP DRAWINGS FOR A FLORIDA STRUCTURAL PE FOR WIND RATINGS OF POLES & POLE MOUNTED FIXTURES.