

LANDSCAPE NOTES:

1. LANDSCAPE:
- A. GENERAL: CONDITIONS AND REQUIREMENTS
- 1) WORK TO INCLUDE FURNISHING LARGE MATERIALS, TOOLS AND EQUIPMENT, OBTAINING NECESSARY PERMITS, INSTALLING ALL MATERIALS NECESSARY TO THE PLANS AND AS HEREIN SPECIFIED.
- 2) THE INSTALLATION SHALL COMPLY WITH ALL REGULATIONS OF THE CITY OF POMPANO BEACH, FLORIDA. ALL LICENSES, PERMITS AND INSPECTIONS FOR THE WORK SHALL BE OBTAINED BY THE CONTRACTOR AT COMPLETION OF THE WORK. THE CONTRACTOR WILL TRANSFER ALL APPLICABLE AUTHORIZED REPRESENTATIVE.
- 3) THE CONTRACTOR AND THE LANDSCAPE SUPERINTENDENT SHALL PROVIDE A QUALIFIED FOREMAN PRESENT ON THE SITE AT ALL TIMES. THE FOREMAN SHALL BE RESPONSIBLE FOR THE PROPER INSTALLATION OF THE LANDSCAPE FOREMAN SHALL BE KNOWLEDGEABLE ABOUT SOUTH FLORIDA PLANT MATERIAL, AND ITS AUTHORIZED AGENT OF THE CONTRACTOR, CAPABLE OF MAKING ON-SITE DECISIONS.
- B. MATERIALS:
- 1) PLANT SIZES: ALL SIZES SHOWN FOR PLANT MATERIALS ON THE PLAN ARE TO BE CONSIDERED AS MINIMUMS. ALL PLANT MATERIAL MUST MEET OR EXCEED THE SPECIFICATIONS FOR PLANT HEIGHT AND SPREAD. ANY OTHER REQUIREMENTS FOR SPECIFIC SHAPE OR EFFECT AS NOTED ON THE PLAN WILL ALSO BE REQUIRED FOR ACCEPTANCE.
- 2) PLANT QUALITY: ALL PLANT MATERIAL INSTALLED SHALL BE CONSIDERED AS THE BEST AVAILABLE FOR THE GREEN IN GRANTS AND STANDARDS FOR NURSERY PLANTS FOR FLORIDA NO. 1 OR BETTER AS NUMBERS 1 AND 2 ARE SPECIFIED.
- 3) PLANTS NOT LISTED IN GRADING AND STANDARDS FOR NURSERY PLANTS FOR FLORIDA NO. 1 OR BETTER AS NUMBERS 1 AND 2 ARE SPECIFIED SHALL BE REMOVED AND REPLACED WITH PLANTS LISTED WITHIN THE STANDARDS FOR NURSERY PLANTS FOR FLORIDA NO. 1 OR BETTER AS NUMBERS 1 AND 2 ARE SPECIFIED. PLANTS TO BE REMOVED SHALL BE REMOVED FROM THE SITE AND NOT REUSED. PLANTS TO BE REMOVED SHALL BE REMOVED FROM THE SITE AND NOT REUSED. PLANTS TO BE REMOVED SHALL BE REMOVED FROM THE SITE AND NOT REUSED.
- 4) PLANTS THAT ARE ROOTBOUND OR ARE WELL-ROOTED SHALL BE REMOVED AND REPLACED WITH PLANTS THAT ARE ROOTBOUND OR ARE WELL-ROOTED. PLANTS THAT ARE ROOTBOUND OR ARE WELL-ROOTED SHALL BE REMOVED AND REPLACED WITH PLANTS THAT ARE ROOTBOUND OR ARE WELL-ROOTED.
- 5) CONTAINER GROWN PLANTS SHALL BE WELL-ROOTED. PLANTS THAT ARE ROOTBOUND OR ARE WELL-ROOTED SHALL BE REMOVED AND REPLACED WITH PLANTS THAT ARE ROOTBOUND OR ARE WELL-ROOTED.
- 6) PLANTS GROWN IN PLANTS SHALL BE WELL-ROOTED AND HEAVILY FOLIATED.
- 7) ROOT PRUNING: PLANTS SHALL BE RECOMMENDED OR CAUSED DIBBAC TO BE REMOVED IN EXCESS OF SEASONAL CHANGE. PLANTS EXHIBITING THESE CHARACTERISTICS WILL BE REMOVED AT THE REQUEST OF THE OWNER, OR AUTHORIZED REPRESENTATIVE.
- 8) PLANTS: ALL PLANTS SHALL BE FLORIDA GRADE NO. 1, STANDARDS FOR NURSERY PLANTS PART I.
- 9) SUBSTITUTIONS: SUBSTITUTIONS OF PLANT TYPE OR SIZE WILL NOT BE ACCEPTED UNLESS SUBSTANTIAL JUSTIFICATION IS PROVIDED. ANY SUBSTITUTIONS SHALL BE APPROVED BY THE ARCHITECT. ANY SUBSTITUTIONS SHALL BE APPROVED BY THE ARCHITECT. ANY SUBSTITUTIONS SHALL BE APPROVED BY THE ARCHITECT.
- 10) PLANTING SOIL: ALL PLANT MATERIAL INSTALLED SHALL BE PLANTED WITH TOPSOIL THAT IS CLEAN AND FREE OF ALL CONTAMINANTS. TOPSOIL IS TO BE USED TO BE FREE OF EXCESS CALCIUM AND HAVE A LIGHT TO MEDIUM TEXTURE. TOPSOIL IS TO BE USED TO BE FREE OF EXCESS CALCIUM AND HAVE A LIGHT TO MEDIUM TEXTURE. TOPSOIL IS TO BE USED TO BE FREE OF EXCESS CALCIUM AND HAVE A LIGHT TO MEDIUM TEXTURE.
- 11) MULCH: ALL MULCH SHALL BE FLOPKMULCH. METEALMULCH MULCH OF UNIFORM SIZE AND APPEARANCE.

- 1) PLANTING BEDS: THE PLANTING BEDS SHALL BE RECOMMENDED OR CAUSED DIBBAC TO BE REMOVED IN EXCESS OF SEASONAL CHANGE. PLANTS EXHIBITING THESE CHARACTERISTICS WILL BE REMOVED AT THE REQUEST OF THE OWNER, OR AUTHORIZED REPRESENTATIVE.
- 2) FERTILIZER: TREES AND SHRUBS SHALL BE FERTILIZED WITH 21 GRAIN AGROFARM FERTILIZER AND POTASSIUM ANALYSIS AT THE APPLICATION RATES AS FOLLOWS:
- 3) PLANTING BEDS: THE PLANTING BEDS SHALL BE RECOMMENDED OR CAUSED DIBBAC TO BE REMOVED IN EXCESS OF SEASONAL CHANGE. PLANTS EXHIBITING THESE CHARACTERISTICS WILL BE REMOVED AT THE REQUEST OF THE OWNER, OR AUTHORIZED REPRESENTATIVE.
- 4) PLANTING BEDS: THE PLANTING BEDS SHALL BE RECOMMENDED OR CAUSED DIBBAC TO BE REMOVED IN EXCESS OF SEASONAL CHANGE. PLANTS EXHIBITING THESE CHARACTERISTICS WILL BE REMOVED AT THE REQUEST OF THE OWNER, OR AUTHORIZED REPRESENTATIVE.
- 5) PLANTING BEDS: THE PLANTING BEDS SHALL BE RECOMMENDED OR CAUSED DIBBAC TO BE REMOVED IN EXCESS OF SEASONAL CHANGE. PLANTS EXHIBITING THESE CHARACTERISTICS WILL BE REMOVED AT THE REQUEST OF THE OWNER, OR AUTHORIZED REPRESENTATIVE.
- 6) PLANTING BEDS: THE PLANTING BEDS SHALL BE RECOMMENDED OR CAUSED DIBBAC TO BE REMOVED IN EXCESS OF SEASONAL CHANGE. PLANTS EXHIBITING THESE CHARACTERISTICS WILL BE REMOVED AT THE REQUEST OF THE OWNER, OR AUTHORIZED REPRESENTATIVE.
- 7) PLANTING BEDS: THE PLANTING BEDS SHALL BE RECOMMENDED OR CAUSED DIBBAC TO BE REMOVED IN EXCESS OF SEASONAL CHANGE. PLANTS EXHIBITING THESE CHARACTERISTICS WILL BE REMOVED AT THE REQUEST OF THE OWNER, OR AUTHORIZED REPRESENTATIVE.
- 8) PLANTING BEDS: THE PLANTING BEDS SHALL BE RECOMMENDED OR CAUSED DIBBAC TO BE REMOVED IN EXCESS OF SEASONAL CHANGE. PLANTS EXHIBITING THESE CHARACTERISTICS WILL BE REMOVED AT THE REQUEST OF THE OWNER, OR AUTHORIZED REPRESENTATIVE.
- 9) PLANTING BEDS: THE PLANTING BEDS SHALL BE RECOMMENDED OR CAUSED DIBBAC TO BE REMOVED IN EXCESS OF SEASONAL CHANGE. PLANTS EXHIBITING THESE CHARACTERISTICS WILL BE REMOVED AT THE REQUEST OF THE OWNER, OR AUTHORIZED REPRESENTATIVE.
- 10) PLANTING BEDS: THE PLANTING BEDS SHALL BE RECOMMENDED OR CAUSED DIBBAC TO BE REMOVED IN EXCESS OF SEASONAL CHANGE. PLANTS EXHIBITING THESE CHARACTERISTICS WILL BE REMOVED AT THE REQUEST OF THE OWNER, OR AUTHORIZED REPRESENTATIVE.
- 11) PLANTING BEDS: THE PLANTING BEDS SHALL BE RECOMMENDED OR CAUSED DIBBAC TO BE REMOVED IN EXCESS OF SEASONAL CHANGE. PLANTS EXHIBITING THESE CHARACTERISTICS WILL BE REMOVED AT THE REQUEST OF THE OWNER, OR AUTHORIZED REPRESENTATIVE.

- 1) PLANTING BEDS: THE PLANTING BEDS SHALL BE RECOMMENDED OR CAUSED DIBBAC TO BE REMOVED IN EXCESS OF SEASONAL CHANGE. PLANTS EXHIBITING THESE CHARACTERISTICS WILL BE REMOVED AT THE REQUEST OF THE OWNER, OR AUTHORIZED REPRESENTATIVE.
- 2) FERTILIZER: TREES AND SHRUBS SHALL BE FERTILIZED WITH 21 GRAIN AGROFARM FERTILIZER AND POTASSIUM ANALYSIS AT THE APPLICATION RATES AS FOLLOWS:
- 3) PLANTING BEDS: THE PLANTING BEDS SHALL BE RECOMMENDED OR CAUSED DIBBAC TO BE REMOVED IN EXCESS OF SEASONAL CHANGE. PLANTS EXHIBITING THESE CHARACTERISTICS WILL BE REMOVED AT THE REQUEST OF THE OWNER, OR AUTHORIZED REPRESENTATIVE.
- 4) PLANTING BEDS: THE PLANTING BEDS SHALL BE RECOMMENDED OR CAUSED DIBBAC TO BE REMOVED IN EXCESS OF SEASONAL CHANGE. PLANTS EXHIBITING THESE CHARACTERISTICS WILL BE REMOVED AT THE REQUEST OF THE OWNER, OR AUTHORIZED REPRESENTATIVE.
- 5) PLANTING BEDS: THE PLANTING BEDS SHALL BE RECOMMENDED OR CAUSED DIBBAC TO BE REMOVED IN EXCESS OF SEASONAL CHANGE. PLANTS EXHIBITING THESE CHARACTERISTICS WILL BE REMOVED AT THE REQUEST OF THE OWNER, OR AUTHORIZED REPRESENTATIVE.
- 6) PLANTING BEDS: THE PLANTING BEDS SHALL BE RECOMMENDED OR CAUSED DIBBAC TO BE REMOVED IN EXCESS OF SEASONAL CHANGE. PLANTS EXHIBITING THESE CHARACTERISTICS WILL BE REMOVED AT THE REQUEST OF THE OWNER, OR AUTHORIZED REPRESENTATIVE.
- 7) PLANTING BEDS: THE PLANTING BEDS SHALL BE RECOMMENDED OR CAUSED DIBBAC TO BE REMOVED IN EXCESS OF SEASONAL CHANGE. PLANTS EXHIBITING THESE CHARACTERISTICS WILL BE REMOVED AT THE REQUEST OF THE OWNER, OR AUTHORIZED REPRESENTATIVE.
- 8) PLANTING BEDS: THE PLANTING BEDS SHALL BE RECOMMENDED OR CAUSED DIBBAC TO BE REMOVED IN EXCESS OF SEASONAL CHANGE. PLANTS EXHIBITING THESE CHARACTERISTICS WILL BE REMOVED AT THE REQUEST OF THE OWNER, OR AUTHORIZED REPRESENTATIVE.
- 9) PLANTING BEDS: THE PLANTING BEDS SHALL BE RECOMMENDED OR CAUSED DIBBAC TO BE REMOVED IN EXCESS OF SEASONAL CHANGE. PLANTS EXHIBITING THESE CHARACTERISTICS WILL BE REMOVED AT THE REQUEST OF THE OWNER, OR AUTHORIZED REPRESENTATIVE.
- 10) PLANTING BEDS: THE PLANTING BEDS SHALL BE RECOMMENDED OR CAUSED DIBBAC TO BE REMOVED IN EXCESS OF SEASONAL CHANGE. PLANTS EXHIBITING THESE CHARACTERISTICS WILL BE REMOVED AT THE REQUEST OF THE OWNER, OR AUTHORIZED REPRESENTATIVE.
- 11) PLANTING BEDS: THE PLANTING BEDS SHALL BE RECOMMENDED OR CAUSED DIBBAC TO BE REMOVED IN EXCESS OF SEASONAL CHANGE. PLANTS EXHIBITING THESE CHARACTERISTICS WILL BE REMOVED AT THE REQUEST OF THE OWNER, OR AUTHORIZED REPRESENTATIVE.

NOTES:

CONTRACTOR SHALL BE RESPONSIBLE FOR LOCATING ALL UTILITIES. CARE SHOULD BE TAKEN NOT TO DISTURB OR DAMAGE ANY UTILITIES. ANY DAMAGE TO THESE UTILITIES WILL BE REPAIRED AT THE EXPENSE OF THE CONTRACTOR IN A MANNER APPROVED BY THE OWNER'S REPRESENTATIVE. WHERE UNDERGROUND CONSTRUCTION OR OBSTRUCTIONS WILL NOT PRESENT, THE CONTRACTOR SHALL BE RESPONSIBLE FOR THE PROPER INSTALLATION OF THE PLANT MATERIAL. THE CONTRACTOR SHALL BE RESPONSIBLE FOR THE PROPER INSTALLATION OF THE PLANT MATERIAL. THE CONTRACTOR SHALL BE RESPONSIBLE FOR THE PROPER INSTALLATION OF THE PLANT MATERIAL.

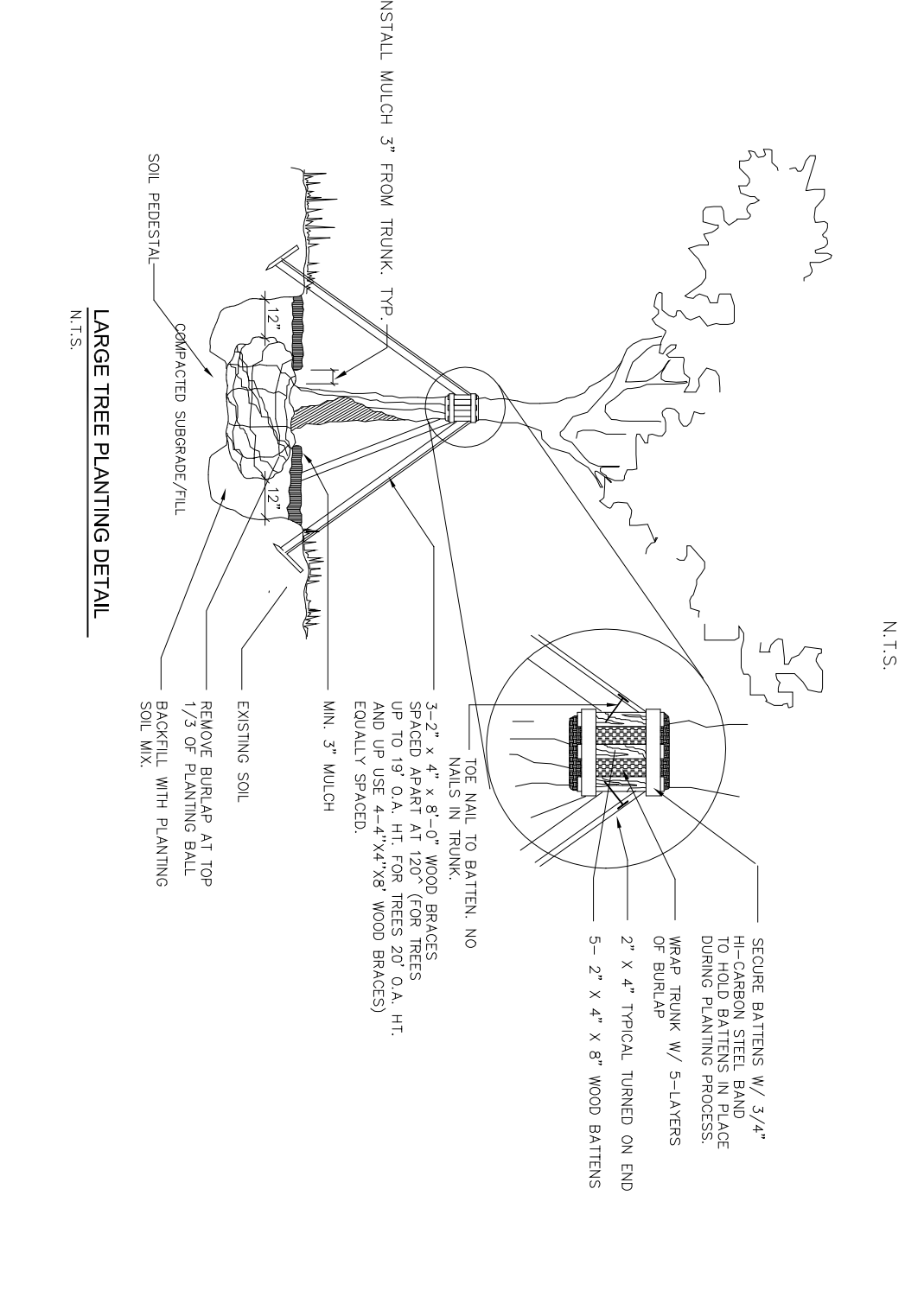
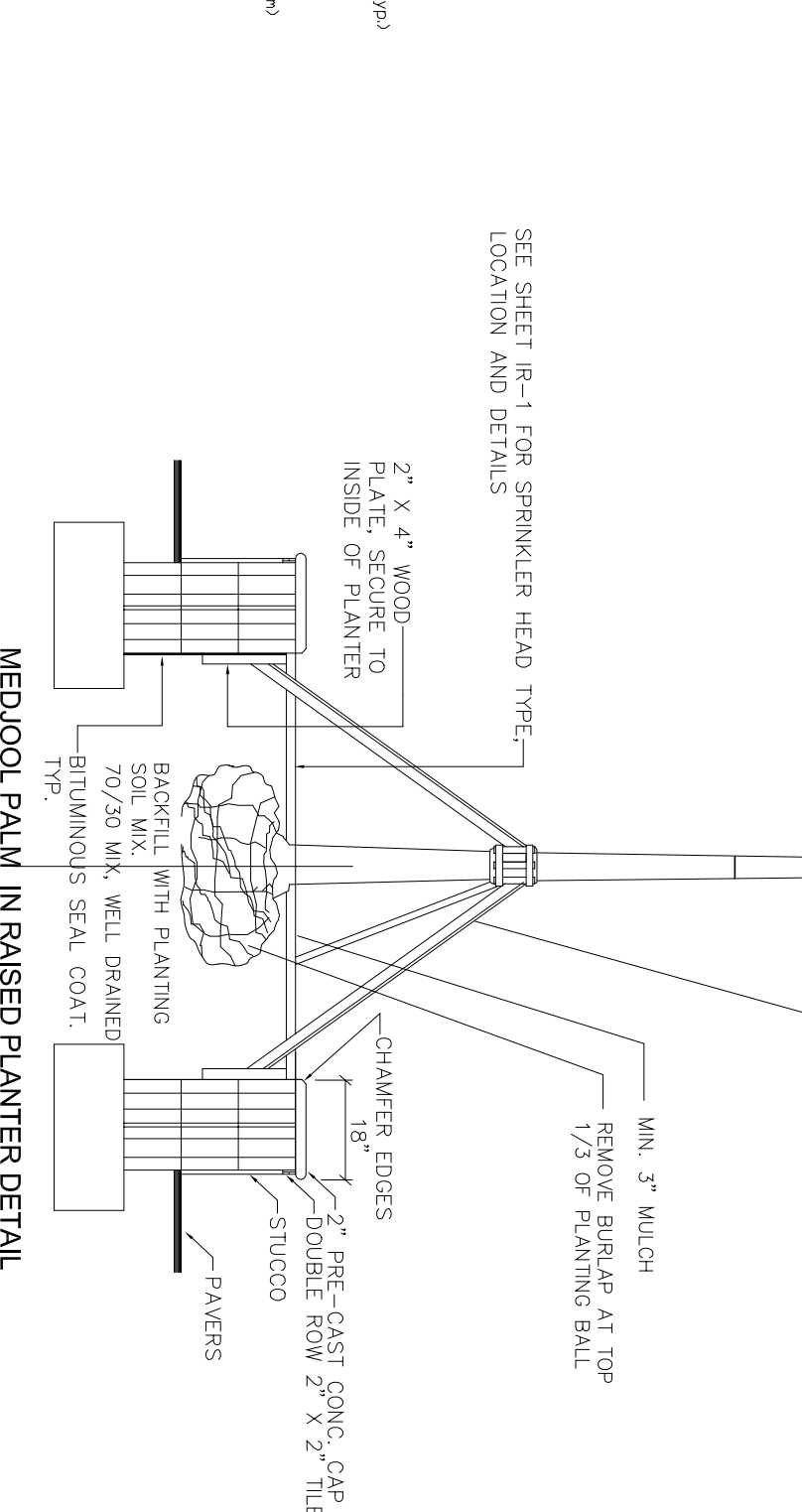
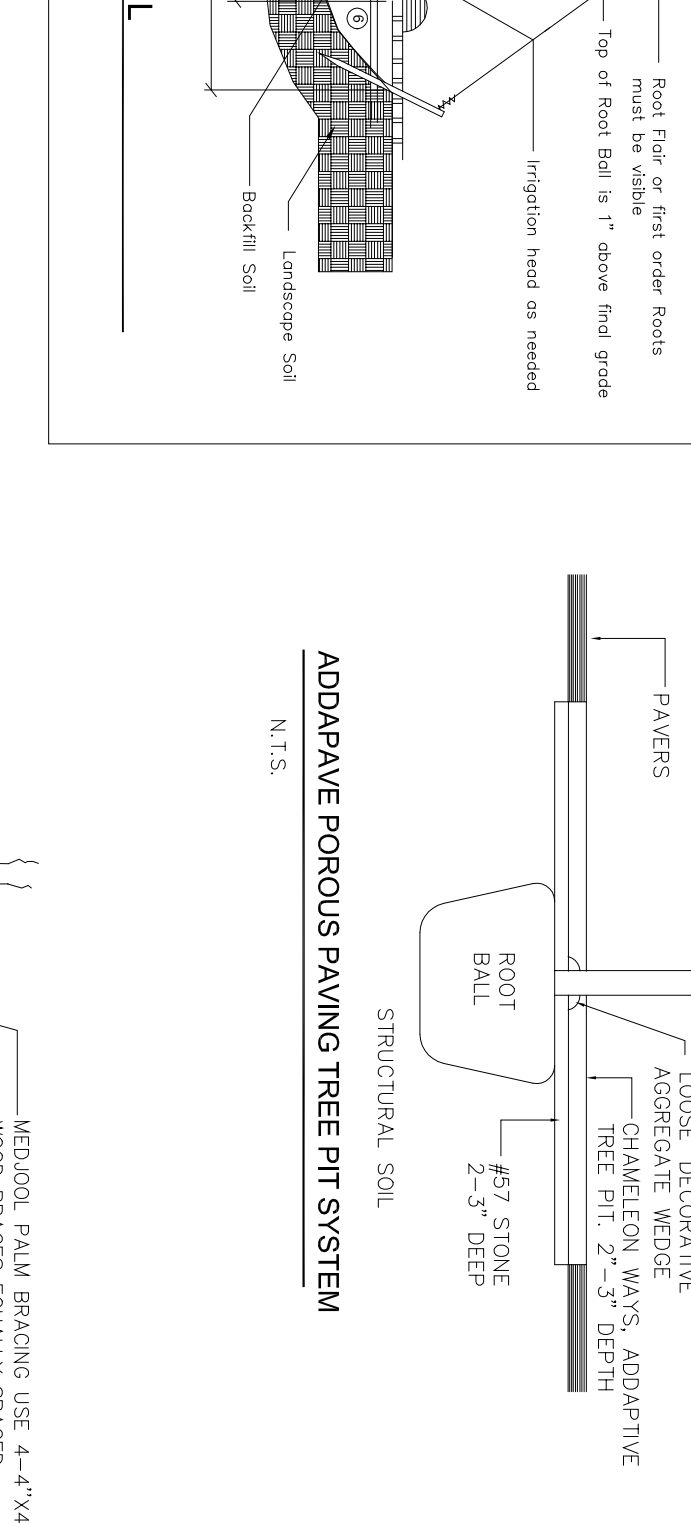
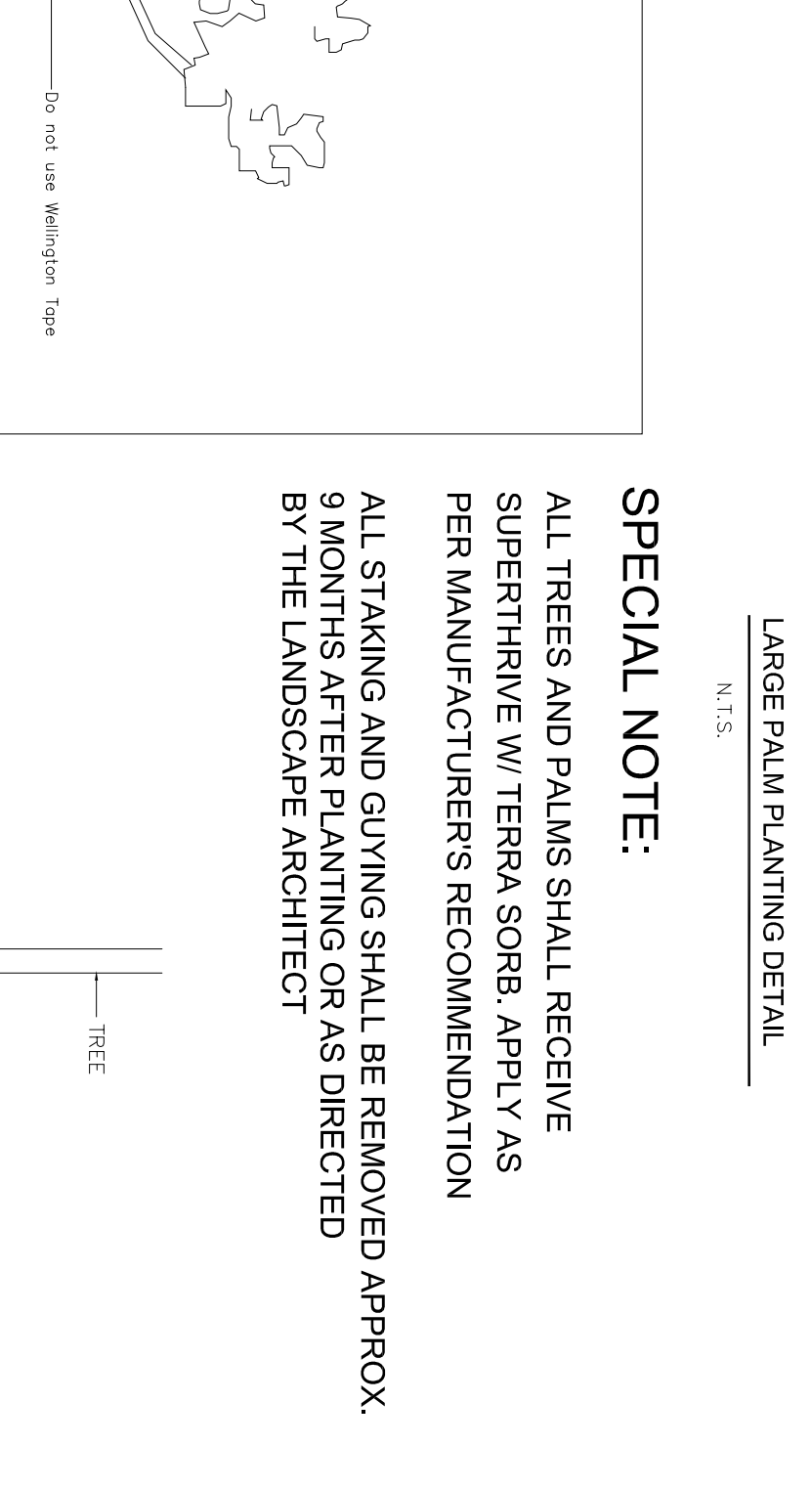
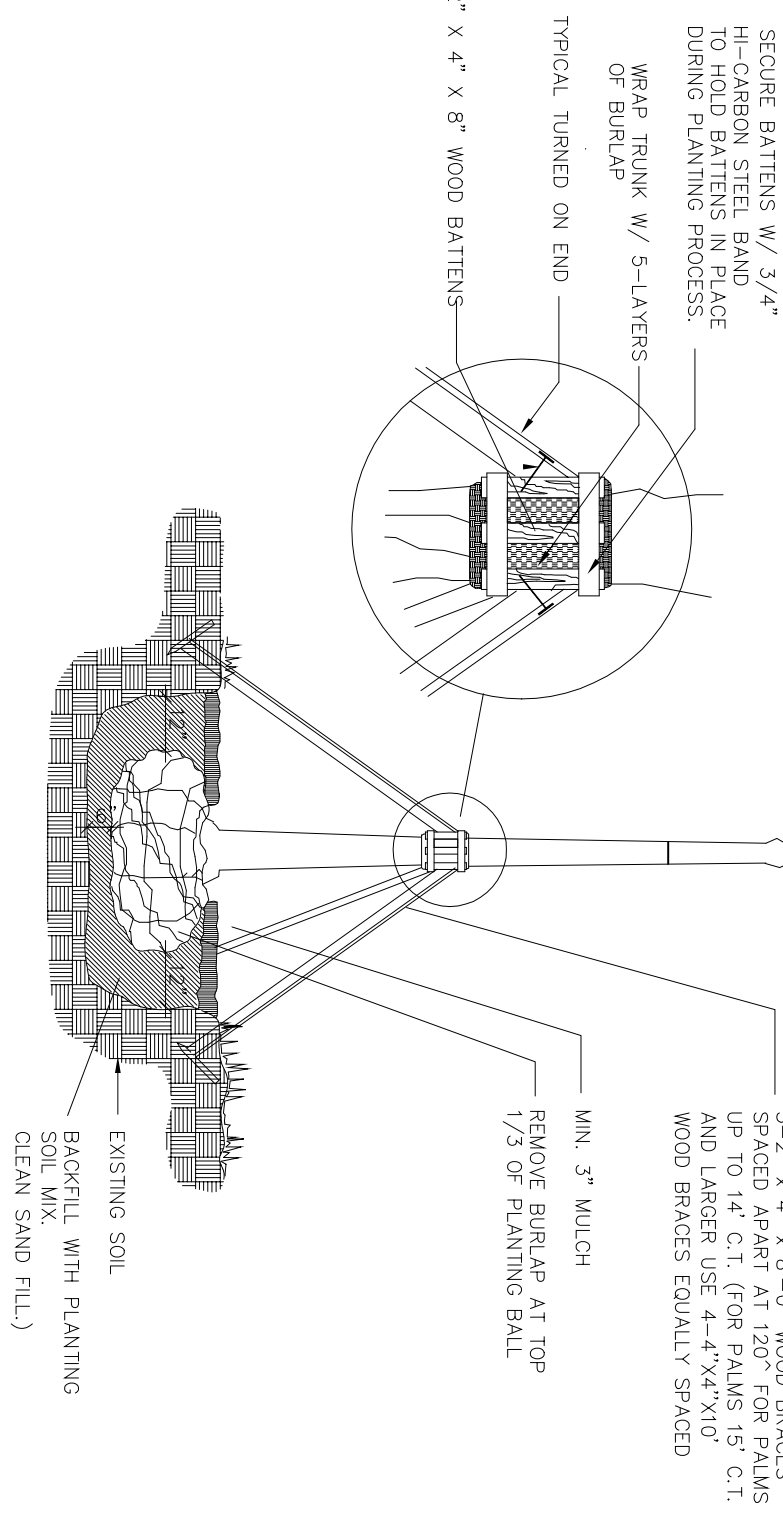
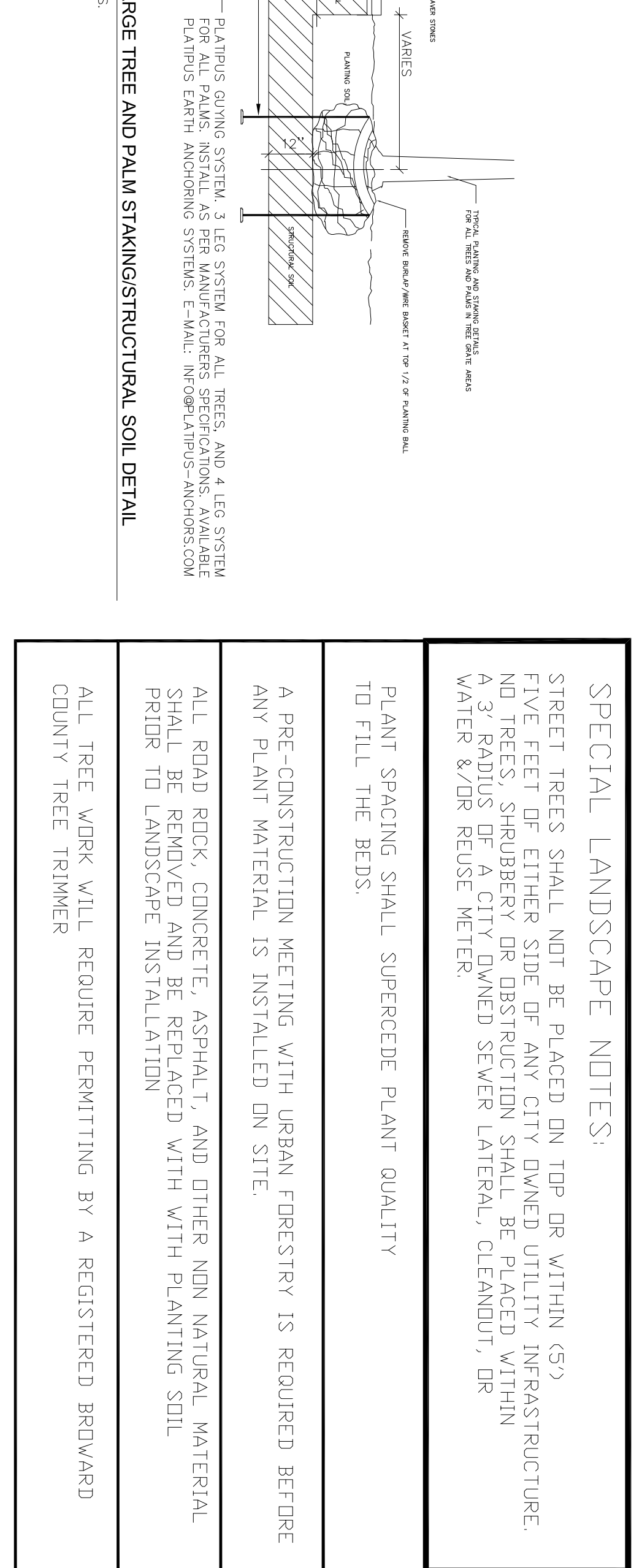
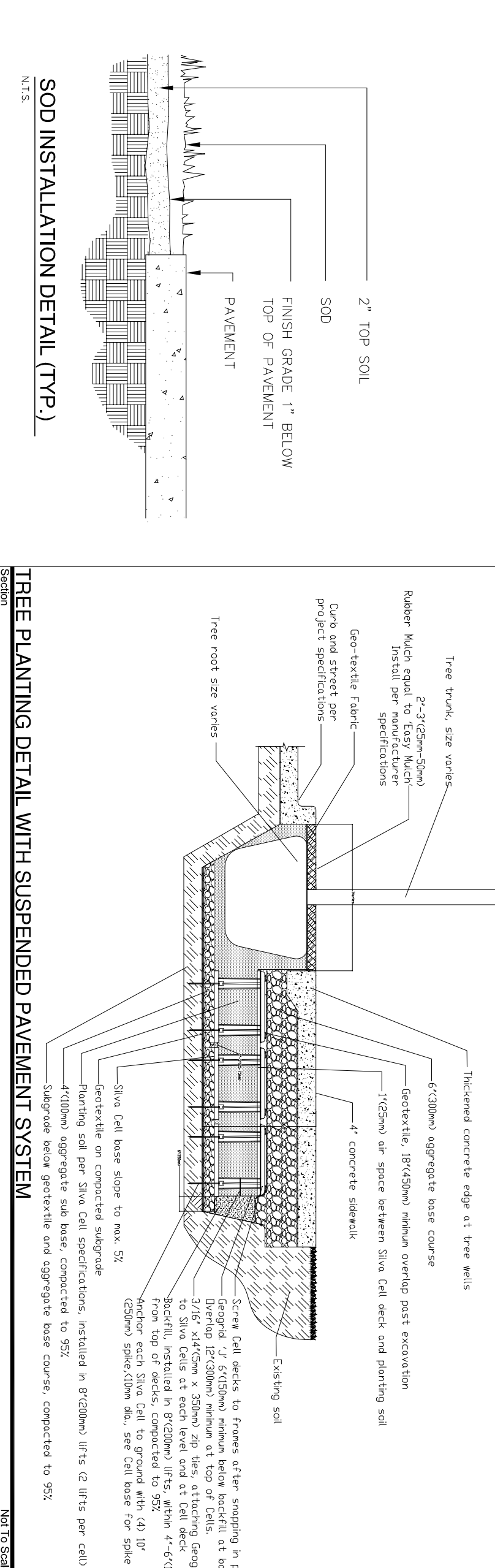
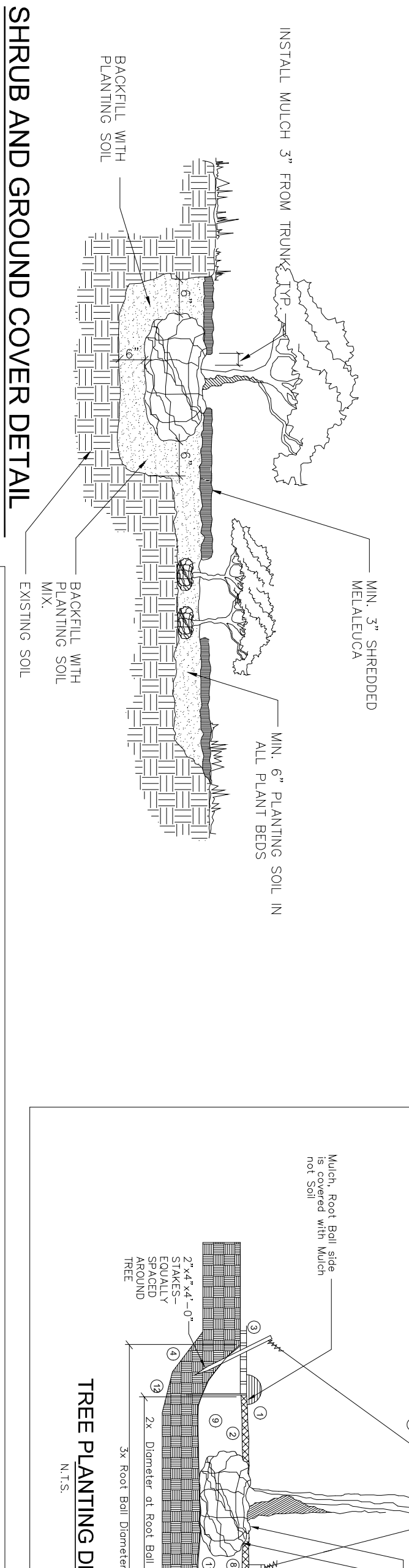
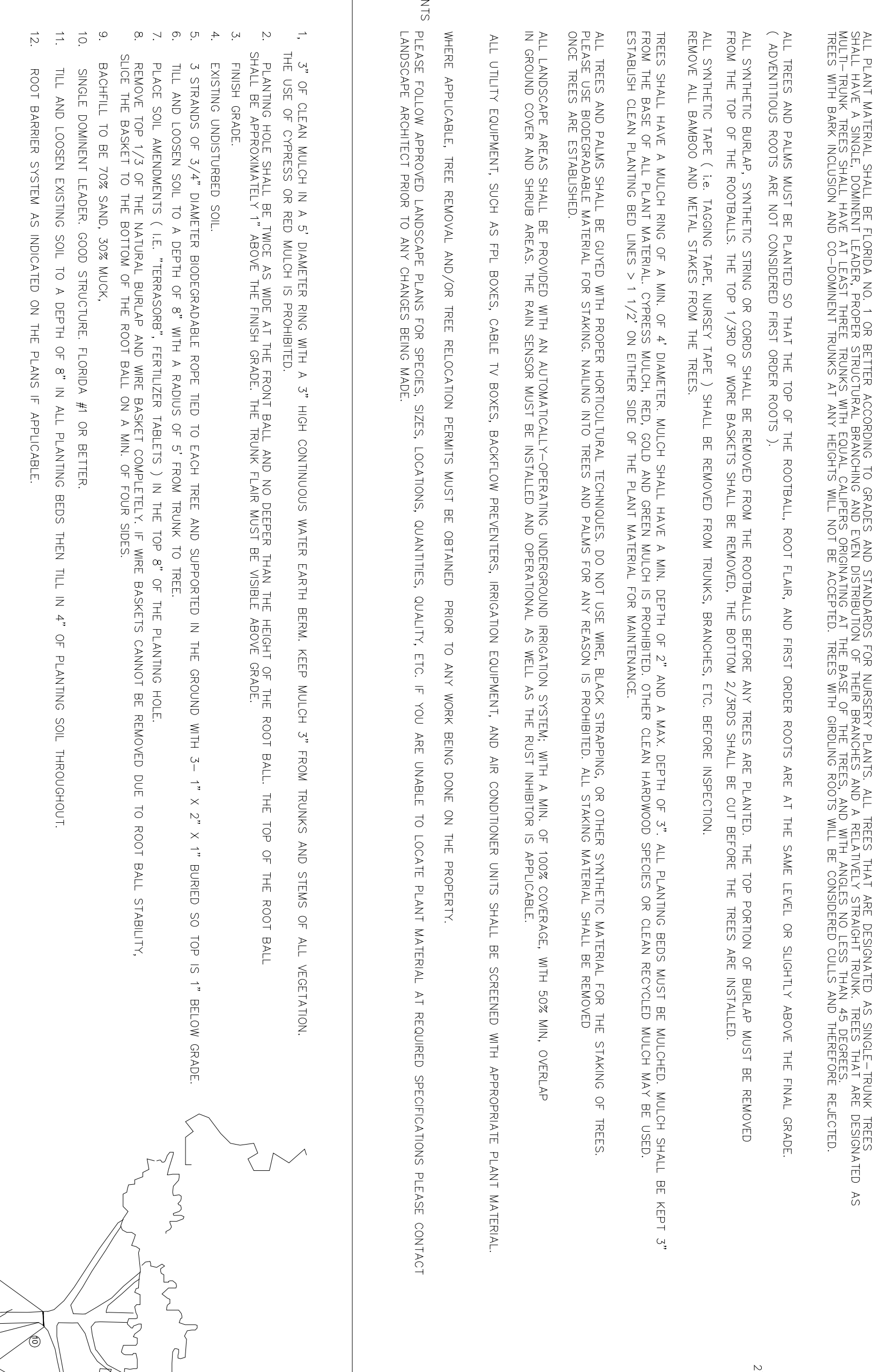

Michael Fay  
DATE: 02/24/2021  
TIME: 09:30:45

MICHAEL FAY: LANDSCAPE ARCHITECT  
REG.# 540  
420 N.W. 7th ST., DELRAY BCH., FL. 33434  
PH. 561-306-4003

DATE: 1-29-20  
DRAWN BY: M. FAY  
CHECKED BY:  
CAD FILE:

PROJECT:  
ATLANTIC 3350  
3350 ATLANTIC BLVD.  
POMPANO BEACH, FLORIDA  
LANDSCAPE DETAILS & SPECS.

SHEET NO.  
L-3  
DRAWING FILE NO.

PZ20-12000005  
2/24/2021