JEFF LANTZ, Parking Operations Manager

100 W. Atlantic Boulevard
Pompano Beach, FL 33060
Phone: (954) 786-5580
Jeff.Lantz@copbfl.com



MEMORANDUM

DATE: August 19, 2020

TO: Mayor, Vice Mayor and City Commissioners

Through: Gregory P. Harrison, City Manager

Through: Suzette Sibble, Assistant City Manager

FROM: Jeff Lantz, Parking Manager, and Chris Brown, Parking Consultant

SUBJECT: Interlocal Agreement for US1 Transit Hub Site Design and Construction

I am requesting approval of an Interlocal Agreement between the Pompano Beach Community Redevelopment Agency (the "CRA") and the City of Pompano Beach (the "City") to allow for parking improvements to properties currently owned by the CRA (See Exhibit A) to allow for these sites to be utilized as a transit hub until such time as the lots are ready to be redeveloped by the CRA. It is the City's intention to transform the lots into a park and ride location. The approval of this item by the CRA Board will allow the City to proceed with developing a design concept (See Exhibit B) and ultimately completing improvements. The City has been approved for an FDOT grant to assist in developing a ride share program and this project will be a component of that overall project.

The City intends to build a small 53-78 space public parking lot to provide parking for the general public, to include employees working in the City within which to park for a monthly fee and who in turn would be shuttled by a City contracted ride-share service vendor to their place of employment, with no charge from the ride share vendor. The City's intention is to cover all or a portion of the ride share vendor's cost (advertising revenue is typically utilized by these vendors to offset operating costs), if any, through a match grant that the City has been awarded from FDOT to provide the ride-share service and related ride share costs. The City will be issuing a solicitation for a micro transit program over the next months. The purpose of a ride-share parking lot is reduced traffic along Atlantic Boulevard and on the Barrier Island, as well as to ensure that new business who build and operate in Pompano Beach will be assured that their employees can park inexpensively in a remote but convenient lot, thereby ensuring parking space availability for the patrons of areas businesses, close to those establishments. The City expects

the destination of the employment will be initially at beach area employers, followed by nearby financial district (US 1 to the Intracoastal Waterway) employers as the mid-town area is redeveloped.

EXHIBIT A

Aerial Map of Transit Hub Site

**Please see map disclaimer



Transit Hub Concept Design – Phase 1 – 53 Spaces

Exhibit 1.

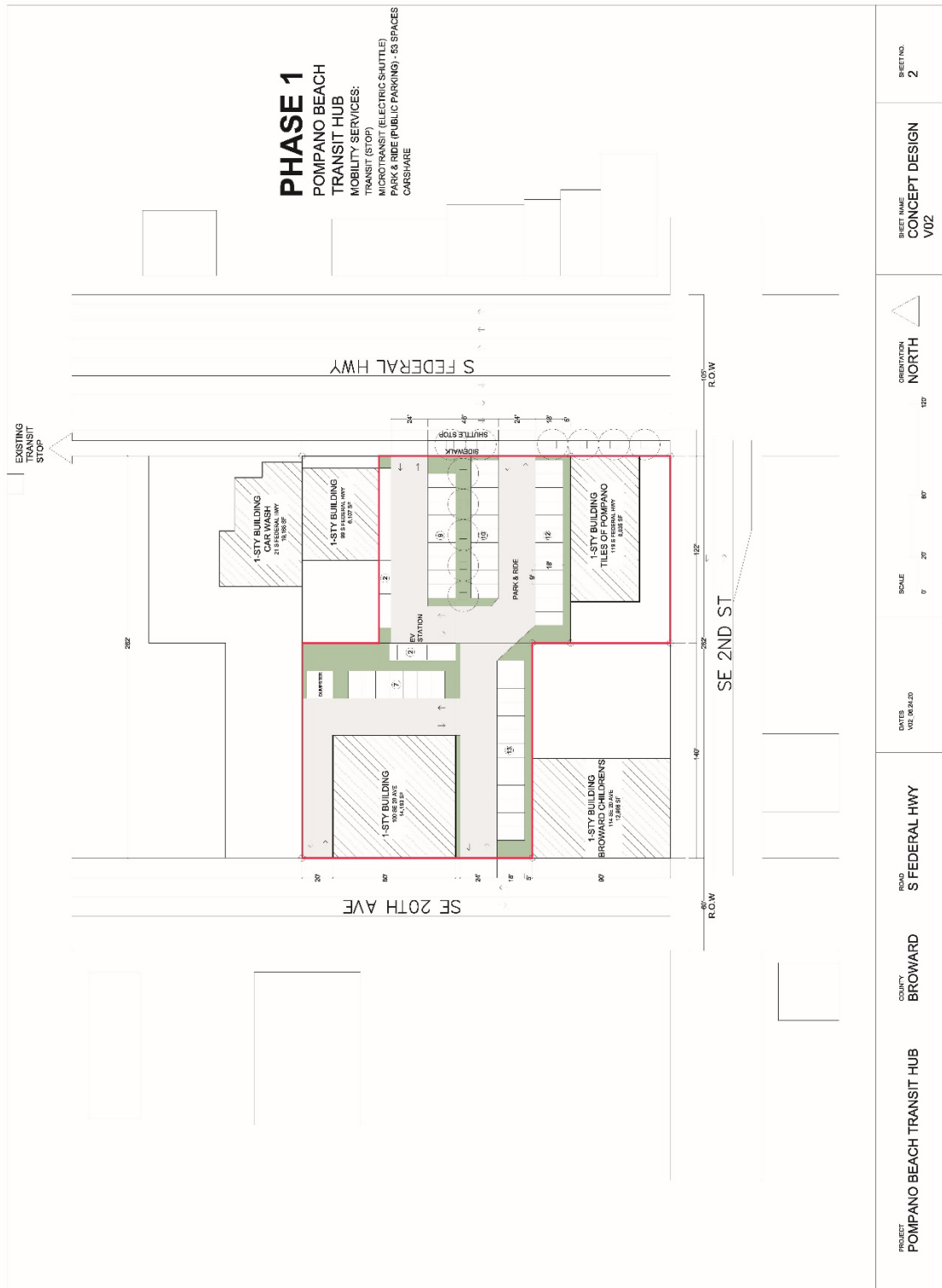

EXHIBIT B

Transit Hub Concept Design – Phase 2 – 78 spaces

