

**CITY OF POMPANO BEACH, FLORIDA
NOTICE OF PUBLIC HEARING
P&Z # 21-17000005**

YOU ARE HEREBY NOTIFIED of a Petition by **U-Haul Co. of Florida** ("Applicant Landowner"), before the ZONING BOARD OF APPEALS of the City of Pompano Beach, Florida, on April 15, 2021, at 5:00 P.M. The public meeting will occur in a remote format. Information for participation will be made available on the City's website alongside the Zoning Board of Appeals agenda at pompanobeachfl.gov/meetings one week prior to the meeting date. The Applicant Landowner is requesting SPECIAL EXCEPTION approval as required by Section 155.4223(A)(1) [Districts Where Permitted] of the City's Zoning Code in order to utilize the subject property (Zoning District: I-1) for a Self-Storage or Mini-Warehouse Facility.

The property in this Public Hearing is as follows:

LOTS 8, 9, 10, 11 AND 12, LESS THE WEST 30 FEET OF LOT 12, BLOCK 10, AMENDED PLAT OF FAIRVIEW, AS RECORDED IN PLAT BOOK 109, PAGE 25, OF THE PUBLIC RECORDS OF BROWARD COUNTY, FLORIDA, TOGETHER WITH THE SOUTH 250 FEET OF THE NORTH 1,235 FEET OF THE EAST 248 FEET OF THE WEST ONE-HALF OF THE SOUTHWEST ONE-QUARTER OF THE NORTHWEST ONE-QUARTER OF SECTION 2, TOWNSHIP 49 SOUTH, RANGE 42 EAST, SAID LANDS, SITUATE, LYING AND BEING IN THE CITY OF POMPANO BEACH, BROWARD COUNTY, FLORIDA.

LESS THE FOLLOWING TWO PARCELS OF LAND

BEGIN AT THE NORTHEAST CORNER OF SAID SOUTH 250 FEET THEREOF; THENCE SOUTH 88° 26' 46" WEST FOR 222.60 FEET TO A POINT OF CURVATURE, SAID POINT ALSO BEING THE POINT OF BEGINNING; THENCE SOUTHWESTERLY ALONG SAID CURVE, CONCAVE TO THE SOUTHEAST HAVING TO CENTRAL ANGLES OF 90° 56' 57" AND TWO RADIUSSES OF 25 FEET FOR AN ARC DISTANCE OF 39.68 FEET TO A POINT ON THE EAST BOUNDARY OF S.W. 12TH AVENUE; THENCE 2° 30' 11" WEST ALONG SAID WEST BOUNDARY OF S.W. 12TH AVENUE FOR 25.40 FEET; THENCE NORTH 88° 26' 46" EAST FOR 25.40 FEET TO THE POINT OF BEGINNING; AND

THAT PART OF LOT 8, BLOCK 10 OF FAIRVIEW AMENDED ACCORDING TO THE PLAT AS RECORDED IN PLAT BOOK 10 AT PAGE 25 OF THE PUBLIC RECORDS OF BROWARD COUNTY, FLORIDA IN SECTION 2, TOWNSHIP 49 SOUTH, RANGE 42 EAST, SAID PART BEING MORE PARTICULARLY DESCRIBED AS FOLLOWS:

BEGIN AT THE SOUTHEAST CORNER OF SAID LOT 8; THENCE RUN NORTHWESTERLY ALONG THE EAST LINE OF SAID LOT 8, A DISTANCE OF 160.33 FEET TO THE NORTHEAST CORNER THEREOF, THENCE S 86°16'42" W A DISTANCE OF 10.69 FEET; THENCE S 0°50'09" E A DISTANCE OF 160.08 FEET; THENCE N 88°16'42" W A DISTANCE OF 14.27 FEET TO THE POINT OF BEGINNING.

AKA: 790-820 SW 12th Avenue
ZONED: General Industrial (I-1)
FOLIOS: 494202000510, 494202030850, and 494202030840

All interested persons are urged to attend the Public Hearing electronically on the day of meeting as directed on the City's website, or express their views by letter. You may either be present in person at the hearing of this Appeal, represented by counsel or letter. All interested persons take due notice of the time and place of the hearing of this Appeal and govern yourselves accordingly. Any person requiring auxiliary aids and services at this meeting may contact the City Clerk's Office at 954-786-4611 at least 24 hours prior to the meeting. If you are hearing or speech impaired, please contact the Florida Relay Service at 1-800-955-8770 or 1-800-955-8771. Any person who decides to appeal any decision of the Zoning Board of Appeals with respect to any matter considered at this meeting will need a record of the proceedings and for such purpose may need to ensure that a verbatim record of the proceedings is made, which record includes the testimony and evidence upon which the appeal is to be based. All correspondence to the Zoning Board of Appeals relative to this matter may be emailed to zoning@copbfl.com or mailed to P.O. Drawer 1300, Pompano Beach, Florida 33061. The original application and documentation may be viewed by contacting zoning@copbfl.com or 954-786-4667 or pompanobeachfl.gov/meetings one week prior to the meeting date.

CITY OF POMPANO BEACH, FLORIDA
BY: Daniel H. Yaffe, Chairman
Zoning Board of Appeals

CITY OF POMPANO BEACH

500' RADIUS MAP

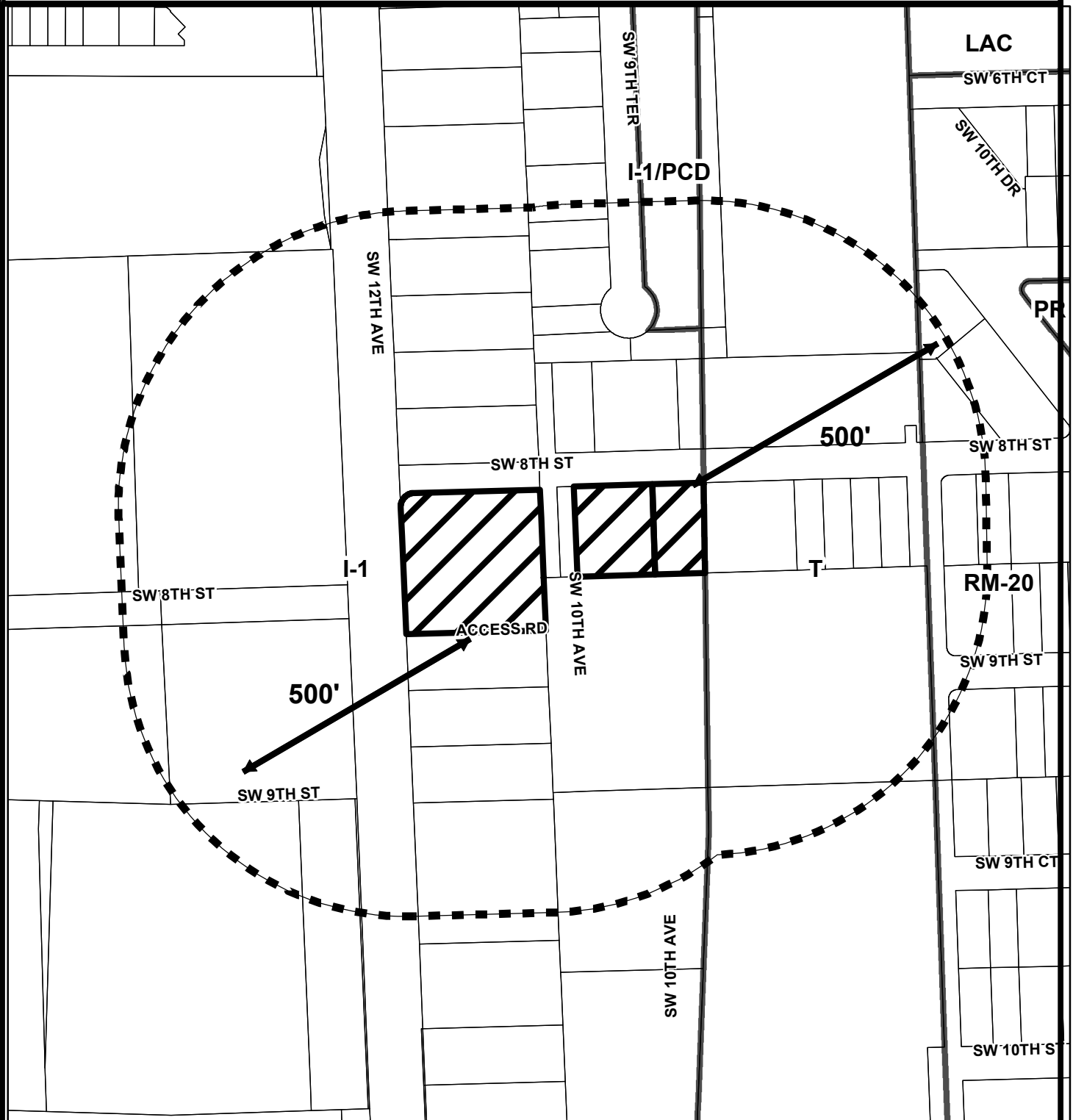

**APPEAL
OF DECISION**

4/5/2021

U-HAUL OF FLORIDA
790-820 SW 12th AVENUE

Y:\AII_Maps\Notice Maps\2021\21-10000002_Map500.mxd

1 in = 250 ft

PREPARED BY:
DEPARTMENT OF
DEVELOPMENT SERVICES

mccpar